

PORTER, O'BRIEN & ARMSTRONG  
CONSULTING ENGINEERS IN WAKE, N. H.

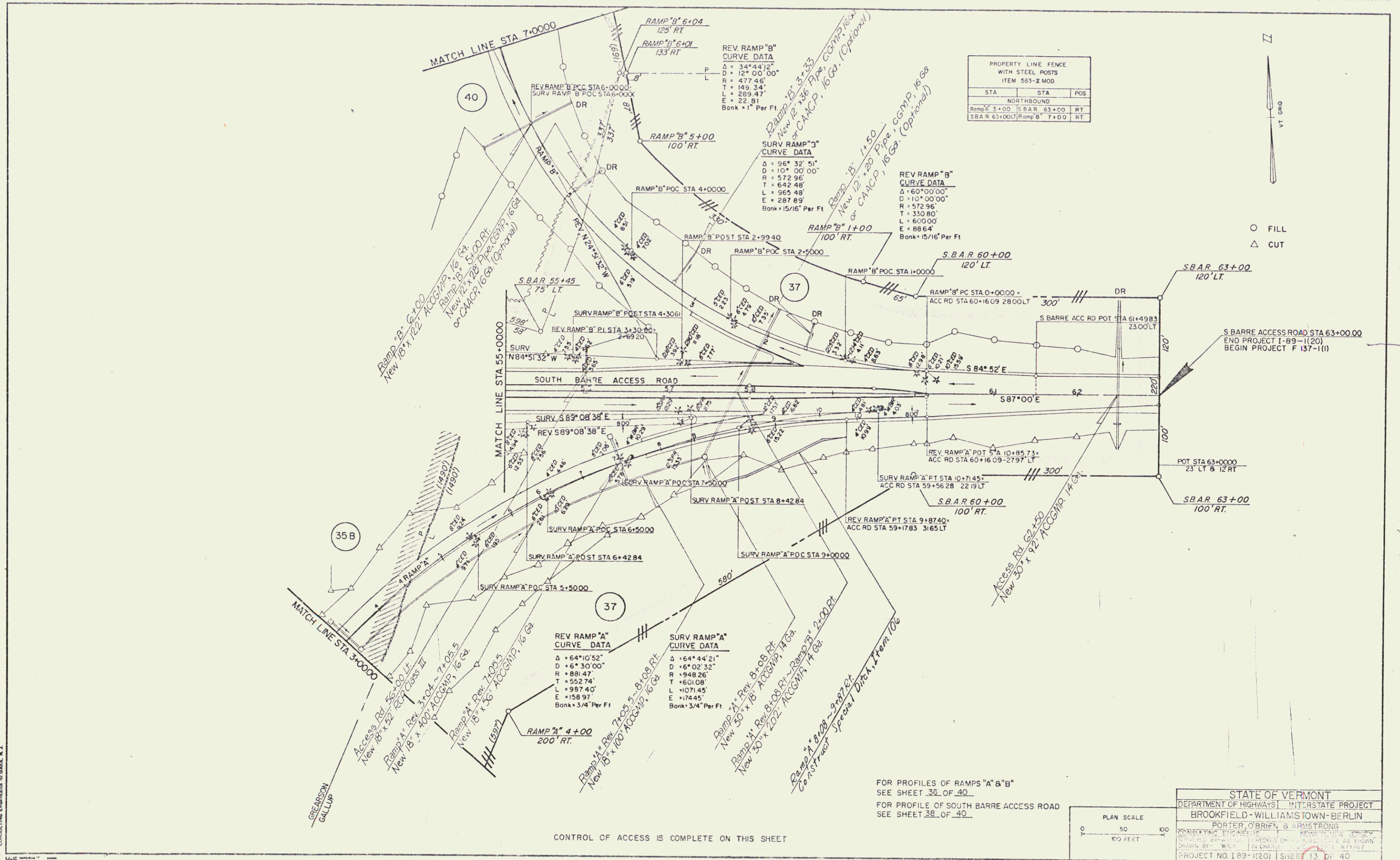

PROPERTY LINE FENCE WITH STEEL POSTS ITEM 583-2 MOD		
STA	STA	POS
NORTHBOUND		
Ramp 3+00	S.B.A.R. 63+00	RT
S.B.A.R. 63+00	Ramp B 7+00	RT

CONTROL OF ACCESS IS COMPLETE ON THIS SHEET

FOR PROFILES OF RAMPS "A" & "B"  
SEE SHEET 38 OF 40  
FOR PROFILE OF SOUTH BARRE ACCESS ROAD  
SEE SHEET 38 OF 40

STATE OF VERMONT  
DEPARTMENT OF HIGHWAYS | INTERSTATE PROJECT  
BROOKFIELD-WILLIAMSTOWN-BERLIN  
PORTER, O'BRIEN & ARMSTRONG  
CONSULTING ENGINEERS IN WAKE, N. H.  
DRAWN BY: WLS  
CHECKED BY: JCS  
DATE: 8/1/72  
PROJECT NO. 189-1(20) | SHEET 13 OF 40