

STA	STA	POS
2512 + 84	2529 + 14	RT
2515 + 15	Ramp C 37 + 00	LT

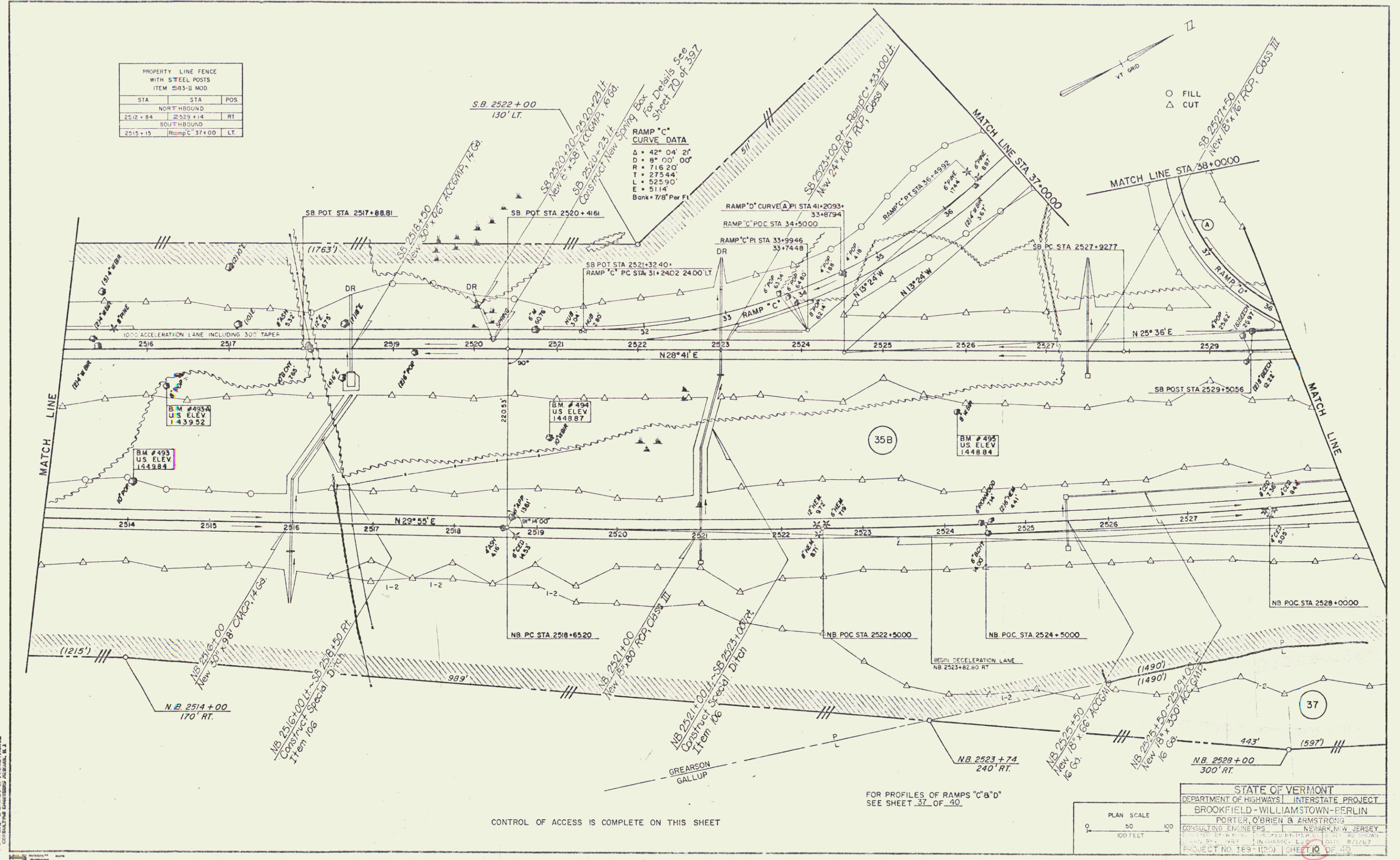

CONTROL OF ACCESS IS COMPLETE ON THIS SHEET

FOR PROFILES OF RAMP "C" & "D" SEE SHEET 37 OF 40.

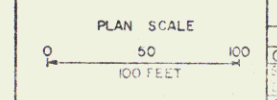

STATE OF VERMONT
DEPARTMENT OF HIGHWAYS INTERSTATE PROJECT
BROOKFIELD-WILLIAMSTOWN-BERLIN
PORTER, O'BRIEN & ARMSTRONG
CONSULTING ENGINEERS NEWARK, N. J. JERSEY
PROJECT NO. 169-1(20) SHEET 10 OF 20