

PONTELL, O'BRIEN & STRONG
Consulting Engineers
Newark, N.J.

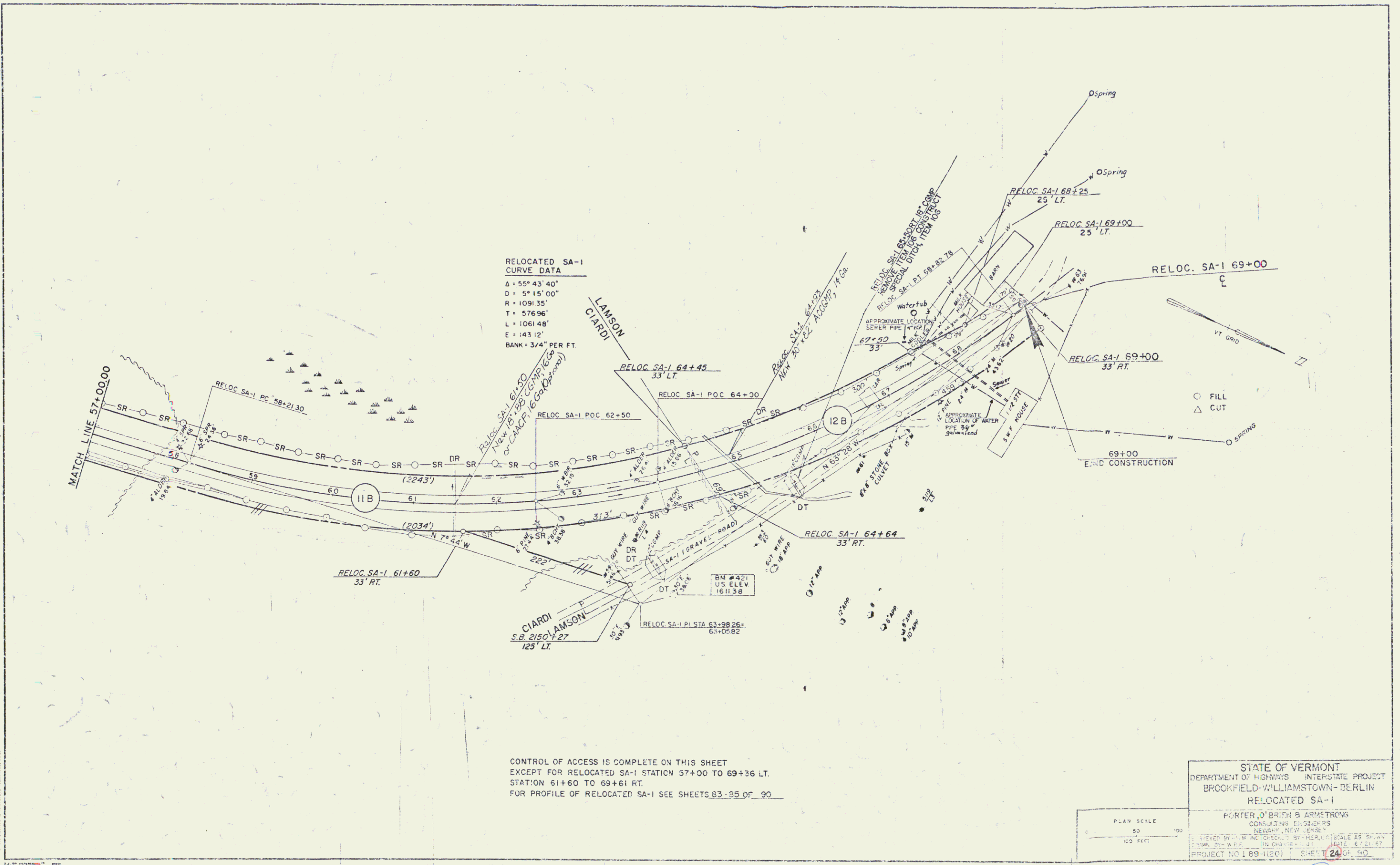

CONTROL OF ACCESS IS COMPLETE ON THIS SHEET
EXCEPT FOR RELOCATED SA-1 STATION 57+00 TO 69+36 LT.
STATION 61+60 TO 69+61 RT.
FOR PROFILE OF RELOCATED SA-1 SEE SHEETS 83-95 OF 90

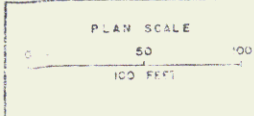

STATE OF VERMONT
DEPARTMENT OF HIGHWAYS INTERSTATE PROJECT
BROOKFIELD-WILLIAMSTOWN-BERLIN
RELOCATED SA-1
PORTER, O'BRIEN & ARMSTRONG
CONSULTING ENGINEERS
NEWARK, NEW JERSEY
1. PREPARED BY: W. J. M. G. DATE: 6/21/67
2. CHECKED BY: W. J. M. G. DATE: 6/21/67
PROJECT NO. 189-1(20) SHEET 24 OF 40

Row + Con. Plans