

PORTER, O'BRIEN & ARMSTRONG
CONSULTING ENGINEERS
NEWARK, NEW JERSEY

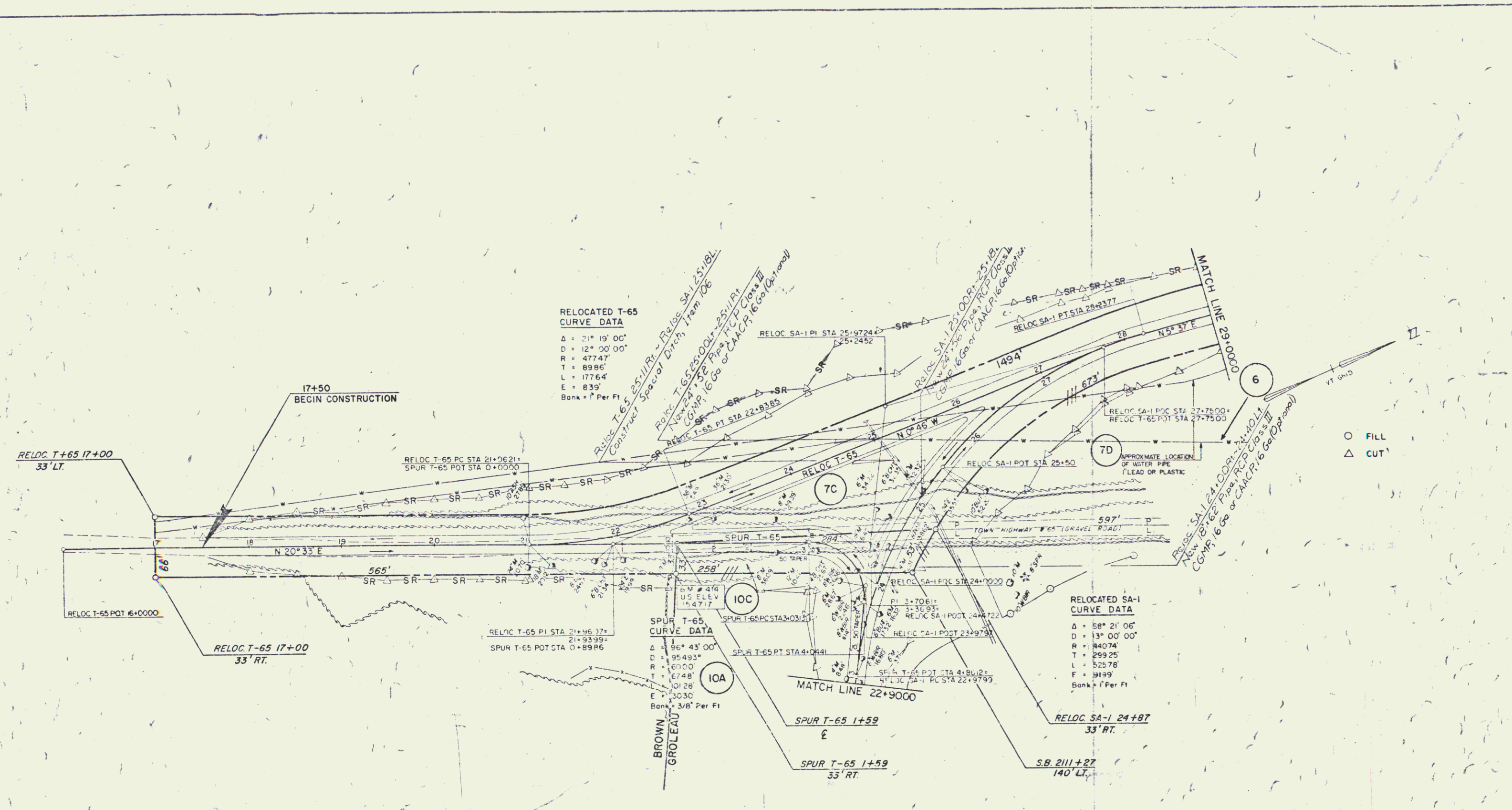

**RELOCATED T-65
CURVE DATA**
Δ = 21° 19' 00"
D = 47747'
R = 47747'
T = 8986'
L = 17764'
E = 839'
Bank = 1' Per Ft

**SPUR T-65
CURVE DATA**
Δ = 96° 43' 00"
D = 6000'
R = 6000'
T = 6748'
L = 3030'
E = 3030'
Bank = 3/8" Per Ft

**RELOCATED SA-1
CURVE DATA**
Δ = 88° 21' 00"
D = 13° 00' 00"
R = 84074'
T = 29925'
L = 52578'
E = 8199'
Bank = 1' Per Ft

CONTROL OF ACCESS IS COMPLETE ON THIS SHEET EXCEPT FOR RELOCATED SA-1 STATION 24+16 TO 29+00 (RT. & LT.) RELOCATED T-65 STATION 17+00 TO 29+00 (RT. & LT.) SPUR T-65 STATION 0+00 TO 1+59 (RT. & LT.) AND STATION 1+59 TO 3+65 (LT.)

FOR PROFILE OF RELOCATED SA-1 SEE SHEETS 83-85 OF 90.
FOR PROFILE OF RELOCATED T-65 SEE SHEET 84 OF 90.
FOR PROFILE OF SPUR T-65 SEE SHEET 88 OF 90.

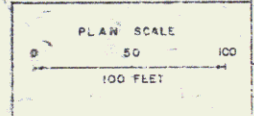

STATE OF VERMONT
DEPARTMENT OF HIGHWAYS INTERSTATE PROJECT
BROOKFIELD-WILLIAMSTOWN-BERLIN
RELOCATED SA-1 & T-65
PORTER, O'BRIEN & ARMSTRONG
CONSULTING ENGINEERS
NEWARK, NEW JERSEY
SURVEYED BY: W.M. INC. CHECKED BY: R.E. GIBBLE AS SHOWN
DRAWN BY: R.E.F. IN CHARGE: L.J.S. DATE: 4/2/78
PROJECT NO: 3 89-120 SHEET 21 OF 90