

RL FENCE TO BE ERECTED PRIOR TO CONSTRUCTION
SB 1295+00 - 1304+51.41
PROPERTY LINE FENCE, MOD, ITEM 583-II
S.B. 1295+00 - 1311+00 LT
N.B. 1295+00 - 1311+00 RT

DRILLING AND BLASTING OF SOLID ROCK SUBGRADE, ITEM 45
N.B. 1295+00 - 1311+00
S.B. 1295+00 - 1298+60
S.B. 1307+75 - 1311+00

JUTE MATTING, ITEM 623
S.B. 1300+25 - 1303+75 RT

MUCK EXCAVATION, ITEM 17
S.B. 1300+75 - 1303+75
S.B. 1297+00 - 1298+60

55# DWARD STEEL BEAM GUARD RAIL, ITEM 545-F
N.B. 1295+00 - 1298+60 RT
N.B. 1295+00 - 1295+12 LT
S.B. 1295+00 - 1311+00
S.B. 1295+00 - 1295+25 RT
* DENOTES STAGE 2 CONSTRUCTION

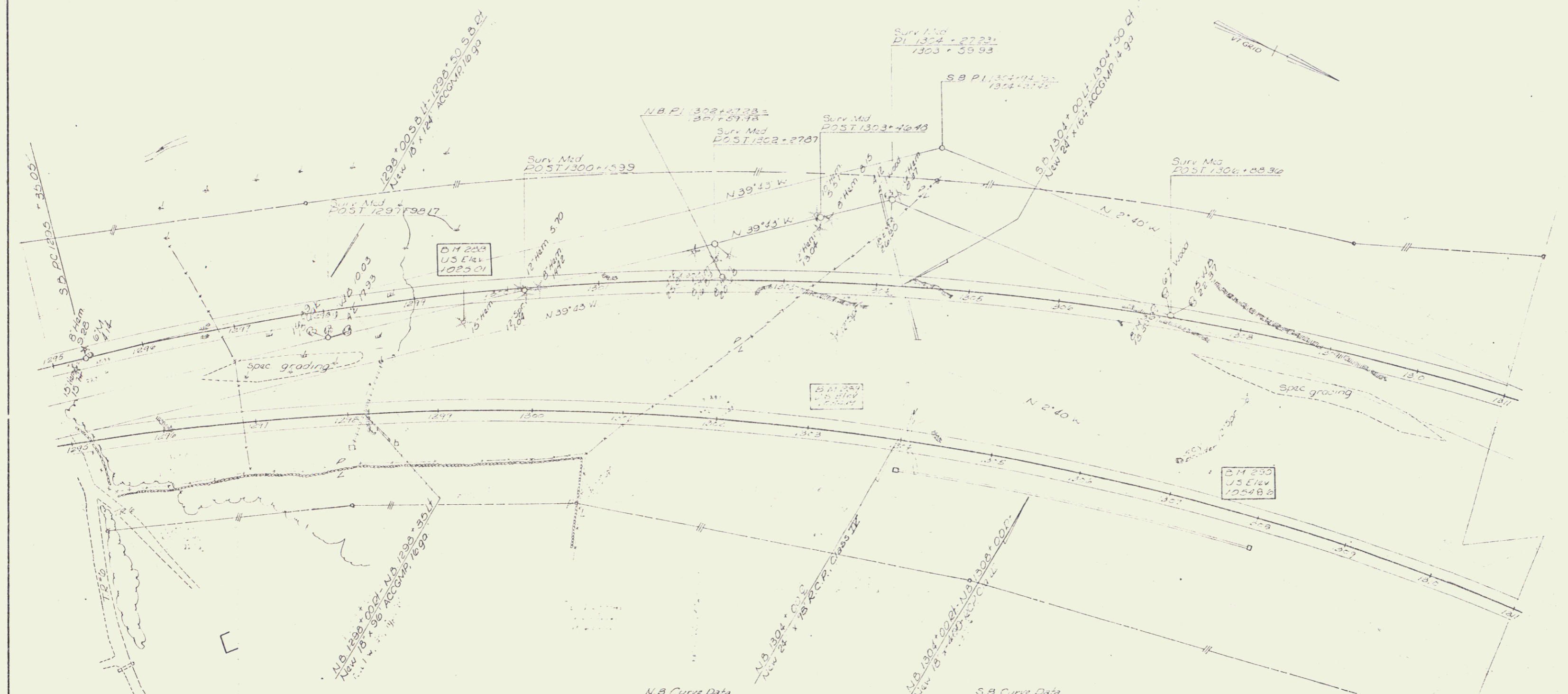

N.B. Curve Data

A	37°02'31" RT
D	2100.00'
R	2824.79'
T	959.70'
L	1852.10'
E	156.48'
Chk	3/8" RT (0.52%)

S.B. Curve Data

A	37°02'31" RT
D	2100.00'
R	2824.79'
T	959.70'
L	1852.10'
E	156.48'
Chk	3/8" RT (0.52%)

DEC 21 1973

SURVEYED BY Jewell DATE 4-63
DRAWN BY L. COCKE DATE 9/63
TRACED BY R. L. E. DATE 8/63
ROYALTON - BETHEL
RANDOLPH
PROJ. I NO. 89-1071 (27)
SHEET 61 OF 61 SHEET 3

CONTROL OF ACCESS COMPLETE ON THIS SHEET