

PROPERTY LINE FENCE MOD
ITEM 553 II
1263+00 - 1279+00 SB II
1265+50 - 1279+00 NB II

* THREE CABLE GUARD RAIL FLIGHT
SPECIALTY ITEM 533
1265+00 - 1279+00 SB II
1279+00 - 1279+00 NB II

JOIE MATTING ITEM 623
1270+75 - 1274+25 NB II
1272+25 - 1279+00 Med
1274+25 - 1279+00 SB II

DRILLING & BLASTING OF SOILD
ROCK SUBGRADE ITEM 115
1263+00 - 1274+60 NB
1263+00 - 1274+10 SB

SUBBASE OF SAND ITEM 202
NB 1274+00 - 1279+75
SB 1274+00 - 1279+00

P/L FENCE TO BE ERECTED PRIOR
TO CONSTRUCTION
NB 1263+00 - 1264+45 Et.
SB 1263+00 - 1279+00 Et.

* DENOTES STAGE 2 CONSTRUCTION

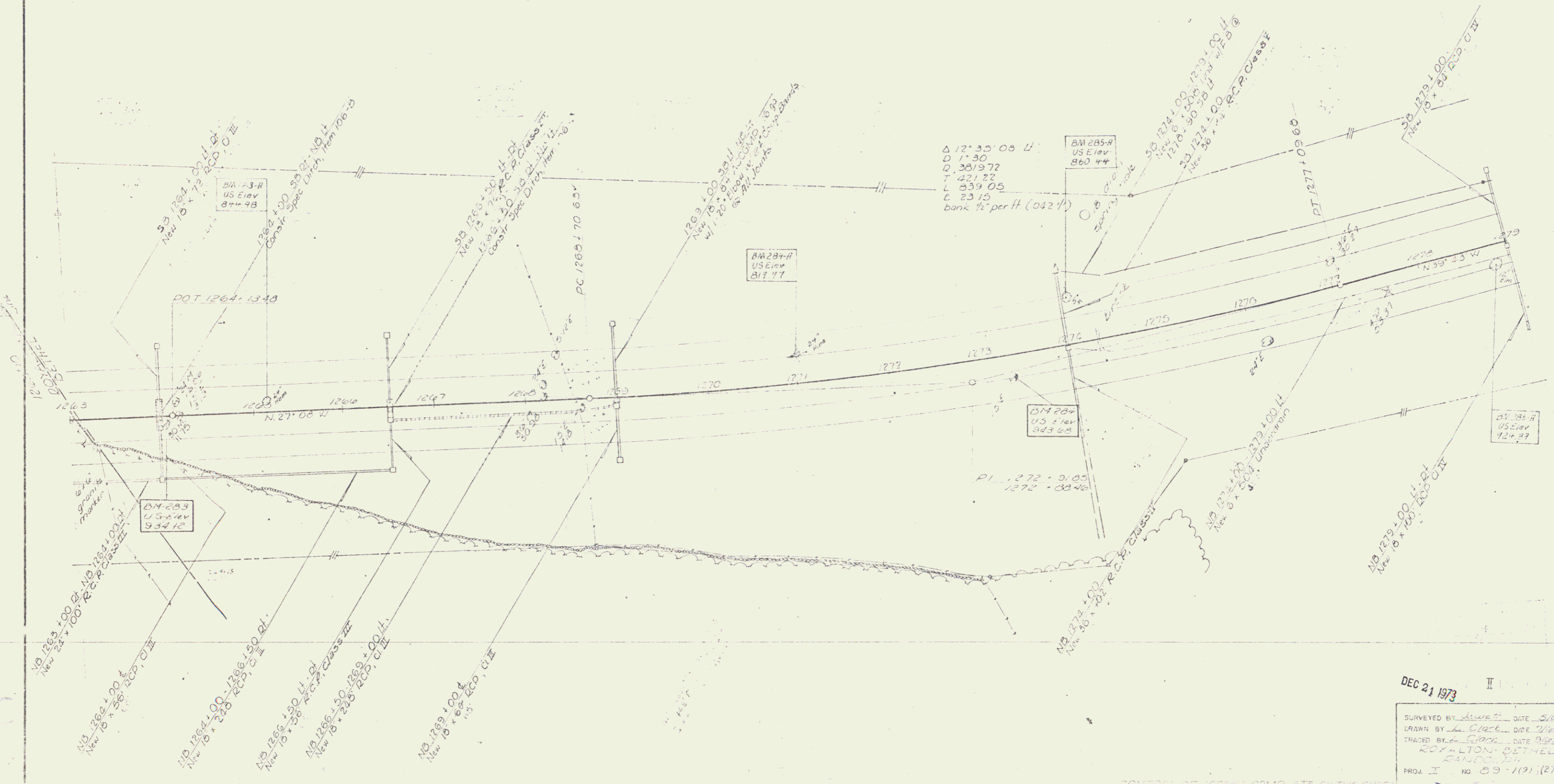
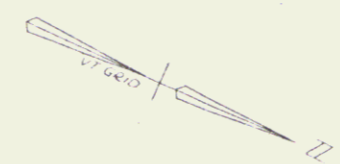

Δ 12° 35' 08" L
D 1' 30"
D 30/1972
T 271.72
L 539.05
E 23.15
bank 1/2" per ft (0.02%)

BM 285-A
US Elev
860.44

BM 284
US Elev
843.64

BM 283
US Elev
934.12

BM 287-A
US Elev
811.77

BM 286-A
US Elev
924.27

DEC 21 1973

SURVEYED BY *Swett* DATE *5/6/73*
DRAWN BY *L. Clark* DATE *7/1/73*
TRACED BY *Clark* DATE *9/6/73*
ROYALTON, BETHEL
CANON, VT.
PROJ. I NO. 89-1(2) (27)

CONTROL OF ACCESS COMPLETE ON THIS SHEET

SHEET 37 OF 138