

DRAWING & SURVEILING OF STATE HIGHWAY SUBGRADE FROM 15  
38 1614+00 - 1617+10

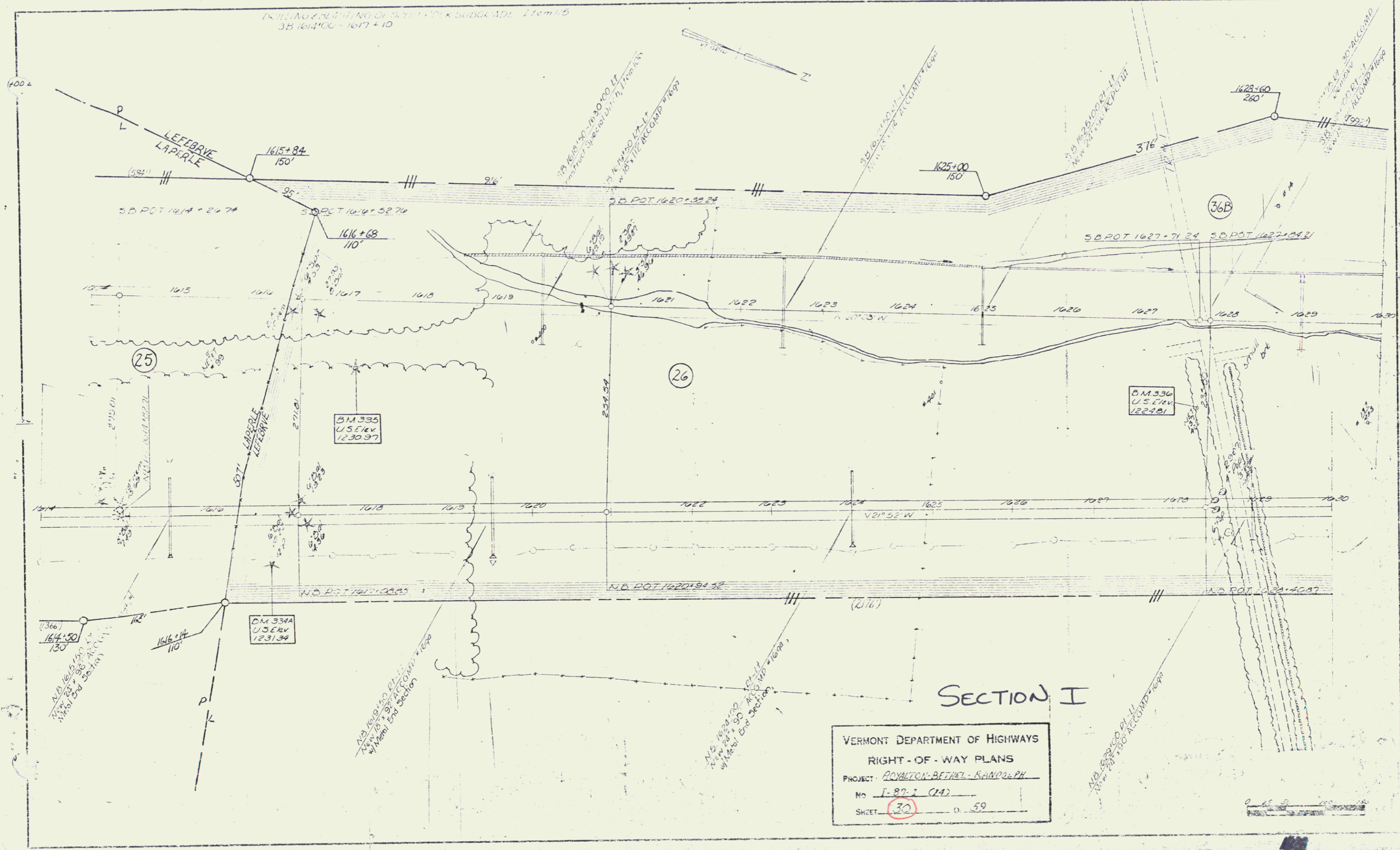

VERMONT DEPARTMENT OF HIGHWAYS  
RIGHT-OF-WAY PLANS  
PROJECT: ROYALTON-BETHEL-BARNES PH  
No. I-87-1 (14)  
SHEET 30 OF 59