

Drilling & Blast - 79 of Solid Rock Subgrade - Item 115  
 NB 1518+40 - 1518+40  
 NB 1524+70 - 1524+70  
 SB 1519+60 - SB 1522+75  
 SB 1523+70 - SB 1524+10  
 SB 1525+70 - SB 1534+00

Three Cable Guard Rail  
 Item 542  
 1518+00-1519+10 S.B. RA  
 1518+00-1520+60 S.B. LT

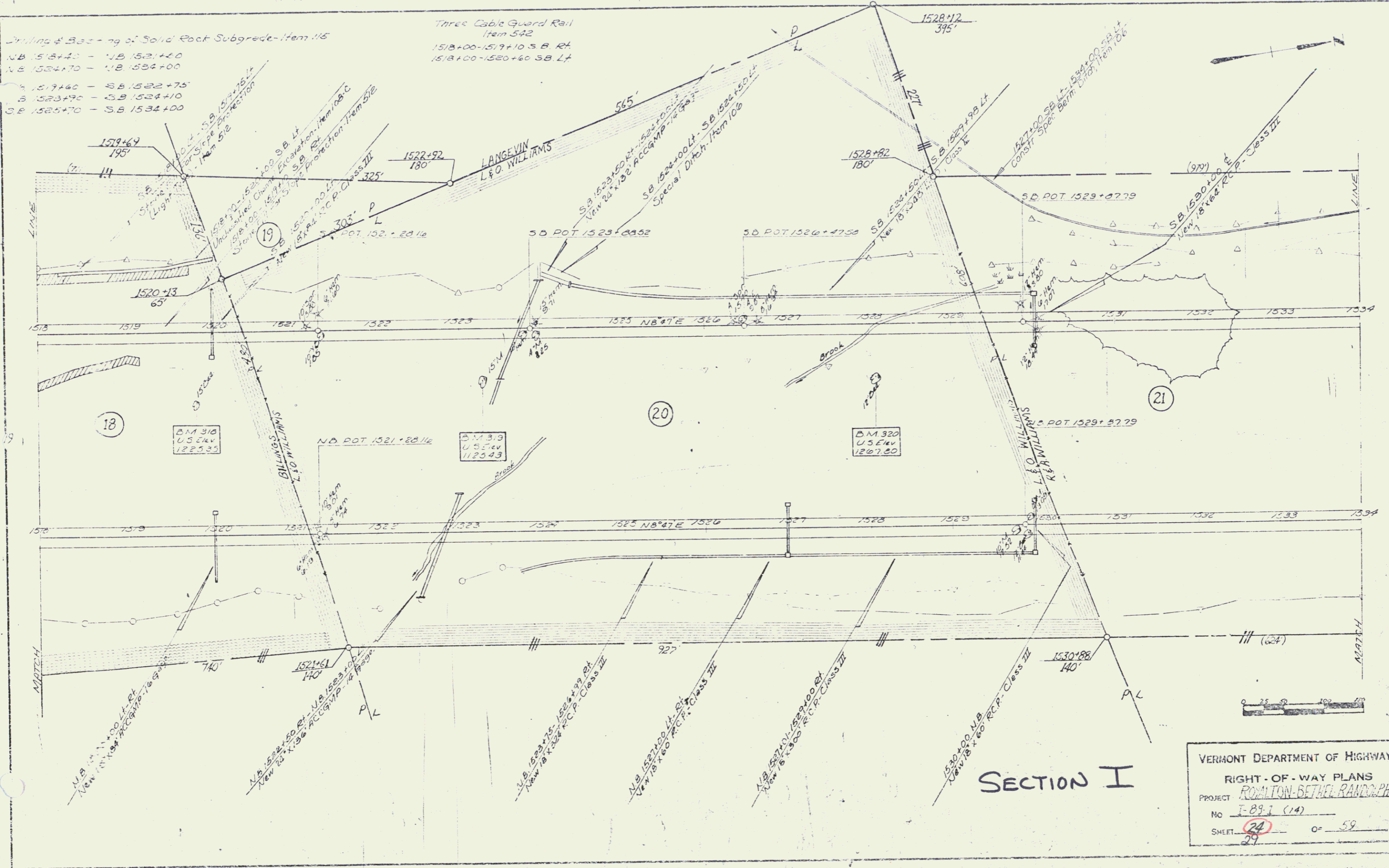

SECTION I

VERMONT DEPARTMENT OF HIGHWAYS  
 RIGHT-OF-WAY PLANS  
 PROJECT ROSLTON-BETHEL RANDOLPH  
 NO F-89-I (14)  
 SHEET 22 OF 59