

STATE OF VERMONT  
DEPARTMENT OF HIGHWAYS

Proposed Improvement

INTERSTATE PROJECT

**TOWNS OF ROYALTON-BETHEL-RANDOLPH**

COUNTIES OF WINDSOR AND ORANGE

**INTERSTATE ROUTE 89**

**WHITE RIVER JCT.-MONTPELIER ROAD**

BEGINNING AT A POINT 1.328 MILES SOUTH OF THE ROYALTON-BETHEL TOWN LINE AND EXTENDING NORTHERLY 8.804 MILES.

LENGTH OF ROADWAY 46,436.68 FEET = 8.795 MILES

LENGTH OF PROJECT 46,436.68 FEET = 8.795 MILES

ADT (1967)	2660
ADT (1987)	2940
DHV (1987)	865
D	51%
T	8%
V	60 MPH

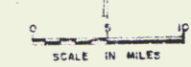
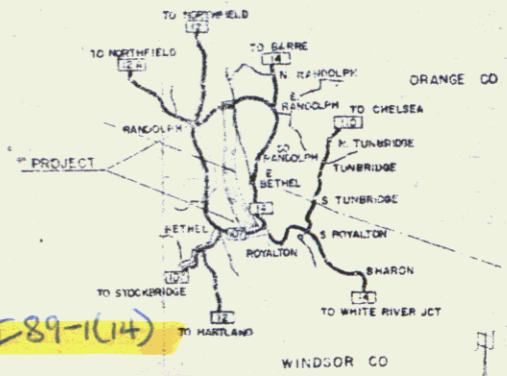

**RIGHT-OF-WAY PLANS**

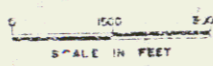
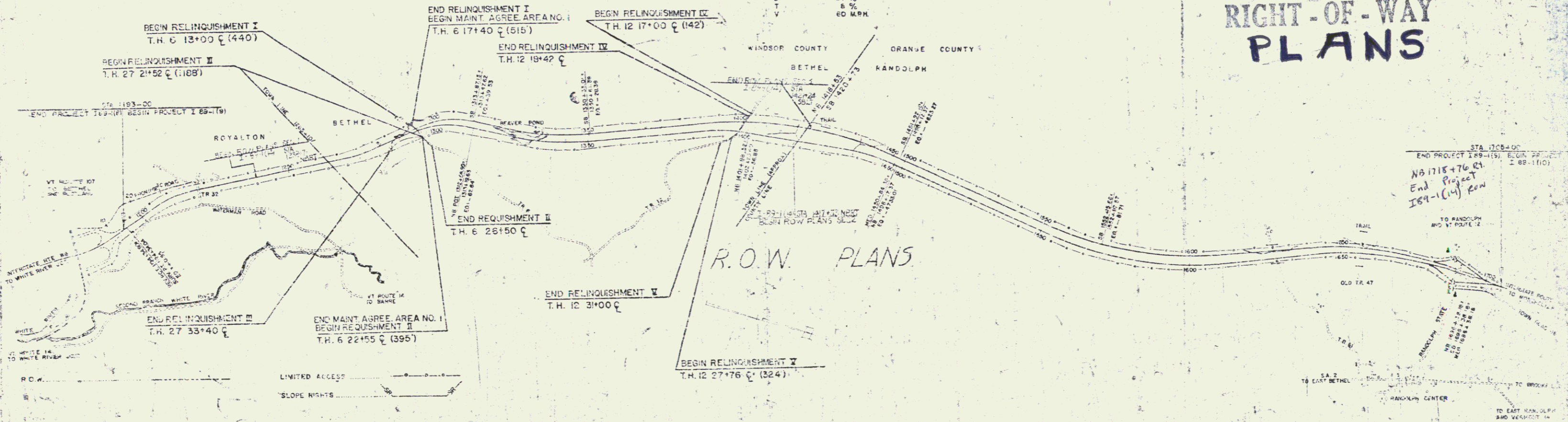

THESE PLANS ARE SUBJECT TO SUCH REVISIONS AS MAY BE REQUIRED BY THE BUREAU OF PUBLIC ROADS OR THE COMMISSIONER OF HIGHWAYS.

CONSTRUCTION IS TO BE CARRIED ON IN ACCORDANCE WITH THESE PLANS AND THE STANDARD SPECIFICATIONS FOR BRIDGE AND BRIDGE CONSTRUCTION, DATED APRIL 1964, AS APPROVED BY THE BUREAU OF PUBLIC ROADS ON OCTOBER 12, 1964, INCLUDING ALL SUBSEQUENT APPROVED REVISIONS AND SUCH REVISED SPECIFICATIONS, THE SPECIAL PROVISIONS AS ARE INDICATED IN THESE PLANS.

MP 22-15-31.42

*Checked 11/27/2000 by J.L. Lewis*

*R.H. Carroll 4/14/65* *C. Bishop 4/15/65* *Burdman 4/15/65* *J. Chubb 4/19/65* *H.M. Lane 4/15/65* *Al. Bunker 4/15/65*

Row Plan I 89-1(14) Sec I 1