

PROPERTY LINE FENCE w/  
STEEL POSTS, ITEM 503-II Mod.  
Ramp A' 12°00' - 16°42' Rt  
Ramp B' 11°00' - 11°00' Lt  
Ramp D' 0°00' - 5°00' Lt  
SB 1191°05' - 1193°00' Lt  
NB 1189°26' - 1193°00' Rt

\* GRANITE SLOPE EDGING  
ITEM 356-A  
Ramp C' 9°00' - 12°11'3" Rt  
Ramp D' 4°3'5" - 7°50' Rt

\* THDPE CABLE GUARD RAIL w/  
4.64" STEEL POSTS, ITEM 538  
Ramp C' 10°55' - 12°17' Rt  
Ramp B' 2°16' - 7°15' Lt  
Ramp A' 12°00' - 19°72' Rt  
SB 1183°00' - 1183°50' Lt  
SB 1191°40' - 1193°00' Lt

\* TREATED TIMBER  
CURB, ITEM 535  
Ramp A' 12°00' - 19°72' Rt  
SB 1192°00' - 1193°00' Lt  
SB 1183°00' - 1183°50' Lt  
STONE FILL FOR SLOPE  
PROTECTION, ITEM 512  
NB 1190°50' - 1193°00' Rt

JUTE MATTING  
ITEM 1023  
\* Ramp A' 12°00' - 12°56' Lt  
\* Ramp A' 13°00' - 15°00' Lt  
\* Ramp B' 5°00' - 6°50' Lt  
\* Ramp D' 3°00' - 4°00' Lt  
\* Ramp C' 11°00' - 11°50' Rt  
\* Med 1183°00' - 1193°00'  
SB 1185°35' - 1186°50' Lt

\* BITUMINOUS CONCRETE SURFACE  
FOR GUTTERS AND TRAFFIC ISLANDS

RAMP C' 10°50' Rt CURB DRAIN  
SB 1192°00' Lt CURB DRAIN

GRAVEL BACKFILL FOR SLOPE STABILIZATION  
ITEM 222-A  
RAMP C' 9°00' - 10°50' Rt

SUB-BASE OF SAND, ITEM 202  
RAMP C' 9°00' - 10°50'  
RAMP D' 1°50' - 5°00'

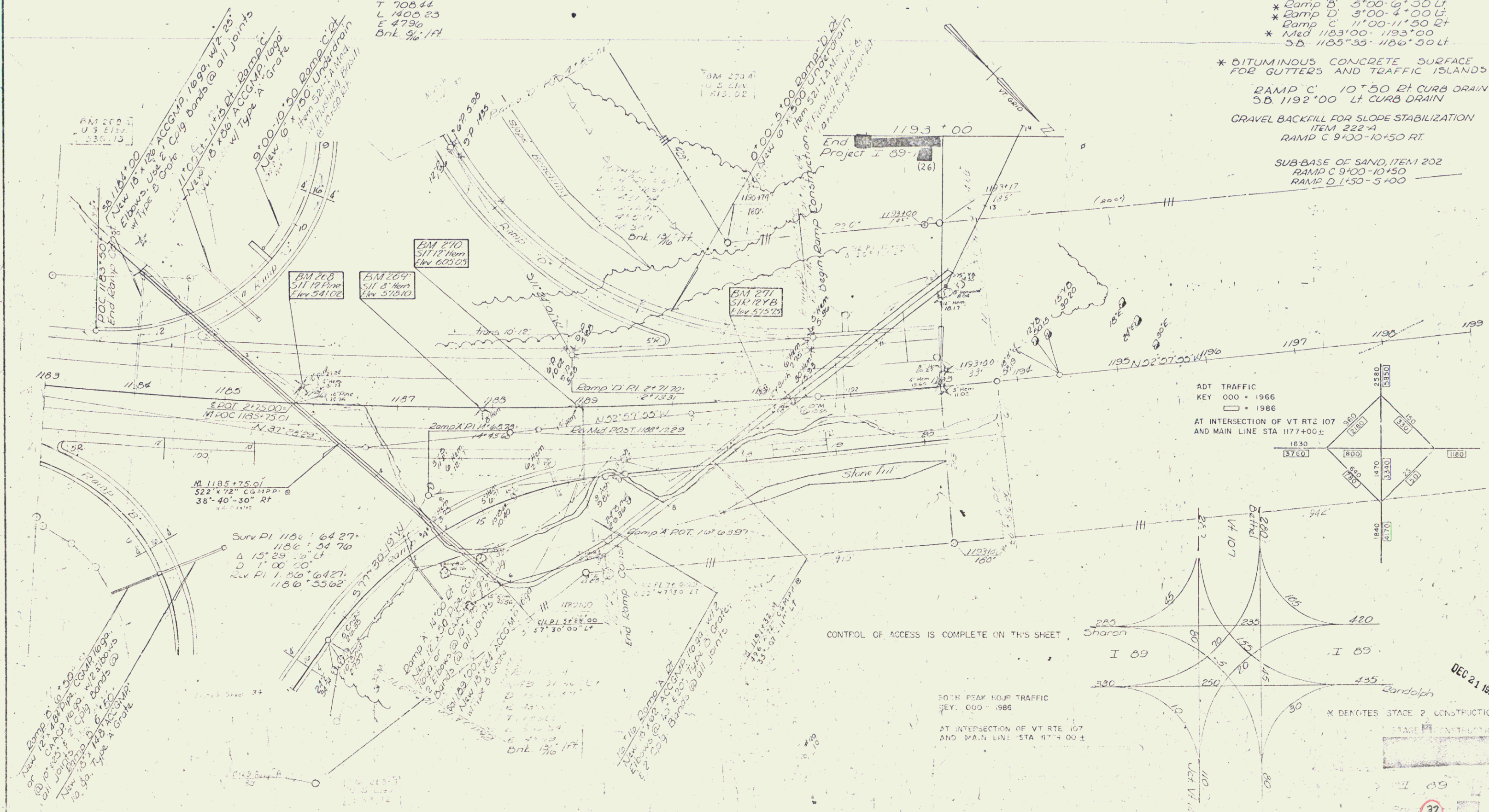

ADT TRAFFIC  
KEY 000 = 1966  
    = 1986  
AT INTERSECTION OF VT RTE 107  
AND MAIN LINE STA 1177+00 ±

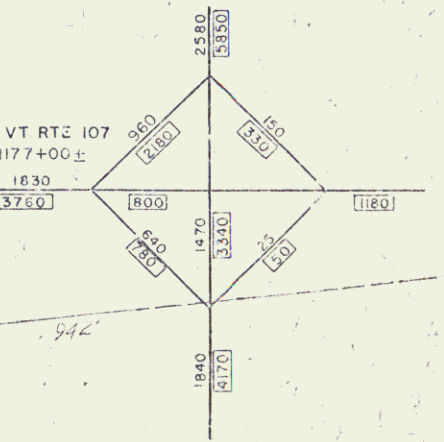

CONTROL OF ACCESS IS COMPLETE ON THIS SHEET

50TH PEAK HOUR TRAFFIC  
KEY: 000 = 1986  
AT INTERSECTION OF VT RTE 107  
AND MAIN LINE STA 1177+00 ±

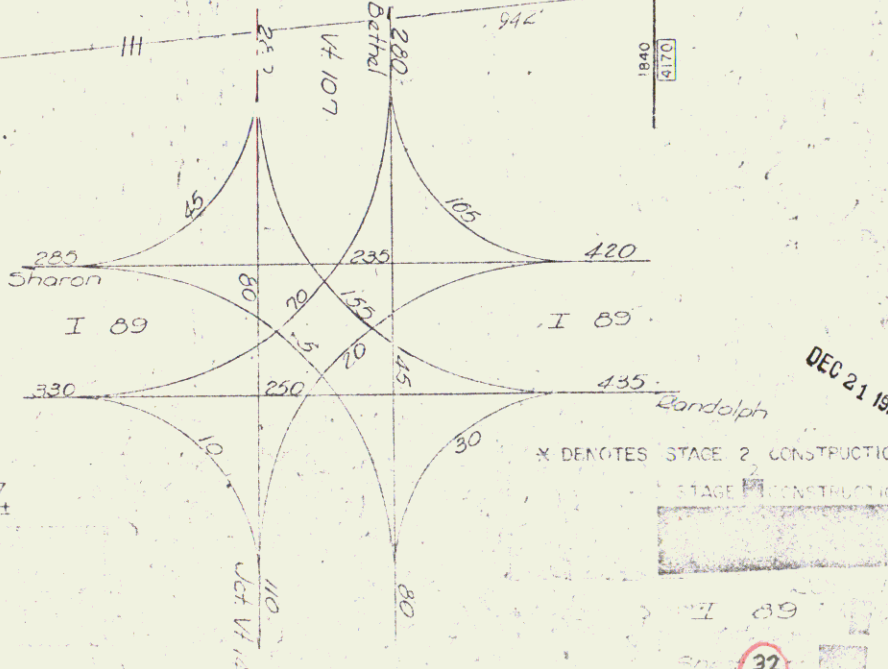

DEC 21 1978

\* DENOTES STAGE 2 CONSTRUCTION

Sheet 22