

\* THREE CABLE GUARD RAIL WITH LIGHT STEEL POSTS ITEM 538  
 NB 847+00-850+00 LF

GRAVEL BACKFILL, ITEM 222-A  
 SB 847+00-848+00 LF

DRILLING & BLASTING of SOLID ROCK SUBGRADE, ITEM 115  
 SB 860+00-862+50  
 NB 860+50-861+50

\* STD STEEL BEAM GUARD RAIL, ITEM 545-A  
 SB 862+90-863+00 LF

PROPERTY LINE FENCE w/ STEEL POSTS  
 ITEM 503-L  
 SB 847+00-863+00 LF  
 NB 847+00-863+00 LF

Note: Property Line Fence @ 847+00-863+00 LF to be constructed prior to commencement of other work in this area

4" SUB-BASE OF SAND  
 ITEM 202  
 SB 862+00-862+50  
 NB 862+00-862+50  
 NB 861+00-862+00

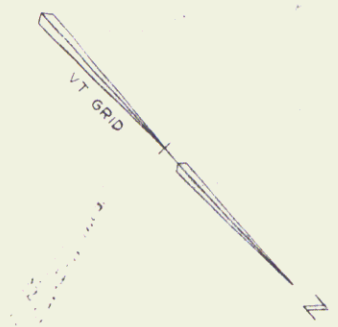
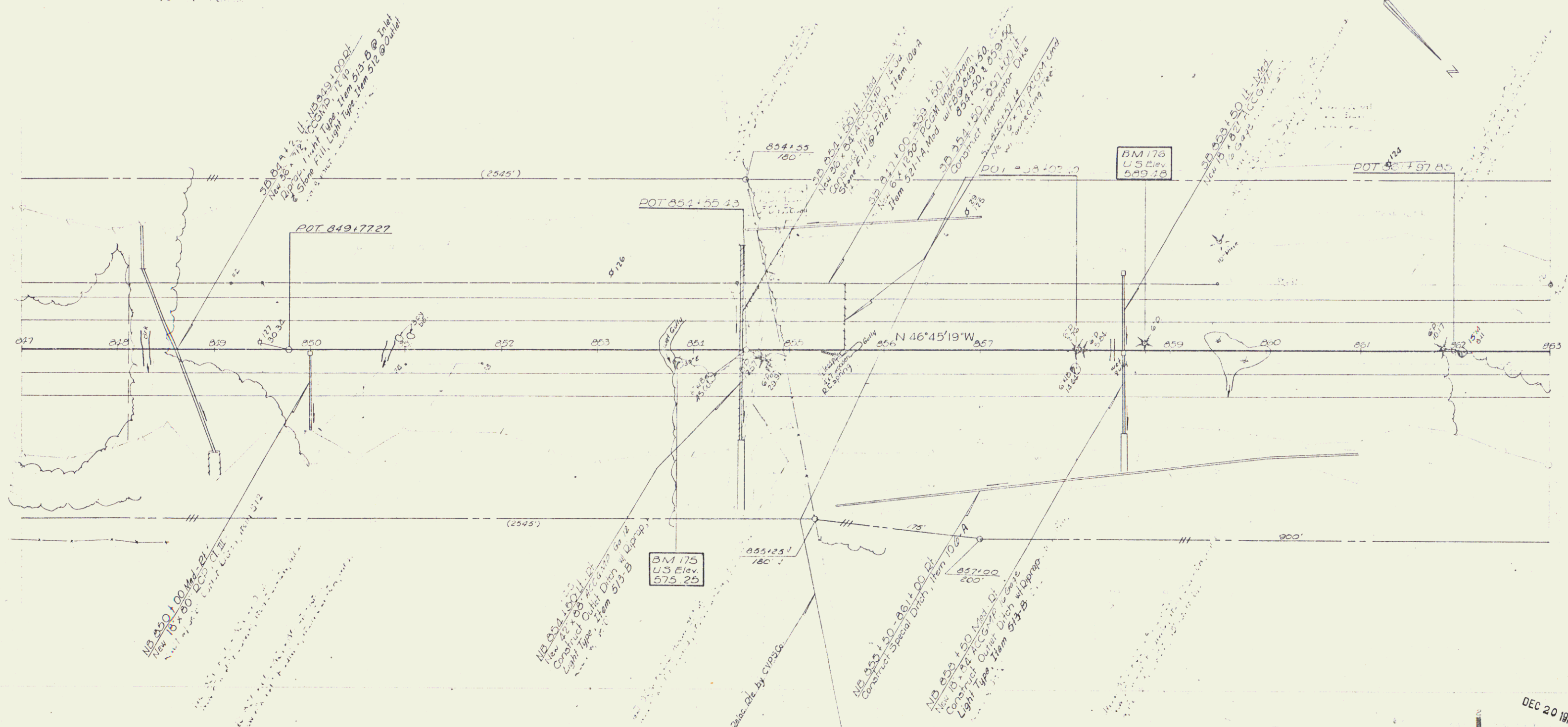

CONTROL OF ACCESS IS COMPLETE ON THIS SHEET

DEC 20 1973  
 SHARON ROYALTON  
 SURVEYED BY Spaulding DATE 1-63  
 DRAWN BY DATE  
 TRACED BY WJ DATE 3-63  
 PROJ. I NO. 89-1 (26)  
 SHEET 38 OF 280 153  
 Sheet PON

78