

DEMOLITION AND DISPOSAL
ITEM 529
1178+00 RT

JUTE MATTING, ITEM 323
NRG 1167+00-1169+00

THREE CABLE GUARD RAIL
W/ STEEL POSTS, ITEM 542
NB 1167+00-1168+48 RT
SB 1167+00-1168+48 LT
NB 1168+00-1168+53
NB 1176+10-1178+50
NB 1178+10-1178+50 RT
SB 1178+10-1183+00 LT

BRUMINOLS CONCRETE
CURB, ITEM 555
NB 1167+00-1168+48 RT
SB 1167+00-1168+48 LT
NB 1176+10-1182+90 RT Connect to Ramp B
SB 1178+10-1183+00 LT
PROPERTY LINE FENCE w/
STEEL POSTS, ITEM 543-TL
NB 1167+00-50 FT 1168+50
1178+00-1183+00 NB (Connects to Ramp
B, 4' 3.15 FT.)
1178+00-1183+00 SB LT

GRANITE SLOPE
EDGING, ITEM 530-A
NB 1162+25-1163+00 RT

STONE FILL FOR
SLOPE PROTECTION
ITEM 522
SB 1167+00-1169+00 LT

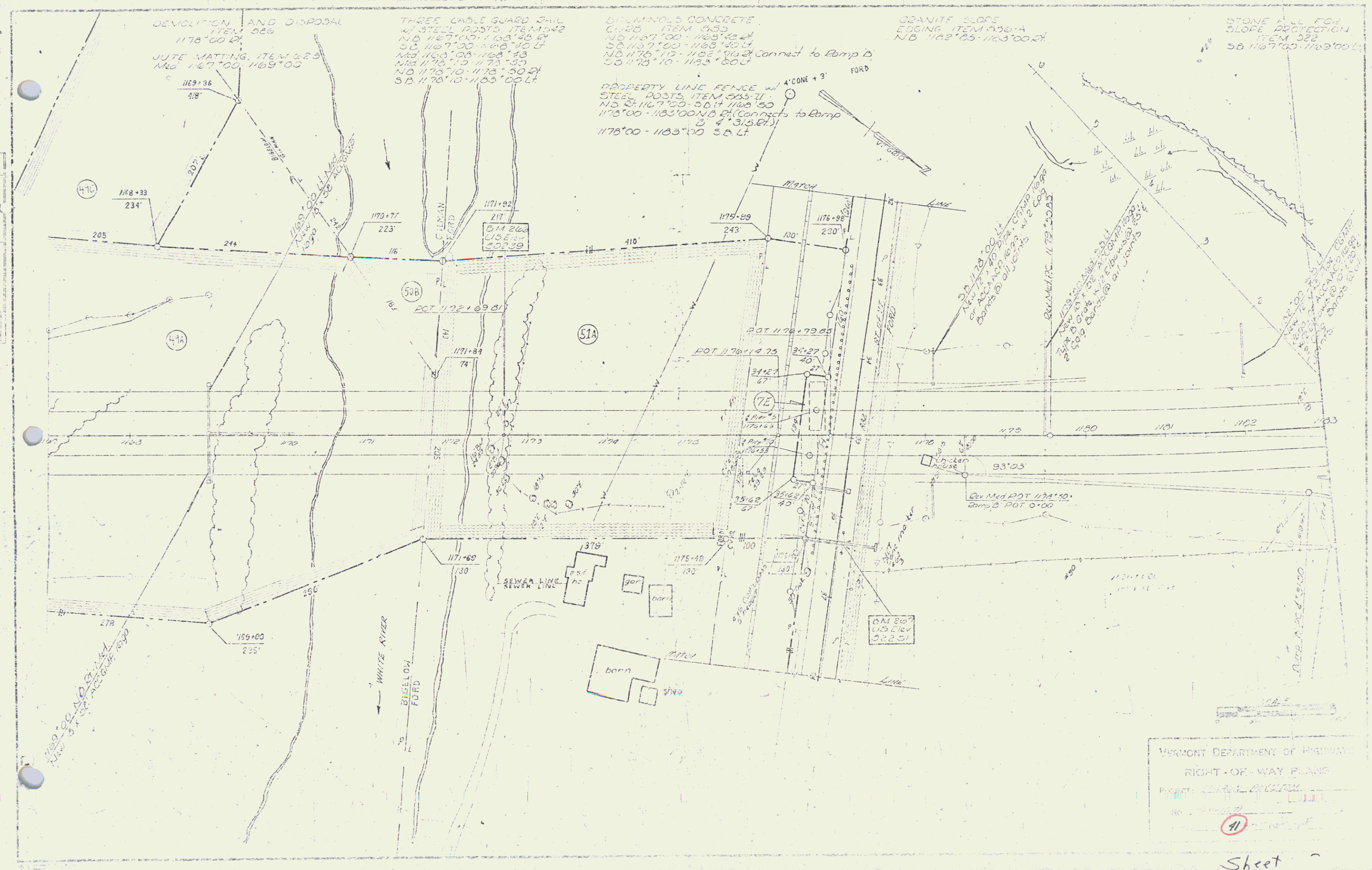

VERMONT DEPARTMENT OF HIGHWAYS
RIGHT-OF-WAY PLANS
PROJECT: State Route 100
No. 100-100
41

Sheet 2

55