

PROPERTY LINE FENCE w/
STEEL POSTS, ITEM 503-II
SB 1151'00"-1167'00" Lt
NB 1151'00"-1167'00" Rt

THREE CABLE GUARD RAIL
w/ STEEL POSTS, ITEM 512
NB 1151'00"-1151'72" Rt
NB 1152'70"-1154'62" Rt
NB 1150'72"-1167'00" Rt
SB 1164'00"-1167'00" Lt

JUTE MATTING
ITEM 623
1151'00"-1167'00" Mid
NB 1161'00"-1161'50" Rt
RIPRAID (LIGHT TYPE)
ITEM 513-B
NB 1161'00" Rt

STONE FILL FOR SLOPE
PROTECTION, ITEM 512
NB 1153'50"-1154'40" Rt
SB 1163'50"-1167'00" Lt

BITUMINOUS CONCRETE
CURB, ITEM 505
NB 1161'50"-1167'00" Rt
SB 1164'00"-1167'00" Lt

Construct Drives for Cattle Pass
1164+50 Rt & Lt

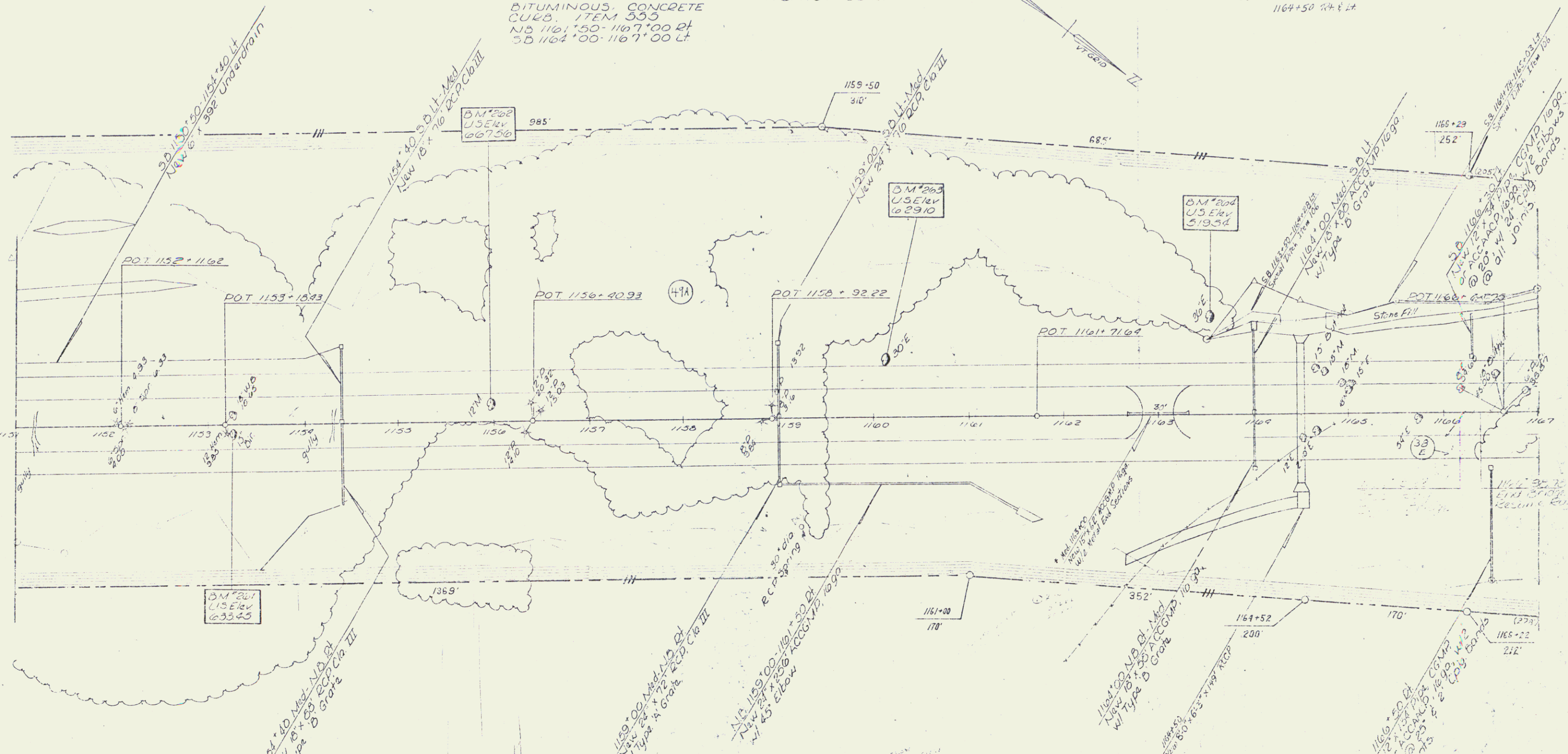

VERMONT DEPARTMENT OF HIGHWAYS
RIGHT-OF-WAY PLANS
PROJECT: SHARON-ROYALTON
No. 688-1117
SHEET 39 OF 45



Sheet