

BITUMINOUS CONC. GUTTER
ITEM 554
SB 1124+55 U

BIT. CONC. CURB
ITEM 555
SB 1124+55 - 1126+00 U

THREE CABLE GUARD RAIL w/
STEEL POSTS, ITEM 512
SB 1124+40 - 1126+00 U

PROJ. 89-08
NB # 5B 1126+00
End Contract 4 Begin Contract 5

TH#6
D 110+66.00
10+64.75

TH#6
Δ 12'28"10" L
D 11
E 432.40
T 155.48
L 511.74
E 0.52
bank 1/2 per ft.

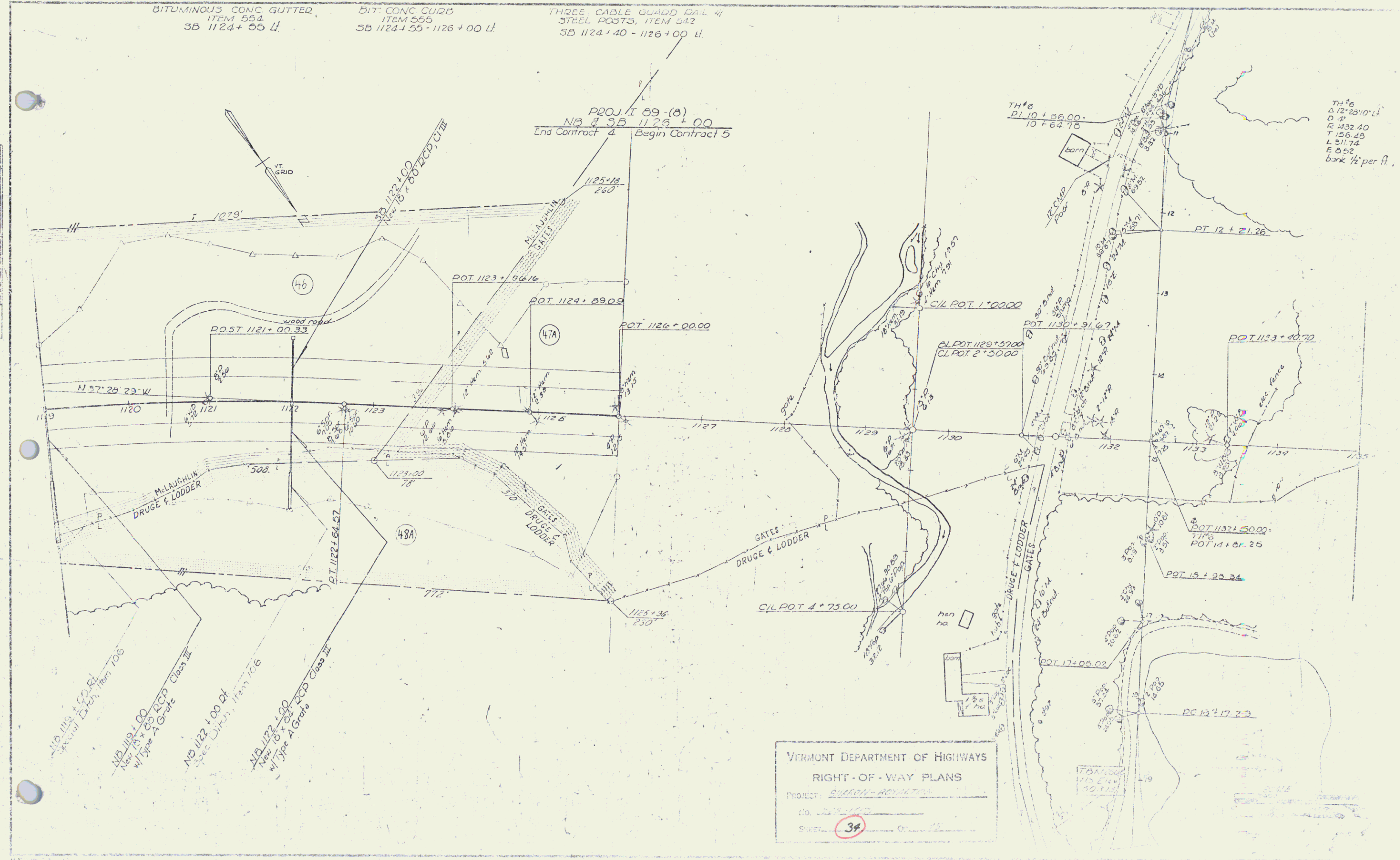

VERMONT DEPARTMENT OF HIGHWAYS
RIGHT-OF-WAY PLANS
Project: SUMNER-ROULTON
No. 22-112
Sheet 34

Sheet