

JUTE MATTING, ITEM 623  
 SB 1062+00 - 1063+00  
 SB 1065+50 - 1066+75 Lt.  
 Med 1067+00 - 1068+50  
 Med 1070+00 - 1071+50

PROPERTY LINE FENCE WITH  
 STEEL POSTS, ITEM 583-II  
 NB 1055+00 - 1065+00 Dt.  
 SB 1060+00 - 1065+00 Lt.

CHANNEL EXCAVATION, ITEM 108  
 SB 1068+30 - 1071+00 Lt.

DRILLING & BLASTING OF SOLID  
 ROCK, SUBGRADE, ITEM 115  
 1055+00 - 1061+25

STANDARD STEEL BEAM GUARD RAIL  
 WITH STEEL POSTS, ITEM 525-A  
 SB 1055+15 - 1055+43 Lt.

BITUMINOUS CONCRETE CURB  
 ITEM 555  
 NB 1055+10 - 1067+13 Dt.

THREE CABLE GUARD RAIL WITH STEEL POSTS  
 ITEM 522  
 NB 1055+00 - 1057+16 Lt.  
 SB 1062+54 - 1071+00 Lt.  
 SB 1055+00 - 1069+35 Lt.  
 NB 1065+75 - 1071+00 Dt.

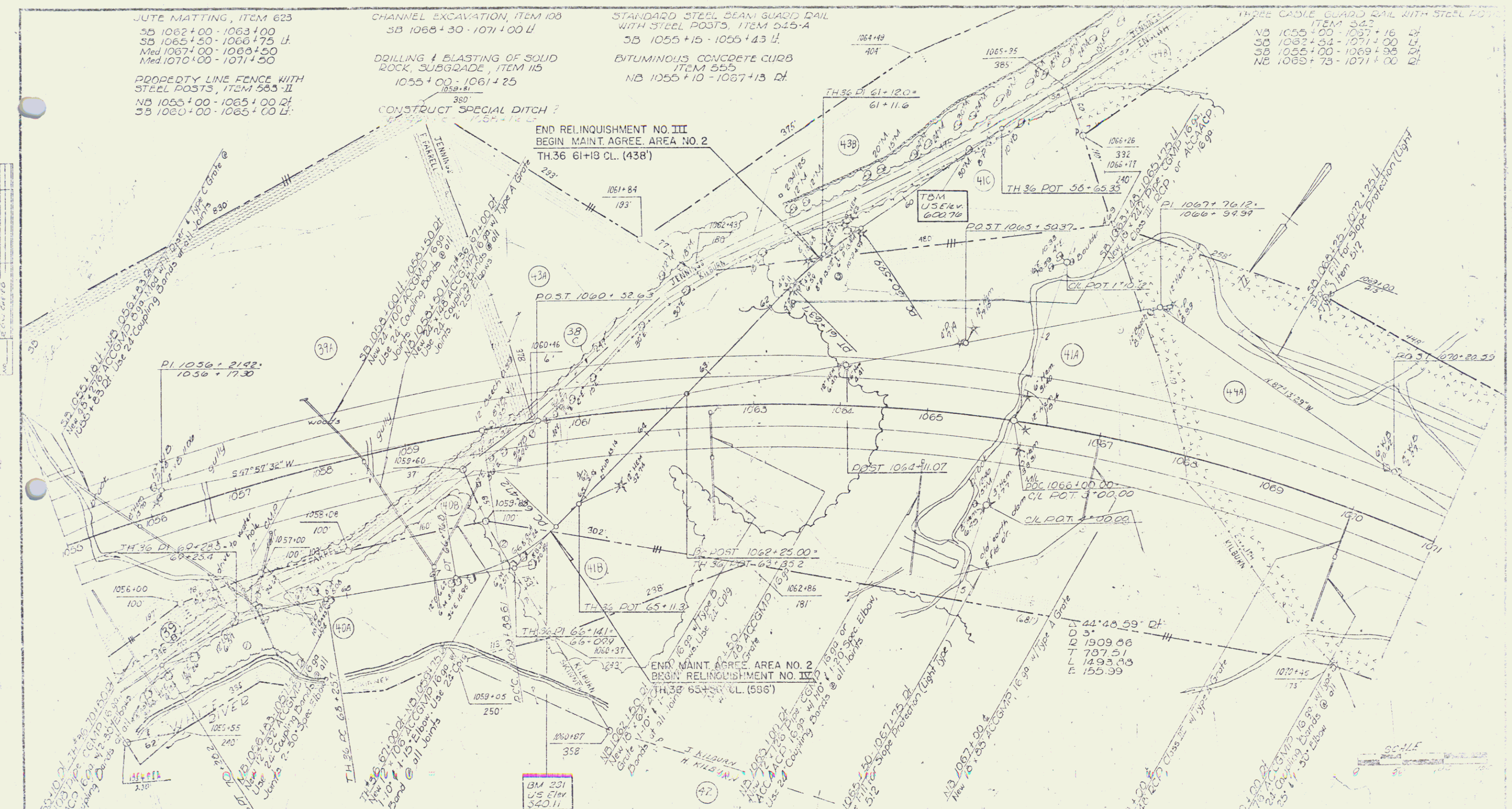

M/L

Δ	12° 48' 12" Rt.
D	2
R	2064.19
T	571.31
L	758.50
E	23.95

TH 36 D

Δ	21° 13' 30" Lt.
D	12
R	477.5
T	102.8
L	202.5
E	10.9

TH 35 C

Δ	55° 00' 00" Rt.
D	27
R	212.2
T	66.7
L	129.6
E	10.3

TH 35 B

Δ	10° 23' 00" Lt.
D	10
R	573.0
T	521
L	103.8
E	2.4

M/L

Δ	44° 45' 59" Rt.
D	3
R	1309.86
T	787.51
L	1993.88
E	155.99

BM 251  
 U.S. Elev.  
 340.11

VERMONT DEPARTMENT OF HIGHWAYS  
 RIGHT-OF-WAY PLANS

PROJECT: *SHARON RD. 101*

No. *300-111*

SHEET 28 OF *2*