

DRILLING & BLASTING OF SOLID ROCK  
SUBGRADE, ITEM 115  
SB 963+50 - 965+40  
NB 970+25 - 975+00

PROPERTY LINE FENCE w/STEEL POSTS  
ITEM 563-II  
SB 965+00 - 975+00 LT  
NB 966+00 - 975+00 RT

JUTE MATTING - ITEM 623  
Med 959+00 - 960+50  
SB 966+60 - 969+32 LT

STONE FILL (LIGHT TYPE)  
ITEM 512  
NB 959+00 - 959+05 RT

BITUMINOUS CONCRETE GUTTER  
ITEM 554  
NB 965+40 RT

BITUMINOUS CONCRETE CURB  
ITEM 555  
NB 959+00 - 959+60 RT  
NB 965+40 - 967+50 RT  
NB 974+25 - 975+00 RT

PLAIN GUARD RAIL  
ITEM 510  
SB 967+65 - 967+81 LT

STEEL BEAM GUARD RAIL w/  
STEEL POSTS, ITEM 522  
NB 959+00 - 959+60 RT  
NB 965+40 - 970+27 RT  
NB 973+80 - 975+00 RT

STANDARD STEEL BEAM GUARD RAIL  
w/STEEL POSTS, ITEM 545-A  
SB 966+70 - 967+23 LT

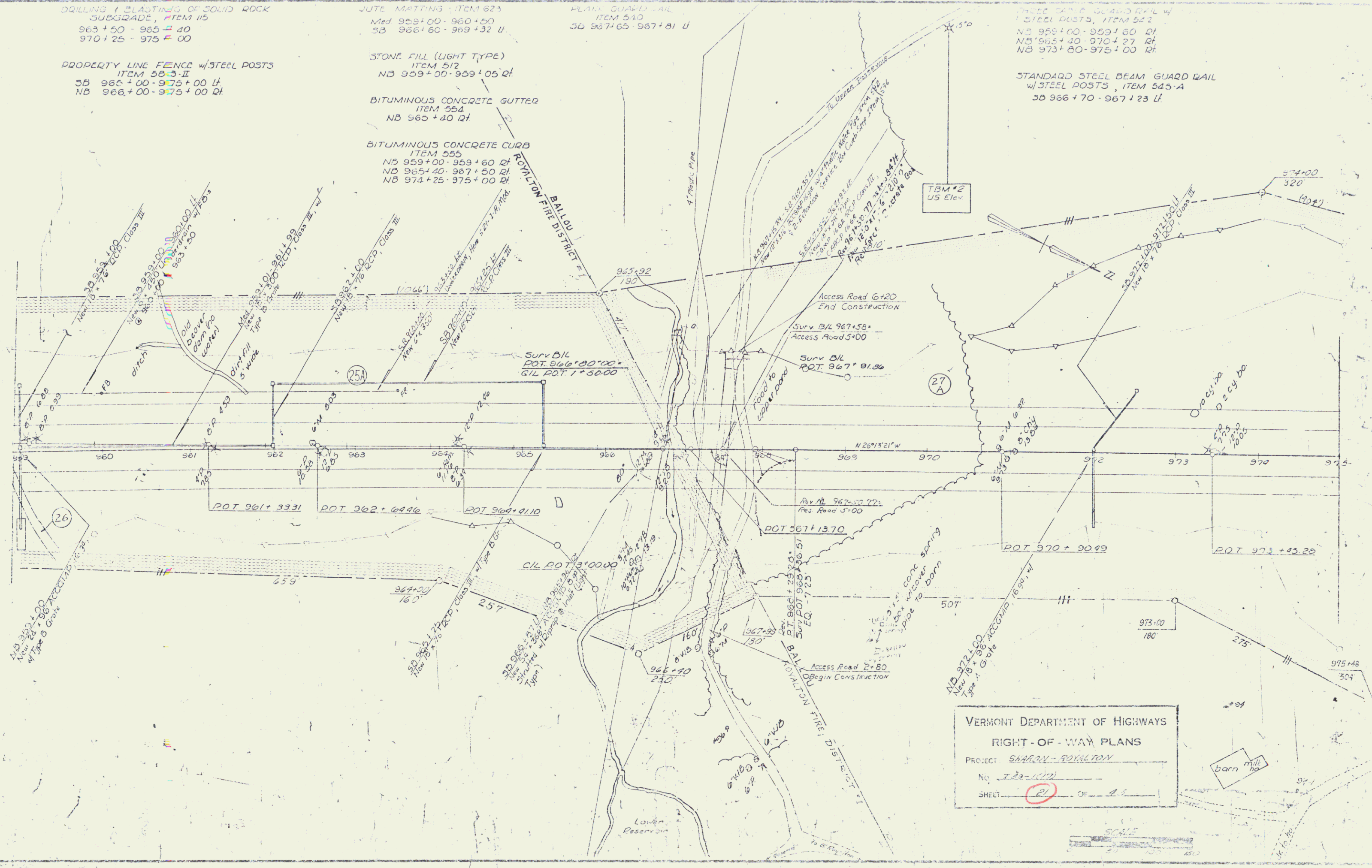

VERMONT DEPARTMENT OF HIGHWAYS  
RIGHT-OF-WAY PLANS  
PROJECT: SHARON-ROYALTON  
No. 122-1(12)  
SHEET 21 OF 21