

DRILLING & BLASTING OF SOLID ROCK SUBGRADE ITEM 115 N.B. 767+00 - 767+55

THREE CABLE GUARD RAIL W/STEEL POSTS, ITEM 542 N.B. 767+35 - 767+75 Rt. N.B. 767+00 - 767+83 Lt.

THREE CABLE GUARD RAIL W/STEEL POSTS, ITEM 542 SB 775+60 - 777+60 Lt. SB 775+75 - 776+50 Lt.

DUMMINS CONCRETE CURB ITEM 555 NB 776+15 - 777+91 Of SB 776+60 - 777+50 Lt.

PROPERTY LINE FENCE W/STEEL POSTS ITEM 533-II SB 772+50 - 781+00 Lt. SB 782+50 - 783+00 Lt. NB 775+50 - 782+00 Rt. SB 787+00 - 787+35 Lt. NB 787+00 - 788+10 Rt.

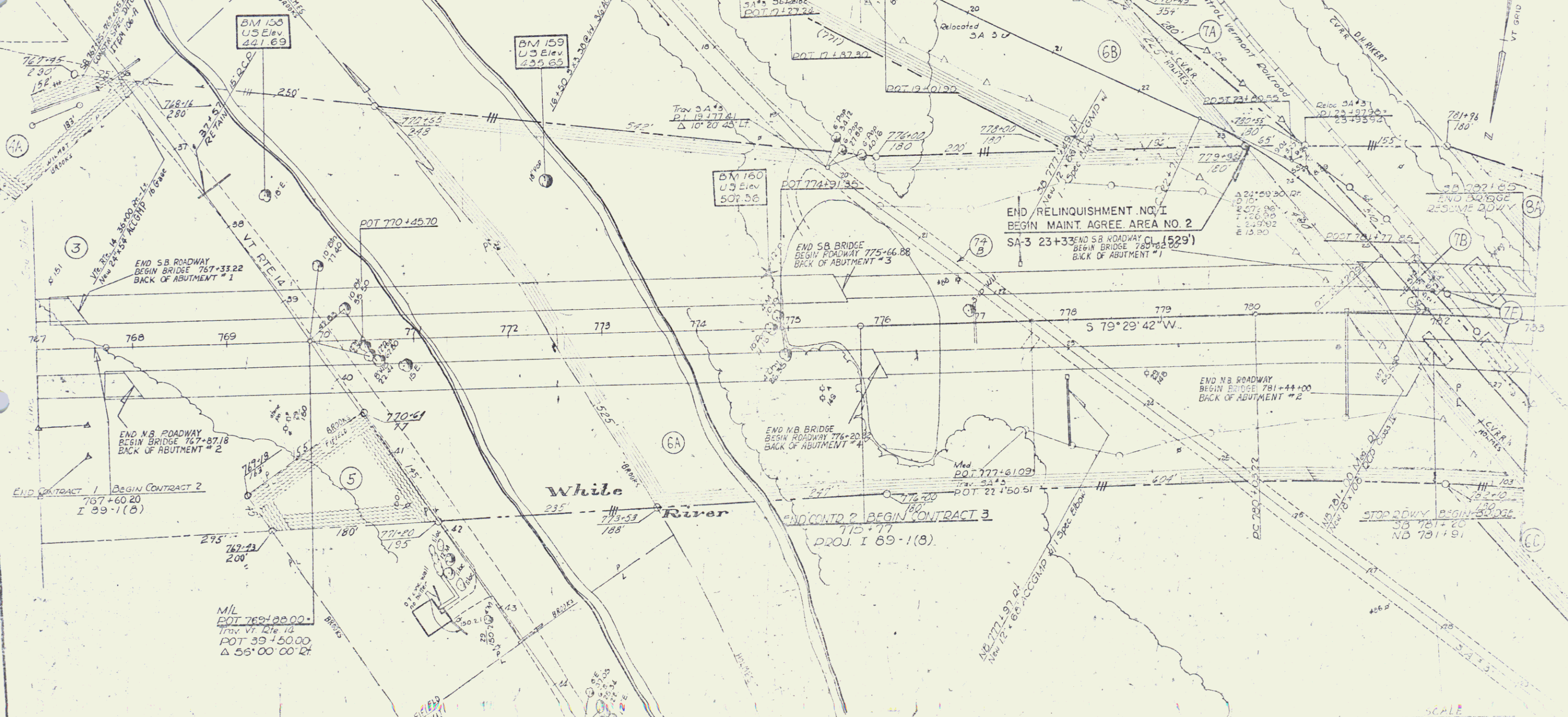

SCALE
VERMONT DEPARTMENT OF HIGHWAYS
RIGHT OF WAY
Project: State Route 102
No. 182-1110

STANDARD STEEL BEAM GUARD
ELEVATED, ITEM 545-A
S.D. 767+83 - 767+748