

*SODDING-Item 612
SB 508+00 LT 5 FT.

*THREE CABLE GUARD RAIL-
LIGHT STEEL POSTS ITEM 538
NB 575+00-591+00 LT
SB 575+00-591+00 LT

*BITUMINOUS CONCRETE
CURB ITEM 553 Type II
SB 575+00-591+00

DRILLING & BLASTING OF
SOLID ROCK SUBGRADE ITEM 115
NB 576+750-5778+7500
SB 571+25-579+25

STONE FILL FOR SLOPE
PROTECTION ITEM 519
NB 582+36-582+60 RT
SB 571+25-579+25

BITUMINOUS CONCRETE
GUTTER ITEM 554 MOD.
ML 590+62-590+87

PROPERTY LINE FENCE ITEM 583-II MOD
SD 575+00-591+00 LT
NB 593+00-591+00 RT

JUTE MATTING ITEM 623-
Med 506+12-591+00

CHANNEL EXCAVATION, ITEM 108-A-C
SB 580+00-582+00 RT
NB 582+30 RT-SB 582+36 LT

RIPRAP, ITEM 513-B
SB 581+00-582+15 RT
NB 582+62-582+88 RT

*STAGE II CONSTRUCTION

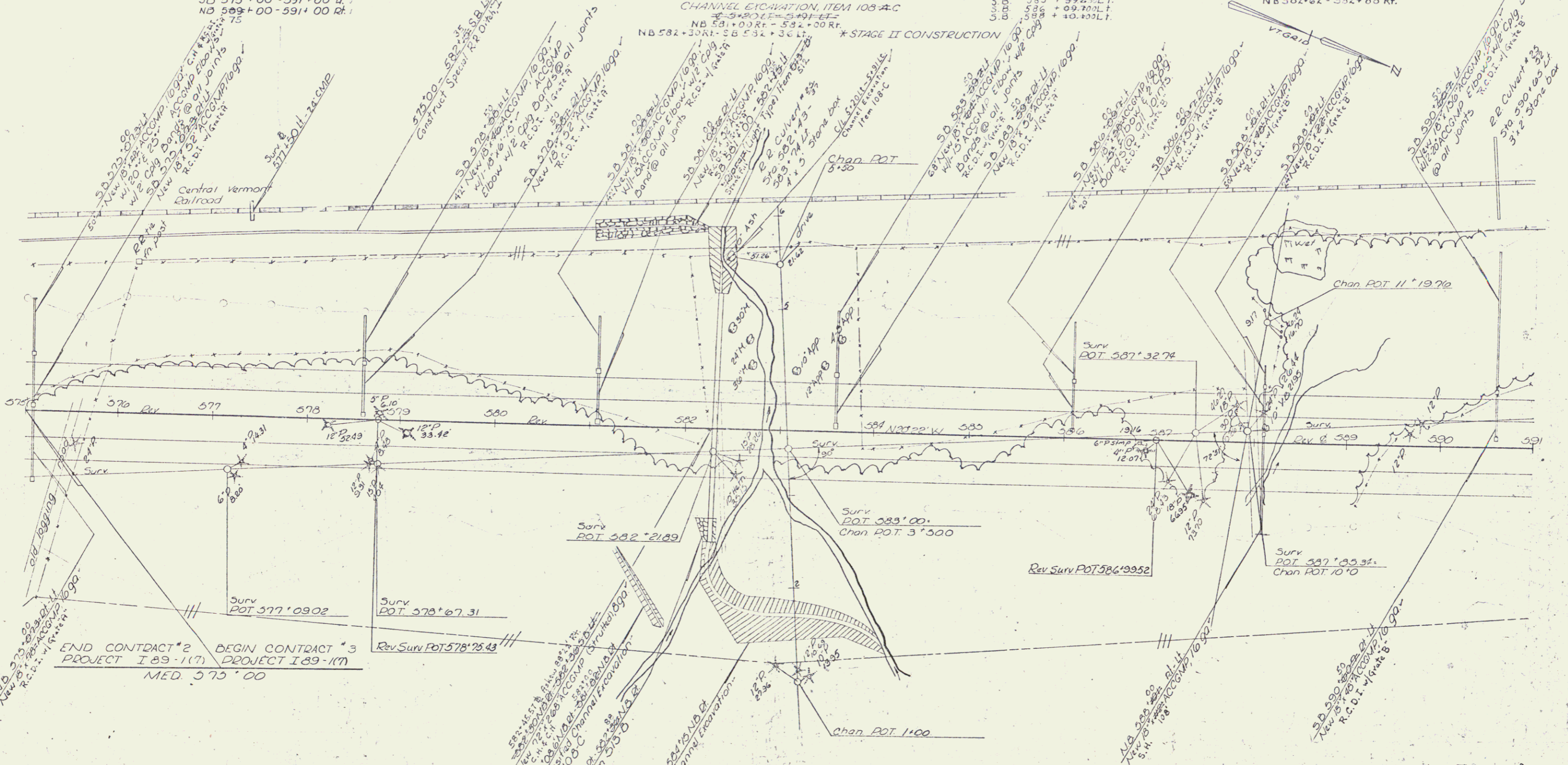

END CONTRACT #2 PROJECT I 89-1(17)
MED. 575+00

TREASURY FINANCIAL CONTROL SECTION
SD 575+00-591+00 LT

STATION	LOCATION	OFFSET	DESCRIPTION
582+36	L.	180'	Concrete

Stage II Construction DEC 19 1973

SURVEYED BY Neuheit DATE 10/22
 DRAWN BY Reichel DATE 10/22
 TRACED BY A. Clark DATE 10/23
 HARTFORD - DEPT. OF CON.
 PROJ. NO. 89-1(17)
 SHEET 18

CONTROL OF ACCESS COMPLETE ON THIS SHEET