

THREE CABLE GUARD RAIL
ITEM 512
NB 591+00-593+72.4
NB 599+06-593+72.4
NB 599+25-607+00.1
NB 602+10-306+02.0
SB 591+00-594+20.4
SB 598+25-606+41.1

BITUMINOUS CONCRETE CURB
ITEM 515, TYPE 1
NB 602+50-606+02.0
SB 591+00-594+20.4

ODD LING / PLATTING OF SOLID
ROCK SUBGRADE, ITEM 115
NB 593+00-600+15
SB 593+75-600+25
SB 605+75-607+00

JUTE MATTING, ITEM 625
Med 594+00-593+12
Med 603+75-607+75

BITUMINOUS CONC GUTTER
ITEM 514
Med 598+10
Med 598+54.8
Med 601+07-601+27
Med 603+43
Med 606+42-606+67

SHEDDAP, ITEM 513-B
NB 603+46.4-606+43.5

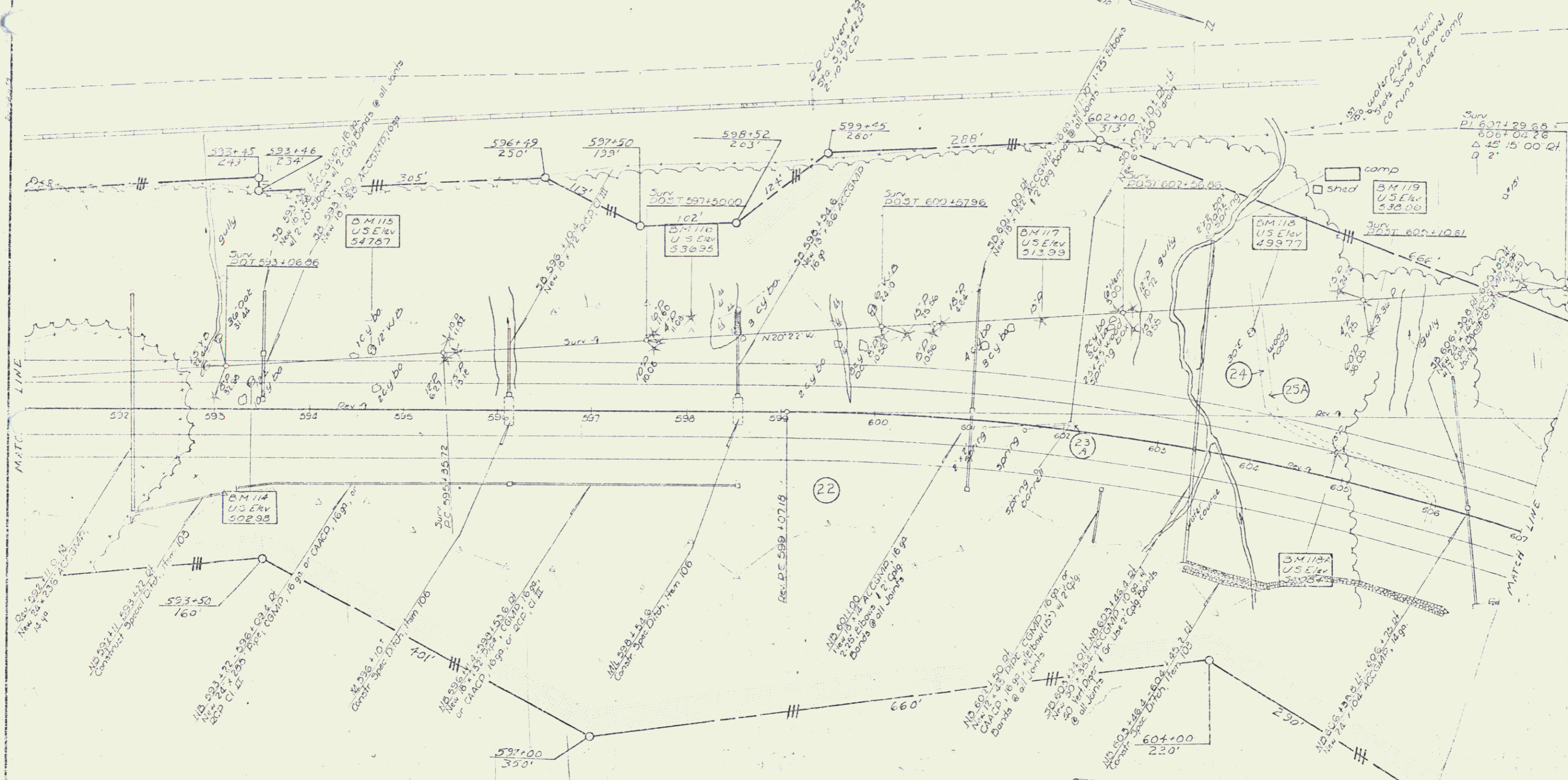

VERMONT DEPARTMENT OF HIGHWAYS
RIGHT-OF-WAY PLANS
PROJECT: HARTFORD - SHARON
NO. E-85-1(16)
SHEET 30 OF 13

SCALE
0' 50' 100' 150'