

THREE CABLE GUARD RAIL
w/ STEEL POSTS, ITEM 542
N.B. 575+00-591+00 LT
N.B. 500+60-584+60 RT
S.B. 575+00-591+00 LT

BITUMINOUS CONCRETE
CURBS, ITEM 553, Type II
S.B. 575+00-591+00

DRILLING & BLASTING OF
SOLID ROCK SUBGRADE, ITEM 115
N.B. 576+75-577+75
JUTE MATTING, ITEM 623
Med. 586+12-591+00

STONE FILL FOR SLOPE
PROTECTION, ITEM 512
N.B. 582+36-582+60 RT

BITUMINOUS CONCRETE
GUTTER, ITEM 554
M/L 590+62-590+87

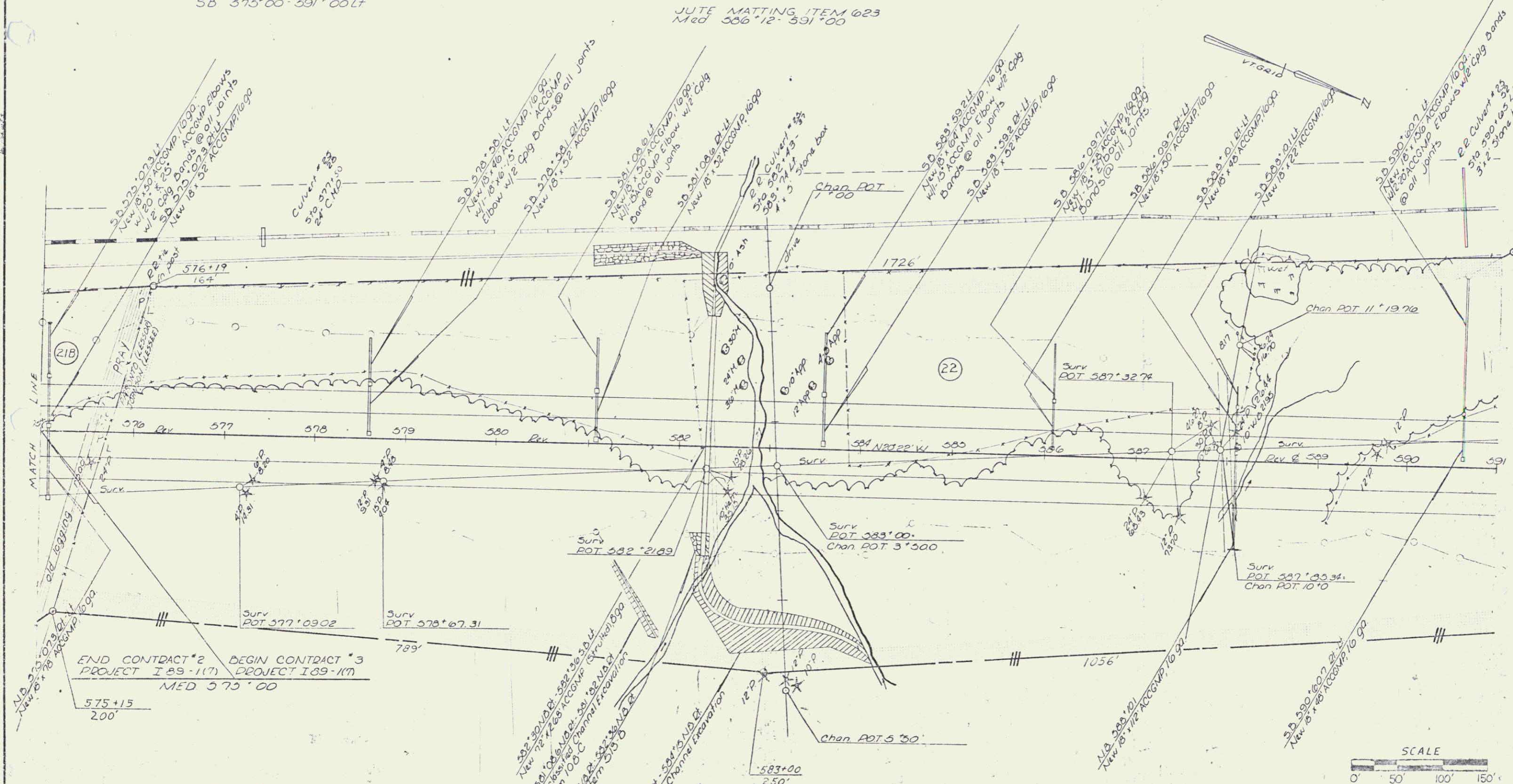

END CONTRACT #2 PROJECT I 89-117
BEGIN CONTRACT #3 PROJECT I 89-117
MED 575+00

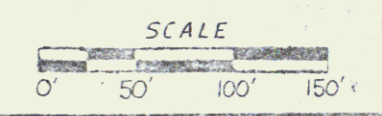

VERMONT DEPARTMENT OF HIGHWAYS
RIGHT-OF-WAY PLANS
PROJECT: HARTFORD - SHARON
NO. I-89-1 (10)
SHEET 29 OF 33