

THREE CABLE GUARD RAIL W.  
STEEL POSTS ITEM 512  
382' ± 54' - 382'00 S.O.L.  
382' ± 20' - 382'00 N.O.L.

CHIEF SURVEYOR ITEM 513-D  
S.B. 382'00 ± 382'04 L.F.

SUBBASE OF SAND  
ITEM 202  
N.B. 381'00 - 383'42

LOW LINE BLASTING OF SOLID  
ROCK SUBGRADE ITEM 115  
N.B. 383'00 - 389'00  
S.B. 382'00 - 388'00

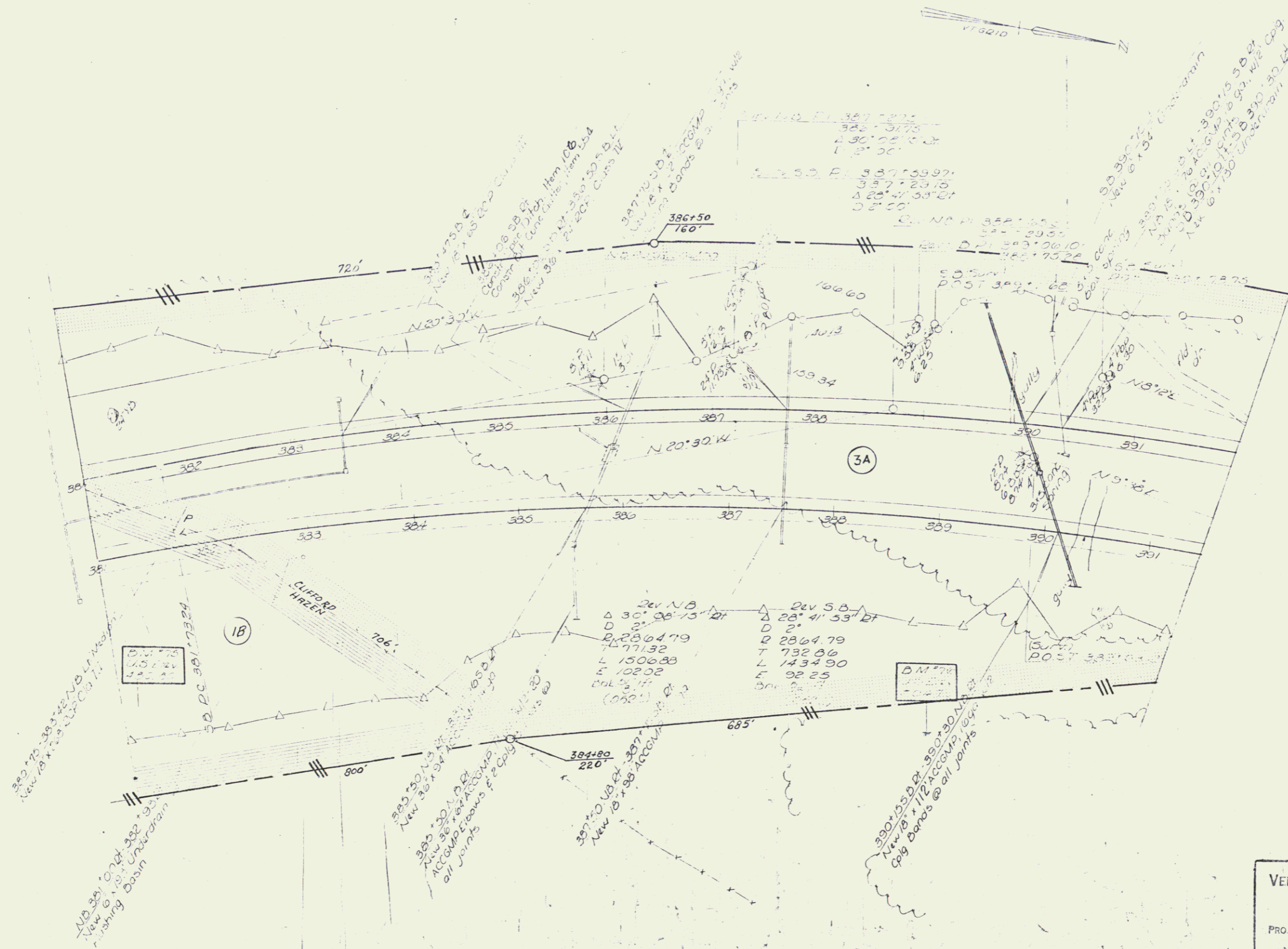

VERMONT DEPARTMENT OF HIGHWAYS  
RIGHT-OF-WAY PLANS  
PROJECT: HARTFORD-SHARON  
NO. 189-1041  
SHEET 15 OF 73