

PLAN	DESIGNED	BY	DATE
PLOTTED	BY		
NOTED	BY		
REVISIONS	NO.	DATE	BY
1			
2			
3			
4			
5			
6			
7			
8			
9			
10			
11			
12			
13			
14			
15			
16			
17			
18			
19			
20			
21			
22			
23			
24			
25			
26			
27			
28			
29			
30			
31			
32			
33			
34			
35			
36			
37			
38			
39			
40			
41			
42			
43			
44			
45			
46			
47			
48			
49			
50			
51			
52			
53			
54			
55			
56			
57			
58			
59			
60			
61			
62			
63			
64			
65			
66			
67			
68			
69			
70			
71			
72			
73			
74			
75			
76			
77			
78			
79			
80			
81			
82			
83			
84			
85			
86			
87			
88			
89			
90			
91			
92			
93			
94			
95			
96			
97			
98			
99			
100			

TWO CABLE GUARD RAIL  
ITEM 541  
T.H. 36 0+15' 2+32' Lt (232)  
T.H. 36 0+30' 4+22' Lt (456)  
T.H. 10 0+80' 3+22' Lt (240)  
T.H. 10 2+80' 5+22' Lt (210)  
T.H. 10 4+00' 5+22' Lt (120)  
Dev. T.H. 10 7+22' 9+22' Lt (174)  
T.H. 36 @ 10 5+87' - 7+35' Rt.

Wood Guide Posts  
T.H. 36 @ 10 4+66' - 5+44' Rt. 6 ea  
T.H. 36 @ 10 7+35' - 7+17' Lt 3 ea

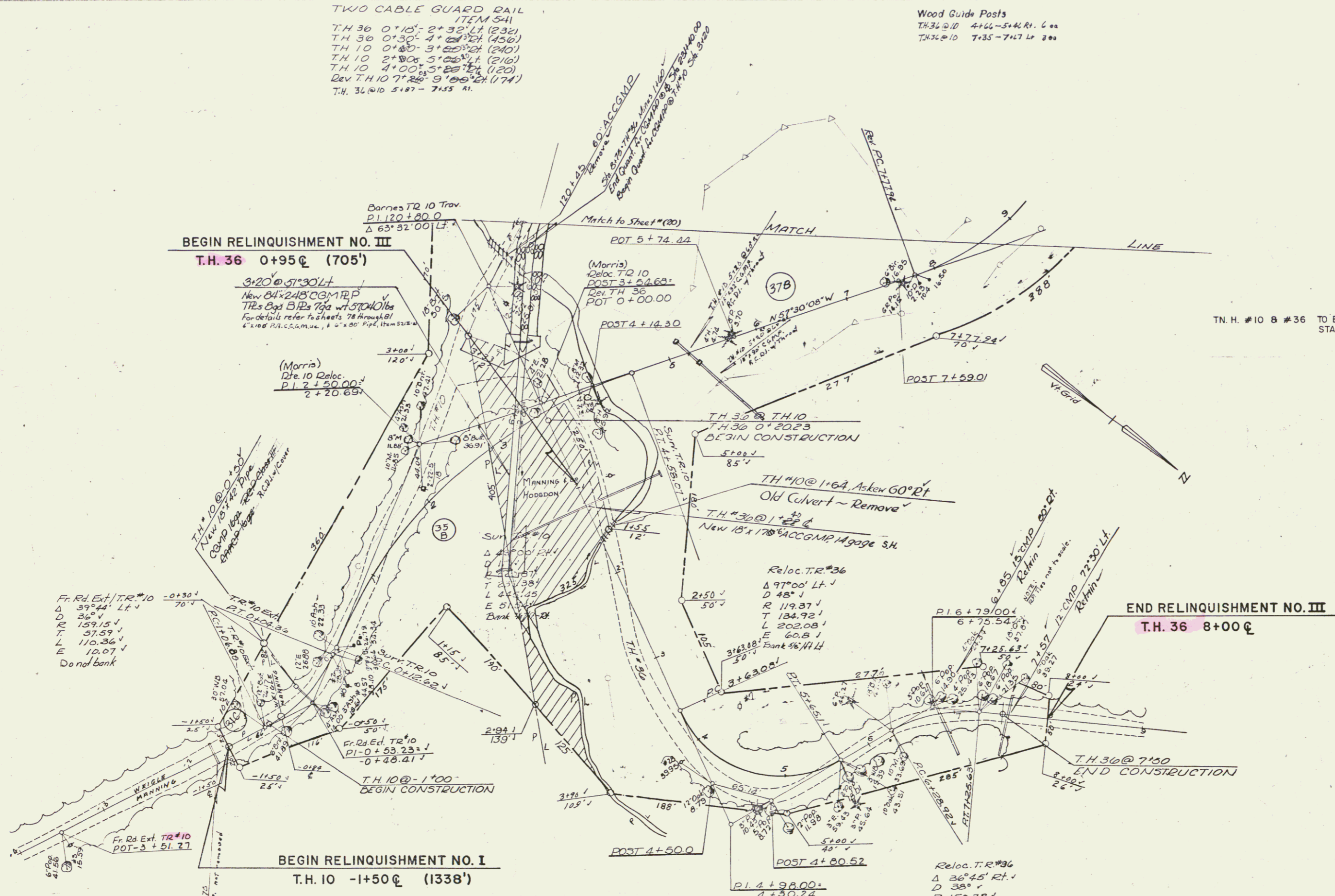

T.N. H. #10 8 #36 TO BE BUILT IN THEIR ENTIRETY DURING STAGE I CONSTRUCTION.

FEB 22 1980

Stage I Construction

Rev. T.H. # 36

HARTFORD

1 89 - 1 (5)

Sheet 22 of 269