

PLAN
 DRAWN BY: [Name]
 CHECKED BY: [Name]
 DATE: 12/20/73

1. Minimum clearance of overhead wires 11' 6" above road surface.

* Standard Steel Beam Guard Rail w/ Bituminous Concrete Curb w/ Steel Foots, Item 345-A
 WB 135+07 - 156+09 Rt
 WB 152+00 - 152+50 Rt
 EB 152+00 - 152+25 Lt

Property Line Fence w/ Steel Posts Mod. Item 883 II
 WB 143+00 - 145+50 Rt

Jute Matting - Item 423
 • Med 158+00 - 158+50
 • Med 159+00 - 159+50
 • Med 159+50 - 161+50
 EB 152+00 - 154+00 Lt

* Three Cable Guard Rail w/ Steel Posts - Item 547
 EB 152+00 - 153+84 Lt
 WB 152+00 - 153+68 Rt
 WB 164+23 - 167+00 Rt

Above Property Line Fence to be installed prior to other work in this area.

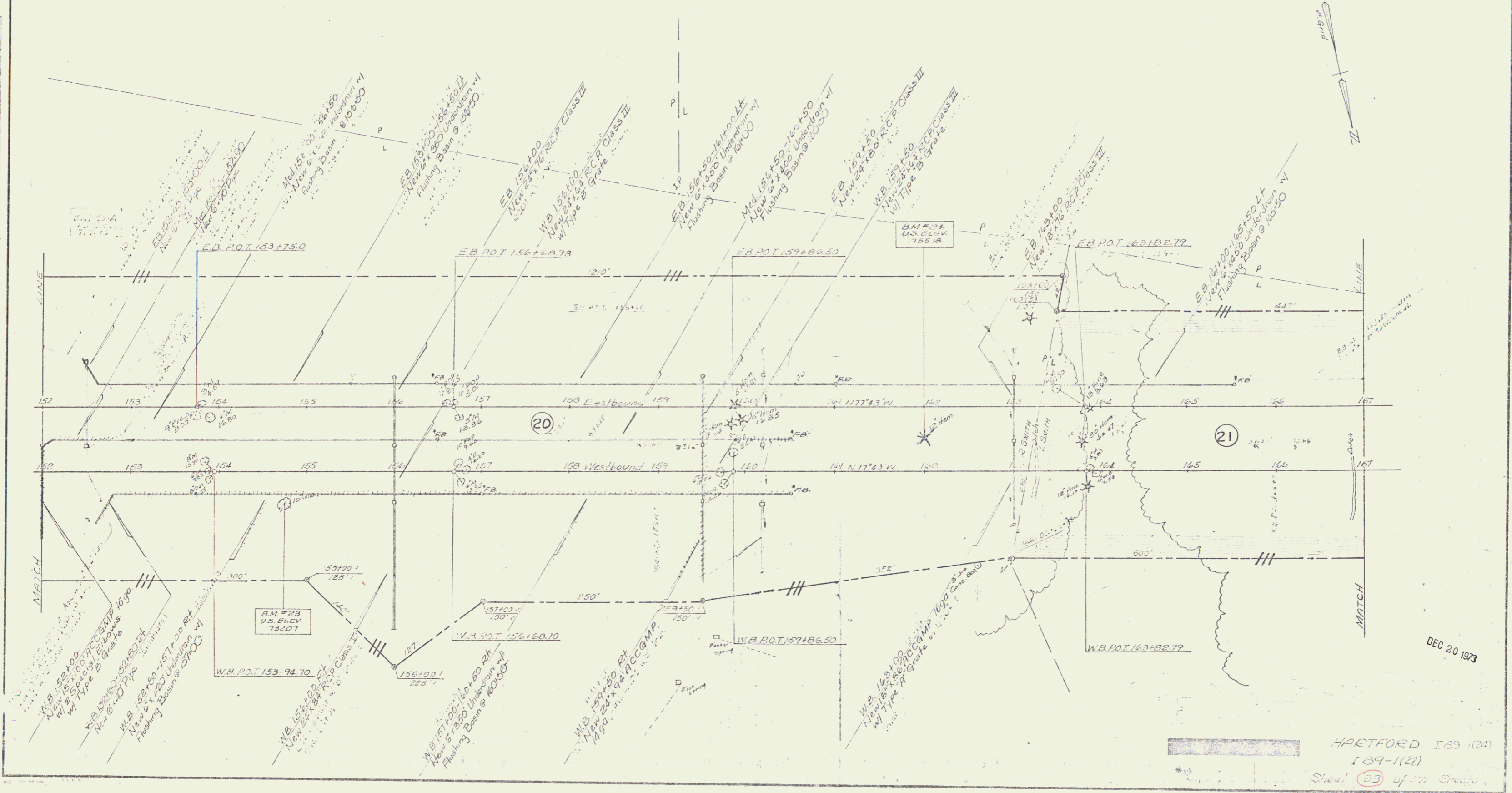

DEC 20 1973

HARTFORD I-89-(24)
 I-89-1(21)
 Sheet 23 of 27 Sheets