

INDEX OF SHEETS

SHEET NO. 1	TITLE PAGE
2	TYPICAL CROSS-SECTION OF IMPROVEMENT—GRADING, DRAINAGE, BASE AND GUARD RAIL, WITH TACK COAT OF REFINED TAR (ITEM 30)
3	BANKING AND WIDENING TABLES
4-12	PLAN AND PROFILE SHEETS
13	DETAILS OF 10' X 4' R.C. BOX—STA. 123+35
14	STANDARD STRUCTURE SHEET S 28—PIPE CULVERTS
15	" " " " S 30—STANDARD UNDERDRAIN & GUARD RAIL
16	" " " " S 40—BARRICADES, SIGNS & LIGHTS
16-A	" " " " S 31—BOUNDARY MARKERS
17-41	CROSS SECTION SHEETS

STATE OF VERMONT
STATE HIGHWAY DEPARTMENT

PLAN AND PROFILE OF PROPOSED
STATE HIGHWAY
FEDERAL AID PROJECT

STANDARD STRUCTURE SHEETS APPROVED
BY THE CHIEF ENGINEER

S 28 JULY 11, 1933
S 30 AUG. 15, 1933
S 31 JULY 25, 1933

FAP 152C

U.S. #2

TOWN OF ALBURG

Pin # 99R005 ALBURG-ROUSES POINT, N.Y. ROAD

BEGINNING AT THE JUNCTION OF ROUTE 104 AND ROUTE U.S. 2
AND EXTENDING WESTERLY 2.253 MILES

LENGTH OF PROJECT: 11,9006 FEET = 2.253 MILES

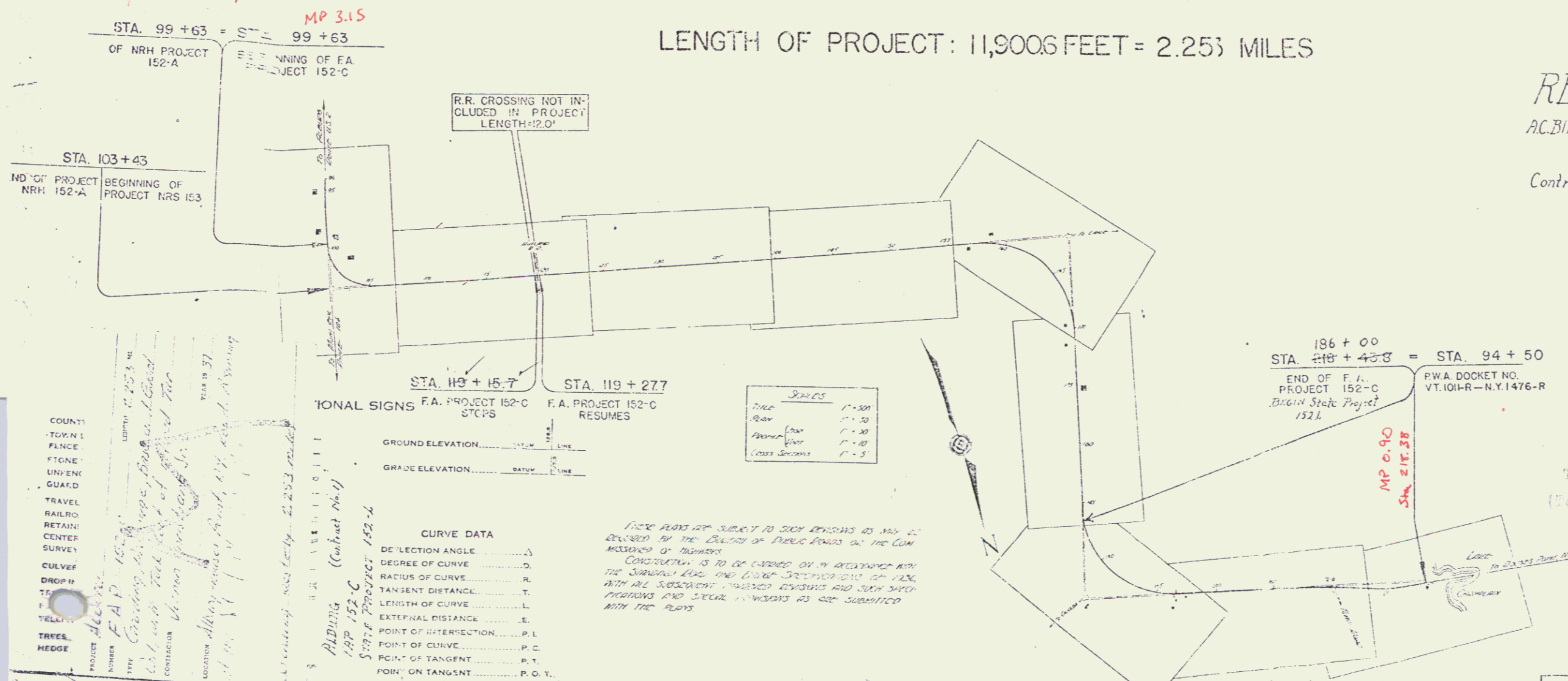
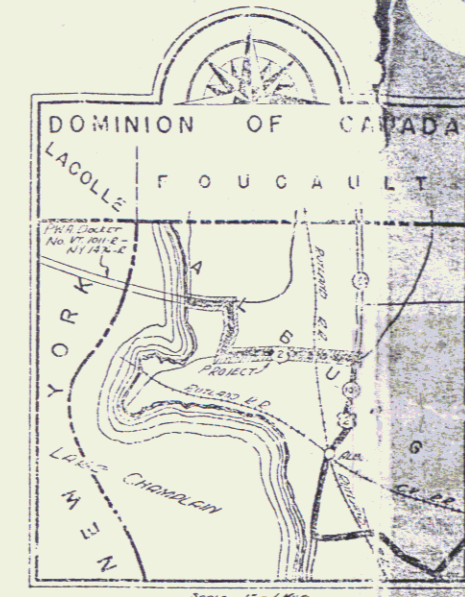

COUNTY: ALBANY
TOWN: ALBURG
FENCE: NONE
STONE: NONE
DRAINAGE: NONE
GUARD: NONE
TRAVEL: NONE
RAILROADS: NONE
RETAIN: NONE
CENTER: NONE
SURVEY: NONE
CULVERT: NONE
DITCH: NONE
DRAIN: NONE
TERRACE: NONE
WALL: NONE
TRAIL: NONE
DRAINAGE: NONE
DITCH: NONE
DRAIN: NONE

CURVE DATA

DEGREES OF CURVE	D
RADIUS OF CURVE	R
TANGENT DISTANCE	T
LENGTH OF CURVE	L
EXTERNAL DISTANCE	E
POINT OF INTERSECTION	P. I.
POINT OF CURVE	P. C.
POINT OF TANGENT	P. T.
POINT ON TANGENT	P. O. T.

These plans are subject to such revisions as may be required by the Board of Public Roads or the Com. Missioners of Highways.
Construction is to be carried out in accordance with the Standard Plans and Specifications of 1926, with the subsequent proposed revisions and such other provisions and special provisions as are submitted with the plans.

RECORD PLAN
AC. BIRNE APRIL 22, 1938

Contractor: Vernon Christiana Jr.
Year 1937

APPROVED: *[Signature]*
COMMISSIONER OF HIGHWAYS

RIGHT-OF-WAY BY APPOINTMENT
TOWN OF ALBURG
PERMANENT
TOWN OF ALBURG
(To be returned to)

RECOMMENDED BY: *[Signature]*
SUPERVISOR OF HIGHWAYS

RECOMMENDED FOR APPROVAL: *[Signature]*
CHIEF ENGINEER

APPROVED: *[Signature]*
RECORD ENGINEER

CORRECT: _____ SERIES FAP NO. 152 SHEET 1 OF 4 FILED

U.S. 2