

Alburg 61

INDEX OF SHEETS

STATE OF VERMONT
DEPARTMENT OF HIGHWAYS

PROPOSED IMPROVEMENT

FEDERAL AID PROJECT

TOWN OF ALBURG
COUNTY OF GRAND ISLE
U.S. ROUTE 2

BEGINNING AT A POINT ON ROUTE U.S. 2, 0.458 MILES SOUTHEASTERLY OF THE ALBURG VILLAGE LIMITS AND EXTENDING EASTERLY 0.276 MILES, EXCLUDING RAILWAY CROSSING.

LENGTH OF PROJECT
ROADWAY 1460.0 FEET = 0.276 MILE.
RAILWAY CROSSING 10.0 FEET = 0.002 MILE.
TOTAL PROJECT 1470.0 FEET = 0.278 MILE.

1960 ADT	1300
1980 ADT	1900
DHV	300
D	70%
T	8%
V	60 M.P.H.

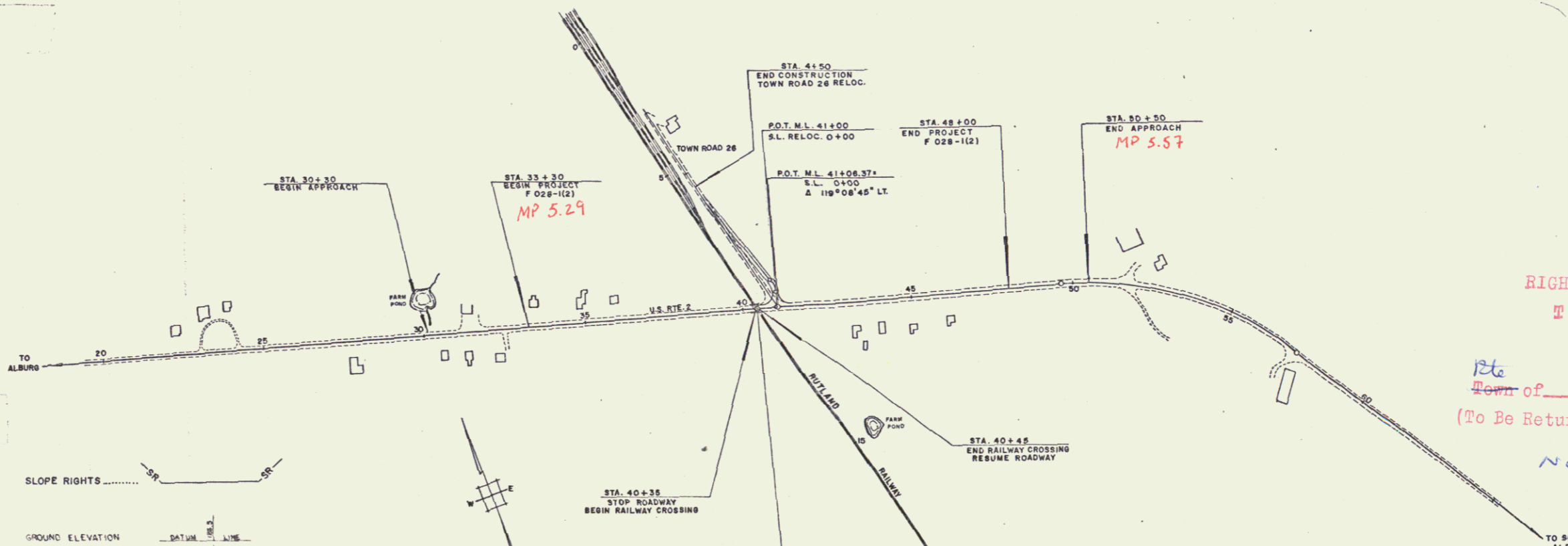
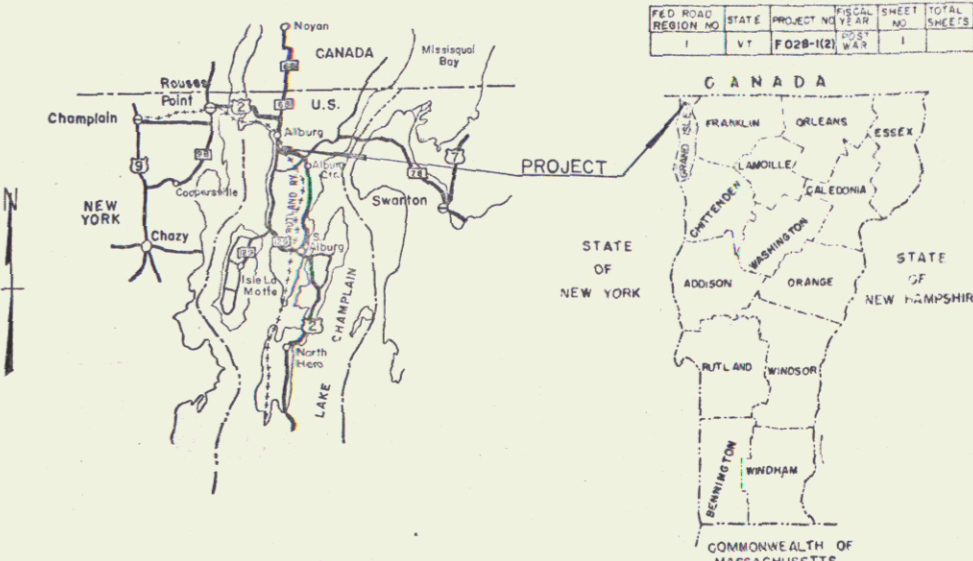

RIGHT-OF-WAY DIVISION
TOWN FILE
PERPETUAL
To Town of US 2
(To Be Returned To R.O.W. Division)
not constructed

CONVENTIONAL SIGNS

R.O.W.	---
COUNTY LINE	---
TOWN LINE	---
FENCE LINE	---
STONE WALL	---
UNFENCED PROPERTY	---
GUARD RAIL	---
TRAVELED WAY	---
RAILROAD	---
RETAINING WALL	---
CENTER LINE	---
SURVEY LINE	---
CULVERT	---
DROP INLET	---
TROLLEY POLE	---
POWER POLE	---
TELEPHONE POLE	---
TREES	---
HEDGE	---

SLOPE RIGHTS

GROUND ELEVATION

GRADE ELEVATION

CURVE DATA

DEFLECTION OF ANGLE	A
DEGREE OF CURVE	D
RADIUS OF CURVE	R
TANGENT DISTANCE	T
LENGTH OF CURVE	L
EXTERNAL DISTANCE	E
POINT OF INTERSECTION	P.I.
POINT OF CURVE	P.C.
POINT OF TANGENT	P.T.
POINT ON TANGENT	P.O.T.
POINT ON SUB-TANGENT	POST

SCALES

TITLE	1" = 200'
TYPICAL	1" = 4'
PLAN	1" = 50'
PROFILE HORIZONTAL	1" = 50'
PROFILE VERTICAL	1" = 10'
CROSS-SECTIONS	1" = 10'

THESE PLANS ARE SUBJECT TO SUCH REVISIONS AS MAY BE REQUIRED BY THE BUREAU OF PUBLIC ROADS OR THE COMMISSIONER OF HIGHWAYS.

CONSTRUCTION IS TO BE CARRIED ON IN ACCORDANCE WITH THE PLANS AND THE STANDARD SPECIFICATIONS FOR HIGHWAY AND BRIDGE CONSTRUCTION OF JANUARY 1956 SUBMITTED TO THE BUREAU OF PUBLIC ROADS AS APPROVED JULY 3, 1956, INCLUDING ALL SUBSEQUENT APPROVED REVISIONS AND SUCH REVISED SPECIFICATIONS AND SPECIAL PROVISIONS AS ARE SUBMITTED WITH THE PLANS.

APPROVED SECONDARY ENGINEER DATE	APPROVED <i>Ed. Stebbins</i> CONSTRUCTION ENGINEER DATE <u>Sept. 15, 1961</u>	APPROVED BRIDGE ENGINEER DATE	APPROVED <i>B. M. Blundell</i> DISTRICT ENGINEER DATE <u>Sept. 14, 1961</u>	APPROVED <i>G. M. Lane</i> HIGHWAY ENGINEER DATE <u>Sept. 12, 1961</u>	APPROVED <i>A. D. Bishoff</i> CHIEF ENGINEER DATE <u>Sept. 12, 1961</u>
--	---	-------------------------------------	---	--	---

DEPARTMENT OF PUBLIC ROADS
BUREAU OF HIGHWAYS

APPROVED _____ DATE _____

DIVISION ENGINEER DATE _____

PROJECT F NO. 028-112

SHEET 1 OF 1 SHEETS

Pin# 99R003