

INDEX OF SHEETS  
SEE SHEET 2

STATE OF VERMONT  
AGENCY OF TRANSPORTATION



PROPOSED IMPROVEMENT  
**TOWN OF COLCHESTER**  
COUNTY OF CHITTENDEN  
COMMUTER PARK-AND-RIDE LOT

TRAFFIC DATA (COLCHESTER, U.S. ROUTE 7)		
	2002	2022
ADT	10,100	12,300
DHV	1,200	1,400
ADTT	570	590
ZT	4	4
ZD	66	66
ESALS (2002-2022) = 3,354,000		
ESALS (2002-2042) = 7,834,000		
POSTED SPEED = 50 MPH		
DESIGN SPEED = 50 MPH		

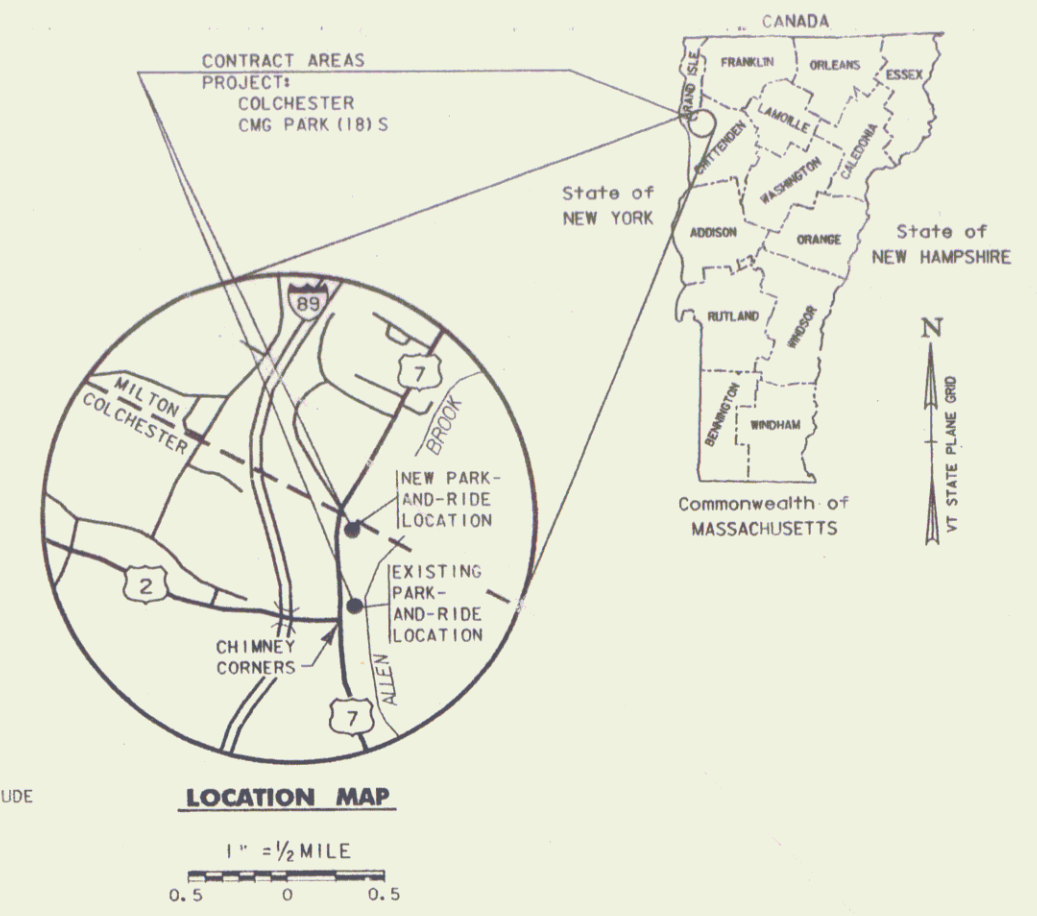

THIS PROJECT IS LOCATED ON U.S. ROUTE 7 IN THE TOWN OF COLCHESTER, APPROXIMATELY 2000 FEET NORTHERLY OF THE U.S. ROUTE 2 / U.S. ROUTE 7 INTERSECTION, ON THE EASTERLY SIDE OF U.S. ROUTE 7.

WORK TO BE PERFORMED UNDER THIS PROJECT INCLUDES THE CLOSING OF THE EXISTING PARK-AND-RIDE LOT, THE CONSTRUCTION OF A NEW PARK-AND-RIDE LOT AND IMPROVEMENTS TO THE U.S. ROUTE 7 APPROACH, WHICH WILL INCLUDE SUBBASE, PAVEMENT WIDENING, PAVEMENT MARKINGS, LIGHTING, LANDSCAPING, AND MISCELLANEOUS APPURTENANCES.

PROJECT DATA	LENGTH (FEET)	LENGTH (MILES)
LENGTH OF ROADWAY (ROUTE 7)	1790.00	0.339
LENGTH OF ACCESS ROAD	258.88	0.049
LENGTH OF PARKING LOT	382.94	0.073

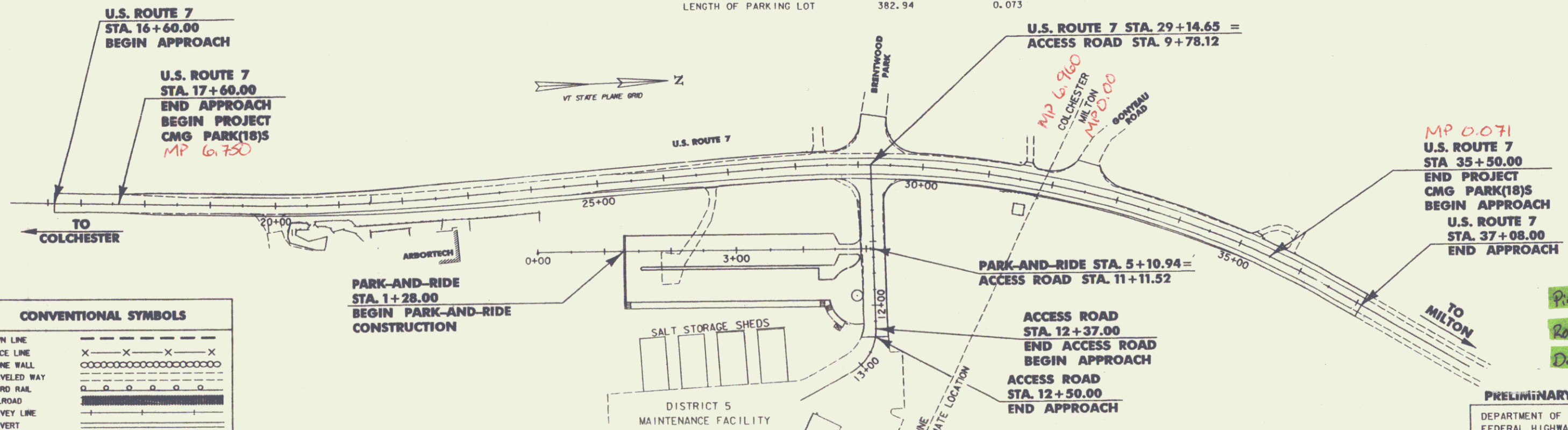

CONVENTIONAL SYMBOLS

TOWN LINE	---
FENCE LINE	-X-X-X-
STONE WALL	-----
TRAVELED WAY	-----
GUARD RAIL	-----
RAILROAD	-----
SURVEY LINE	-----
CULVERT	-----
POWER POLE	○
TELEPHONE POLE	○
TREES	* * *
CONTROL OF ACCESS	
PROPERTY LINE	---
R.O.W. TAKING LINE	SR SR SR
SLOPE RIGHTS	○
TOP OF CUT	△
TOE OF SLOPE	○
CLEAR ZONE	---
SILT FENCE	---
WETLANDS	-----

SURVEYED BY: VERMONT SURVEY AND ENGINEERING, INC.  
SURVEYED DATE: 5/01/00

DATUM  
VERTICAL NAVD 88  
HORIZONTAL NAD 83 (1995)  
VT SPC (FEET)

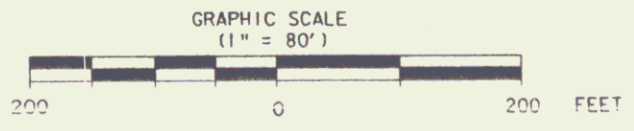

THESE PLANS ARE SUBJECT TO SUCH ENGINEERING CHANGES AS MAY BE REQUIRED BY THE FEDERAL HIGHWAY ADMINISTRATION OR THE DIRECTOR OF PROJECT DEVELOPMENT.

CONSTRUCTION IS TO BE CARRIED ON IN ACCORDANCE WITH THESE PLANS AND THE STANDARD SPECIFICATIONS FOR CONSTRUCTION DATED 2001, AS APPROVED BY THE FEDERAL HIGHWAY ADMINISTRATION ON JANUARY 4, 2001 FOR USE ON THIS PROJECT, INCLUDING ALL SUBSEQUENT REVISIONS AND SUCH REVISED SPECIFICATIONS AND SPECIAL PROVISIONS AS ARE INCORPORATED IN THESE PLANS.



PRELIMINARY PLANS: JANUARY, 2002

DEPARTMENT OF TRANSPORTATION  
FEDERAL HIGHWAY ADMINISTRATOR

APPROVED: \_\_\_\_\_ DATE: \_\_\_\_\_

DIRECTOR OF PROJECT DEVELOPMENT

APPROVED: \_\_\_\_\_ DATE: \_\_\_\_\_

PROJECT MANAGER: WAYNE L. DAVIS

PROJECT NAME: COLCHESTER PARK-AND-RIDE  
PROJECT NUMBER: CMG PARK (18) S

SHEET 1 OF 51 SHEETS

Pin # 99K062  
Route: US 7  
Date: 7/11/2003

VERTICAL GRANITE CURB  
 U.S. ROUTE 7 STA. 18+00 TO 19+40, LT.  
 GEOTEXTILE FOR SILT FENCE  
 U.S. ROUTE 7 STA. 17+60 TO 19+00, LT.

NOTE  
 1. ASSUMED 4-ROD RIGHT-OF-WAY  
 2. SILT FENCE TO BE PLACE WITHIN RIGHT-OF-WAY  
 3. SEE VTR-98 STANDARD C-1 FOR CURB END TREATMENT DETAILS

~~(1) U.S. ROUTE 7 STA. 17+60 TO 18+00, LT.  
 NEW 6" X 40" UNDERDRAIN CARRIER PIPE,  
 INV. IN = 223.02, INV. OUT = 222.75~~  
~~(1) U.S. ROUTE 7 STA. 18+00 TO 19+40, LT.  
 NEW 6" X 140" UNDERDRAIN,  
 INV. IN = 222.75, INV. OUT AT STA. 22+50 = 216.28~~

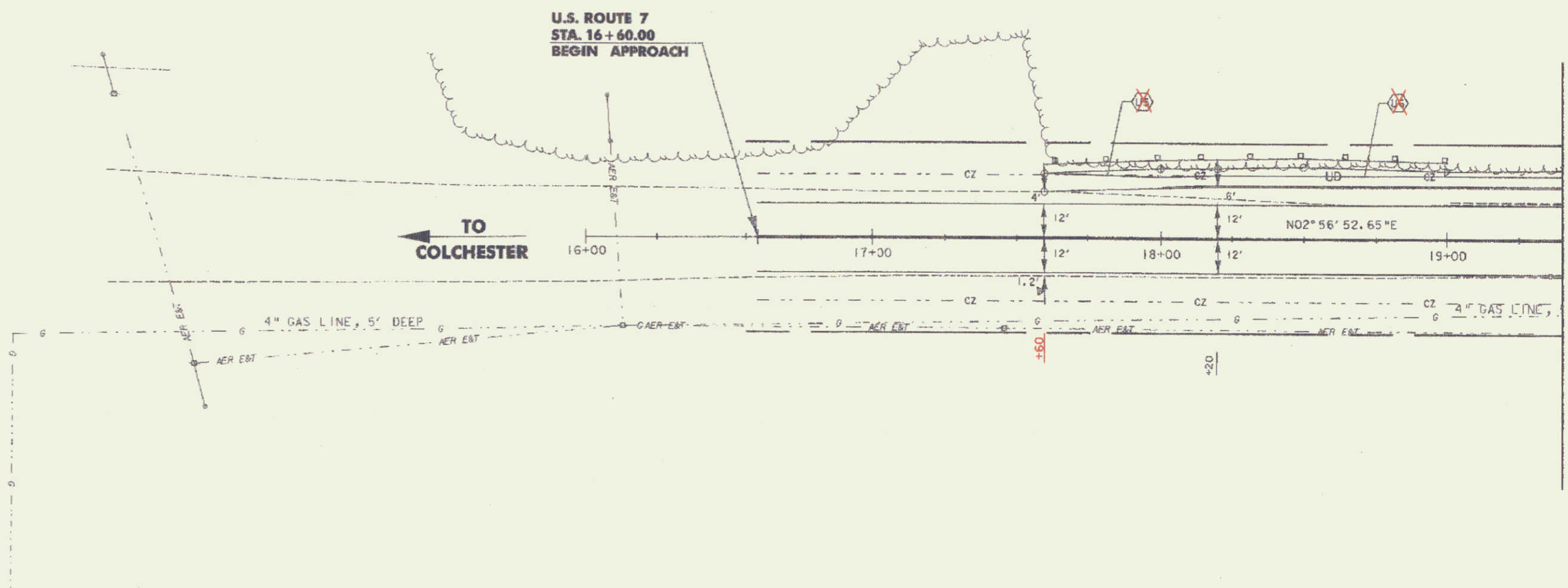

MATCHLINE - STA. 19+40 - SEE PLAN LA03

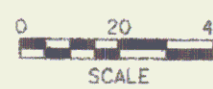

	PROJECT NAME: COLCHESTER PARK-AND-RIDE	PLOT DATE: 07/08/02
	PROJECT NUMBER: CMG PARK(16)S	DRAWN BY: CGG
	FILE NAME: LA02.PTF	CHECKED BY: GAE
	PROJECT LEADER: WLD DESIGNED BY: CSP	SHEET (12) OF 56

GENERAL NOTES:  
 U.S. ROUTE 7 STA. 19+40 TO 25+50, LT.  
 U.S. ROUTE 7 STA. 19+40 TO 25+50, RT.

U.S. ROUTE 7 STA. 19+40 TO 25+50, LT.  
 NEW 6" X 310' UNDERDRAIN  
 INV IN AT STA 18+00 = 222.27, INV. OUT = 216.28

U.S. ROUTE 7 STA. 22+50 TO 23+50, LT.  
 NEW 6" X 100' UNDERDRAIN CARRIER PIPE  
 INV IN = 216.28, INV. OUT = 214.39

CHAIN LINK FENCE, 6 FEET MOD.  
 U.S. ROUTE 7 STA. 24+12 TO 24+14, RT.

VERTICAL GRANITE CURB  
 U.S. ROUTE 7 STA. 19+40 TO 22+75, LT.

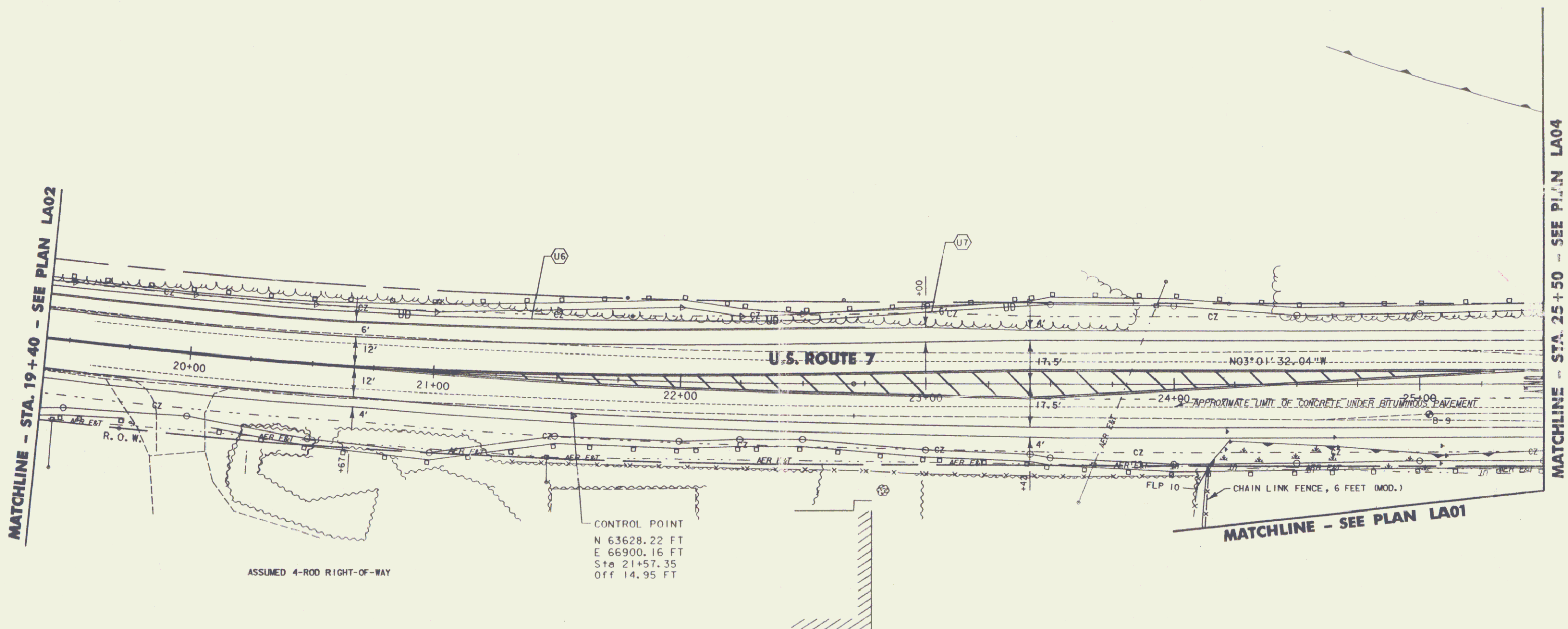

**SOIL BORING LOG SUMMARY**  
 BASED ON A PLAN ENTITLED "BRENTWOOD PARK" BY  
 "LAMOREAUX, STONE & O'LEARY"  
 DATED 3/19/97, REVISED 9/18/97

U.S. ROUTE 7  
 STA. 25+04, 12' RT.  
 B-9 (AT WHITE LINE)  
 0-18" PAVEMENT  
 18" + GRAVEL



*Pin # 99k062*

PROJECT NAME: COLCHESTER PARK-AND-RIDE  
 PROJECT NUMBER: CMG PARK(18)S

FILE NAME: LA03.PTF  
 PROJECT LEADER: WLD  
 DESIGNED BY: CSP

PLOT DATE: 12/31/2001  
 DRAWN BY: MAM  
 CHECKED BY:  
 SHEET (13) OF 51

**SOIL BORING LOG SUMMARY**

BASED ON A PLAN ENTITLED "BRENTWOOD PARK" BY  
"LAMOUREUX, STONE & O'LEARY"  
DATED 3/19/97, REVISED 9/18/97

U.S. ROUTE 7 STA. 26+67, 8' RT. B-1 (13.5' OFF E.O.P.) 0-8.5" PAVEMENT 8.5" + CONCRETE	U.S. ROUTE 7 STA. 27+69, 11' RT. B-6 (2' INTO TRAVEL LANE) 0-13" PAVEMENT 13"-24" GRAVEL
U.S. ROUTE 7 STA. 26+77, 16' RT. B-2 (MID. SHOULDER) 0-3" PAVEMENT 3"-18" GRAVEL 18" + SANDY SILT	U.S. ROUTE 7 STA. 27+13, 7' LT. B-10 (2' INTO TRAVEL LANE) 0-12" PAVEMENT 12" + CONCRETE
U.S. ROUTE 7 STA. 26+88, 20' RT. B-3 (AT E.O.P.) 0-24" GRAVEL	U.S. ROUTE 7 STA. 27+10, 14' LT. B-11 (MID. SHOULDER) 0-5.5" PAVEMENT 5.5"-18" + GRAVEL
U.S. ROUTE 7 STA. 28+22, 11' RT. B-4 (AT WHITE LINE) 0-13" PAVEMENT 13"-18" + GRAVEL	U.S. ROUTE 7 STA. 26+16, 13' LT. B-12 (MID. SHOULDER) 0-10" PAVEMENT 10"-20" + GRAVEL
U.S. ROUTE 7 STA. 28+22, 18' RT. B-5 (MID. SHOULDER) 0-5" PAVEMENT 5"-18" GRAVEL 18" + SANDY SILT	

**GEOTEXTILE FOR SILT FENCE**

U.S. ROUTE 7 STA. 25+50 TO 26+63, RT.  
U.S. ROUTE 7 STA. 25+50 TO 28+28, LT.  
U.S. ROUTE 7 STA. 28+83, RT. TO ACCESS ROAD STA. 10+25, RT.  
U.S. ROUTE 7 STA. 28+47 TO 28+97, LT.  
ACCESS ROAD STA. 10+25, LT. TO U.S. ROUTE 7 STA. 31+25, RT.  
U.S. ROUTE 7 STA. 29+52 TO 31+25, LT.

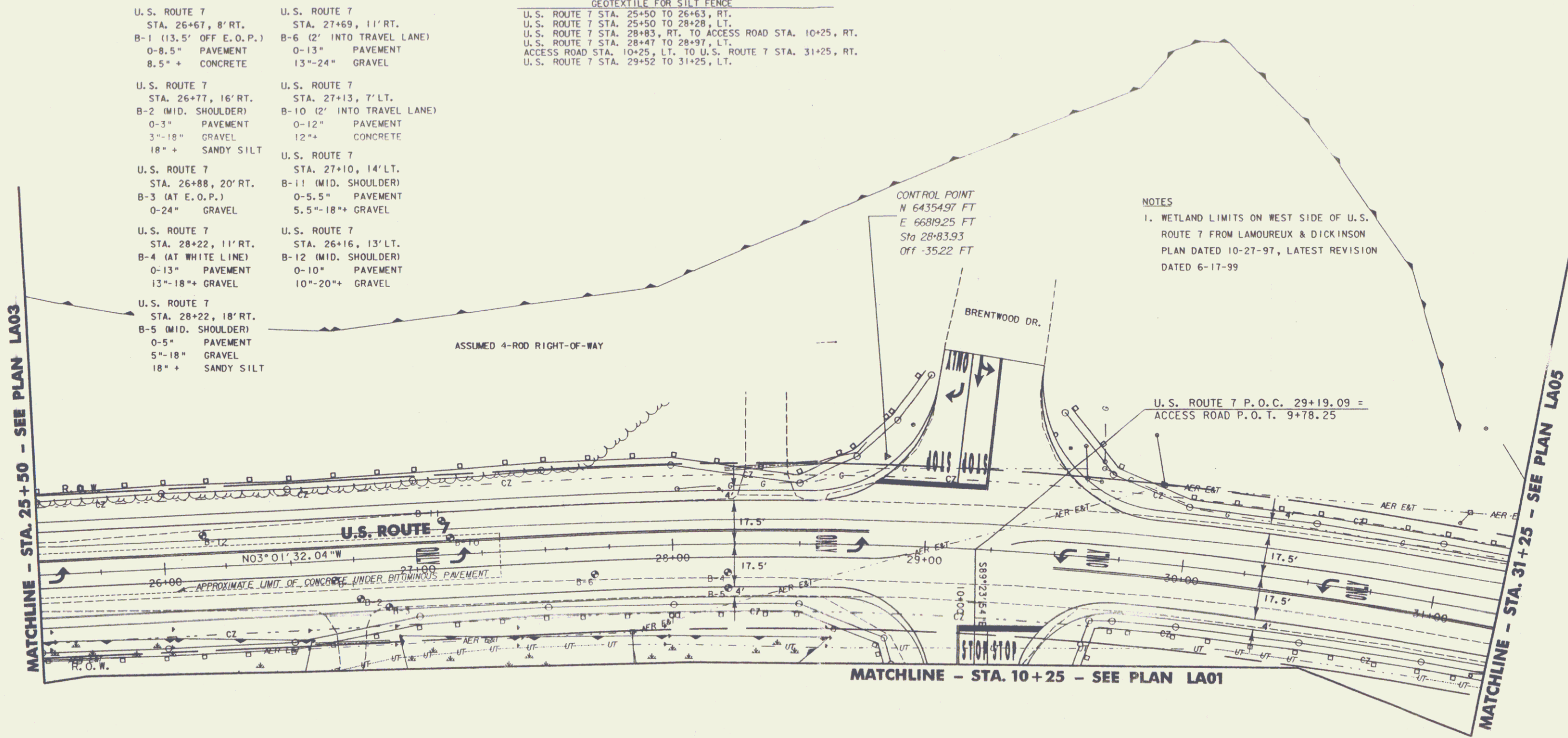

**NOTES**  
1. WETLAND LIMITS ON WEST SIDE OF U.S. ROUTE 7 FROM LAMOUREUX & DICKINSON PLAN DATED 10-27-97, LATEST REVISION DATED 6-17-99

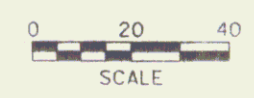

Pin 99k062  
PROJECT NAME: COLCHESTER PARK-AND-RIDE  
PROJECT NUMBER: CMG PARK(18)S  
FILE NAME: LA04.PTF  
PROJECT LEADER: WLD  
DESIGNED BY: CSP  
RT.7 LAYOUT & EROSION LA04  
PLOT DATE: 12/31/2001  
DRAWN BY: MAM  
CHECKED BY: GAE  
SHEET 14 OF 51



GEOTEXTILE FOR SILT FENCE  
 U.S. ROUTE 7 STA. 31+25 TO 31+52, LT.  
 U.S. ROUTE 7 STA. 31+25 TO 35+50, RT.  
 U.S. ROUTE 7 STA. 31+69 TO 32+42, LT.  
 U.S. ROUTE 7 STA. 32+19 TO 35+14, LT.  
 U.S. ROUTE 7 STA. 35+37 TO 35+68, LT.  
 U.S. ROUTE 7 STA. 35+81 TO 35+50, LT.

REMOVING AND RESET GUARD RAIL  
 STA. 31+20 TO 31+84, RT.

MAINLINE - STA. 31+25 - SEE PLAN LA04

PI STA. 32+19.05 BK. = STA 31+89.77 AHD.

**U.S. ROUTE 7  
 STA. 35+50.00  
 END PROJECT  
 CMG PARK(18)S  
 BEGIN APPROACH**

**U.S. ROUTE 7  
 STA. 37+08.00  
 END APPROACH**

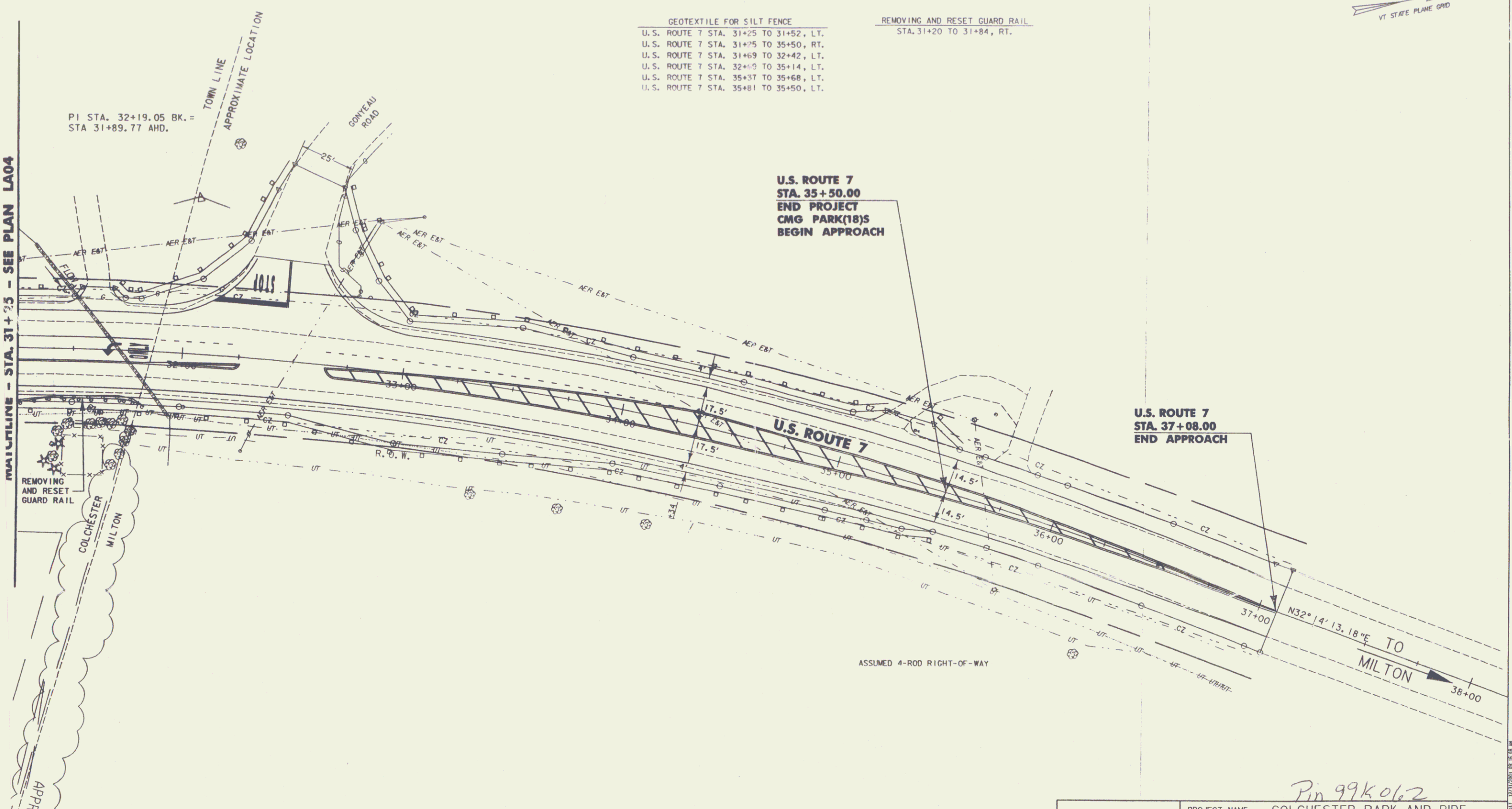

ASSUMED 4-ROD RIGHT-OF-WAY



PROJECT NAME: *Pin 99k062* COLCHESTER PARK-AND-RIDE  
 PROJECT NUMBER: CMG PARK(18)S  
 FILE NAME: LA05.PTF  
 PROJECT LEADER: WLD  
 DESIGNED BY: CSP  
 RT. 7 LAYOUT & EROSION LA05

PLOT DATE: 12/31/2001  
 DRAWN BY: MAM  
 CHECKED BY:  
 SHEET 15 OF 51

MARCH LINE

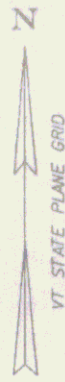

COORDINATES SHOWN ARE REFERENCED TO NAD83 (1996) HADZ7 TRANSLATED VALUES ARE SHOWN IN BRACKETS

[N=764611.84]  
[E=326394.99]  
N=764636.55  
E=1466927.56

MILTON COLCHESTER

N/F SANDERSON  
Bk. 39/Pg. 264



0 1 2 MILES

[N=764288.36]  
[E=327027.83]  
N=764313.09  
E=1467560.38

N/F ARBORTECH, INC.  
Bk. 266/Pg. 245

LOT 1 OF THE SURVEY FOR LANDS OF ARBORTECH, INC. BY ALBERT W. HARRIS, RECORDED 7/2/98 IS NOW SHOWN AS PARCEL A AND B

~ LEGEND ~

- I.P.F. IRON PIPE FOUND
- UNMONUMENTED POINT
- TOWN LINE
- - - PROPERTY LINE
- - - RIGHT-OF-WAY LINE
- - - GAS LINE
- - - GAS VALVE
- - - WATER LINE
- - - WATER GATE VALVE
- - - UNDERGROUND TELEPHONE
- - - UNDERGROUND ELECTRIC
- - - OVERHEAD UTILITIES
- - - STORM DRAINAGE
- - - BARBED WIRE FENCE
- - - COMBINATION POLE

N/F STATE OF VERMONT  
Bk. 293/Pg. 226

DEPARTMENT OF BUILDINGS AND GENERAL SERVICES  
PARCEL A  
AREA = 6.53 ac

AGENCY OF TRANSPORTATION  
PARCEL B  
AREA = 2.53 ac

This area contains a 100' X 165' easement area for replacement wastewater disposal with a 25' wide easement for a sewer R.O.W. benefiting Parcels 1 & 2, and detailed on a plan entitled, "PLAT OF AMENDED SUBDIVISION OF LANDS OF JOHN J. WILEY, JR., U.S. ROUTE 7-COLCHESTER, VERMONT", dated 10/15/96 and last revised 10/22/96, prepared by Knight Consulting Engineers and recorded at Slide #331 in the Town of Colchester records.

[N=763857.69]  
[E=327025.513]  
N=763882.42  
E=1467558.07

0 60 120  
1" = 60'

N/F ARBORTECH, INC.  
Bk. 267/Pg. 114

Approved by Resolution of the Planning Commission of the Town of Colchester, Vermont on the \_\_\_\_\_ day of \_\_\_\_\_, 20\_\_\_\_, subject to the requirements and conditions of said Resolution. Signed this \_\_\_\_\_ day of \_\_\_\_\_, 20\_\_\_\_, by \_\_\_\_\_, Chairman. DATE: 01-30-01

- The following information was considered during compilation of this plan:
1. Those deeds to which reference is made on this plan, and deeds in the chains of title to the parcels shown hereon, these deeds are a matter of public record in the Towns of Colchester and Milton, Vermont.
  2. A plan entitled, "BOUNDARY LINE ADJUSTMENT, LANDS OF ARBORTECH, INC., U.S. RTE. 7", prepared by Albert W. Harris, L.S., and recorded on July 02, 1998, in Map Slide #342 of the Colchester Land Records.
  3. Parcels 1 and 2 are subject to two easements of record along U.S. Rte. 7 benefiting New England Telephone & Telegraph Company and Central Vermont Public Service Corp., per Misc. Bk. 28, Pg. 296 and Bk. 237, Pg. 639.
  4. The sidelines of Parcels 1 & 2 extend to the centerline of U.S. Rte. 7. The areas of these parcels were computed to the Right-of-Way limit and exclude the area within the public R.O.W.

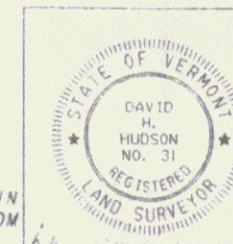

THIS SURVEY IS BASED ON EVIDENCE FOUND IN THE FIELD AND INFORMATION ABSTRACTED FROM PERTINENT DEEDS AND RECORDS.

PROPERTY PLAN SHOWING LANDS OF  
**STATE OF VERMONT**  
LOCATED IN THE  
TOWN OF COLCHESTER, VERMONT

VERMONT SURVEY AND ENGINEERING, INC.  
79 RIVER STREET, #301  
MONTPELIER, VT 05602

PROJECT NAME: COLCHESTER PARK-AND-RIDE  
PROJECT NO.: COLCHESTER CMG PARK (18) S  
Plan # 99-007

SHEET 16 6