

Bill: row

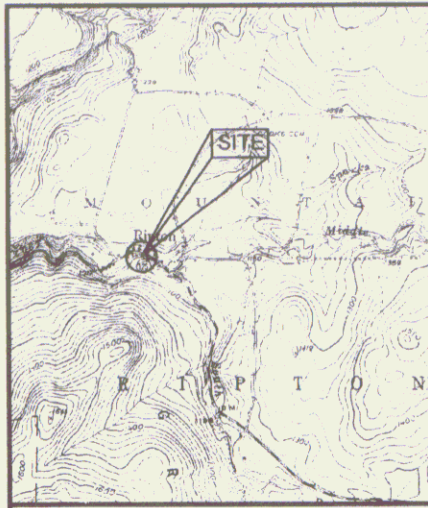

PROJECT LOCATION MAP

TOWN OF RIPTON

VILLAGE ENHANCEMENT PROJECT

RIPTON SB VT 99(002) AND RIPTON ST EH 00(33)

SELECTBOARD

William Ford-Chair
Laureen Cox
Ronald Wimett

MUNICIPAL PROJECT MANAGER

Alison Joseph

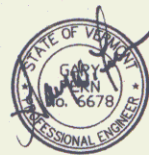

RIPTON, VERMONT

SPRING 2004

BID SET

Pin # 98E380

Route VT125

Date 12/21/2003

MP 1.149-1.480

PROJECT FUNDED BY THE VERMONT AGENCY OF
TRANSPORTATION AND FEDERAL HIGHWAY
ADMINISTRATION.

CONSTRUCTION IS TO BE CARRIED ON IN ACCORDANCE
WITH THESE PLANS AND SPECIFICATIONS PREPARED BY
OTTER CREEK ENGINEERING, INC. DATED APRIL, 2004 FOR
USE ON THIS PROJECT.

SHEET INDEX:

- C-1 SITE PLAN
- C-2 SITE PLAN
- C-3 SITE PLAN AND SECTION
- C-4 NOTES AND DETAILS
- S-1 STRUCTURAL PLANS AND SECTIONS



OTTER CREEK
ENGINEERING, INC.

404 East Main Street
P.O. Box 712
East Middlebury, VT 05740
Telephone: 802 382-8522
Fax: 802 382-8640
25 Washington Street
Rutland, VT 05701
Telephone: 802 747-3080
Fax: 802 747-4820

SHEET 1

MATCH TO SHEET C-1

MATCH LINE

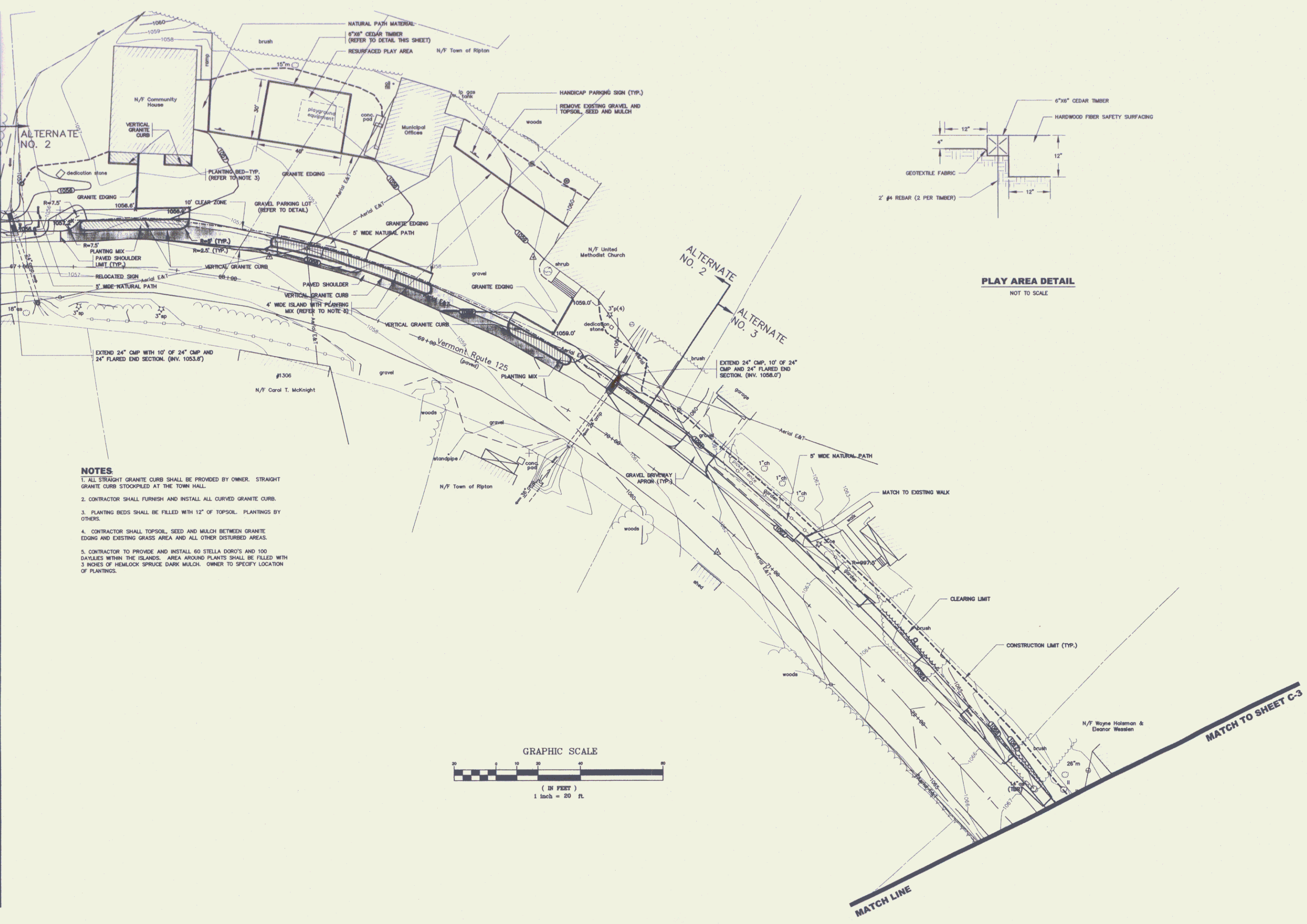

- NOTES**
1. ALL STRAIGHT GRANITE CURB SHALL BE PROVIDED BY OWNER. STRAIGHT GRANITE CURB STOCKPILED AT THE TOWN HALL.
 2. CONTRACTOR SHALL FURNISH AND INSTALL ALL CURVED GRANITE CURB.
 3. PLANTING BEDS SHALL BE FILLED WITH 12" OF TOPSOIL. PLANTINGS BY OTHERS.
 4. CONTRACTOR SHALL TOPSOIL, SEED AND MULCH BETWEEN GRANITE EDGING AND EXISTING GRASS AREA AND ALL OTHER DISTURBED AREAS.
 5. CONTRACTOR TO PROVIDE AND INSTALL 60 STELLA DORIS AND 100 DAYLILIES WITHIN THE ISLANDS. AREA AROUND PLANTS SHALL BE FILLED WITH 3 INCHES OF HEMLOCK SPRUCE DARK MULCH. OWNER TO SPECIFY LOCATION OF PLANTINGS.

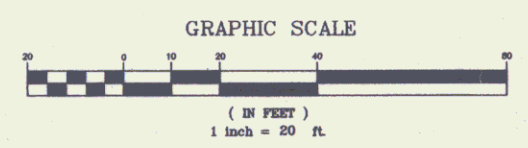

COE
OTTER CREEK ENGINEERING, INC.
 404 East Main Street
 P.O. Box 712
 East Ferrisburgh, VT 05740
 Telephone: 802-360-8332
 Fax: 802-360-8640
 22 Washington Street
 Rutland, VT 05701
 Telephone: 802-247-3080
 Fax: 802-247-4820
 E-mail: info@ottercreek.com

THESE DRAWINGS SHALL NOT BE ALTERED IN ANY WAY WITHOUT THE WRITTEN APPROVAL OF THE ENGINEER. ANY REVISIONS SHALL BE MADE BY THE ENGINEER AND NOTED IN THE REVISION BLOCK.
 © 2004
 OTTER CREEK ENGINEERING, INC.

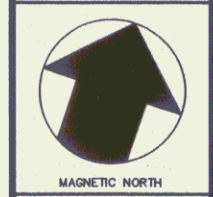

TOWN OF RIPTON
VILLAGE ENHANCEMENT PROJECT
RIPTON, VERMONT

BID

DATE ISSUED:	3/22/04
REVISIONS:	

DRAWN BY: HB
 CHECKED BY: GF
 SCALE: 1"=20'
 PROJECT NO.: 223.001
 CAD FILE: 223-001

SITE PLAN

DRAWING NO.
C-2
 SHEET 2 OF 5

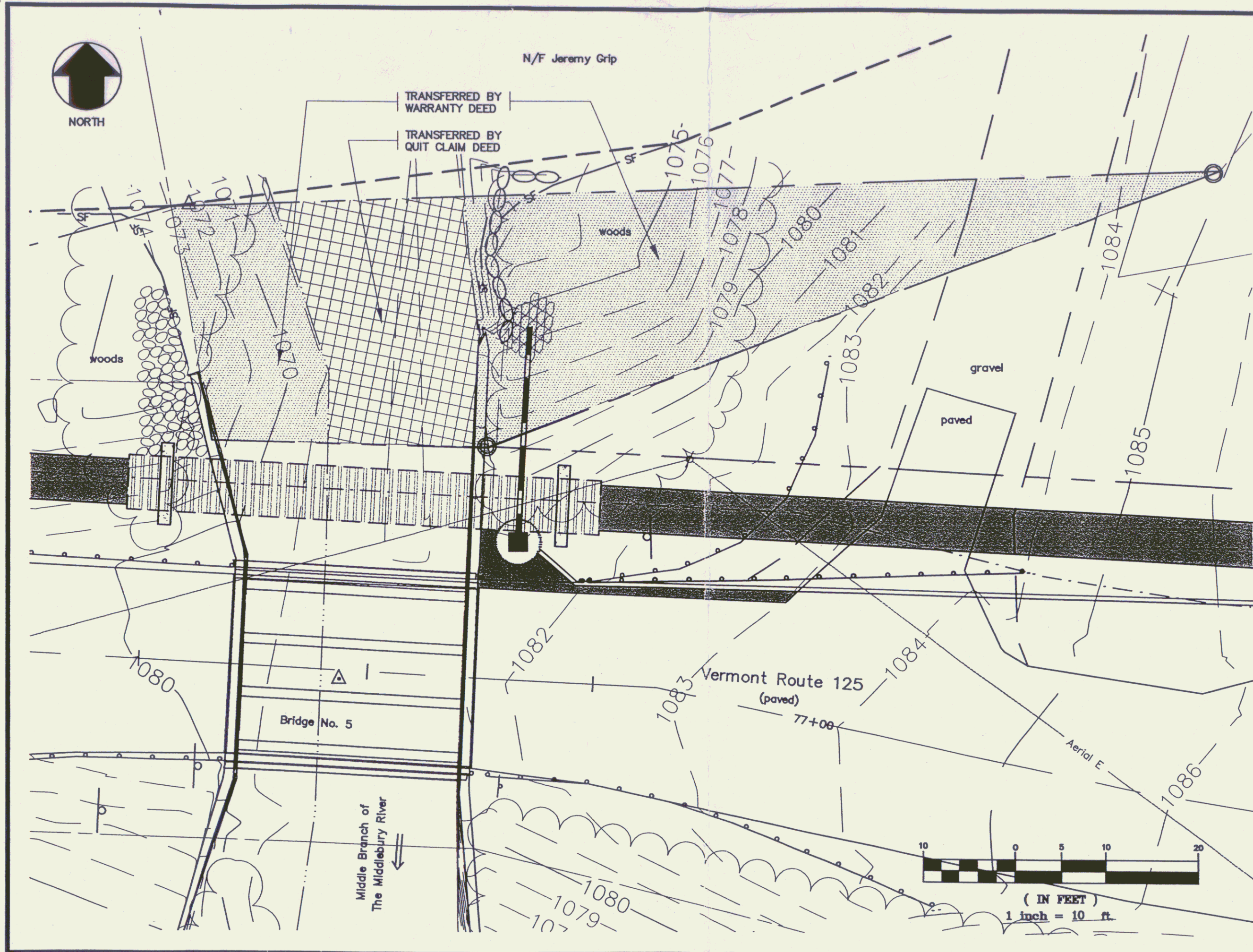

OTTER CREEK
ENGINEERING, INC.

40+ East Main Street
P.O. Box 712
East Middlebury, VT 05740
Telephone: 802-382-8522
Fax: 802-382-8640
E-mail: ottercrk@ottercrk.com

**TOWN OF RIPTON
VILLAGE ENHANCEMENT
PROJECT**

RIPTON, VERMONT

SCALE: 1"=10'

PROJECT NO.: 223.001

TITLE:

**JEREMY GRIP
EASEMENT**

FIGURE NO. SHEET (3A)

A

5



OTTER CREEK ENGINEERING, INC.
 104 East Main Street
 P.O. Box 712
 East Middlebury, VT 05740
 Telephone: 802-382-8522
 Fax: 802-382-8640
 E-mail: ottercrk@ottercrk.com

TOWN OF RIPTON
VILLAGE ENHANCEMENT PROJECT
RIPTON, VERMONT

SCALE: 1"=20'

PROJECT NO.: 223.001

TITLE:
JEREMY GRIP EASEMENT

FIGURE NO. SHEET **3B**

B