

STATE OF VERMONT
AGENCY OF TRANSPORTATION



PROPOSED IMPROVEMENT
TOWN OF WELLS
COUNTY OF RUTLAND
VT ROUTE 30

BEGINNING AT A POINT, IN THE TOWN OF WELLS, ON VT. RTE. 30,
APPROXIMATELY 4.68 MILES NORTH OF THE PAWLET/WELLS TOWN LINE
AND EXTENDING NORTHERLY APPROXIMATELY 0.23 MILES

LENGTH OF ROADWAY 1225 FEET = 0.23 MILES
LENGTH OF PROJECT 1225 FEET = 0.23 MILES
LENGTH OF R.O.W. PROJECT 630 FEET = 0.12 MILES
WORK TO BE PERFORMED UNDER PROJECT INCLUDES CLEARING & GRUBBING
(PLUS INDIVIDUAL TREES & STUMPS) AND REMOVAL OF LEDGE.

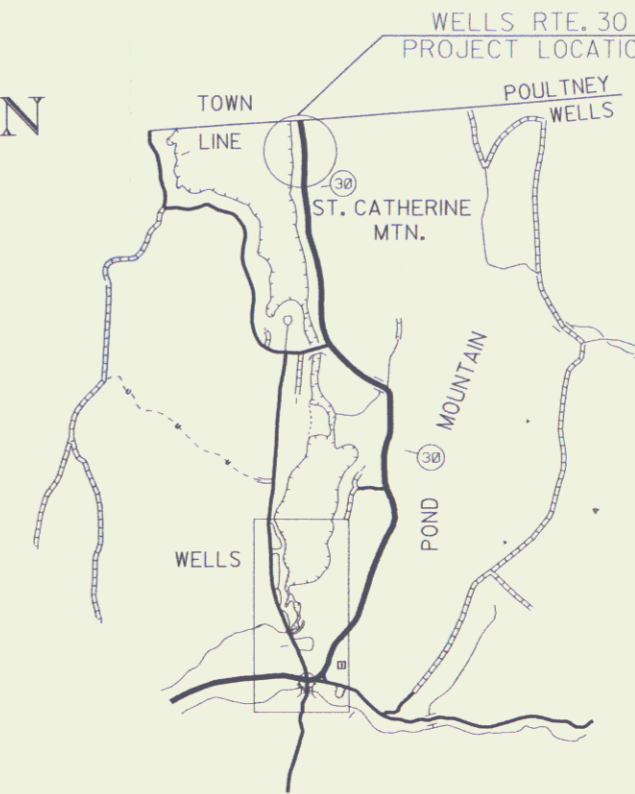

R.O.W. PLANS

CONVENTIONAL SIGNS

COUNTY LINE	---
TOWN LINE	- - - -
LIMITS OF ACCESS	○ ○ ○ ○
POINT OF ACCESS	X
FENCE LINE	- x - x -
STONE WALL	o o o o o o
TRAVELED WAY	- - - - -
RAILROAD	
SURVEY LINE	—+—+—+—
CULVERT	—+—+—+—
POWER POLE	⊕
TELEPHONE POLE	⊕
TREES	⊗
CONTROL OF ACCESS	///
PROPERTY LINE	---
R.O.W. TAKING LINE	—SR—
SLOPE RIGHTS	○
TOP OF CUT	△
TOE OF SLOPE	○

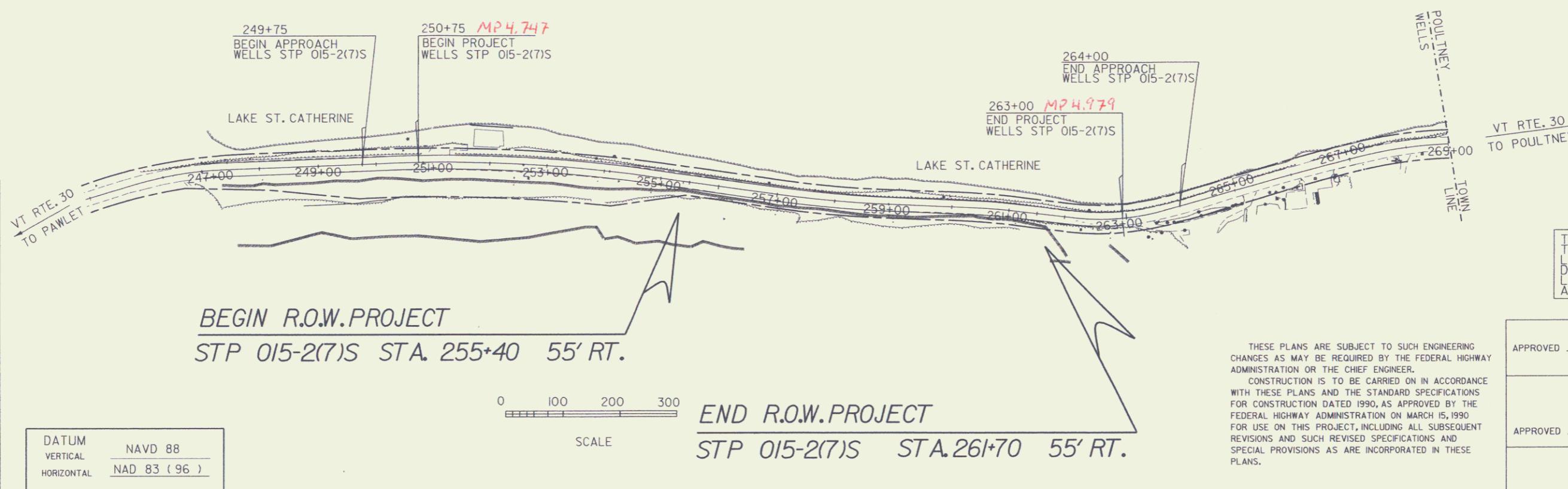

THE LEDGE LINE IS THE MAXIMUM PROPOSED LIMIT AND DOES NOT DEFICI THE EXPECTED LIMITS OF LEDGE ACTUALLY REMOVED.

THESE PLANS ARE SUBJECT TO SUCH ENGINEERING CHANGES AS MAY BE REQUIRED BY THE FEDERAL HIGHWAY ADMINISTRATION OR THE CHIEF ENGINEER. CONSTRUCTION IS TO BE CARRIED ON IN ACCORDANCE WITH THESE PLANS AND THE STANDARD SPECIFICATIONS FOR CONSTRUCTION DATED 1990, AS APPROVED BY THE FEDERAL HIGHWAY ADMINISTRATION ON MARCH 5, 1990 FOR USE ON THIS PROJECT, INCLUDING ALL SUBSEQUENT REVISIONS AND SUCH REVISED SPECIFICATIONS AND SPECIAL PROVISIONS AS ARE INCORPORATED IN THESE PLANS.

APPROVED	DAVID J. SCOTT	DATE	6-22-01
	DIRECTOR OF PROJECT DEVELOPMENT		
	<i>Pin # 988160</i>		
APPROVED	ALLEN N. BLAKE	DATE	6-21-01
	CHIEF OF RIGHT OF WAY		
	WELLS RTE. 30 STP 015-2 (7)S		
	ROW SHEET 1 OF 5 SHEETS		

NOV 14 2007

Profile

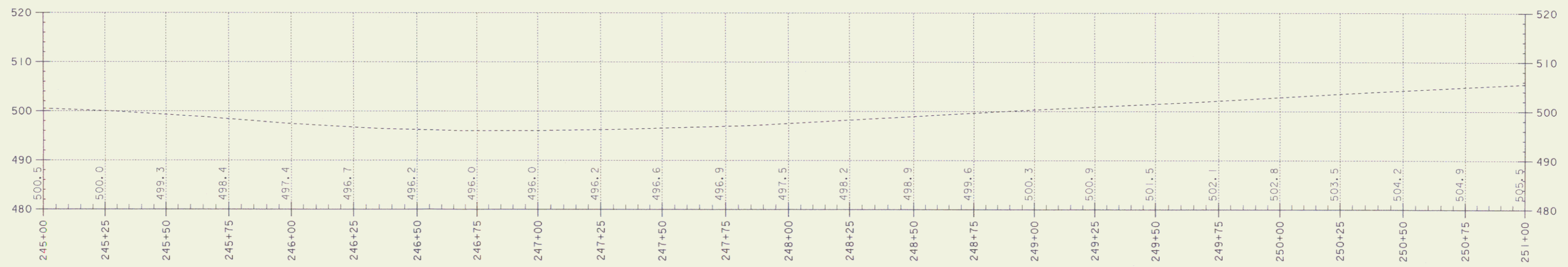

Profile

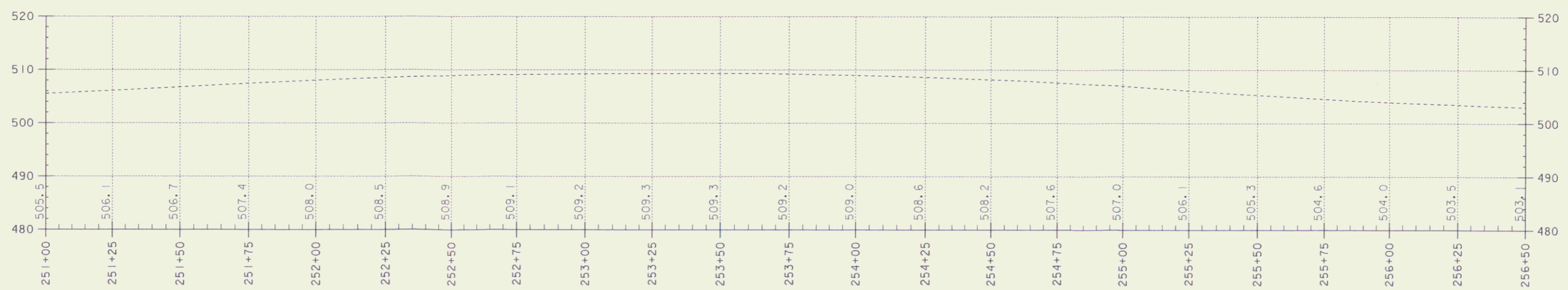

DATUM
 VERTICAL: NAVD 88
 HORIZONTAL: NAD 83 (96)

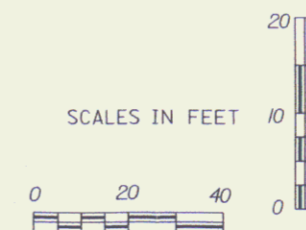

PROJECT: WELLS VT RTE. 30	PROJECT NO.:
DESIGN FILE NAME: /sqdb/98bl60/dbl60wrk.dgn	PLOT DATE: 20-JUN-2001
IPARM FILE NAME: DBI60POL1	SURVEY DATE:
SURVEYED BY:	DRAWN BY: SODB
SQUAD LEADER: DELLA SANTA	
R. O. W. SHEET 2 OF 5 SHEETS	

NOV 14 2007

2

Profile

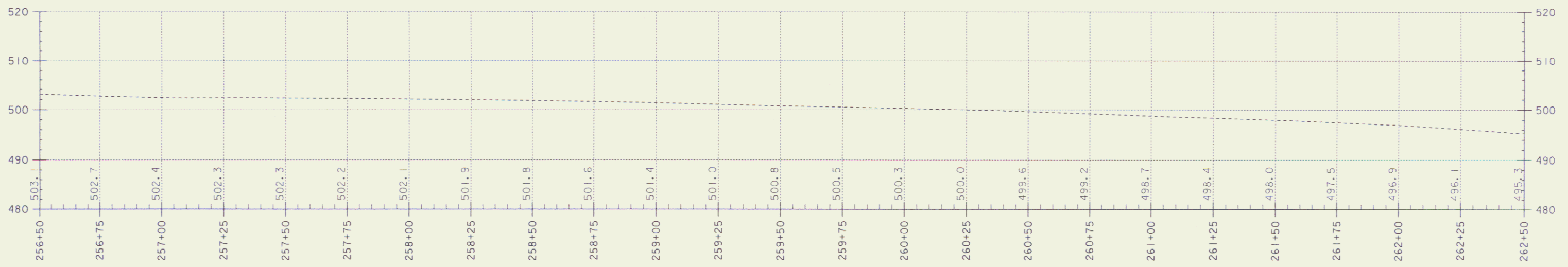

Profile

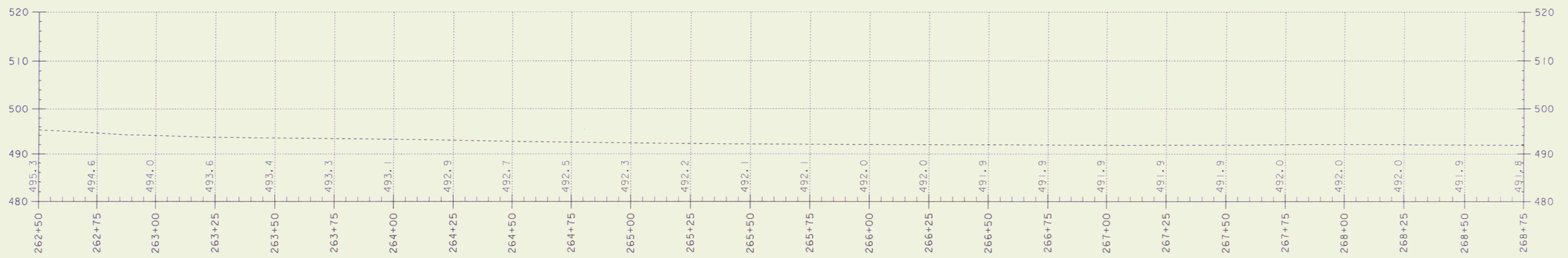

DATUM
 VERTICAL NAVD 88
 HORIZONTAL NAD 83 (96)

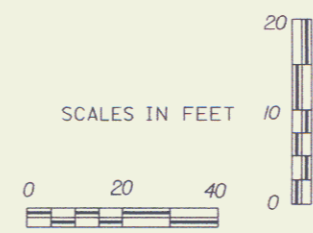

PROJECT: WELLS VT RTE. 30	PROJECT NO. :
DESIGN FILE NAME: /sqdb/98b160/db160wrk.dgn	PLOT DATE: 20-JUN-2001
IPARM FILE NAME: DB160P02.I	SURVEY DATE:
SURVEYED BY:	DRAWN BY: SODB
SQUAD LEADER: DELLA SANTA	
R. O. W. SHEET 3 OF 5 SHEETS	

NOV 14 2007

3

PARCEL NO.	GRANTOR	SHEET NO.	BEGINNING STATION	ENDING STATION	TAKING	REM.	RIGHTS	TITLE TAKEN	DATE	TOWN OR CITY RECORDED	BK.	PG.	REMARKS
1A	CANNATA, DAVID B. & DEBORAH ANN TRUSTEES OF THE CANNATA TRUST	4	255+40 RT.	256+25 RT.			CONST. (T) 2550 S.F. ±			WELLS			BOTH RIGHTS FOR PARCEL 1A ADDRESS THE SAME AREA AS DEFINED IN TRUSTEES DEED TO THE STATE OF VERMONT
			255+40 RT.	256+25 RT.			MAINTENANCE (P) 2550 S.F. ±						
1B		5	257+00 RT.	261+70 RT.			SLOPE (P) 0.33A ±						14,410 S.F. ±

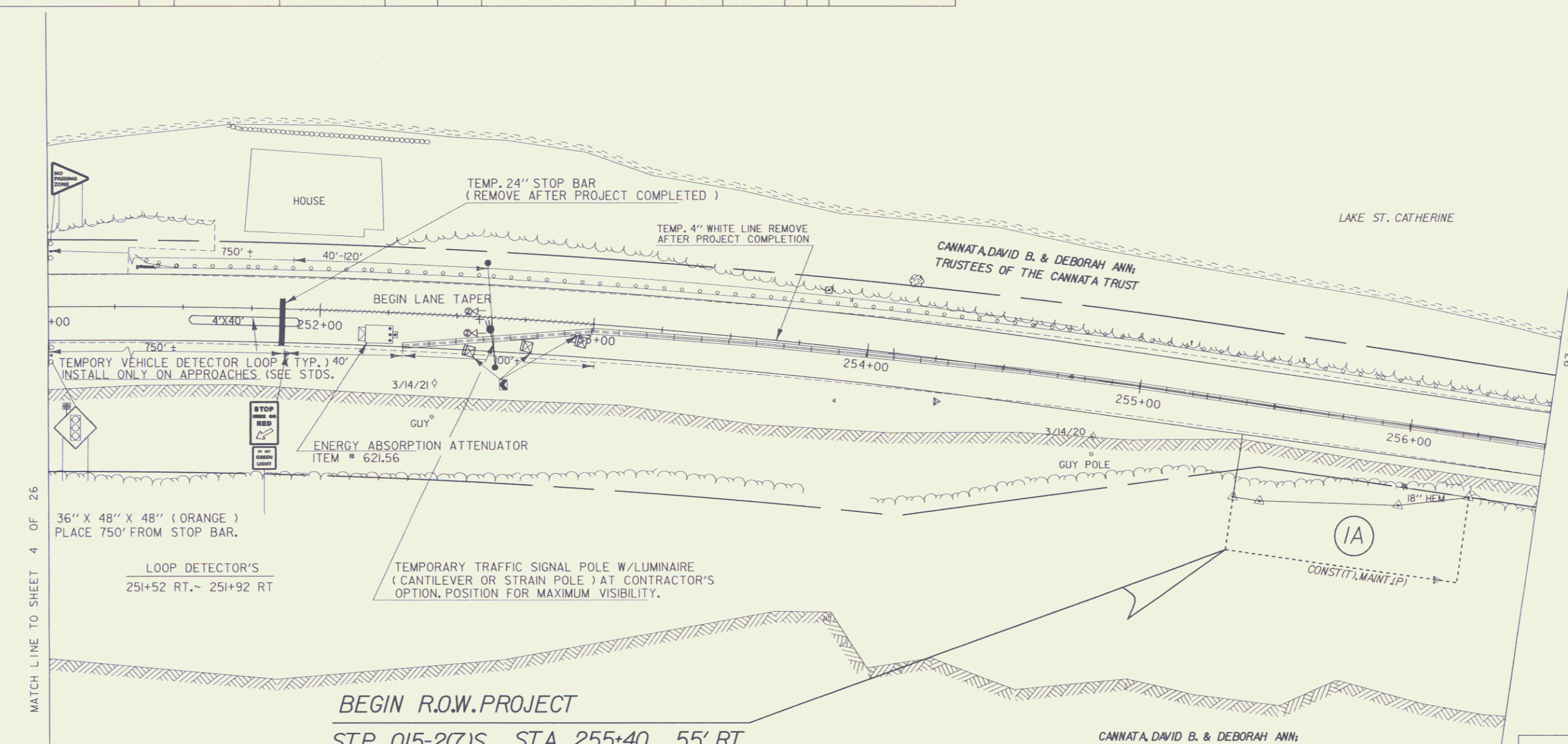
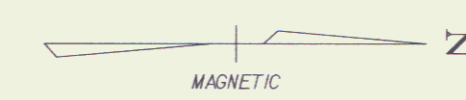

MATCH LINE TO SHEET 4 OF 26

MATCH LINE TO SHEET 6 OF 26

BEGIN R.O.W. PROJECT
STP 015-2(7)S STA. 255+40 55' RT.

- LEGEND**
- — TRAFFIC SIGNAL POLE WITH LUMINAIRE
 - ⊙ — REFLECTORIZED PLASTIC DRUMS (SEE STD. E-106). DRUM SPACING (IN FEET) IS EQUAL TO DETOUR SPEED (IN MPH)
 - — TYPE III BARRICADES SEE STD. E-107A
 - ▣ — TYPE III BARRICADES (MOD.) SEE STD. E-107A
 - /// — PAVEMENT MARKING REMOVAL
 - ⊙ — SIGNAL HEAD AND PHASE
 - ⊕ — FLASHING BEACON

THE LEDGE LINE IS THE MAXIMUM PROPOSED LIMIT AND DOES NOT DEPICT THE EXPECTED LIMITS OF LEDGE ACTUALLY REMOVED.

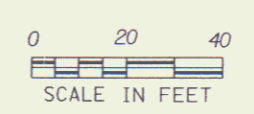

FOR R.O.W. USE ONLY

LINES SHOWN ON THIS PLAN AS EXISTING PROPERTY LINES (P/L) ARE BELIEVED TO BE ACCURATE BUT SHOULD NOT BE RELIED UPON FOR PURPOSES UNRELATED TO THE STATE OF VERMONT'S ACQUISITION OF LAND AND RIGHTS FOR THIS PROJECT.

DATUM

VERTICAL	NAVD 88
HORIZONTAL	NAD 83 (96)

PROJECT:	WELLS VT RTE 30	PROJECT NO.:	STP 015-2(7)S
DESIGN FILE NAME:	/sqdb/98b160/db160bdr.dgn	PLOT DATE:	06-NOV-2003
IPARM FILE NAME:	db160102.1	SURVEY DATE:	
SURVEYED BY:		DRAWN BY:	SQUAD B
SQUAD LEADER:	DELLA SANTA		
R. O. W. SHEET	4 OF 5 SHEETS		3A OF 27 SHEETS

NOV 14 2007

DURABLE 4" WHITE LINE
 STA. 256+50 RT - STA. 262+50 RT
 STA. 256+50 LT - STA. 262+50 LT

DURABLE 4" YELLOW LINE
 STA. 256+50 CL - STA. 262+50 CL

COLD PLANING- BITUMINOUS PAVEMENT
 STA. 256+50 - STA. 262+50

TEMPORARY TRAFFIC BARRIER
 STA. 256+50 RT - STA. 262+25 RT.

LAKE ST. CATHERINE

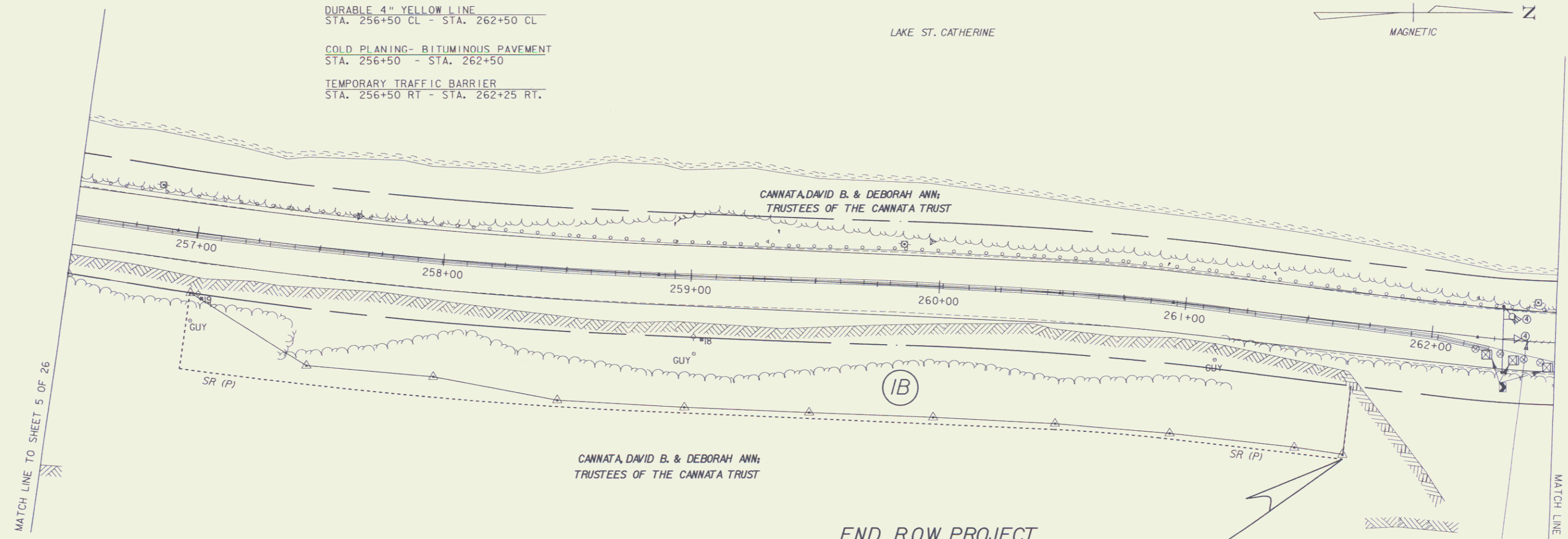
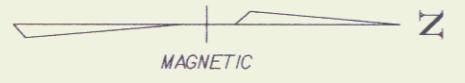

CANNATA, DAVID B. & DEBORAH ANN;
 TRUSTEES OF THE CANNATA TRUST

END R.O.W. PROJECT
 STP 015-2(7)S STA. 261+70 55' RT.

TEMPORARY TRAFFIC SIGNAL POLE W/ LUMINAIRE
 (CANTILEVER OR STRAIN POLE) AT CONTRACTOR'S
 OPTION, POSITION FOR MAXIMUM VISIBILITY.

THE LEDGE LINE IS
 THE MAXIMUM PROPOSED
 LIMIT AND DOES NOT
 DEPICT THE EXPECTED
 LIMITS OF LEDGE
 ACTUALLY REMOVED.

**FOR R.O.W.
 USE ONLY**

LINES SHOWN ON THIS PLAN AS EXISTING
 PROPERTY LINES (P/L) ARE BELIEVED TO
 BE ACCURATE BUT SHOULD NOT BE RELIED
 UPON FOR PURPOSES UNRELATED TO THE
 STATE OF VERMONT'S ACQUISITION OF LAND
 AND RIGHTS FOR THIS PROJECT.

LEGEND

- — TRAFFIC SIGNAL POLE WITH LUMINAIRE
- ⊙ — REFLECTORIZED PLASTIC DRUMS (SEE STD. E-106).
DRUM SPACING (IN FEET) IS EQUAL
TO DETOUR SPEED (IN MPH)
- — TYPE III BARRICADES SEE STD. E-107A
- ⊠ — TYPE III BARRICADES (MOD.) SEE STD. E-107A
- /// — PAVEMENT MARKING REMOVAL
- ⊙ — SIGNAL HEAD AND PHASE
- ⊙ — FLASHING BEACON

DATUM

VERTICAL	NAVD 88
HORIZONTAL	NAD 83 (96)

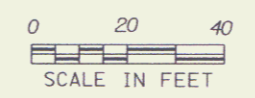

PROJECT: WELLS VT RTE 30	PROJECT NO.: STP 015-2(7)S
DESIGN FILE NAME: /sqdb/98bi60/dbi60bdr.dgn	PLOT DATE: 06-NOV-2003
IPARM FILE NAME: dbi60i03.i	SURVEY DATE:
SURVEYED BY:	SQUAD LEADER: DF11A SANTA
SQUAD LEADER: DF11A SANTA	DRAWN BY: A.JONES
R. O. W. SHEET 5 OF 5 SHEETS	3B OF 27 SHEETS

NOV 14 2007

5