

PARCEL NO.	GRANTOR	SHEET NO.	BEGINNING STATION	ENDING STATION	TAKING	REM.	RIGHTS	TITLE TAKEN	DATE	TOWN OR CITY RECORDED	BK.	PG.	REMARKS
1A	CANNATA, DAVID B. & DEBORAH ANN; TRUSTEES OF THE CANNATA TRUST	4	255+40 RT.	256+25 RT.			CONST. (T) 2550 S.F. ±			WELLS			BOTH RIGHTS FOR PARCEL 1A ADDRESS THE SAME AREA AS DEFINED IN TRUSTEES DEED TO THE STATE OF VERMONT
			255+40 RT.	256+25 RT.			MAINTENANCE (P) 2550 S.F. ±						
1B		5	257+00 RT.	261+70 RT.			SLOPE (P) 0.33A ±						14,410 S.F. ±

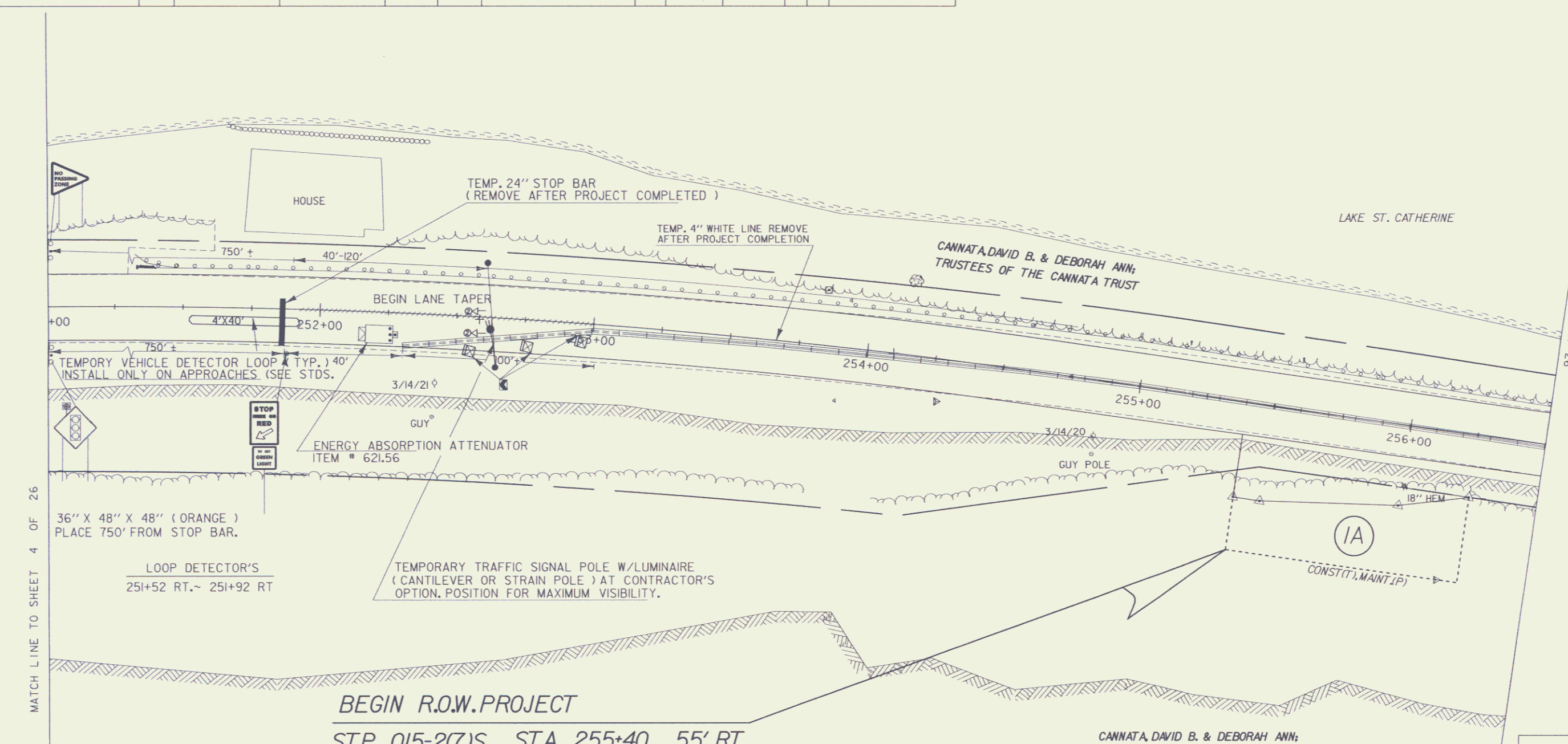
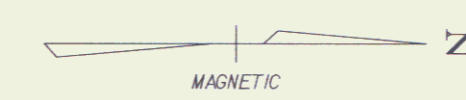

MATCH LINE TO SHEET 4 OF 26

MATCH LINE TO SHEET 6 OF 26

**BEGIN R.O.W. PROJECT**  
**STP 015-2(7)S STA. 255+40 55' RT.**

- LEGEND**
- — TRAFFIC SIGNAL POLE WITH LUMINAIRE
  - ⊙ — REFLECTORIZED PLASTIC DRUMS (SEE STD. E-106). DRUM SPACING (IN FEET) IS EQUAL TO DETOUR SPEED (IN MPH)
  - — TYPE III BARRICADES SEE STD. E-107A
  - ▣ — TYPE III BARRICADES (MOD.) SEE STD. E-107A
  - /// — PAVEMENT MARKING REMOVAL
  - ⊕ — SIGNAL HEAD AND PHASE
  - ⊛ — FLASHING BEACON

THE LEDGE LINE IS THE MAXIMUM PROPOSED LIMIT AND DOES NOT DEPICT THE EXPECTED LIMITS OF LEDGE ACTUALLY REMOVED.

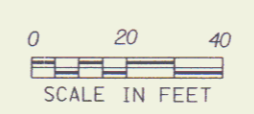

**FOR R.O.W. USE ONLY**

LINES SHOWN ON THIS PLAN AS EXISTING PROPERTY LINES (P/L) ARE BELIEVED TO BE ACCURATE BUT SHOULD NOT BE RELIED UPON FOR PURPOSES UNRELATED TO THE STATE OF VERMONT'S ACQUISITION OF LAND AND RIGHTS FOR THIS PROJECT.

**DATUM**  
 VERTICAL NAVD 88  
 HORIZONTAL NAD 83 (96)

PROJECT: **WELLS VT RTE 30** PROJECT NO.: **STP 015-2(7)S**  
 DESIGN FILE NAME: /sqdb/98b160/db160bdr.dgn PLOT DATE: 06-NOV-2003  
 IPARM FILE NAME: db160102.1 SURVEY DATE:  
 SURVEYED BY: SQUAD LEADER: DELLA SANTA DRAWN BY: SQUAD B  
 R. O. W. SHEET 4 OF 5 SHEETS 3A OF 27 SHEETS

NOV 14 2007