

**646.40 DURABLE 100 mm WHITE LINE**  
 2+830.000 RT ~ 22+040.000 RT 26.0 m (EDGE LINE)  
 2+830.000 LT ~ 2+942.035 LT 112.2 m (EDGE LINE)  
 2+857.126 LT ~ 2+916.750 LT 59.6 m (TURN LANE)  
 2+870.000 RT ~ 2+939.117 RT 69.1 m (TURN LANE)  
 2+916.750 LT ~ 2+941.139 LT 6.1 m (BROKEN LANE LINE)  
 2+942.868 RT ~ 3+000.000 RT 57.1 m (EDGE LINE)  
 2+973.914 LT ~ 2+987.916 LT 14.0 m (TURN LANE)  
 2+987.916 LT ~ 3+000.000 LT 12.1 m (DOTTED LANE)  
 22+040.000 LT ~ 2+940.471 RT 116.6 m (EDGE LINE)  
 2+942.035 LT ~ 32+040.000 LT 33.5 m (EDGE LINE)  
 32+040.000 RT ~ 3+000.000 LT 61.6 m (EDGE LINE)  
 32+010.094 LT ~ 32+040.000 LT 29.9 m (TURN LANE)

**646.41 DURABLE 100 mm YELLOW LINE**  
 2+830.000 LT ~ 2+840.000 BL 25.2 m (LANE LINE)  
 2+830.000 BL ~ 2+840.000 BL 25.2 m (CENTER LINE)  
 2+870.000 BL ~ 2+939.117 BL 138.2 m (CENTER LINE)  
 2+973.915 RT ~ 3+000.000 RT 56.3 m (LANE LINE)  
 2+973.914 RT ~ 3+000.000 RT 56.3 m (CENTER LINE)  
 22+010.121 BL ~ 22+040.000 BL 59.7 m (CENTER LINE)  
 32+010.094 BL ~ 32+040.000 BL 59.8 m (CENTER LINE)

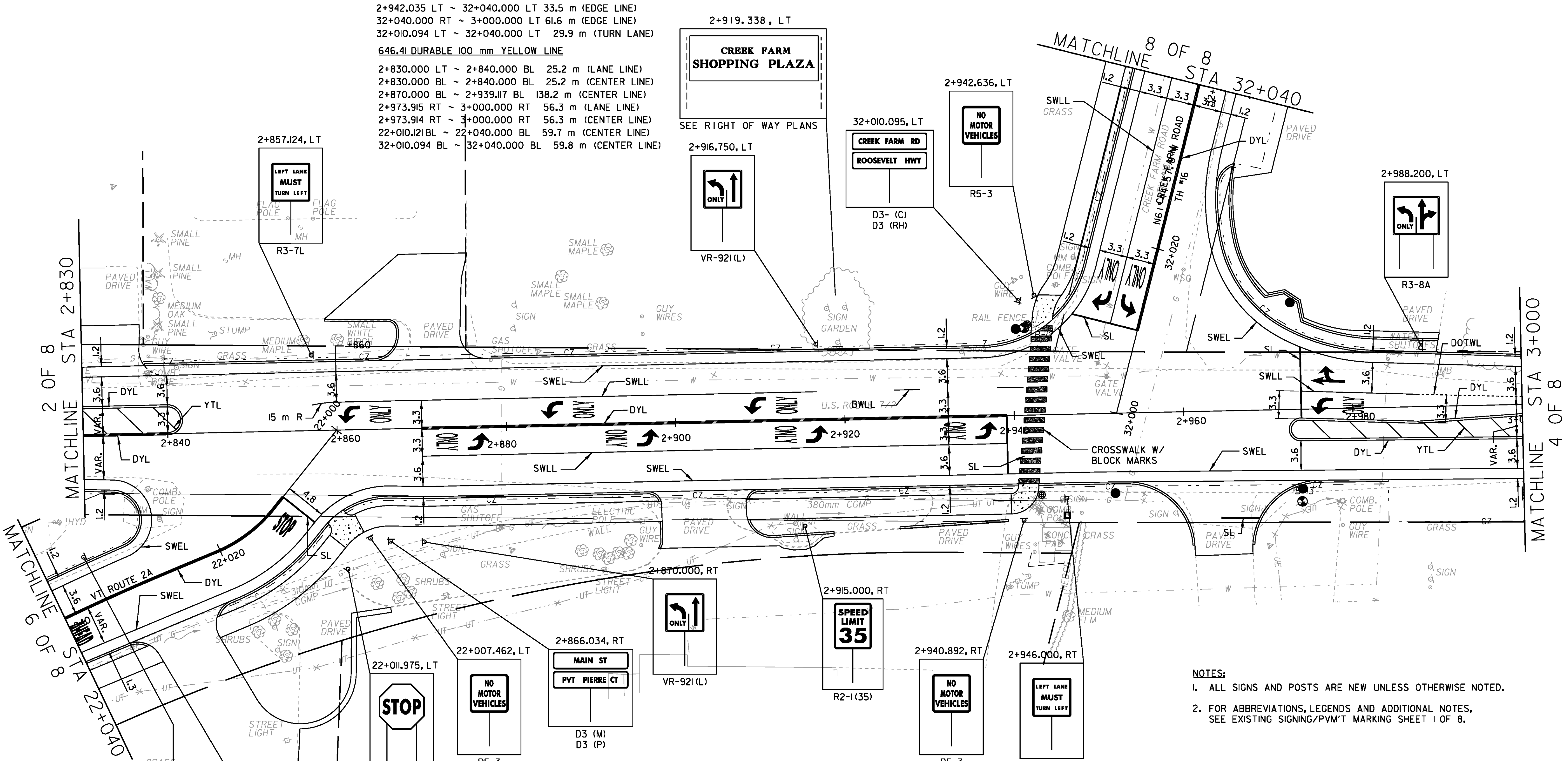

**NOTES:**  
 1. ALL SIGNS AND POSTS ARE NEW UNLESS OTHERWISE NOTED.  
 2. FOR ABBREVIATIONS, LEGENDS AND ADDITIONAL NOTES, SEE EXISTING SIGNING/PVMT MARKING SHEET 1 OF 8.

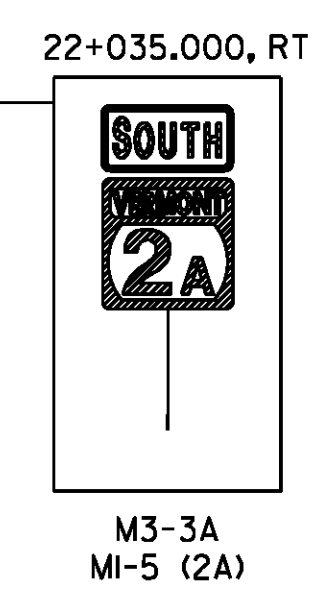
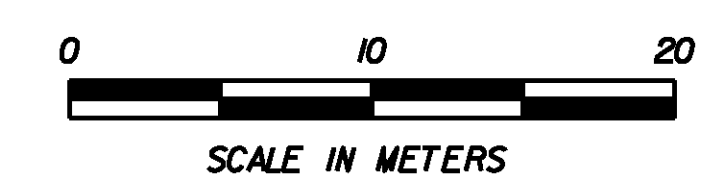

**646.43 DURABLE 200 mm YELLOW LINE**  
 2+830.000 LT ~ 2+840.975 LT 12.4 m (TRANSVERSE LINES)  
 2+975.159 RT ~ 3+000.000 RT 16.8 m (TRANSVERSE LINES)

**646.46 DURABLE 600 mm STOP BAR**  
 2+939.117 RT 6.8 m  
 2+973.915 LT ~ RT 8.4 m  
 22+010.121 LT 4.8 m  
 32+010.094 LT 8.0 m

**646.50 DURABLE LETTER OR SYMBOL**  
 2+860.200 LT 1 EA (LEFT ARROW)  
 2+863.900 LT 4 EA (ONLY)  
 2+874.213 RT 4 EA (ONLY)  
 2+877.913 RT 1 EA (LEFT ARROW)  
 2+884.200 LT 1 EA (LEFT ARROW)  
 2+887.900 LT 4 EA (ONLY)  
 2+894.213 RT 4 EA (ONLY)  
 2+897.913 RT 1 EA (LEFT ARROW)  
 2+908.200 LT 1 EA (LEFT ARROW)  
 2+914.213 RT 4 EA (ONLY)  
 2+919.900 LT 4 EA (ONLY)  
 2+917.913 RT 1 EA (LEFT ARROW)  
 2+934.213 RT 4 EA (ONLY)  
 2+937.913 RT 1 EA (LEFT ARROW)  
 2+975.114 LT 3 EA (LEFT AND RIGHT/THRU ARROWS)  
 2+978.867 LT 4 EA (ONLY)  
 22+011.323 LT 4 EA (STOP)  
 32+011.295 LT 2 EA (RIGHT AND LEFT ARROWS)  
 32+014.995 LT 8 EA (ONLY)

**646.51 DURABLE CROSSWALK W/DIAGONAL LINES**  
 2+941.572 RT ~ 2+943.828 LT

PROJECT NAME:	COLCHESTER	PLOT DATE:	21-FEB-2013
PROJECT NUMBER:	STP 5600(9)S	DRAWN BY:	T. KELLEY
FILE NAME:	r97d206SPMP3.dgn	CHECKED BY:	D. BURHANS
PROJECT LEADER:	J. SCHULTZ	SHEET	69 OF 74
DESIGNED BY:	D. BRYANT		
PROP. SIGN/PVMT MARK. SHEET	3 OF 8		