



NEW WATER MAIN

- W3 2+830.000 LT ~ 2+985.894 RT
NEW 300 mm PIPE
- W4 2+984.400 RT ~ 2+982.750 RT
NEW 300 mm PIPE
- W5 32+01.436 LT ~ 32+015.330 LT
NEW 300 mm PIPE
- W6 2+841.199 LT ~ 22+040.000 RT
NEW 300 mm PIPE
- W7 22+032.996 RT ~ 22+033.026 RT
NEW HYDRANT ASSEMBLY

NEW GAS MAIN (BY OTHERS)

- G3 2+997.968 RT ~ 22+040.000 LT
NEW 100 mm XTRU
- G4 2+994.686 RT ~ 2+995.285 LT
NEW 100 mm XTRU
- G5 2+995.285 LT ~ 32+036.819 RT
NEW 100 mm XTRU

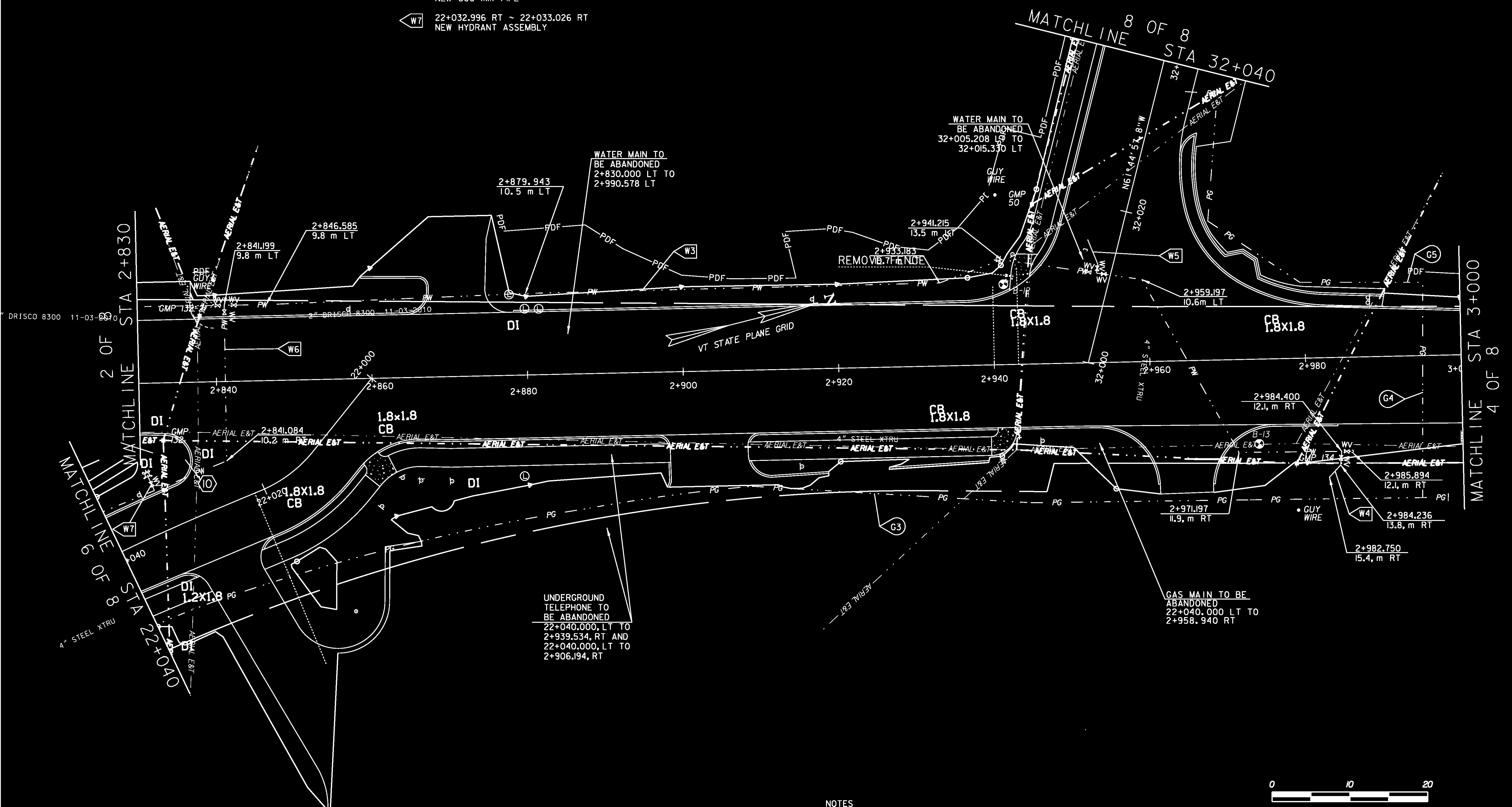

- NOTES**
- 1) SEE SIGNAL PLANS FOR LOCATIONS OF TRAFFIC SIGNALS AND MAST ARMS.
 - 2) SEE DRAINAGE PLANS FOR LOCATION OF PROPOSED DRAINAGE FACILITIES.
 - 3) SEE CONSTRUCTION PLANS FOR ADDITIONAL PROPOSED FACILITIES.



PROJECT NAME:	COLCHESTER	PLOT DATE:	21-FEB-2013
PROJECT NUMBER:	STP 5600(9)S	DRAWN BY:	T. KELLEY
FILE NAME:	r97d206UTL3.dgn	CHECKED BY:	D. BURHANS
PROJECT LEADER:	J. SCHULTZ	SHEET	43 OF 74
DESIGNED BY:	D. BRYANT		
UTILITY SHEET	3 OF 8		