

**STONE DITCH NOTES**

2+984.000 RT ~ 2+986.000 RT  
 CONSTRUCT 2.000 m W X 2.900 m L X 0.300 m D  
 STONE DITCH WITH STONE FILL TYPE I

**NEW UNDERDRAIN**

- UI2 2+864.712 RT ~ 2+937.623 RT  
 NEW 150 mm x 72.964 m UNDERDRAIN  
 W/ CARRIER PIPE & F.B. @ 2+864.712 RT  
 INV. IN = 62.268; INV. OUT = 62.082
- UI5 2+880.991 LT ~ 2+940.039 LT  
 NEW 150 mm x 59.050 m UNDERDRAIN  
 W/ CARRIER PIPE & F.B. @ 2+880.991 LT  
 INV. IN = 62.148; INV. OUT = 61.689
- UI6 2+938.468 RT ~ 2+953.095 RT  
 NEW 150 mm x 14.747 m UNDERDRAIN  
 W/ CARRIER PIPE & F.B. @ 2+953.095 RT  
 INV. IN = 62.142; INV. OUT = 62.082

- UI7 2+975.962 RT ~ 3+052.572 RT  
 NEW 150 mm x 76.597 m UNDERDRAIN  
 W/ CARRIER PIPE & F.B. @ 2+975.962 RT  
 INV. IN = 60.123; INV. OUT = 59.400
- UI8 2+977.730 LT ~ 32+033.148 RT  
 NEW 150 mm x 30.441 m UNDERDRAIN  
 W/ CARRIER PIPE & F.B. @ 32+033.148 RT  
 INV. IN = 61.452; INV. OUT = 61.300
- UI9 2+979.517 LT ~ 3+052.478 LT  
 NEW 150 mm x 73.381 m UNDERDRAIN  
 W/ CARRIER PIPE & FLUSHING ACCESS  
 INV. IN = 61.739; INV. OUT = 59.350
- UI24 2+836.789 RT ~ 22+089.832 RT  
 NEW 150 mm x 65.070 m UNDERDRAIN  
 W/ CARRIER PIPE & F.B. @ 22+089.832 RT  
 INV. IN = 63.335; INV. OUT = 63.225
- UI26 22+037.052 LT ~ 22+092.996 LT  
 NEW 150 mm x 54.870 m UNDERDRAIN  
 W/ CARRIER PIPE & F.B. @ 22+092.996 LT  
 INV. IN = 62.699; INV. OUT = 62.550
- UI27 22+018.366 LT ~ 22+035.475 LT  
 NEW 150 mm x 17.748 m UNDERDRAIN  
 W/ CARRIER PIPE & F.B. @ 22+035.475 LT  
 INV. IN = 62.396; INV. OUT = 62.360
- UI28 2+862.755 RT ~ 22+017.681 LT  
 NEW 150 mm x 15.249 m UNDERDRAIN  
 W/ CARRIER PIPE & FLUSHING ACCESS  
 INV. IN = 62.952; INV. OUT = 62.800

**NEW DRAINAGE**

- 9 2+830.184 RT ~ 22+089.479 RT  
 NEW 450 mm x 58.813 m OPTION AA PIPE  
 INV. IN = 63.425; INV. OUT = 62.800
- 10 2+831.133 RT ~ 2+836.415 RT  
 NEW 450 mm x 5.298 m OPTION AA PIPE  
 INV. IN = 62.925; INV. OUT = 62.800
- 10A 2+830.717 RT ~ 2+830.645 RT  
 NEW 450 mm x 1.678 m OPTION AA PIPE  
 INV. IN = 62.725; INV. OUT = 62.702
- 21A 22+037.218 LT ~ 22+064.482 LT  
 NEW 900 mm x 26.920 m CPEP SL  
 INV. IN = 62.398; INV. OUT = 62.325
- 22 22+036.468 LT ~ 22+036.478 LT  
 NEW 450 mm x 6.265 m OPTION AA PIPE  
 INV. IN = 62.600; INV. OUT = 62.568
- 23 22+018.571 LT ~ 22+035.715 LT  
 NEW 900 mm x 17.547 m CPEP SL  
 INV. IN = 62.250; INV. OUT = 62.150
- 24 2+862.308 RT ~ 22+017.458 LT  
 NEW 900 mm x 14.594 m CPEP SL  
 INV. IN = 62.075; INV. OUT = 62.000
- 25 2+863.375 RT ~ 2+868.303 RT  
 NEW 450 mm x 8.404 m OPTION AA PIPE  
 INV. IN = 62.800; INV. OUT = 62.500
- 26 2+863.623 RT ~ 2+937.263 RT  
 NEW 900 mm x 73.640 m CPEP SL  
 INV. IN = 61.925; INV. OUT = 61.475
- 27 2+938.129 RT ~ 2+940.665 LT  
 NEW 900 mm x 14.470 m CPEP SL  
 INV. IN = 61.430; INV. OUT = 61.357
- 27B 2+955.339 RT ~ 2+973.954 LT  
 NEW 900 mm x 18.615 m OPTION AA PIPE  
 INV. IN = 62.070; INV. OUT = 61.990

- 28 2+880.511 LT ~ 2+939.961 LT  
 NEW 450 mm x 59.451 m OPTION AA PIPE  
 INV. IN = 62.700; INV. OUT = 62.103
- 29 2+941.531 LT ~ 2+977.190 LT  
 NEW 900 mm x 35.693 m OPTION CC PIPE  
 INV. IN = 61.150; INV. OUT = 60.700
- 30 2+978.662 LT ~ 3+052.735 LT  
 NEW 900 mm x 73.864 m OPTION CC PIPE  
 INV. IN = 60.550; INV. OUT = 58.750

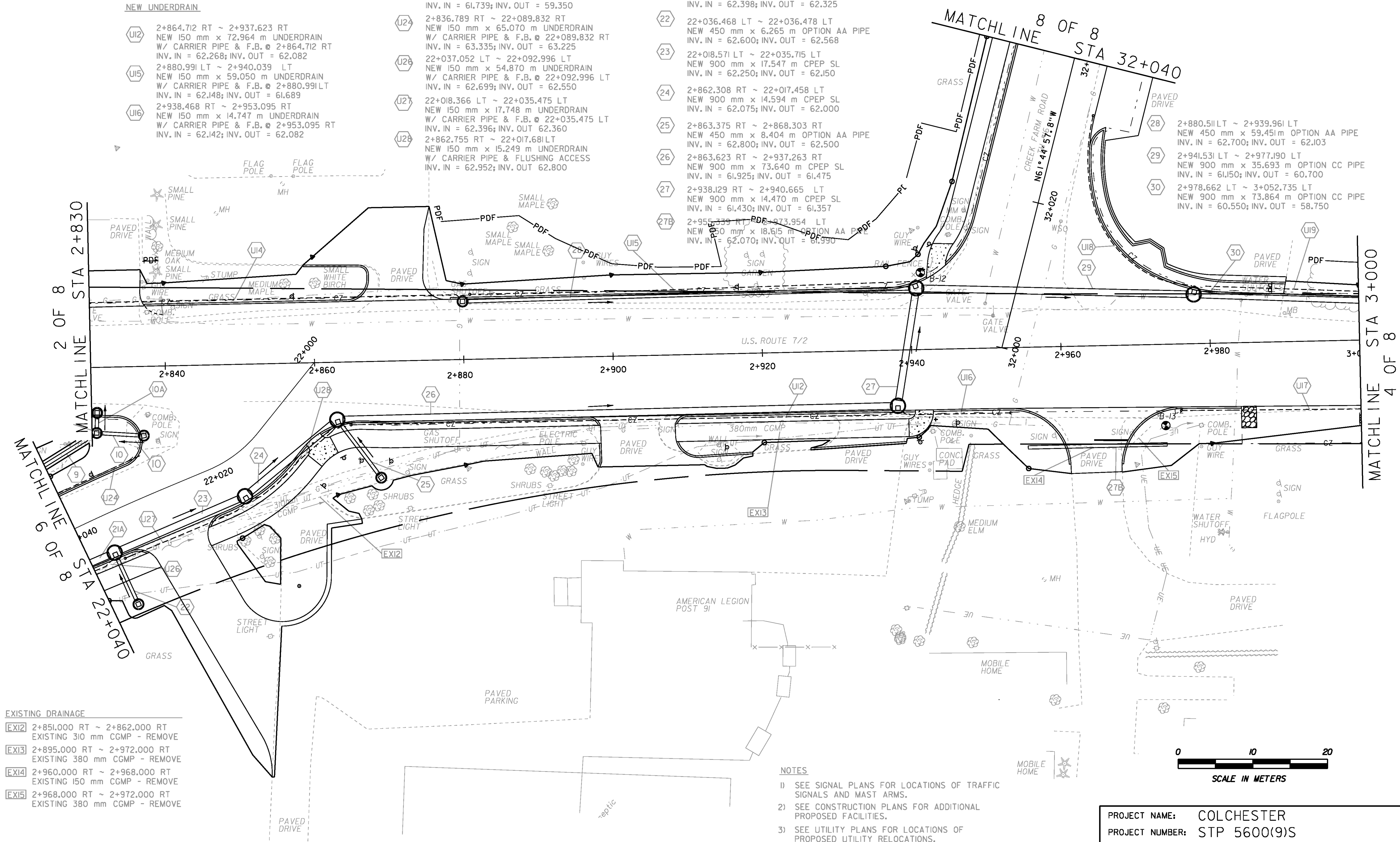

- EXISTING DRAINAGE**
- EXI2 2+851.000 RT ~ 2+862.000 RT  
 EXISTING 310 mm CGMP - REMOVE
  - EXI3 2+895.000 RT ~ 2+972.000 RT  
 EXISTING 380 mm CGMP - REMOVE
  - EXI4 2+960.000 RT ~ 2+968.000 RT  
 EXISTING 150 mm CGMP - REMOVE
  - EXI5 2+968.000 RT ~ 2+972.000 RT  
 EXISTING 380 mm CGMP - REMOVE

- NOTES**
- 1) SEE SIGNAL PLANS FOR LOCATIONS OF TRAFFIC SIGNALS AND MAST ARMS.
  - 2) SEE CONSTRUCTION PLANS FOR ADDITIONAL PROPOSED FACILITIES.
  - 3) SEE UTILITY PLANS FOR LOCATIONS OF PROPOSED UTILITY RELOCATIONS.

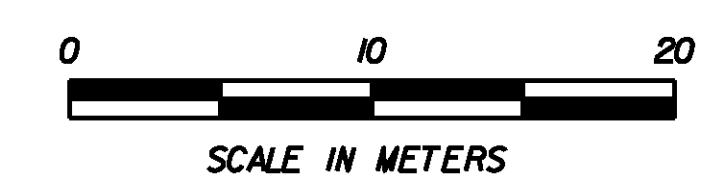

PROJECT NAME:	COLCHESTER	PLOT DATE:	21-FEB-2013
PROJECT NUMBER:	STP 5600(9)S	DRAWN BY:	T. KELLEY
FILE NAME:	r97d206DRN3.dgn	CHECKED BY:	D. BURHANS
DESIGNED BY:	D. BRYANT	SHEET	35 OF 74
DRAINAGE PLAN SHEET	3 OF 8		