

Original Drawing - Ink on polymer meeting the requirements of 27 V.S.A. § 1403

PARCEL NO.	GRANTOR	SHEET NO.	BEGINNING STATION	ENDING STATION	TAKING	REM.	RIGHTS	TITLE TAKEN	DATE	TOWN OR CITY RECORDED	BK.	PG.	REMARKS
1	HAYES, JEFFERY C. & KELLY D. (DAVIS)	2	10+50.0 RT.	12+20.0 RT.			CONST (T) 859 S. F. ±						INCLUDES PDF & EROSION CONTROL
			11+52.8 RT.	12+14.2 RT.			SLOPE (P) 485 S. F. ±						
			11+13.4 RT.				REMOVE (T)						

ELECTRONIC FILES TO STRUCTURES 1-22-09

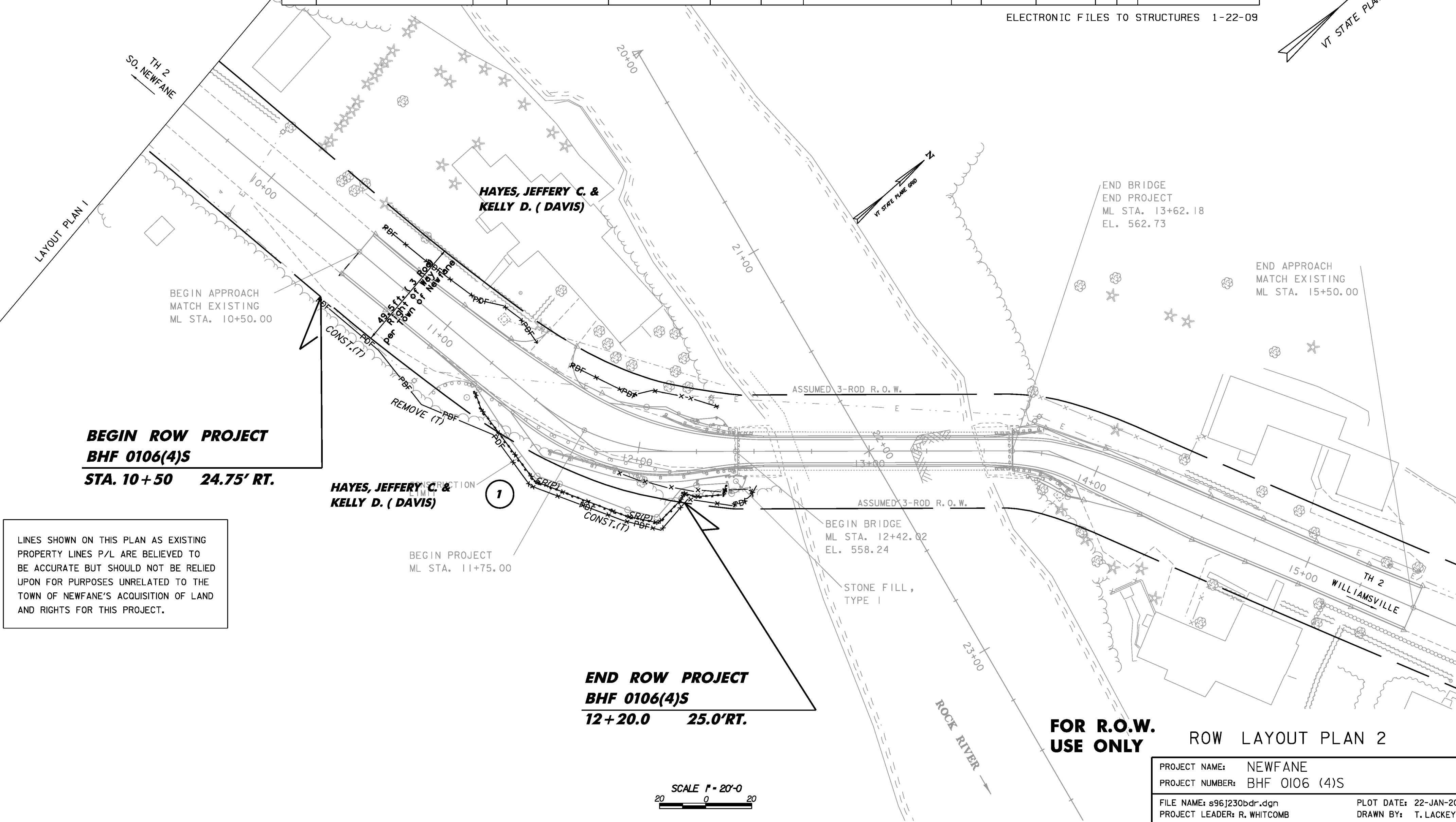
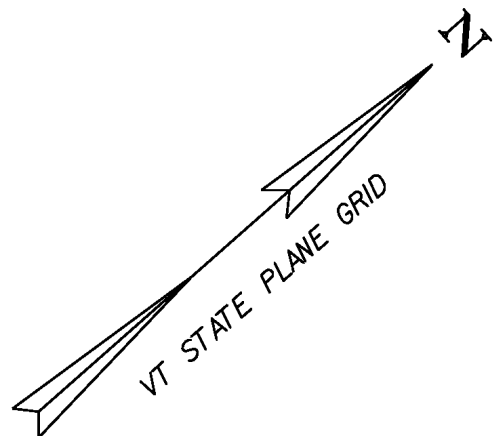

**BEGIN ROW PROJECT  
BHF 0106(4)S  
STA. 10+50 24.75' RT.**

**END ROW PROJECT  
BHF 0106(4)S  
12+20.0 25.0' RT.**

LINES SHOWN ON THIS PLAN AS EXISTING PROPERTY LINES P/L ARE BELIEVED TO BE ACCURATE BUT SHOULD NOT BE RELIED UPON FOR PURPOSES UNRELATED TO THE TOWN OF NEWFANE'S ACQUISITION OF LAND AND RIGHTS FOR THIS PROJECT.

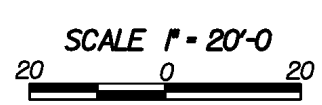

**FOR R.O.W. USE ONLY** ROW LAYOUT PLAN 2

PROJECT NAME:	NEWFANE	PLOT DATE:	22-JAN-2009
PROJECT NUMBER:	BHF 0106 (4)S	DRAWN BY:	T. LACKEY
FILE NAME:	s96j230bdr.dgn	CHECKED BY:	R. WHITCOMB
PROJECT LEADER:	R. WHITCOMB	R. O. W. SHEET	2 OF 2 SHEETS
DESIGNED BY:	T. LACKEY		

PLOT DATE: 22-JAN-2009