

Original Drawing - Ink on polymer meeting the requirements of 27 V.S.A. § 1403

PARCEL NO.	GRANTOR	SHEET NO.	BEGINNING STATION	ENDING STATION	TAKING	REM.	RIGHTS	TITLE TAKEN	DATE	TOWN OR CITY RECORDED	BK.	PG.	REMARKS
1	HAYES, JEFFERY C. & KELLY D. (DAVIS)	2	10+50.0 RT.	12+20.0 RT.			CONST (T) 859 S. F. ±						INCLUDES PDF & EROSION CONTROL
			11+52.8 RT.	12+14.2 RT.			SLOPE (P) 485 S. F. ±						
			11+13.4 RT.				REMOVE (T)						

ELECTRONIC FILES TO STRUCTURES 1-22-09

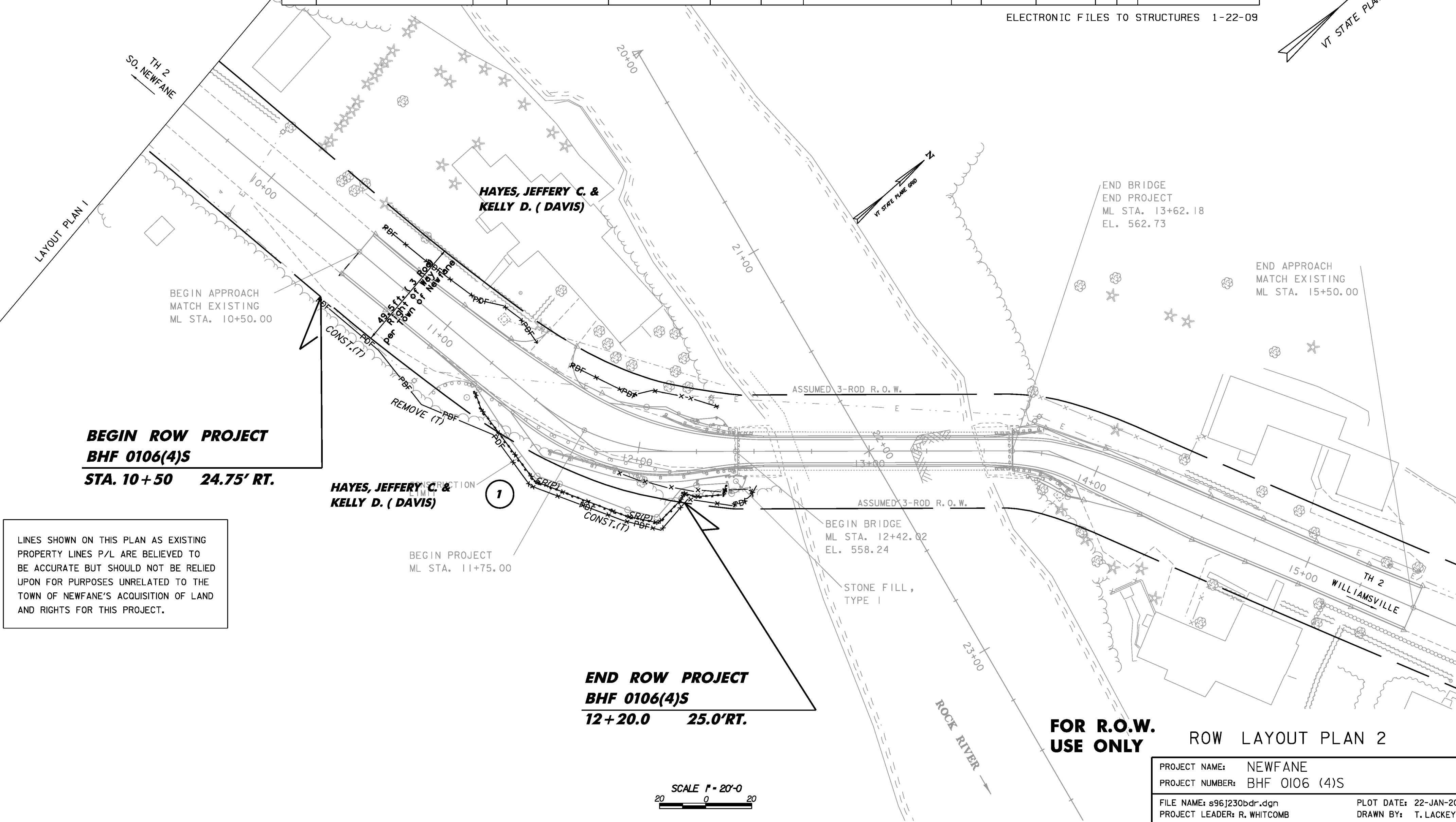
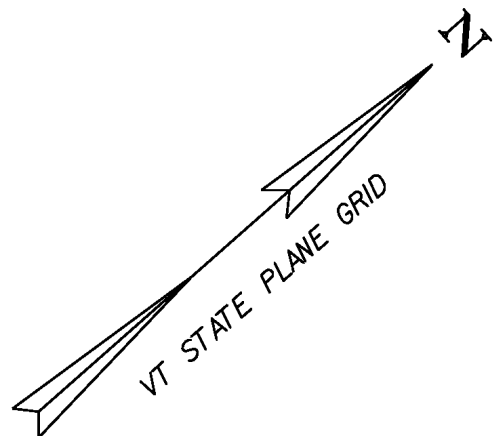

**BEGIN ROW PROJECT
BHF 0106(4)S
STA. 10+50 24.75' RT.**

**END ROW PROJECT
BHF 0106(4)S
12+20.0 25.0' RT.**

LINES SHOWN ON THIS PLAN AS EXISTING PROPERTY LINES P/L ARE BELIEVED TO BE ACCURATE BUT SHOULD NOT BE RELIED UPON FOR PURPOSES UNRELATED TO THE TOWN OF NEWFANE'S ACQUISITION OF LAND AND RIGHTS FOR THIS PROJECT.

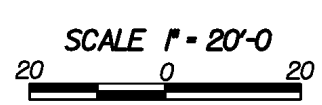

FOR R.O.W. USE ONLY ROW LAYOUT PLAN 2

PROJECT NAME: NEWFANE	PLOT DATE: 22-JAN-2009
PROJECT NUMBER: BHF 0106 (4)S	DRAWN BY: T. LACKEY
FILE NAME: s96j230bdr.dgn	CHECKED BY: R. WHITCOMB
PROJECT LEADER: R. WHITCOMB	R. O. W. SHEET 2 OF 2 SHEETS
DESIGNED BY: T. LACKEY	

PLOT DATE: 22-JAN-2009