

R. O. W. PLANS

STATE OF VERMONT
AGENCY OF TRANSPORTATION

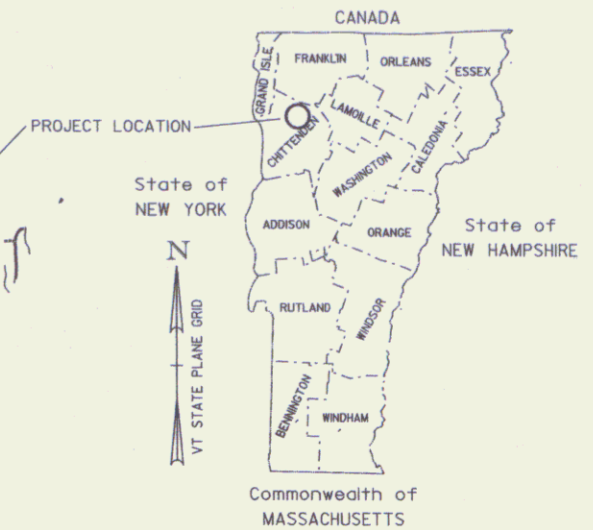
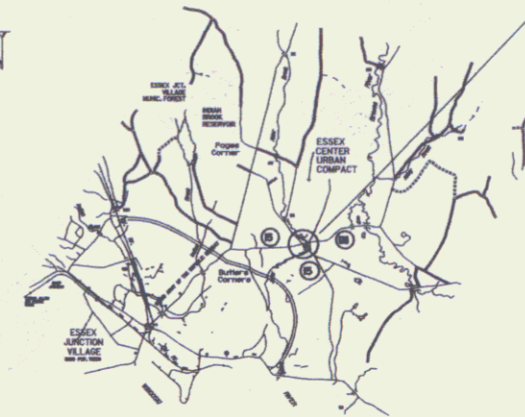

TOWN OF ESSEX
COUNTY OF CHITTENDEN
INTERSECTION OF VT 15 & VT 128

TOWN OF ESSEX, VT IS AT THE INTERSECTION OF VT 128 & TOWERS RD. (MM 5.34).

WORK UNDER THIS PROJECT INCLUDES INSTALLING A NEW TRAFFIC SIGNAL SYSTEM, UPGRADING PEDESTRIAN CROSSINGS, NEW SIGNS, PAVING, AND PAVEMENT MARKINGS TO INCREASE CAPACITY AND IMPROVE SAFETY.
LENGTH OF ROW PROJECT 488.89 FEET

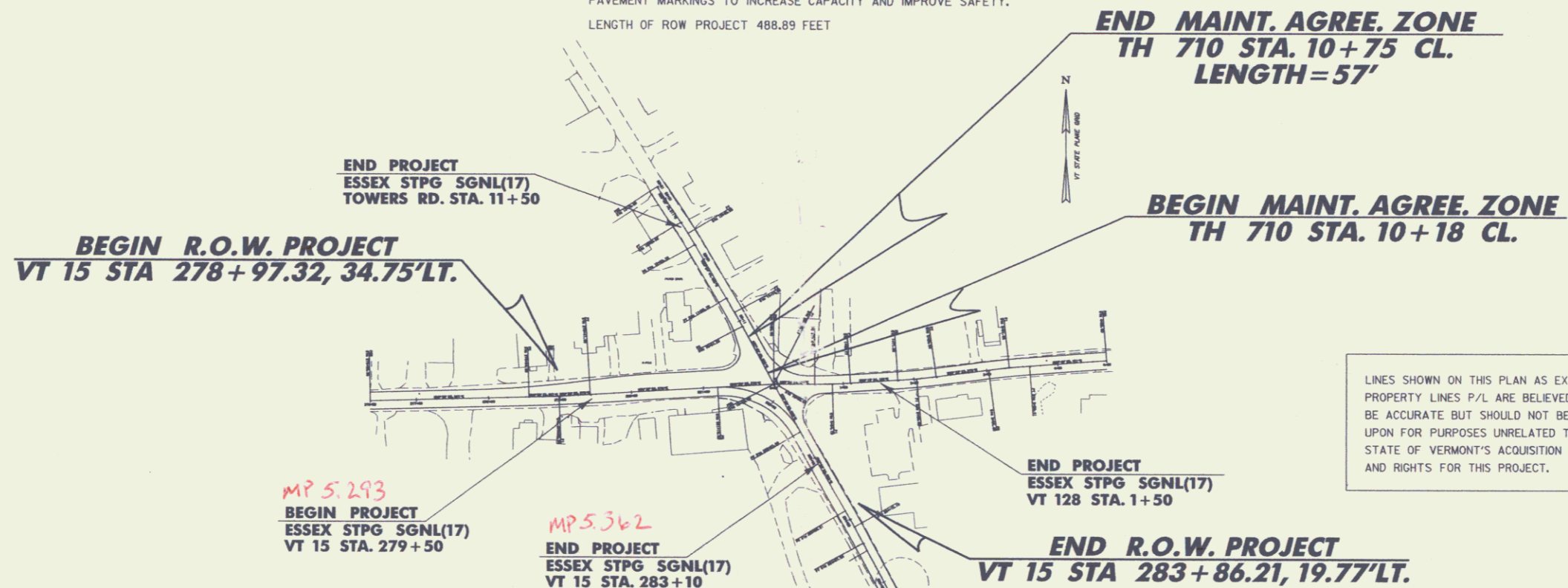

LINES SHOWN ON THIS PLAN AS EXISTING PROPERTY LINES P/L ARE BELIEVED TO BE ACCURATE BUT SHOULD NOT BE RELIED UPON FOR PURPOSES UNRELATED TO THE STATE OF VERMONT'S ACQUISITION OF LAND AND RIGHTS FOR THIS PROJECT.

CONVENTIONAL SYMBOLS

COUNTY LINE	
TOWN LINE	
LIMITS OF ACCESS	
POINT OF ACCESS	
FENCE LINE	
STONE WALL	
TRAVELED WAY	
GUARD RAIL	
RAILROAD	
SURVEY LINE	
CULVERT	
POWER POLE	
TELEPHONE POLE	
TREES	
CONTROL OF ACCESS	
PROPERTY LINE	
R.O.W. TAKING LINE	
SLOPE RIGHTS	
TOP OF CUT	
TOE OF SLOPE	

SURVEYED BY : L. ORVIS
SURVEYED DATE : 10/98
DATUM
VERTICAL NAVD88
HORIZONTAL NAD83(92)

ALL DRIVES AS INDICATED ON PLANS ARE SUBJECT TO PERMITS PURSUANT TO TITLE 19 SECTION III, V.S.A.

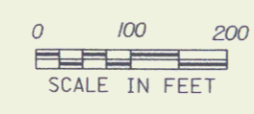

THESE PLANS ARE SUBJECT TO SUCH ENGINEERING CHANGES AS MAY BE REQUIRED BY THE FEDERAL HIGHWAY ADMINISTRATION OR THE DIRECTOR OF PROJECT DEVELOPMENT.
CONSTRUCTION IS TO BE CARRIED ON IN ACCORDANCE WITH THESE PLANS AND THE STANDARD SPECIFICATIONS FOR CONSTRUCTION DATED 2001, AS APPROVED BY THE FEDERAL HIGHWAY ADMINISTRATION ON JANUARY 4, 2001 FOR USE ON THIS PROJECT, INCLUDING ALL SUBSEQUENT REVISIONS AND SUCH REVISED SPECIFICATIONS AND SPECIAL PROVISIONS AS ARE INCORPORATED IN THESE PLANS.

P.in #96B182
Route VT15
PLOTTED: 17-NOV-2004

APPROVED *[Signature]* DATE 3/8/05
Director of Program Development

APPROVED *[Signature]* DATE 3/8/05
Chief of Right of Way

ESSEX
STPG SGNL(17)
R.O.W. SHEET 1 OF 5 SHEETS

/tr of 96b182/1b182bdr.dgn/1b182111.1