

STATE OF VERMONT
 AGENCY OF TRANSPORTATION

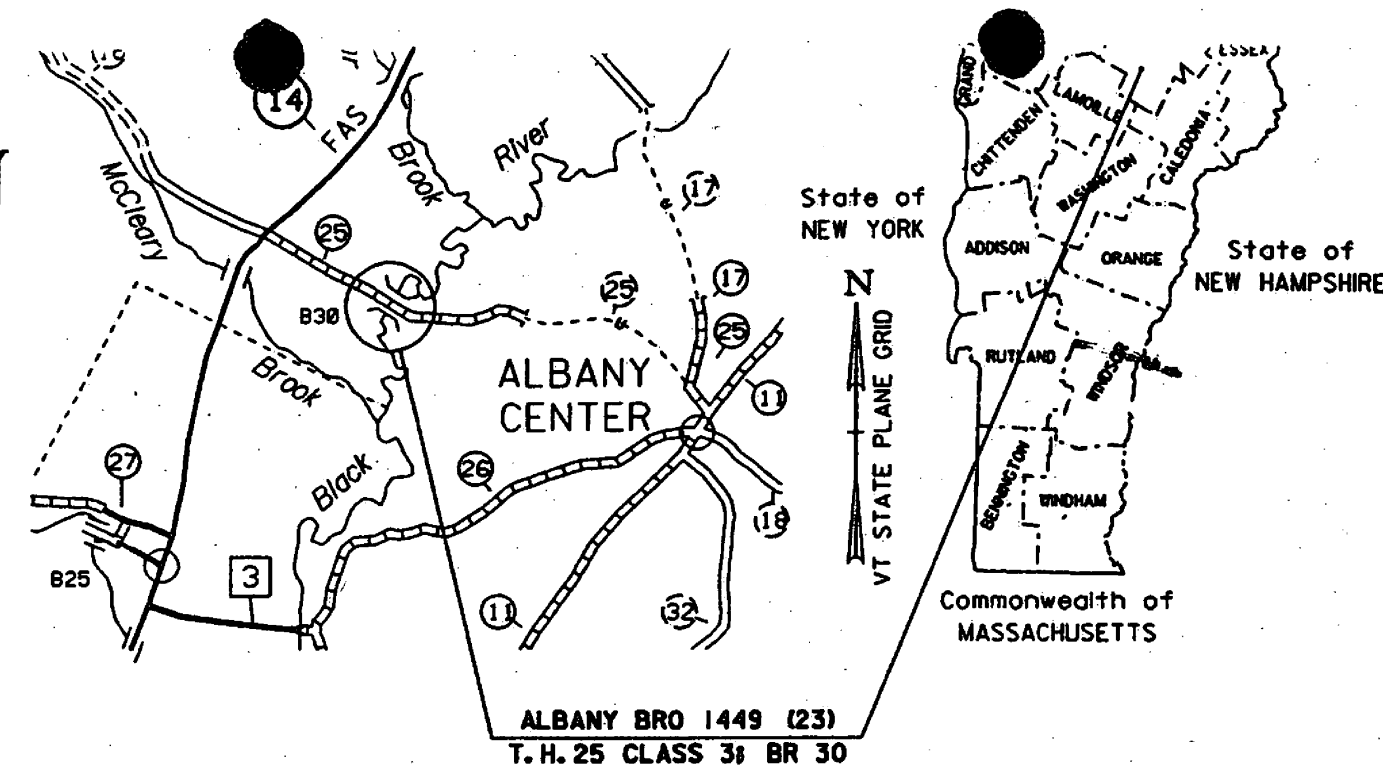

PROPOSED IMPROVEMENT
 BRIDGE PROJECT
 TOWN OF ALBANY
 COUNTY OF ORLEANS



NOTE: T.H. 25 WILL BE CLOSED DURING CONSTRUCTION.

ROUTE NO : T.H. 25 CLASS 3 BRIDGE NO : 30

PROJECT LOCATION : BEGINNING APPROXIMATELY 0.6 KILOMETER FROM THE EXISTING INTERSECTION OF VT RTE. 14 AND T.H. 25 AND PROCEEDING EASTERLY 0.07 KILOMETER ALONG T.H. 25.

PROJECT DESCRIPTION : REPLACEMENT OF THE EXISTING BRIDGE INCLUDING RELATED APPROACH ROADWAY AND CHANNEL WORK.

LENGTH OF STRUCTURE : 20.900 METERS.
 LENGTH OF ROADWAY : 49.100 METERS.
 LENGTH OF PROJECT : 70.000 METERS.

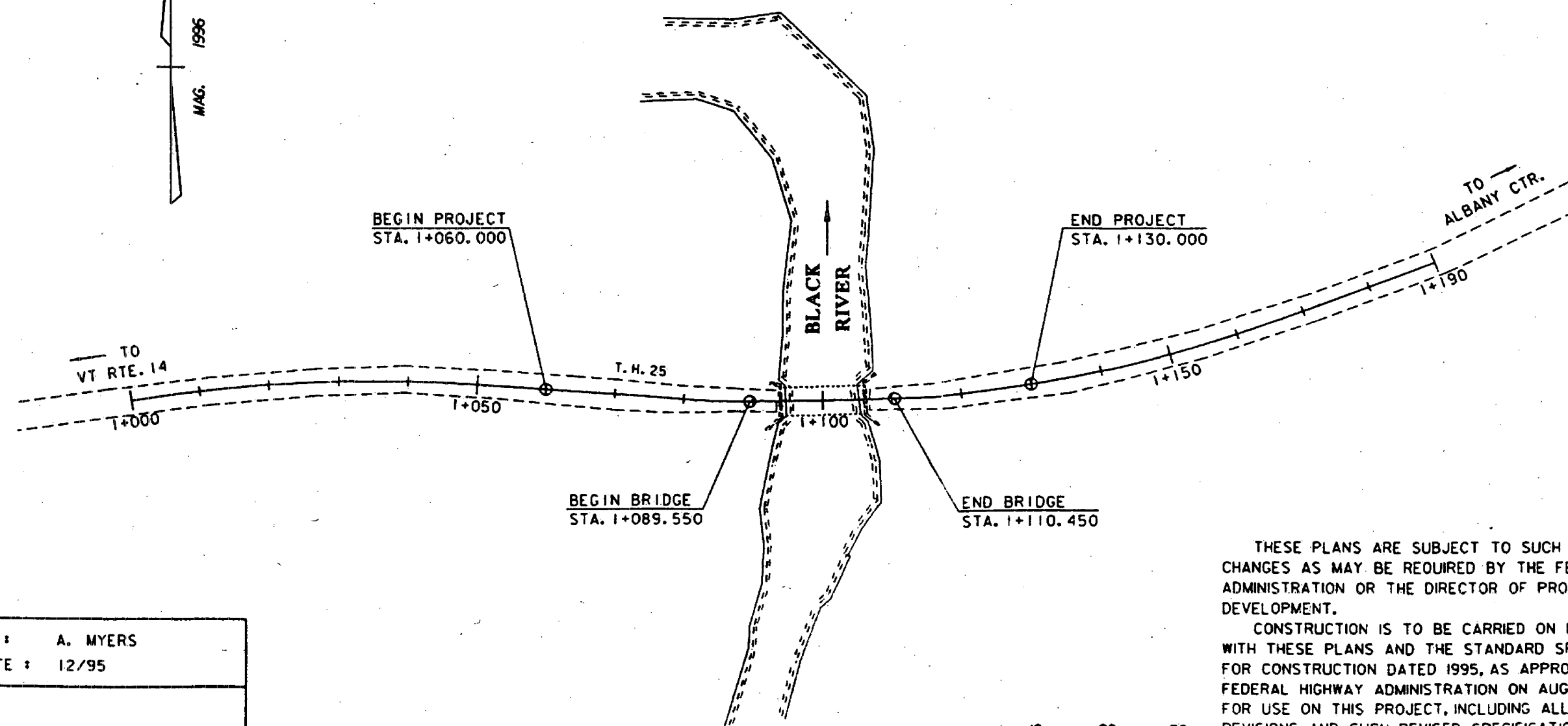
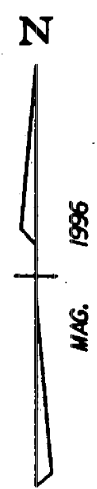

CONVENTIONAL SYMBOLS	
COUNTY LINE	--- --- --- ---
TOWN LINE	--- --- --- ---
RIGHTS OF ACCESS	---X---
ENCLOSURE LINE	---X---X---X---X---
STONE WALL	---o---o---o---o---
RAVELED WAY	---o---o---o---o---
RAILROAD	--- --- --- ---
DRIVEWAY	--- --- --- ---
WELL	⊕
POWER POLE	⊕
TELEPHONE POLE	⊕
FEES	⊕
CONTROL OF ACCESS	--- --- --- ---
PROPERTY LINE	--- --- --- ---
CONTRACTING LINE	---SR---SR---SR---
ROPE RIGHTS	--- --- --- ---
TOP OF CUT	--- --- --- ---
LINE OF SLOPE	--- --- --- ---

SURVEYED BY : A. MYERS
 SURVEYED DATE : 12/95
 DATUM
 VERTICAL ASSUMED
 HORIZONTAL ASSUMED



Metric
 UNLESS NOTED OTHERWISE
 STATIONS ARE IN KILOMETERS
 ELEVATIONS ARE IN METERS
 DIMENSIONS ARE IN MILLIMETERS

THESE PLANS ARE SUBJECT TO SUCH ENGINEERING CHANGES AS MAY BE REQUIRED BY THE FEDERAL HIGHWAY ADMINISTRATION OR THE DIRECTOR OF PROJECT DEVELOPMENT.
 CONSTRUCTION IS TO BE CARRIED ON IN ACCORDANCE WITH THESE PLANS AND THE STANDARD SPECIFICATIONS FOR CONSTRUCTION DATED 1995, AS APPROVED BY THE FEDERAL HIGHWAY ADMINISTRATION ON AUGUST 21, 1995 FOR USE ON THIS PROJECT, INCLUDING ALL SUBSEQUENT REVISIONS AND SUCH REVISED SPECIFICATIONS AND SPECIAL PROVISIONS AS ARE INCORPORATED IN THESE PLANS.

DIRECTOR OF PROJECT DEVELOPMENT	
APPROVED _____	DATE _____
PROJECT MANAGER :	
PROJECT NAME : ALBANY	
PROJECT NUMBER : BRO 1449 (23)	
SHEET _____	OF _____ SHEETS

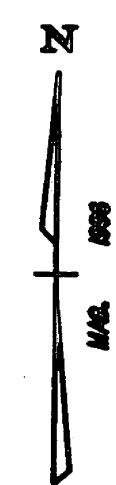
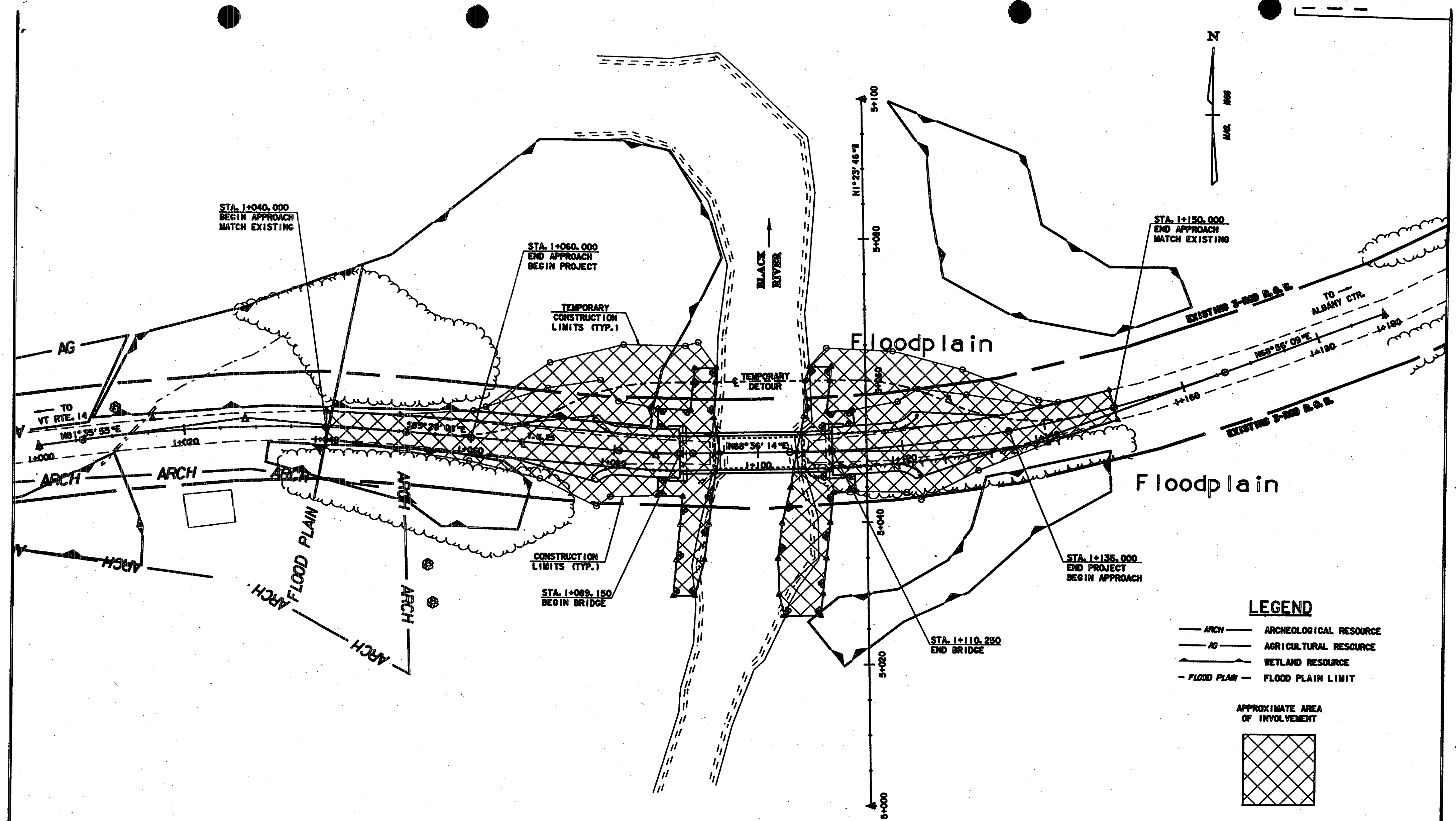

STA. 1+150.000
END APPROACH
MATCH EXISTING

STA. 1+060.000
END APPROACH
BEGIN PROJECT

STA. 1+040.000
BEGIN APPROACH
MATCH EXISTING

TEMPORARY
CONSTRUCTION
LIMITS (TYP.)

BLACK
RIVER

Floodplain

Floodplain

TEMPORARY
DETOUR

STA. 1+135.000
END PROJECT
BEGIN APPROACH

CONSTRUCTION
LIMITS (TYP.)

STA. 1+089.150
BEGIN BRIDGE

STA. 1+110.250
END BRIDGE

LEGEND

- ARCH — ARCHEOLOGICAL RESOURCE
- AG — AGRICULTURAL RESOURCE
- WETLAND RESOURCE
- FLOOD PLAN - FLOOD PLAIN LIMIT

APPROXIMATE AREA
OF INVOLVEMENT

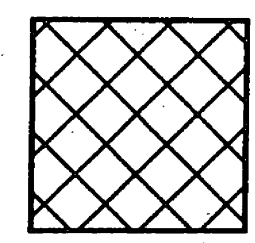

RESOURCE SHEET



PROJECT NAME:	ALBANY	PLOT DATE:	24-AUG-2000
PROJECT NUMBER:	BRO 1449 (23)	DRAWN BY:	
FILE NAME:	95\316\Structures\316res.d	CHECKED BY:	
PROJECT MANAGER:		SHEET	OF

RIGHT - OF

TABLE OF PROPERTY ACQUISITION

PARCEL NO.	PROPERTY OWNER	SHEET NO.	BEGINNING STATION	ENDING STATION	TAKE	REMAINDER	RIGHT	
					AREA ±	AREA ±	TYPE	(T)(P)
1A	DELETED							
1B	CHARTIER PLACE, INC.	9	1+068.23 RT.	1+132.01 RT.			CONST.	(T)
			1+089.33 RT.	1+093.26 RT.			CHANNEL	(P)
			1+102.72 RT.	1+109.90 RT.			CHANNEL	(P)
2	SCHOLZ, R. FREDRICK & KEMPERS, MARGOT B.	9	1+105.05 LT.	1+136.26 LT.			INSTALL	(T)
			1+100.70 LT.	1+133.35 LT.			DETOUR	(T)
			1+107.27 LT.	1+110.71 LT.			CHANNEL	(P)
3	CHARTIER PLACE, INC. & SCHOLZ, R. FREDRICK & KEMPERS, MARGOT B.	9	1+063.00 LT.	1+095.94 LT.			INSTALL	(T)
			1+065.25 LT.	1+100.80 LT.			DETOUR	(T)
			1+068.90 LT.	1+079.40 LT.			SLOPE	(T)
			1+090.93 LT.	1+094.12 LT.			CHANNEL	(P)

PLAN LEGEND

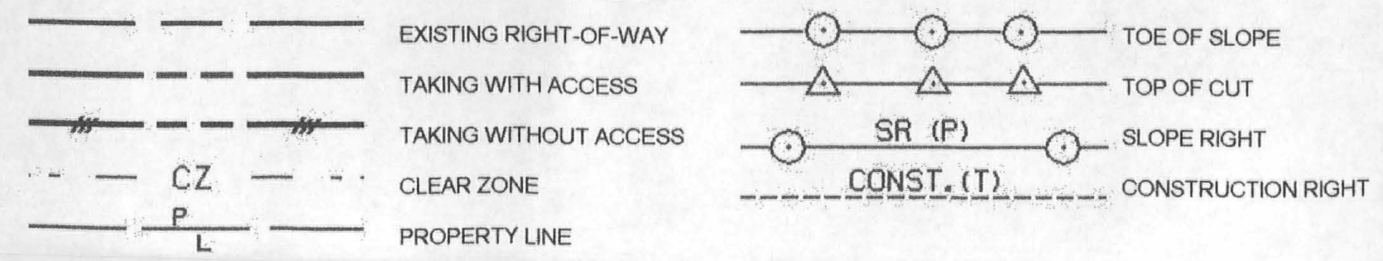

(P)
(T)
DF
DI
CH
DF
CU
C8
SR
UE

