

4" WHITE LINE	
FROM STA.	TO STA.
103+00.00 LT	108+00.00 LT
103+00.00 RT	108+00.00 RT

4" YELLOW LINE (DOUBLE)	
FROM STA.	TO STA.
103+00.00	108+00.00

REMOVAL AND DISPOSAL OF GUARDRAIL	
FROM STA.	TO STA.
103+73.00	104+67.00 LT
104+47.00	104+89.00 RT
105+51.00	105+63.00 LT
105+73.00	105+86.00 RT

TRANSPLANTING SHRUBS	
STA.	OFFSET
103+49.93	24.65 RT
103+89.10	34.93 RT

ANCHOR FOR STEEL BEAM RAIL

VT 12	
FROM STA.	TO STA.
103+85.00 LT	104+20.00 RT
106+28.00 LT	106+37.00 RT

CONSTRUCT DRIVE (GRAVEL)
103+28.50 RT (WIDTH 12')

STEEL BEAM GUARDRAIL, GALVANIZED

VT 12	
FROM STA.	TO STA.
103+80.00	104+28.79 LT
104+15.42	104+39.78 RT
106+07.58	106+28.22 LT
106+18.50	106+42.30 RT

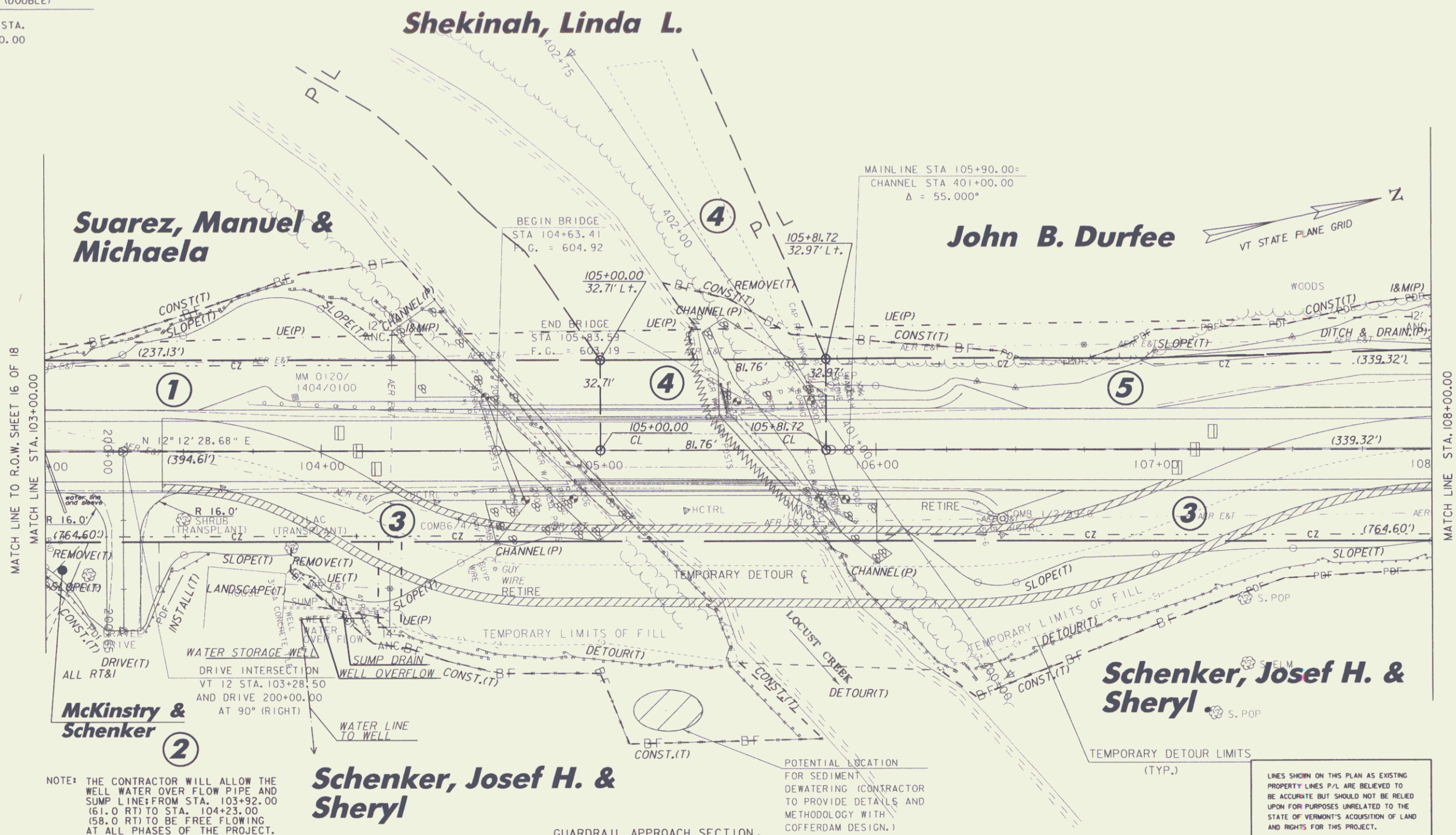

NOTE: THE CONTRACTOR WILL ALLOW THE WELL WATER OVER FLOW PIPE AND SUMP LINE FROM STA. 103+92.00 (61.0 RT) TO STA. 104+23.00 (58.0 RT) TO BE FREE FLOWING AT ALL PHASES OF THE PROJECT. THIS INCLUDES THE PIPES OVER FLOW DITCH TO BE FREE OF OBSTRUCTIONS AT ALL TIMES. THE FLOW OF DITCH IS AS INDICATED.

Schenker, Josef H. & Sheryl

DELINEATOR WITH STEEL POST	
STA.	OFFSET
103+88.00	18' (GREEN)
104+15.00	18' (BLUE)
106+25.00	18' (BLUE)
106+31.00	18' (GREEN)

GUARDRAIL APPROACH SECTION, GALVANIZED NETC 2 RAIL	
FROM STA.	TO STA.
104+28.79	104+58.29 LT
104+39.78	104+69.20 RT
105+78.17	106+07.58 LT
105+89.08	106+18.50 RT

BRIDGE RAILING, GALVANIZED NETC 2 RAIL	
FROM STA.	TO STA.
104+58.29	105+78.17 LT
104+69.20	105+89.08 RT

EXISTING BRIDGE DATA
 SIMPLE SPAN WITH CONCRETE DECK
 YEAR BUILT: 1939
 CLEAR SPAN: 58 FT.
 VERTICAL CLEARANCE: 9.5 FT.
 WATERWAY OF FULL OPENING: 440 SQ. FT.
 EXISTING BRIDGE RAIL: TEMPORARY CONCRETE BARRIER

SCALE 1" = 20'-0"
 20 0 20

LAYOUT SHEET 2

PROJECT NAME: BETHEL
 PROJECT NUMBER: BHF 02413015
 FILE NAME: 95c002\str\sc002bdr.dgn
 PROJECT LEADER: M. EVANS-MONGEON
 DESIGNED BY: U.STANLEY
 PLOT DATE: 05-FEB-2010
 DRAWN BY: G.ROKES
 CHECKED BY: U.STANLEY
 ROW SHEET 17 OF 18