

STATE OF VERMONT
AGENCY OF TRANSPORTATION



PROPOSED IMPROVEMENT

BRIDGE PROJECT
TOWN OF RUTLAND
COUNTY OF RUTLAND
US 7 (PRINCIPAL ARTERIAL)
BRIDGE #103 OVER EAST CREEK

BEGINNING ON US 7 IN THE TOWN OF RUTLAND APPROXIMATELY 1.869 KM (1.161 MILES) NORTH OF THE CITY OF RUTLAND AND EXTENDING NORTH 0.165 KM (0.103 MILES).
LENGTH OF BRIDGE = 35.007 M
LENGTH OF ROADWAY = 174.993 M
LENGTH OF PROJECT = 210.000 M
WORK TO BE PERFORMED UNDER THIS PROJECT CONSISTS OF REPLACEMENT OF BRIDGE #103 AT EXISTING LOCATION WITH ROADWAY APPROACH WORK.
LENGTH OF R.O.W. PROJECT = 307.15M (1007.7')

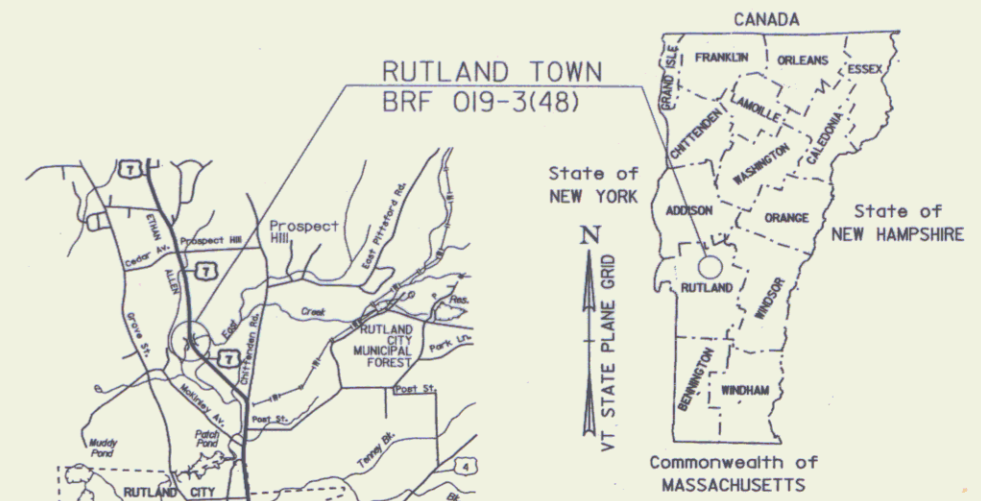

R. O. W. PLANS

BEGIN R.O.W. PROJECT
BRF 019-3(48)
STA. 2+156.93
9.54M (31.3') LT.

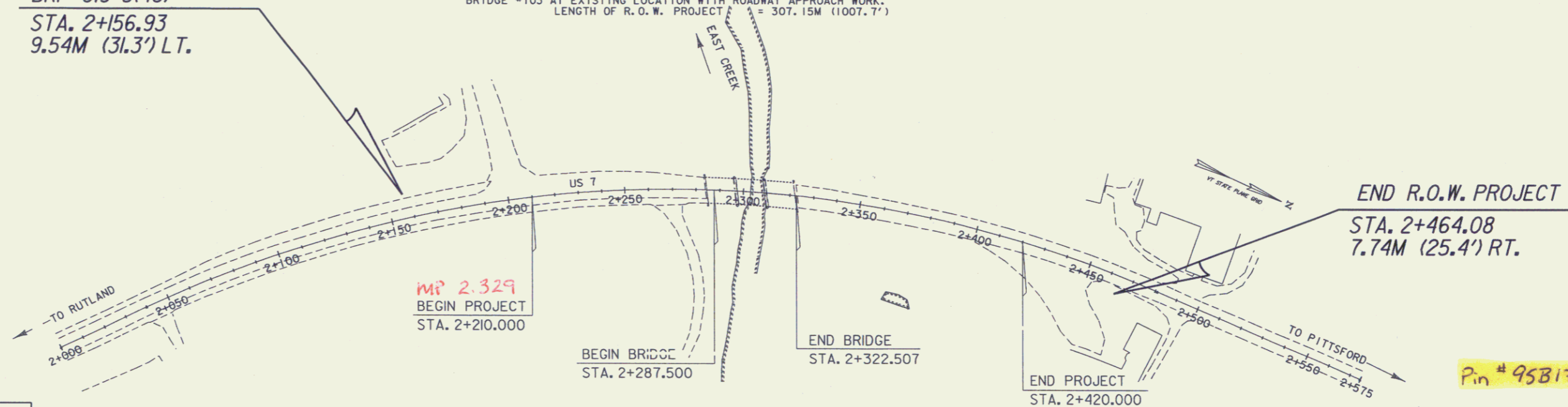

END R.O.W. PROJECT
STA. 2+464.08
7.74M (25.4') RT.

MP 2.329
BEGIN PROJECT
STA. 2+210.000

BEGIN BRIDGE
STA. 2+287.500

END BRIDGE
STA. 2+322.507

END PROJECT
STA. 2+420.000
MP 2.460

Pin # 958172

CONVENTIONAL SYMBOLS	
COUNTY LINE	— — — — —
TOWN LINE	— — — — —
LIMITS OF ACCESS	○ — ○ — ○ — ○
POINT OF ACCESS	X — X — X — X
FENCE LINE	— — — — —
STONE WALL	— — — — —
TRAVELED WAY	— — — — —
RAILROAD	— — — — —
SURVEY LINE	— — — — —
CULVERT	— — — — —
POWER POLE	⊕
TELEPHONE POLE	⊕
TREES	⊕
CONTROL OF ACCESS	/// — /// — ///
PROPERTY LINE	— — — — —
R.O.W. TAKING LINE	— — — — —
SLOPE RIGHTS	○ — SR — △ — SR — ○
TOP OF CUT	△
TOE OF SLOPE	○

SURVEYED BY : L. ORVIS
SURVEYED DATE : 09/95
DATUM
VERTICAL NAVD 88
HORIZONTAL NAD 83/92

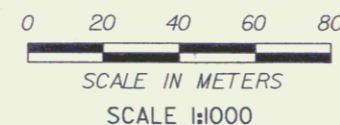

THESE PLANS ARE SUBJECT TO SUCH ENGINEERING CHANGES AS MAY BE REQUIRED BY THE FEDERAL HIGHWAY ADMINISTRATION OR THE DIRECTOR OF PROJECT DEVELOPMENT.
CONSTRUCTION IS TO BE CARRIED ON IN ACCORDANCE WITH THESE PLANS AND THE STANDARD SPECIFICATIONS FOR CONSTRUCTION DATED 2001, AS APPROVED BY THE FEDERAL HIGHWAY ADMINISTRATION ON JANUARY 4, 2001 FOR USE ON THIS PROJECT, INCLUDING ALL SUBSEQUENT REVISIONS AND SUCH REVISED SPECIFICATIONS AND SPECIAL PROVISIONS AS ARE INCORPORATED IN THESE PLANS.
05-OCT-2004

Metric
UNLESS NOTED OTHERWISE
STATIONS ARE IN KILOMETERS
ELEVATIONS ARE IN METERS
DIMENSIONS ARE IN MILLIMETERS

APPROVED: *Robert J. Felton* DATE 3/4/05
Director of Program Development
APPROVED: *William J. Moore* DATE 3/4/05
Chief of Right of Way
RUTLAND TOWN
BRF 019-3(48)
R. O. W. SHEET 1 OF 19 SHEETS

PRELIMINARY INFORMATION SHEET



INDEX OF SHEETS

1. TITLE SHEET
2. PRELIMINARY INFORMATION
- 3-6. TYPICAL SECTIONS
- 7-8. QUANTITY SHEETS
9. EARTHWORK SHEET
10. TIE SHEET
- 11-14. SURVEY PLANS
15. BLANK
- 16-18. LAYOUT PLANS
- 19-22. PROFILES
23. WIDTH & SUPERELEVATION
24. MATERIAL TRANSITION DETAIL
- 25-27. BLANK
- 28-30. EXISTING SIGNS, PAVEMENT MARKING & NEW SIGN SHEETS
31. TRAFFIC SIGN SUMMARY SHEET
32. CONSTRUCTION APPROACH SIGNING
33. BORING LAYOUT INFORMATION
- 34-35. BORING LOGS
36. PLAN & ELEVATION
37. RESOURCE PLAN
38. EROSION CONTROL - EXISTING GRADING PLAN
39. EROSION CONTROL - FINAL GRADING PLAN
- 40-41. BRIDGE RAIL DETAILS
- 42-51. ROADWAY CROSS SECTIONS
- 52-53. DRIVE CROSS SECTIONS
- 54-60. CHANNEL CROSS SECTIONS

FINAL HYDRAULIC REPORT

HYDROLOGIC DATA

Date: 1-22-03

DRAINAGE AREA: 129.5 sq km

CHARACTER OF TERRAIN: Mountainous and forested

STREAM CHARACTERISTICS: Incised, sinuous to meandering channel with eroded banks.

NATURE OF STREAMBED: Gravel, cobbles and boulders

PEAK FLOW DATA

Q 2.33 = 29.7 cms	Q 50 = 107.6 cms
Q 10 = 65.1 cms	Q 100 = 124.6 cms
Q 25 = 90.6 cms	Q 500 = 165.7 cms

DATE OF FLOOD RECORD: November 1927

ESTIMATED DISCHARGE: Unknown

WATER SURFACE ELEV.: Unknown

NATURAL STREAM VELOCITY: @ Q50 = 1.2 mps

ICE CONDITIONS: Moderate

DEBRIS: Moderate

DOES THE STREAM REACH MAXIMUM HIGHWATER ELEV. RAPIDLY? Yes

IS ORDINARY RISE RAPID? Yes

IS STAGE AFFECTED BY UPS TREAM OR DOWNSTREAM CONDITIONS? Yes

IF YES, DESCRIBE: Several dams are within this watershed to include the Chittenden Reservoir, Glen Dam and the Rutland City Reservoir.

WATERSHED STORAGE: 3% HEADWATERS: _____

UNIFORM: _____ X

IMMEDIATELY ABOVE SITE: _____

EXISTING STRUCTURE INFORMATION

STRUCTURE TYPE: Three span concrete T-beam bridge

YEAR BUILT: 1931

CLEAR SPAN(NORMAL TO STREAM): 29.3 m

VERTICAL CLEARANCE ABOVE STREAMBED: 4.2 m

WATERWAY OF FULL OPENING: 87 sq m

DISPOSITION OF STRUCTURE: Remove

TYPE OF MATERIAL UNDER SUBSTRUCTURE: refer to boring logs

WATER SURFACE ELEVATIONS AT:

Q2.33 = 194.5 m	VELOCITY = 1.4 mps
Q10 = 195.0 m	" 1.9 mps
Q25 = 195.4 m	" 2.2 mps
Q50 = 195.6 m	" 2.5 mps
Q100 = 195.8 m	" 2.7 mps

LONG TERM STREAMBED CHANGES: None noted

IS THE ROADWAY OVERTOPPED BELOW Q100: No

FREQUENCY: Above Q100

RELIEF ELEVATION: 196.6 m

DISCHARGE OVER ROAD @Q100: None

UPSTREAM STRUCTURE

TOWN: Rutland DISTANCE: 0.6 km

HIGHWAY #: TH-1 FAS 165 STRUCTURE #: 5

CLEAR SPAN: 40 m CLEAR HEIGHT: 3 m

YEAR BUILT: 1995 FULL WATERWAY: unknown

STRUCTURE TYPE: Single span welded plate girder bridge

DOWNSTREAM STRUCTURE

TOWN: Rutland DISTANCE: 1.6 km

HIGHWAY #: TH-19 STRUCTURE #: 9

CLEAR SPAN: 29 m CLEAR HEIGHT: 4 m

YEAR BUILT: 1950 FULL WATERWAY: unknown

STRUCTURE TYPE: Single span rolled beam bridge

LOAD FACTOR - LOAD RATING (TONS)

LOADING LEVELS	TRUCK						
	M	MS	3S2	6 AXLE	3A. STR.	4A. STR.	SA SEM
INVENTORY							
POSTED							
OPERATING							

TRAFFIC DATA

YEAR	ADT	DHV	% D	% T	ADTT
2006	9400	1100	56	7	83
2026	12400	1200	56	8	13

20 year ESAL for flexible pavement from 2006 to 2026 : 10 464 000

40 year ESAL for flexible pavement from 2006 to 2046 : 27 425 000

Design Speed : 80 km/h

PROPOSED STRUCTURE

STRUCTURE TYPE: Single span integral abutment bridge

CLEAR SPAN(NORMAL TO STREAM): 33 m

VERTICAL CLEARANCE ABOVE STREAMBED: 3.7 m

WATERWAY OF FULL OPENING: 77 sq m

WATER SURFACE ELEVATIONS AT:

Q2.33 = 194.4 m	VELOCITY = 1.4 mps
Q10 = 194.9 m	" 1.9 mps
Q25 = 195.2 m	" 2.2 mps
Q50 = 195.4 m	" 2.4 mps
Q100 = 195.6 m	" 2.7 mps

IS THE ROADWAY OVERTOPPED BELOW Q100: No

FREQUENCY: Above Q100

RELIEF ELEVATION: 196.7 m

DISCHARGE OVER ROAD @Q100: None

AVERAGE LOW ELEVATION OF SUPERSTRUCTURE: 196.04 m

VERTICAL CLEARANCE: @ Q50 = 0.6 m

SCOUR: 1 meter of contraction scour at Q500

REQUIRED CHANNEL PROTECTION: Stone Fill, Type III

PERMIT INFORMATION

AVERAGE DAILY FLOW: 3.0 cms DEPTH OR ELEVATION: _____

ORDINARY LOW WATER: 1.5 cms 0.3 m

ORDINARY HIGH WATER: 13.0 cms 1.0 m

TEMPORARY BRIDGE REQUIREMENTS

STRUCTURE TYPE: Single span bridge

CLEAR SPAN (NORMAL TO STREAM): 15 m (centered on the stream)

VERTICAL CLEARANCE ABOVE STREAMBED: 196 m (minimum low beam elev.)

WATERWAY AREA OF FULL OPENING: 36 sq m (minimum)

ADDITIONAL INFORMATION

Stone fill should not constrict channel, abutment stems should be set at or below elevation 194.5m (below the stone fill). Piles should be designed to withstand a freestanding load down to elevation 190.3m.

DESIGN CRITERIA

1. DESIGN LIVE LOAD AASHTO MS 22.5
2. DESIGN SPAN 40 m
3. ALLOWABLE LOAD FOR SPREAD FOOTINGS ON SOIL 27.8 Mpa ON LEDGE
4. ALLOWABLE LOAD FOR PILING TYPE _____ ESTIMATED LENGTH _____
5. STRUCTURAL STEEL AASHTO M270/M270M GRADE 345W
6. REINFORCING STEEL GRADE 420
7. CONCRETE CLASS A (HPC-A) f'c: 30 Mpa
- CONCRETE CLASS B (HPC-B) f'c: 25 Mpa
8. SOIL UNIT WEIGHT 22.00 Kn/m³
9. DESIGN LOAD FOR SPREAD FOOTINGS ON SOIL _____

TRAFFIC MAINTENANCE

1. IS TRAFFIC TO BE MAINTAINED? YES
- IF YES, ON EXISTING STRUCTURE? YES
- OR ON TEMPORARY BRIDGE? YES
- ONE OR TWO-WAY TRAVEL? TWO WAY
2. TRAFFIC CONTROL SIGNALS REQUIRED? NO
3. ARE SIDEWALKS REQUIRED? NO
- IF SO, ON WHAT SIDE? _____

PROJECT NAME: Rutland Town

PROJECT NUMBER: BRF 019-3(48)

FILE NAME: 95b172p1.xls PLOT DATE: 09/05/2003

PROJECT MANAGER: Whitcomb DRAWN BY: L. Bullock

DESIGNED BY: T. Lackey CHECKED BY: _____

PRELIMINARY INFORMATION SHEET SHEET 2 OF 19

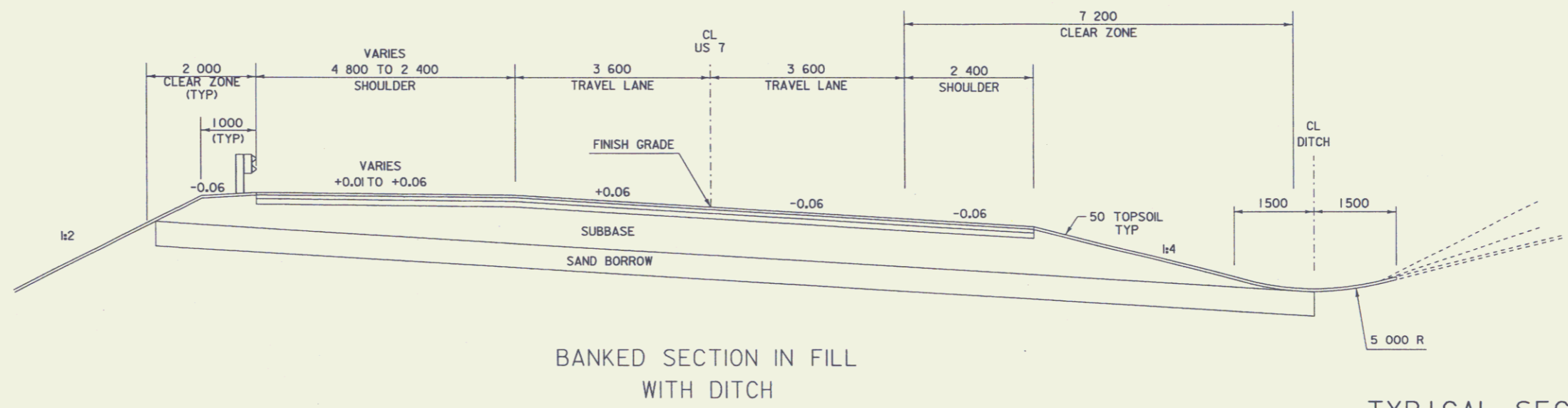
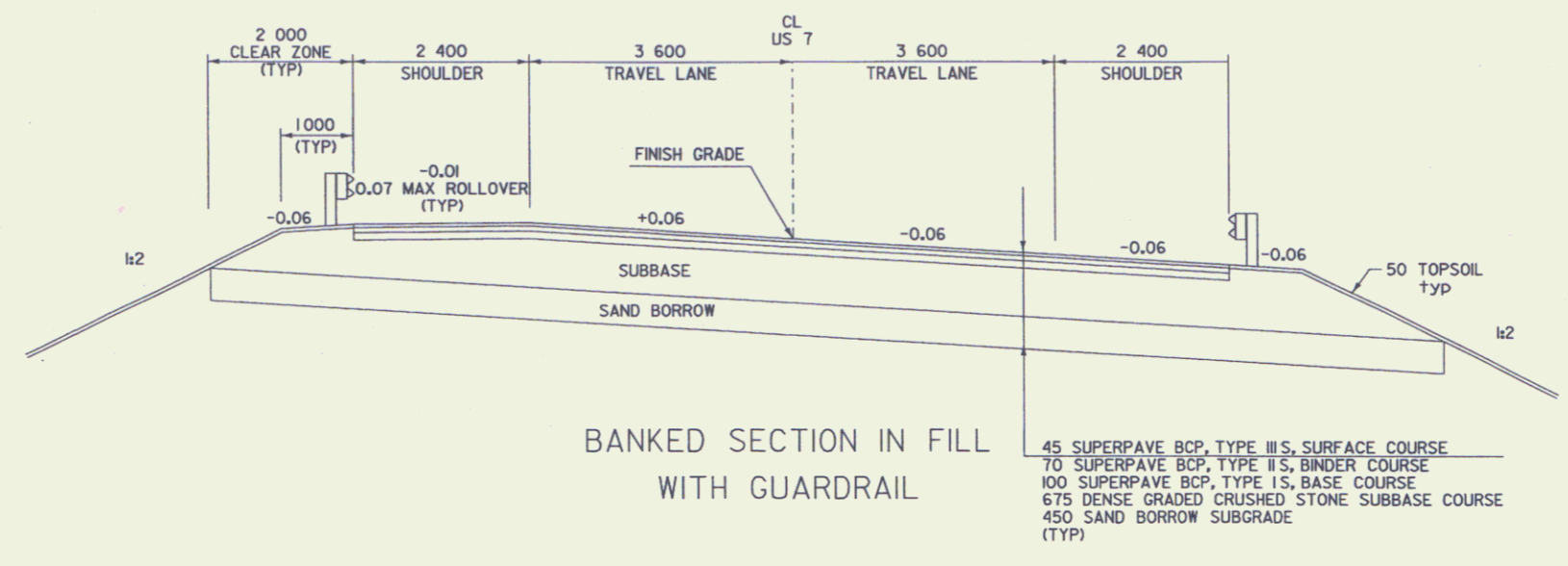

**TYPICAL SECTIONS I
ROADWAY**

DATUM	_____
VERTICAL	_____
HORIZONTAL	_____

PROJECT:	RUTLAND TOWN	PROJECT NO.:	BRF 019-3(48)
DESIGN FILE NAME:	95bi72/structures/abi72typ.dgn	PLOT DATE:	20-SEP-2004
IPARM FILE NAME:	abi72typ.i	SURVEY DATE:	
SURVEYED BY:		DRAWN BY:	T. LACKEY
SQUAD LEADER:	R. WHITCOMB	SHEET	3 OF 19



**SEEDING FORMULA
RURAL AREAS**

% MASS	Kg/ha	NAME	PUR %	GERM %
37.5	26.0	CREeping RED FESCUE	98	85
37.5	26.0	TALL FESCUE	95	90
5.0	4.0	RED TOP	95	90
15.0	10.0	BIRDSFOOT TREFOIL	98	85
5.0	4.0	ANNUAL RYE GRASS	95	85
100.0	70.0			

GENERAL NOTES

SEED MIXTURE: SHALL NOT HAVE A WEED CONTENT EXCEEDING 0.40% BY MASS AND SHALL BE FREE OF ALL NOXIOUS SEED.

SEED: TO BE APPLIED PER SEEDING FORMULAS OR AS DIRECTED BY THE ENGINEER.

FERTILIZER: FORMULA 10-20-10, TO BE USED WITH SEED, APPLIED AT THE RATE OF 560 kg/ha. (HYDRO SEEDERS MAY USE 19-19-19 FORMULA).

AGRICULTURAL LIMESTONE: TO BE APPLIED AT THE RATE OF 4500 kg/ha, OR AS DIRECTED BY THE ENGINEER.

HAY MULCH: TO BE PLACED ON EARTH SLOPES AT THE RATE OF 4500 kg/ha, OR AS DIRECTED BY THE ENGINEER.

TOPSOIL: TO BE USED WITH SEED AS INDICATED ON THE PLANS, OR AS DIRECTED BY THE ENGINEER.

MARKER POSTS: TO BE PLACED AS INDICATED OR AS DIRECTED BY THE ENGINEER.

SLOPE ROUNDING: ALL CUT SLOPES TO BE ROUNDED IN ACCORDANCE WITH STANDARD SHEET B-5M.

PAY LIMITS OF SAND BORROW: WHEN USED IN CONJUNCTION WITH UNDERDRAIN - SEE STANDARD SHEET D-2M.

TACK COAT: EMULSIFIED ASPHALT IS TO BE APPLIED AT THE RATE OF 0.07 L/m² BETWEEN SUCCESSIVE COURSES OF PAVEMENT AS DIRECTED BY THE ENGINEER.

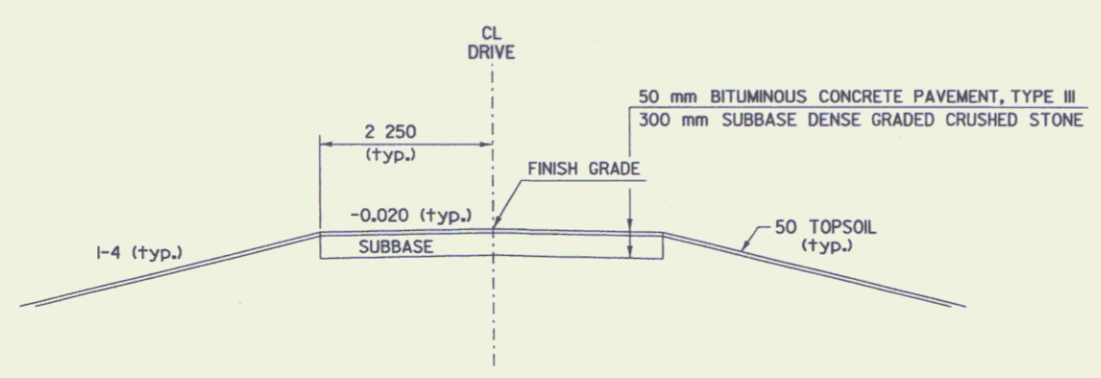

TYPICAL FOR DRIVE @ 2+263.000 RT.

**TYPICAL SECTIONS 2
DRIVEWAY**

DATUM
VERTICAL _____
HORIZONTAL _____

PROJECT: RUTLAND TOWN	PROJECT NO.: BRF 019-3(48)
DESIGN FILE NAME: 95bt72/structures/sbt72typ.dgn	PLOT DATE: 20-SEP-2004
IPARM FILE NAME: sbt72ty2.i	SURVEY DATE:
SURVEYED BY:	DRAWN BY: T. LACKEY
SQUAD LEADER: R. WHITCOMB	SHEET 4 OF 19

4

Profile

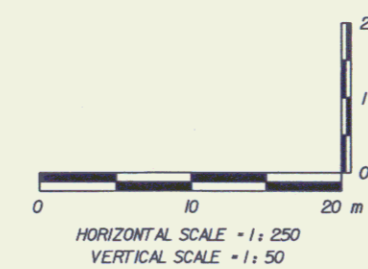
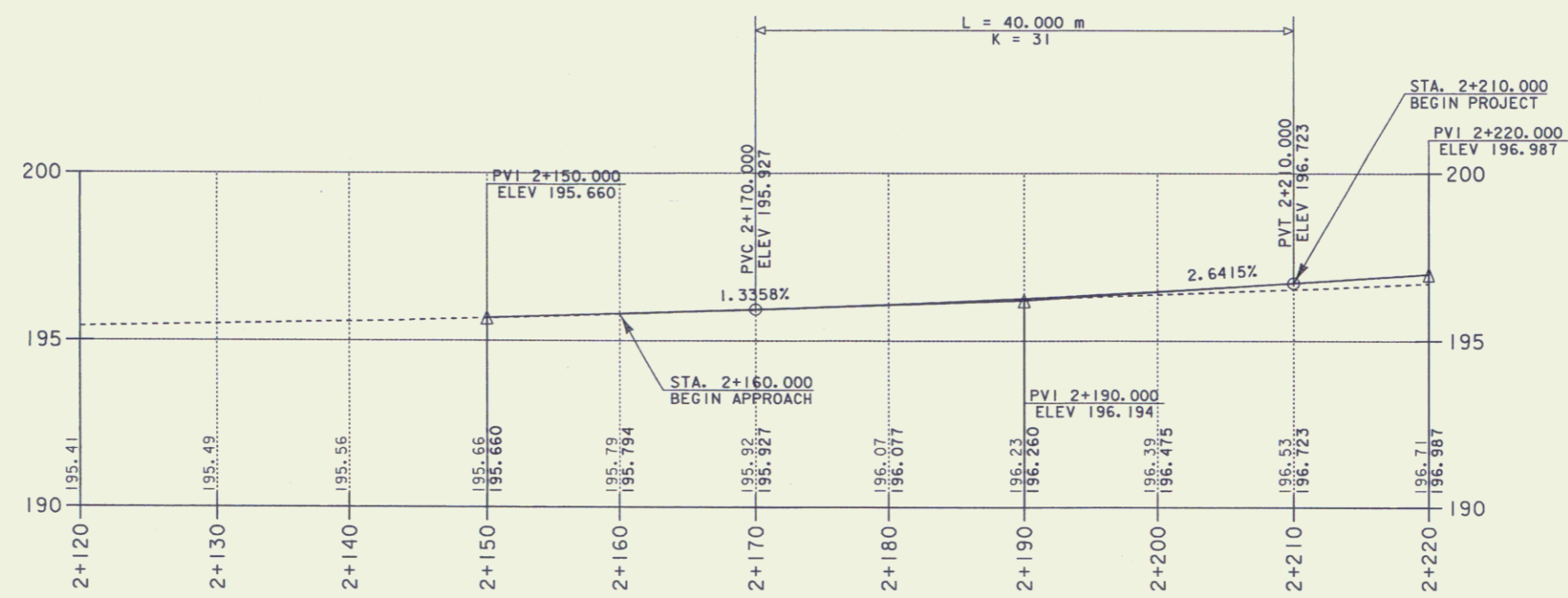

PROFILE MAINLINE SHEET 1

PROJECT NAME: RUTLAND TOWN	PLOT DATE: 17-SEP-2004
PROJECT NUMBER: BRF 019-3(48)	DRAWN BY: L. BULLOCK
FILE NAME: sb172p-fl1	CHECKED BY:
PROJECT LEADER: R. WHITCOMB	SHEET 5 OF 19
DESIGNED BY: T. LACKEY	

Profile

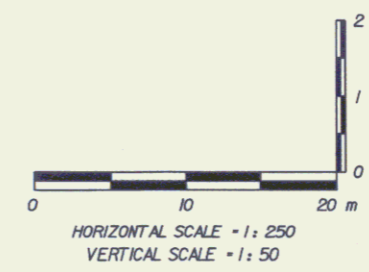
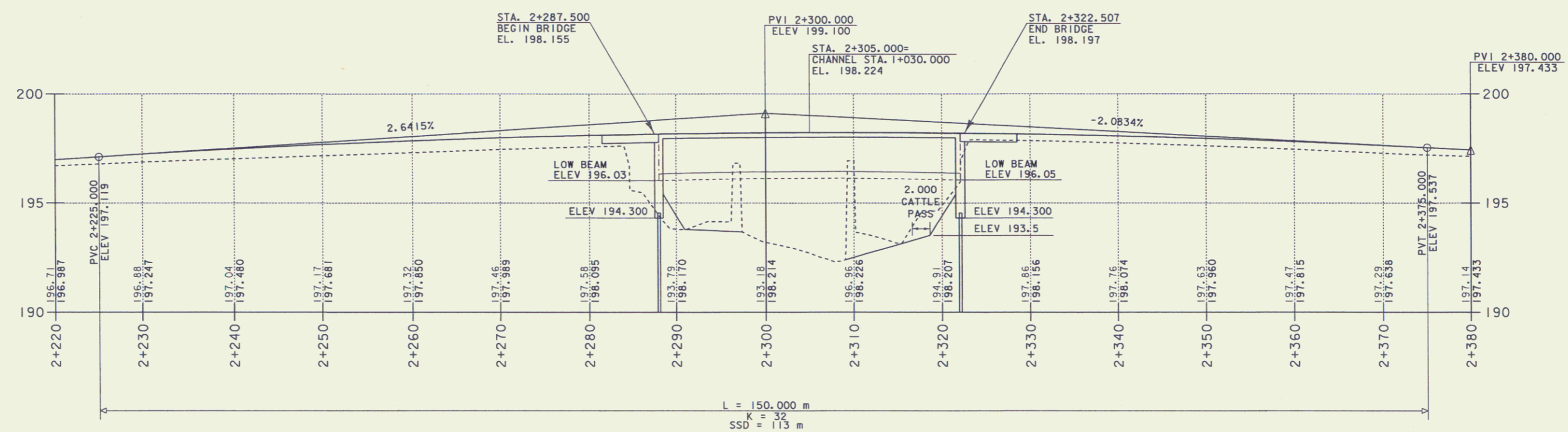

PROFILE MAINLINE SHEET 2

PROJECT NAME:	RUTLAND TOWN	PLOT DATE:	17-SEP-2004
PROJECT NUMBER:	BRF 019-3(48)	DRAWN BY:	L. BULLOCK
FILE NAME:	eb172p2.1	CHECKED BY:	
PROJECT LEADER:	R. WHITCOMB	SHEET	6 OF 19
DESIGNED BY:	T. LACKEY		

Profile

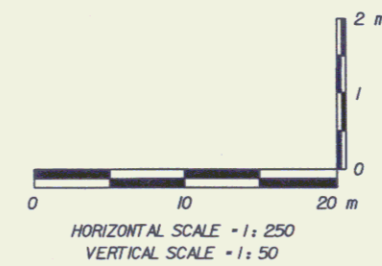
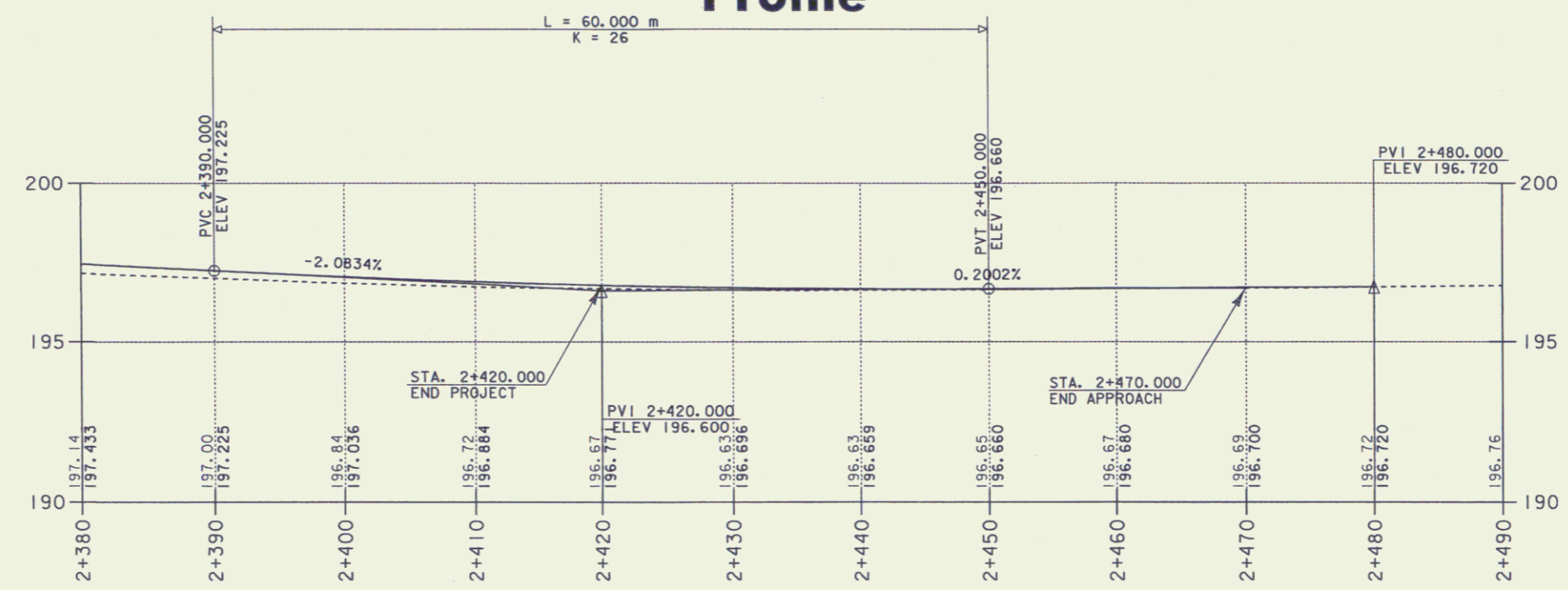

PROFILE MAINLINE SHEET 3

PROJECT NAME:	RUTLAND TOWN	PLOT DATE:	17-SEP-2004
PROJECT NUMBER:	BRF 019-3(48)	DRAWN BY:	L. BULLOCK
FILE NAME:	eb172pf3.1	CHECKED BY:	
PROJECT LEADER:	R. WHITCOMB	SHEET	7 OF 19
DESIGNED BY:	T. LACKEY		

Profile

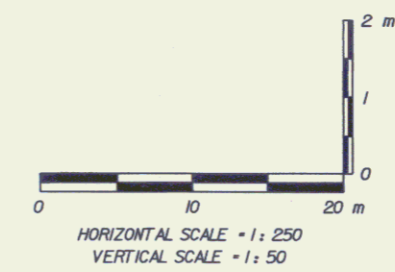
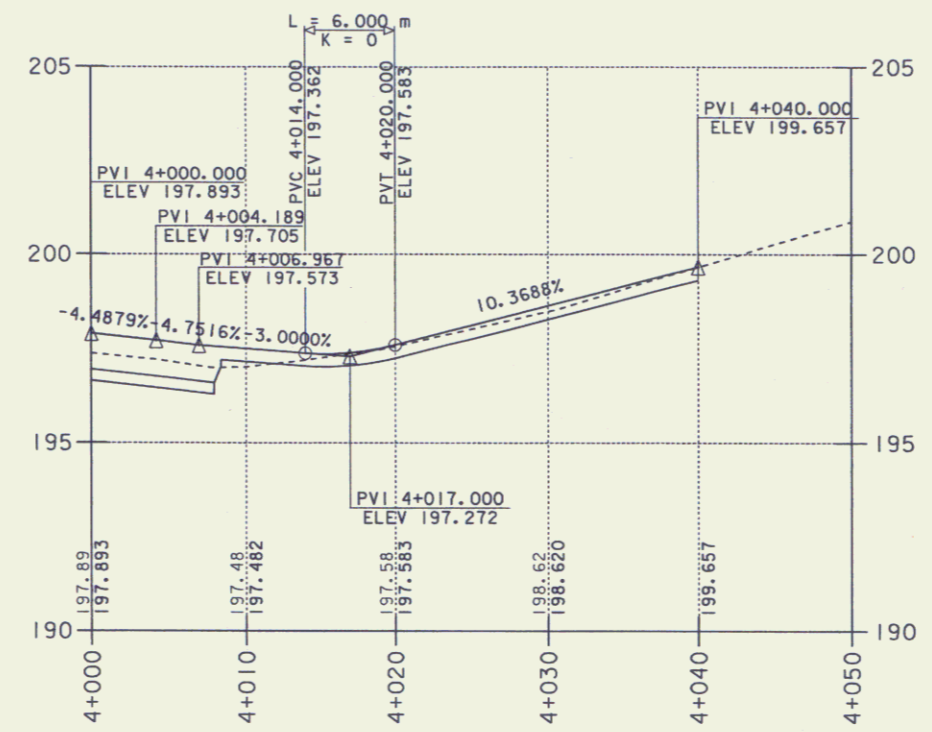

PROFILE DRIVE AT 2+263 RT

PROJECT NAME: RUTLAND TOWN	PLOT DATE: 17-SEP-2004
PROJECT NUMBER: BRF 019-3(48)	DRAWN BY: L. BULLOCK
FILE NAME: sbt2p-f6.j	CHECKED BY:
PROJECT LEADER: WHITCOMB	SHEET 8 OF 19
DESIGNED BY:	

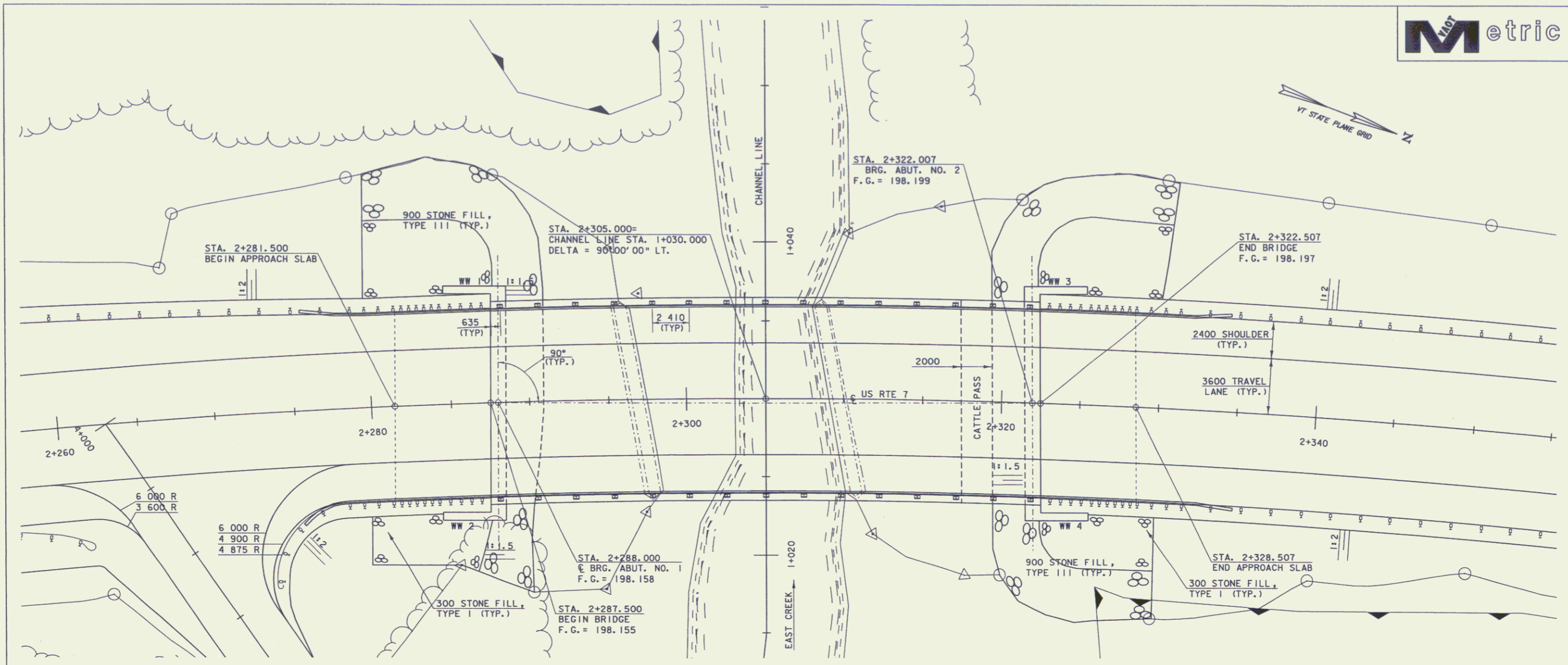
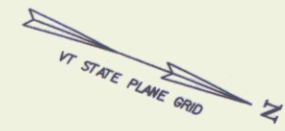

PLAN

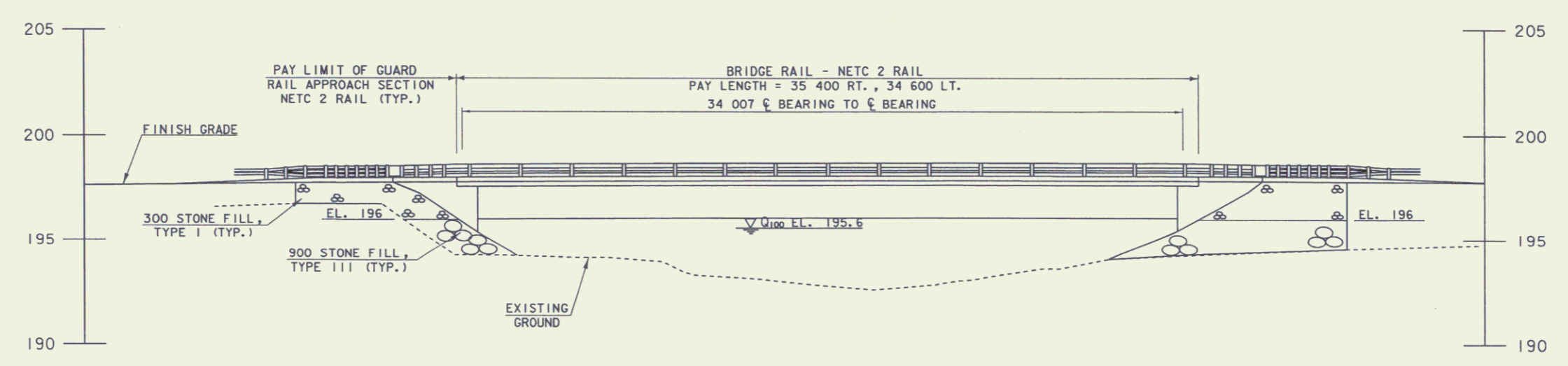

PLAN & ELEVATION

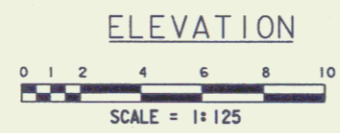

PROJECT NAME:	RUTLAND TOWN	PLOT DATE:	17-SEP-2004
PROJECT NUMBER:	BRF 019-3(48)	DRAWN BY:	L. BULLOCK
FILE NAME:	95bt72/str/sb72pe.dgn	CHECKED BY:	T. LACKEY
PROJECT LEADER:	R. WHITCOMB	SHEET	9 OF 19
DESIGNED BY:	T. LACKEY		

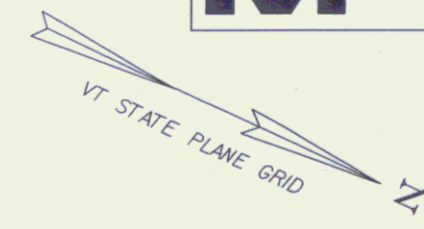

- Soil Limit
- Ordinary High Water
- 50' Riparian Corridor
- Wetland Limit
- 50' Wetland Buffer Limit
- R.O.W. & Property Lines
- Sensitive Area (SA)

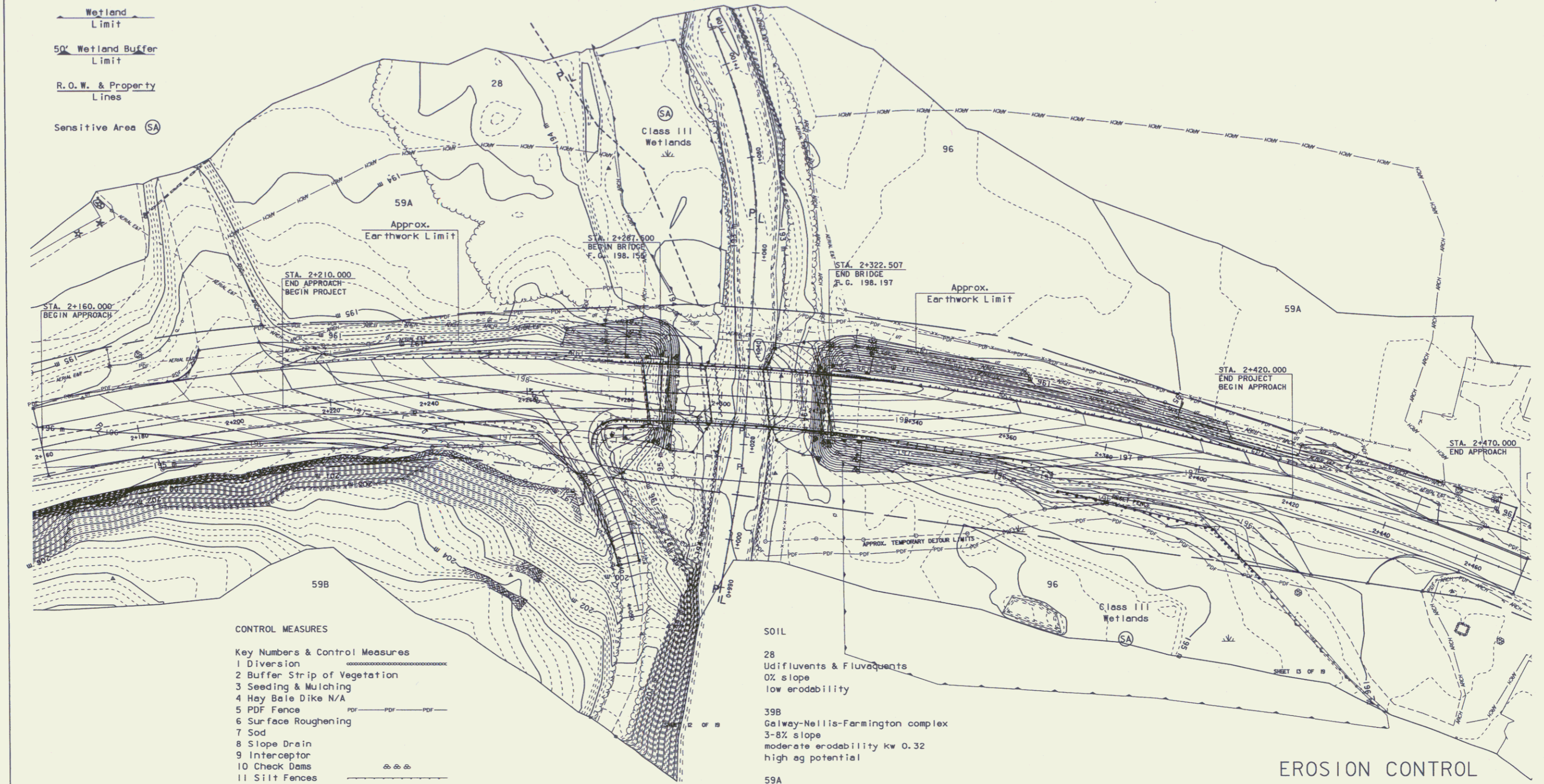

CONTROL MEASURES

- Key Numbers & Control Measures
- 1 Diversion
 - 2 Buffer Strip of Vegetation
 - 3 Seeding & Mulching
 - 4 Hay Bale Dike N/A
 - 5 PDF Fence
 - 6 Surface Roughening
 - 7 Sod
 - 8 Slope Drain
 - 9 Interceptor
 - 10 Check Dams
 - 11 Silt Fences
 - 12 Sediment Basin
 - 13 Sediment Trap
 - 14 Perimeter Diversion
 - 15 Stabilized Construction Entrance
 - 16 Erosion Matting
 - 17 Inlet Protection
 - 18 Filter Curtain
 - 19 Geotextile Under Stone Fill
 - 20 Stone Fill

SOIL

- 28 Udifluvents & Fluvaquents
0% slope
low erodability
- 39B Galway-Nellis-Farmington complex
3-8% slope
moderate erodability kw 0.32
high ag potential
- 59A Deerfield loamy sand
0-4% slope
low erodability kw 0.17
good ag potential
- 96 Udipsamments
0% slope
low erodability

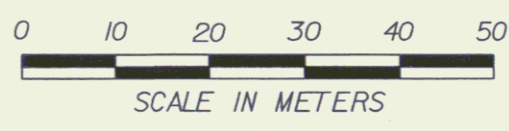

SCALE 1:400

EROSION CONTROL
FINAL GRADING PLAN
FINAL EP&SC PLAN

DATUM SHEET 1 OF 19
VERTICAL NAVD 88 GPS
HORIZONTAL NAVD 83/92 GPS

PROJECT: RUTLAND TOWN	PROJECT NO.: BRF 019-3(48)
DESIGN FILE NAME: 95b172/structures/sb12ero.dgn	PLOT DATE: 17-SEP-2004
IPARM FILE NAME: sb172er2.1	SURVEY DATE:
SURVEYED BY:	DRAWN BY: T LACKEY
SQUAD LEADER: R WHITCOMB	SHEET 10 OF 19

10

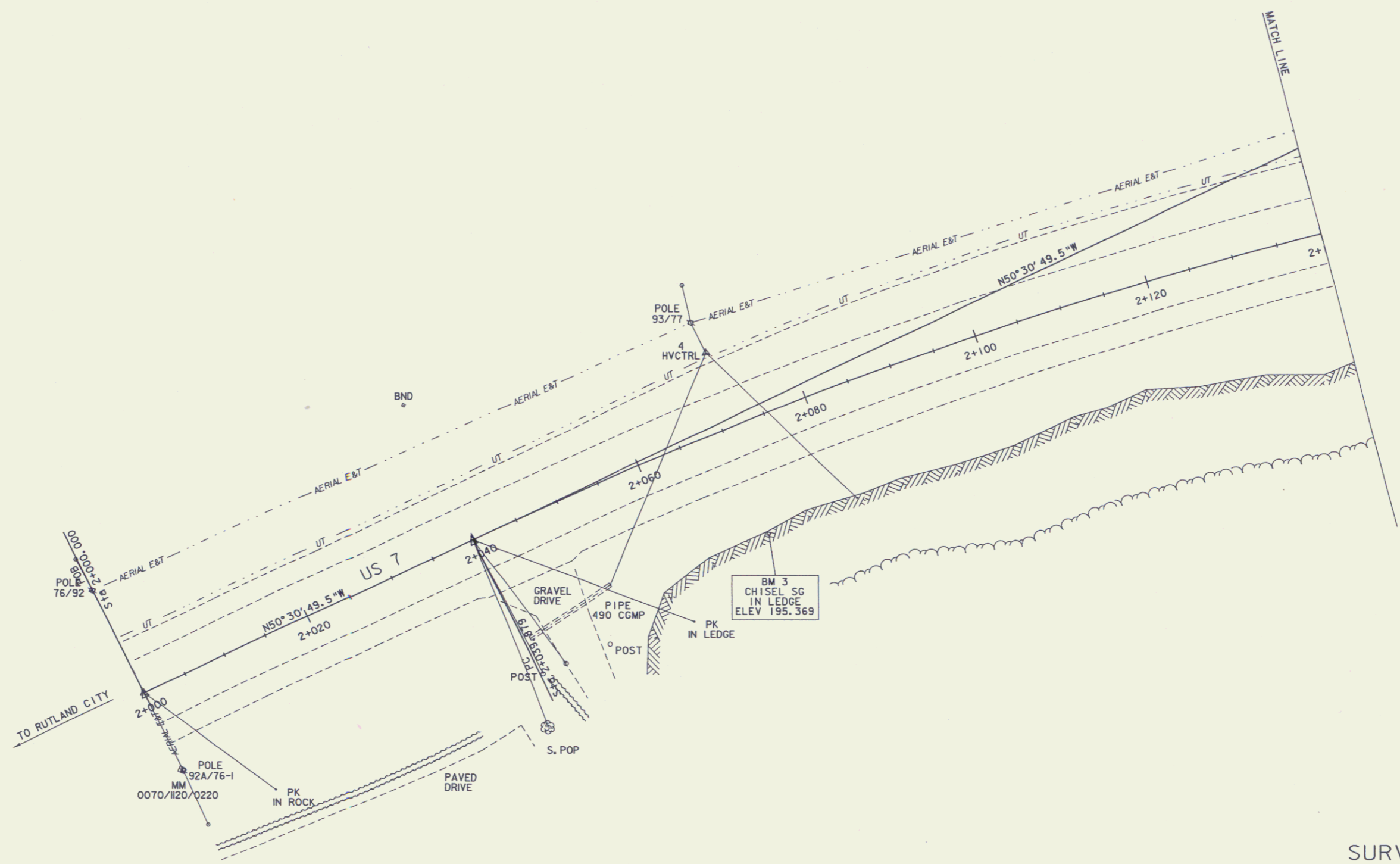
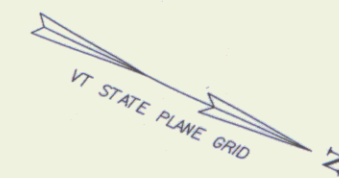

SURVEY PLAN I

DATUM
 VERTICAL NAVD 88 GPS
 HORIZONTAL NAD 83/92 GPS

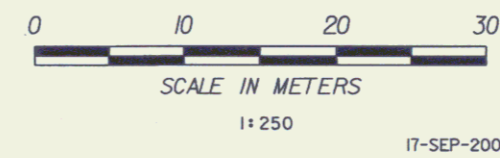

PROJECT: RUTLAND TOWN	PROJECT NO.: BRF 019-3(48)
DESIGN FILE NAME: 95b172/structures/sb172sur.dgn	PLOT DATE: 17-SEP-2004
IPARM FILE NAME: sb197sul.l	SURVEY DATE: 09/14/95
SURVEYED BY: L. ORVIS	DRAWN BY: T. LACKEY
SQUAD LEADER: R. WHITCOMB	SHEET 11 OF 19

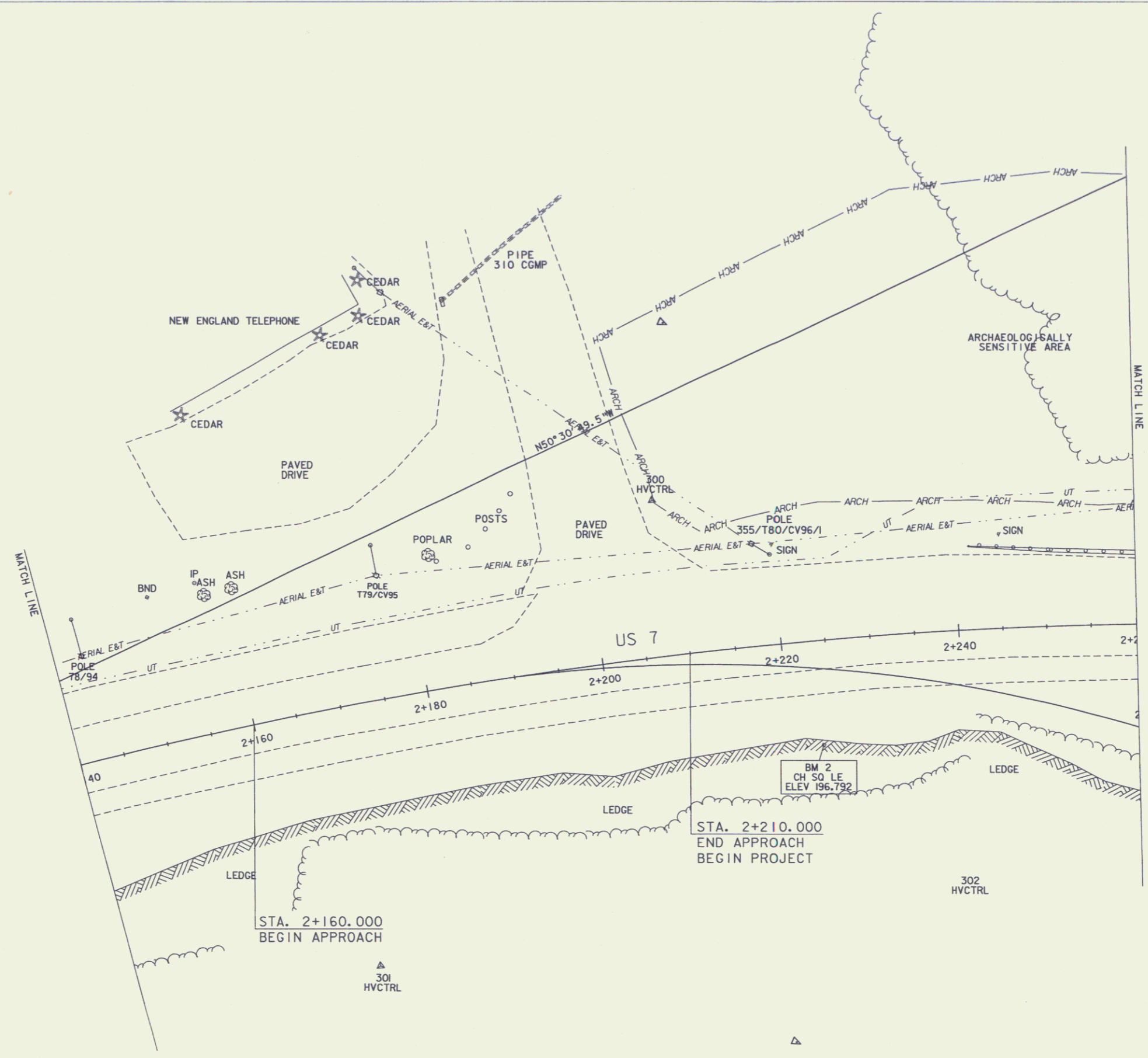
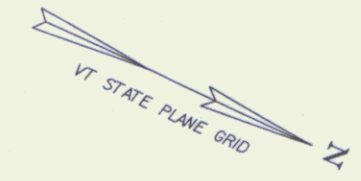

SURVEY PLAN 2

DATUM
 VERTICAL NAVD 88 GPS
 HORIZONTAL NAD 83/92 GPS

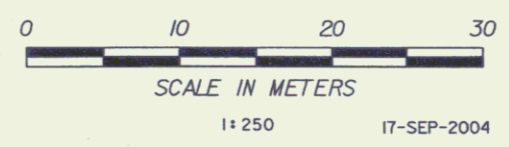

PROJECT: RUTLAND TOWN	PROJECT NO.: BRF 019-3(48)
DESIGN FILE NAME: 95b172/structures/sb172sur.dgn	PLOT DATE: 17-SEP-2004
IPARM FILE NAME: sb172su2.i	SURVEY DATE: 09/14/95
SURVEYED BY: L. ORVIS	DRAWN BY: T. LACKEY
SQUAD LEADER: R. WHITCOMB	SHEET 12 OF 19

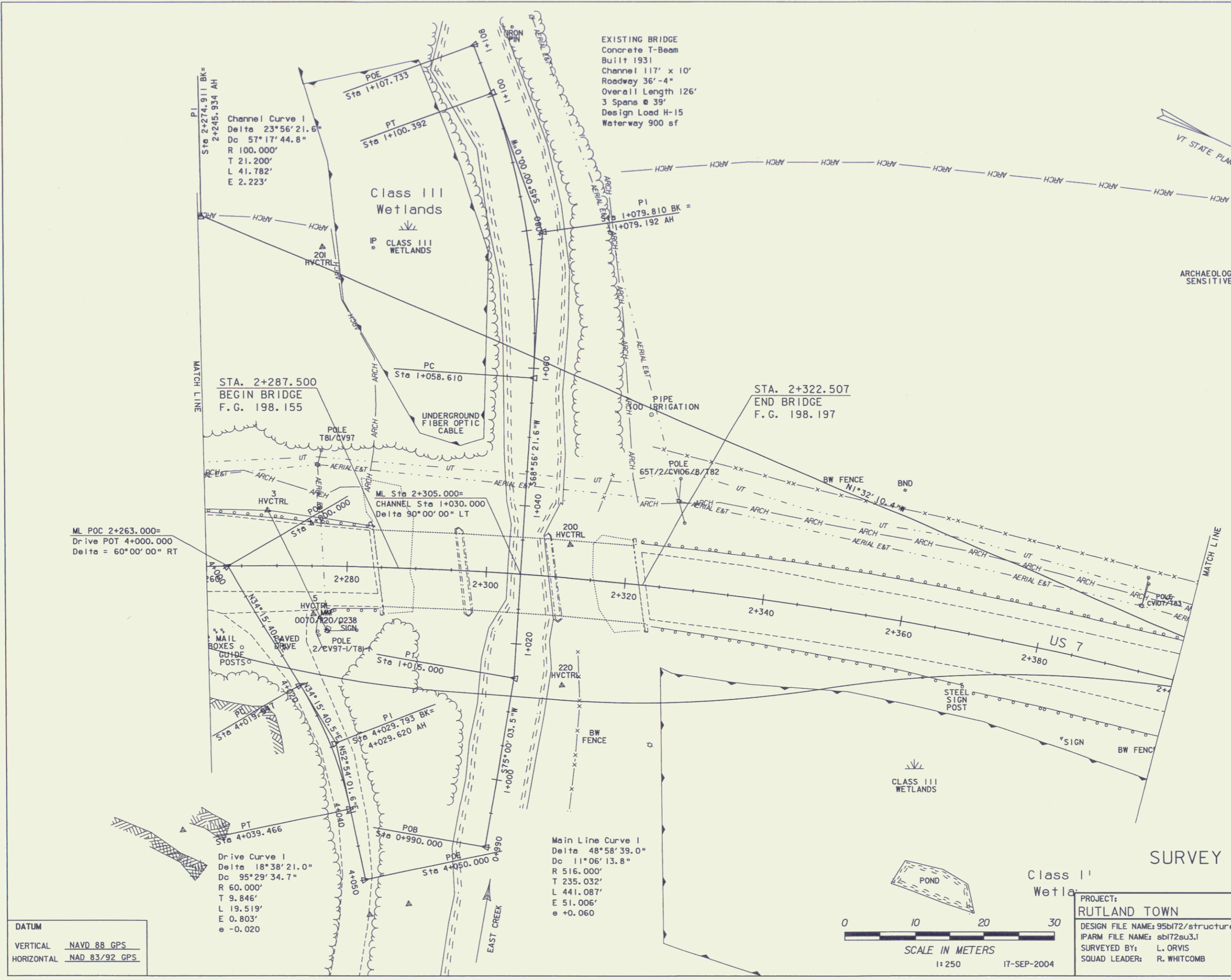

EXISTING BRIDGE
Concrete T-Beam
Built 1931
Channel 117' x 10'
Roadway 36'-4"
Overall Length 126'
3 Spans @ 39'
Design Load H-15
Waterway 900 sf

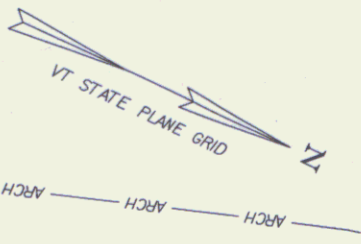

ARCHAEOLOGICALLY SENSITIVE AREA

Channel Curve 1
Delta 23°56'21.6"
Dc 57°17'44.8"
R 100.000'
T 21.200'
L 41.782'
E 2.223'

STA. 2+287.500
BEGIN BRIDGE
F.G. 198.155

STA. 2+322.507
END BRIDGE
F.G. 198.197

ML POC 2+263.000=
Drive POT 4+000.000
Delta = 60°00'00" RT

Main Line Curve 1
Delta 48°58'39.0"
Dc 11°06'13.8"
R 516.000'
T 235.032'
L 441.087'
E 51.006'
e +0.060

Drive Curve 1
Delta 18°38'21.0"
Dc 95°29'34.7"
R 60.000'
T 9.846'
L 19.519'
E 0.803'
e -0.020

DATUM
VERTICAL NAVD 88 GPS
HORIZONTAL NAD 83/92 GPS

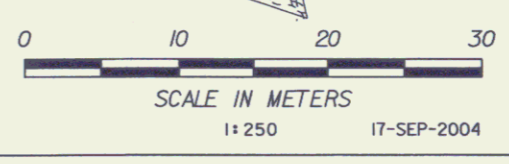

SURVEY PLAN 3

Class I Wetlands

PROJECT: RUTLAND TOWN	PROJECT NO.: BRF 019-3(48)
DESIGN FILE NAME: 95bi72/structures/sb172sur.dgn	PLOT DATE: 17-SEP-2004
IPARM FILE NAME: sb172su3.1	SURVEY DATE: 09/14/95
SURVEYED BY: L. ORVIS	DRAWN BY: T. LACKEY
SQUAD LEADER: R. WHITCOMB	SHEET 13 OF 19

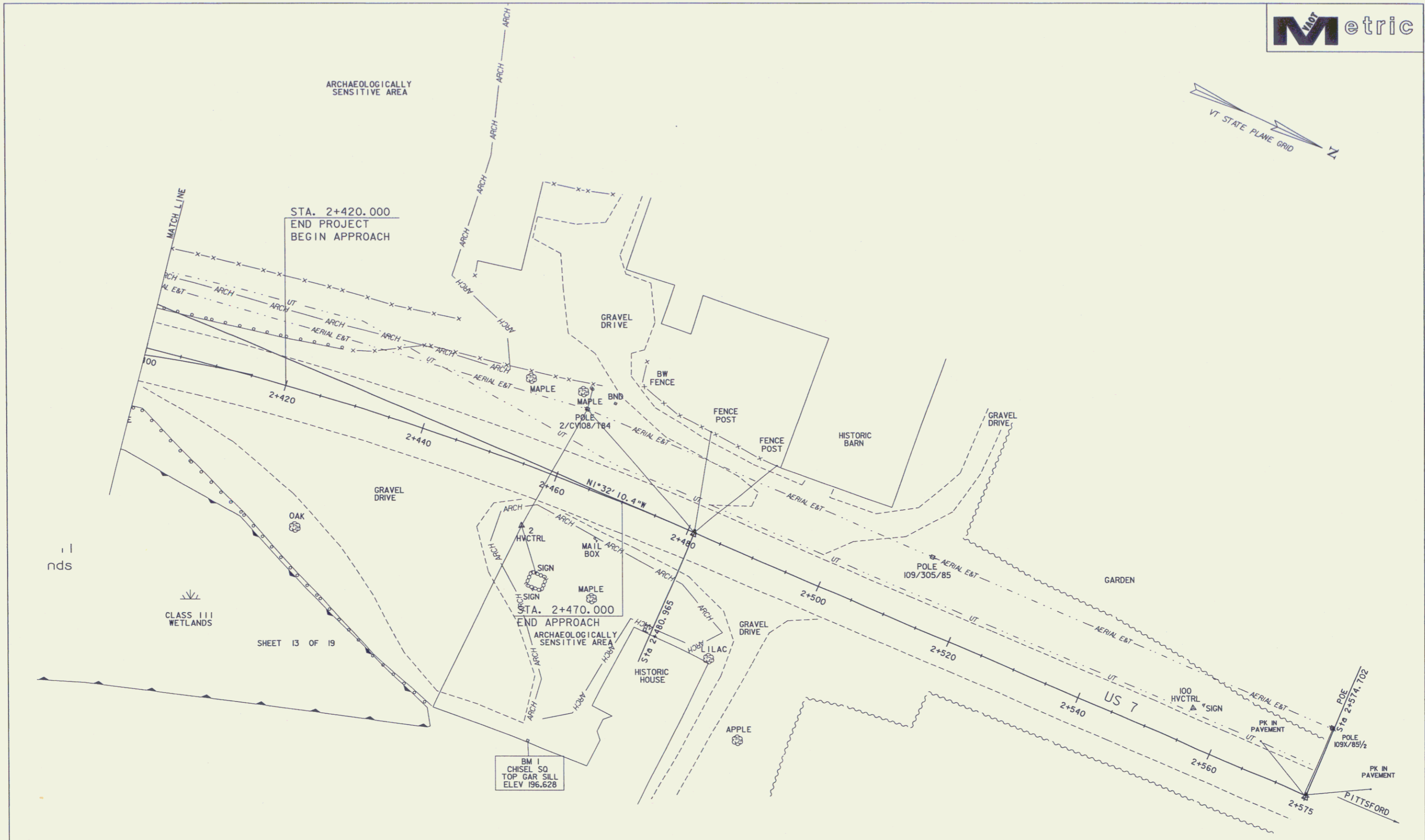
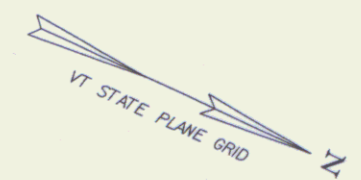

SURVEY PLAN 4

DATUM
 VERTICAL NAVD 88 GPS
 HORIZONTAL NAD 83/92 GPS

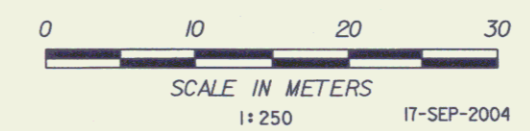

PROJECT: RUTLAND TOWN	PROJECT NO. # BRF 019-3(48)
DESIGN FILE NAME: 95dt72/structures/sb172sur.dgn	PLOT DATE: 17-SEP-2004
IPARM FILE NAME: sb172su4.1	SURVEY DATE: 09/14/95
SURVEYED BY: L. ORVIS	DRAWN BY: T. LACKEY
SQUAD LEADER: R. WHITCOMB	SHEET 14 OF 19

GPS CONTROL POINTS

HVCTRL # 1

STANDARD DISK STAMPED

RP *

N = 128042.974
E = 460815.963
ELEV. = 200.345

To reach from the junction of US route 7 and US route 4 (Woodstock) in Rutland proceed north on route 7 for 3.1 mi (5.0 km) to a rock outcrop and the station on the right (east).

Station is 35.36m (116.01 ft) northwest of the northwest corner of a 2.5 story house, 15 m (49.2 ft) southwest of a utility pole # 114B/90B, 10 m (32.8 ft) northeast of utility pole # 114/90A and a fiberglass witness post, 6.8m (22.3 ft) east of and 1 m (3.3 ft) higher than the centerline of route 7.

* DESCRIPTION PROVIDED BY VERMONT AGENCY OF TRANSPORTATION GEODETIC SURVEY UNIT

TRAVERSE TIES

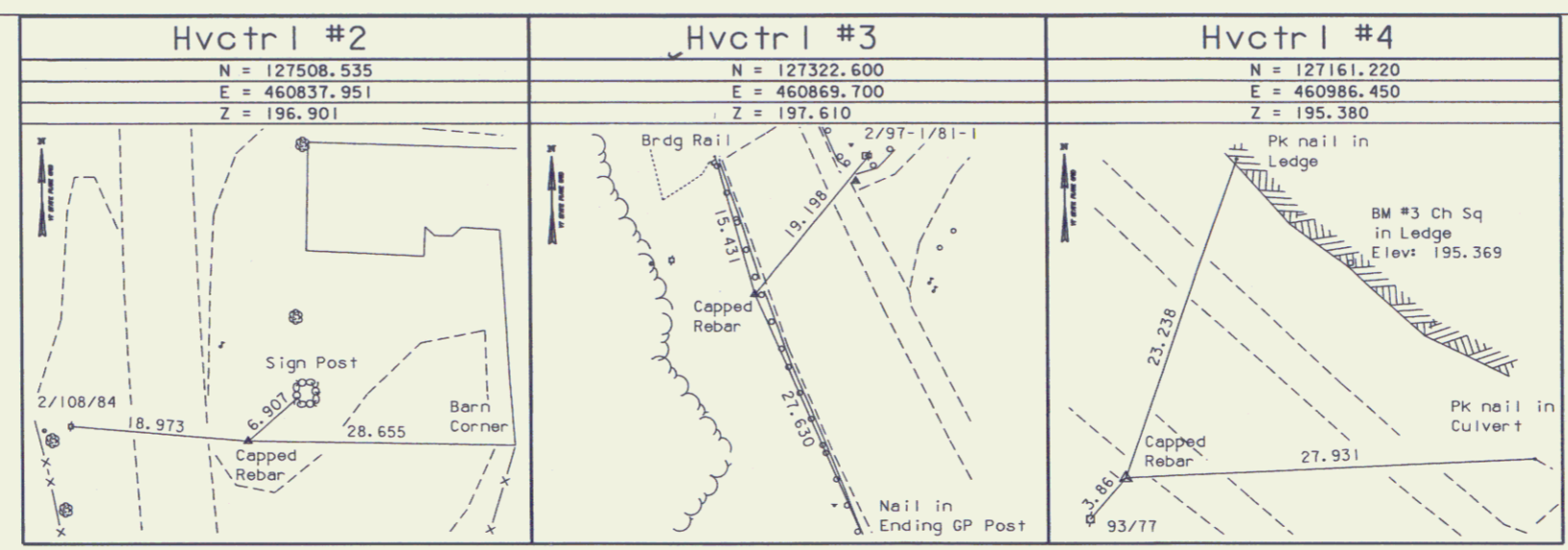

* MAIN TRAVERSE COMPLETED 7/28/95 by L. Orvis P.C. and R. Bullock

ALIGNMENT TIES

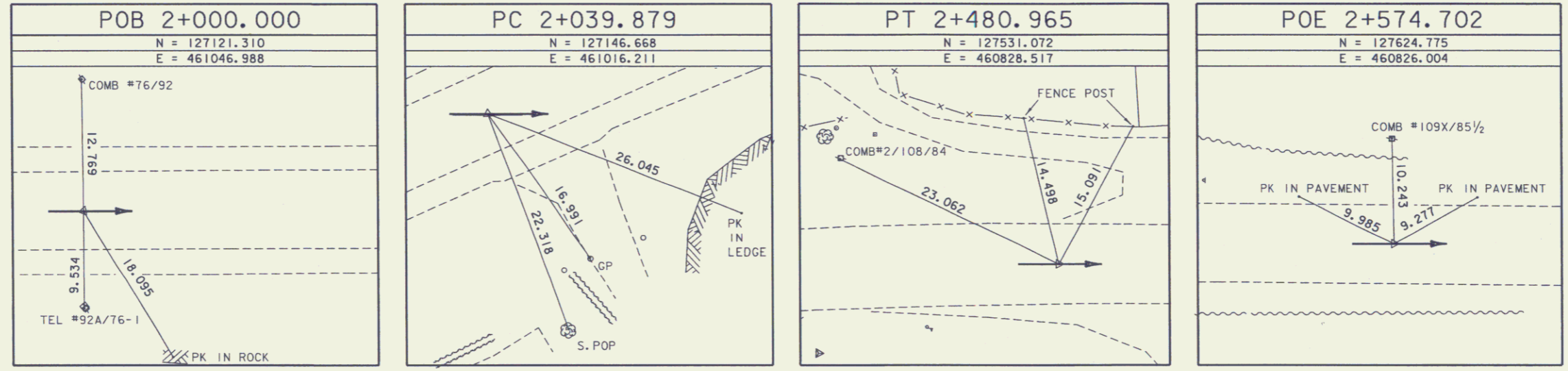

* ALIGNMENT COMPLETED: DECEMBER 18, 2002 BY: L.ORVIS PC. & J.HULETT

DATUM
VERTICAL NAVD 88
HORIZONTAL NAD 83/92
ADJUSTMENT Least Sq

PROJECT NAME: Rutland Town
PROJECT NUMBER: BRF 019-3(48)
FILE NAME: 95b172/s tr/sb172sur.dgn PLOT DATE: 17-SEP-2004
PROJECT LEADER: R. WHITCOMB DRAWN BY: R. Bullock
DESIGNED BY: sb172u5.i CHECKED BY: P.HODGE
SHEET 15 OF 19

RIGHT - OF - WAY DETAIL SHEET

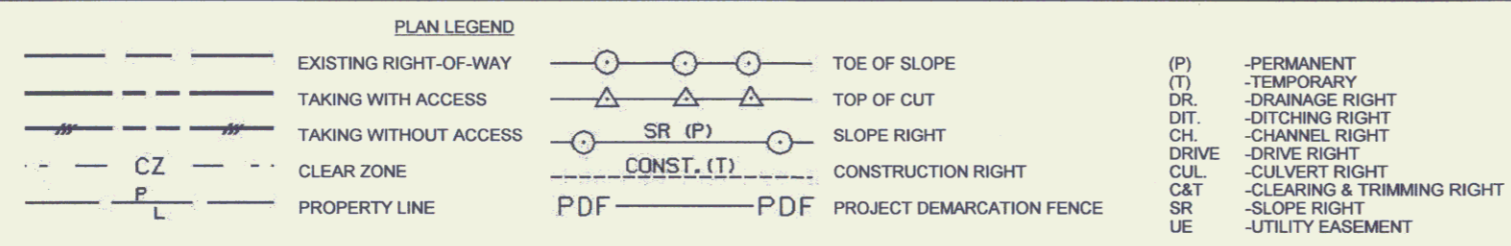

TABLE OF PROPERTY ACQUISITION

PARCEL NO.	PROPERTY OWNER	SHEET NO.	BEGINNING STATION	ENDING STATION	TAKE AREA ±	REMAINDER AREA ±	RIGHT			RECORDING DATA				REMARKS	
							TYPE	(T)/(P)	AREA ±	TITLE	DATE	TOWN / CITY	BOOK		PAGE
1A	MARGAR, LLC joined by VERIZON NEW ENGLAND, INC.	18	2+200.8 LT. 2+271.9 LT. 2+274.8 LT.	2+279.1 LT.			CONST. INSTALL	T P	29 SM	WD	8/7/2006	RUTLAND	144	42	PAVED DRIVE 12.2M(40') WIDE MM0233 INCLUDES PDF, 312 SF± GUY WIRE & ANCHOR
1B		17,18	2+156.93 LT.	2+305.00 RT.	0.11 HA		ALL R. T. & L								US RTE. 7 HWY. EASE; 0.27A±
1C		17,18	2+249.11 LT.	2+297.49 LT.	165 SM		ALL R. T. & L								US RTE. 7 HWY. EASE; 1776 SF±
2A	FAIGNANT, JOHN PAUL	17,18	2+243.9 RT. 2+234.3± RT. 2+273.8 RT. 2+285.3 RT. 2+278.8 RT. 2+289.2 RT.	2+304.4 RT. 2+278.0 RT. 2+281.4 RT. 2+288.7 RT. 2+303.4 RT.			DETOUR CONST. DRIVE UTILITY CONST. INSTALL	T T T P T P	254 SM 80 SM 109 SM 52 SM 135 SM	WD	3/16/2006	RUTLAND	142	65	2734 SF± INCLUDES PDF, 851 SF± PAVED, 4.5M(15') WIDE 1173 SF± MM0237(2+263.0 RT.) 560 SF± INCLUDES PDF, 1453 SF± GUY WIRE & ANCHOR
2B		17,18	2+156.93 RT.	2+305.00 RT.	0.11 HA		ALL R. T. & L								US RTE. 7 HWY. EASE; 0.27A±
2C		17	2+156.93 RT.	2+245.78 RT.	490 SM		ALL R. T. & L								US RTE. 7 HWY. EASE; 0.12A±
3A	WILLIAMS, SHERWIN L.	18,19	2+303.0 RT. 2+303.4 RT. 2+314.8 RT. 2+326.1 RT. 2+414.2 RT. 2+386.2 RT. 2+405.7 RT. 2+434.7 RT.	2+363.5 RT. 2+357.3 RT. 2+315.0 RT. 2+418.5 RT.			CONST. DETOUR REMOVE REMOVE REMOVE & RESET REMOVE INSTALL DRIVE	T T T T T T T T	163 SM 271 SM	WD	2/1/2006	RUTLAND	141	345	INCLUDES PDF, 1755 SF± 2917 SF± FENCE POLE FENCE SIGN PDF GRAVEL 12M(39') WIDE MM0248
3B		19	2+415.2 LT. 2+424.1 LT.	2+436.6 LT. 2+427.2 LT.			CONST. SLOPE	T T	42 SM 1 SM						INCLUDES PDF, 452 SF± 11 SF±
3C		18,19	2+304.38 RT.	2+464.08 RT.	0.24 HA		ALL R. T. & L								US RTE. 7 HWY. EASE; 0.58A±
3D		18,19	2+305.1 LT.	2+464.06 LT.	0.11 HA		ALL R. T. & L								US RTE. 7 HWY. EASE; 0.27A±
4	CENTRAL VERMONT PUBLIC SERVICE CORPORATION	17,18,19	2+156.93 LT.	2+464.08 RT.	1.01 HA		ALL R. T. & L			QCD	5/26/2006	RUTLAND	143	96	"WATERS OF EAST CREEK" AND FLOWAGE RIGHTS, 2.50 AC± - UTILITY
5	BAKER, JESSIE L.	18	2+294.38 LT.	2+305.04 LT.	64 SM		ALL R. T. & L			WD	4/14/2006	RUTLAND	142	221	US RTE. 7 HWY. EASE; 689 SF±
6	VERIZON NEW ENGLAND, INC.														UTILITY
7	ADELPHIA CABLE COMMUNICATIONS														UTILITY

TABLE OF REVISIONS

REVISION NO.	SHEET NO.	DESCRIPTION	DATE
1	16,17,18	PARCEL NO. 2 FAIGNANT. REMOVE AMBER FAIGNANT FROM PLANS. MADE BY: JB	2/17/2006
		ELECTRONIC FILES TO STRUCTURES	2-1-07



APPROVED: ROGER P. DUMAS DATE: 03-07-05
CHIEF, PLANS & TITLES

PROJECT NAME: **RUTLAND TOWN**
PROJECT NUMBER: **BRF 019-3(48)**

FILE NAME: 95b172.xls PLOT DATE: 09/14/04
PROJECT LEADER: R. WHITCOMB DRAWN BY: G. FUNK
DESIGNED BY: T. LACKEY CHECKED BY: R. DUMAS
R.O.W. SHEET 7 OF 19 SHEET 11 OF 82

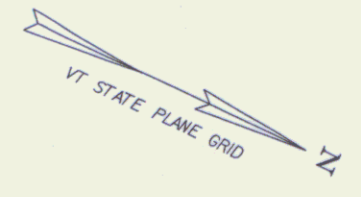

CONSTRUCT DRIVE
2+200.8 LT. - 12.2 M WIDE, PAVED

REMOVAL AND DISPOSAL OF GUARDRAIL
2+241.6 LT. - 2+260.0 LT.

STEEL BEAM GUARDRAIL, GALVANIZED
2+222.6 LT. - 2+260.0 LT.

COLD PLANING, BITUMINOUS PAVEMENT
2+160.0 - 2+180.0

MANUFACTURED TERMINAL SECTION, FLARED
2+211.2 LT. - 2+222.6 LT.
2+238.7 RT. - 2+250.1 RT.
2+250.1 RT. - 2+260.0 RT.

MARGAR, LLC
Joined by
VERIZON NEW ENGLAND, INC.

BEGIN R.O.W. PROJECT
STA 2+156.93
17.26M(56.6')LT

N/F
GOODNICK

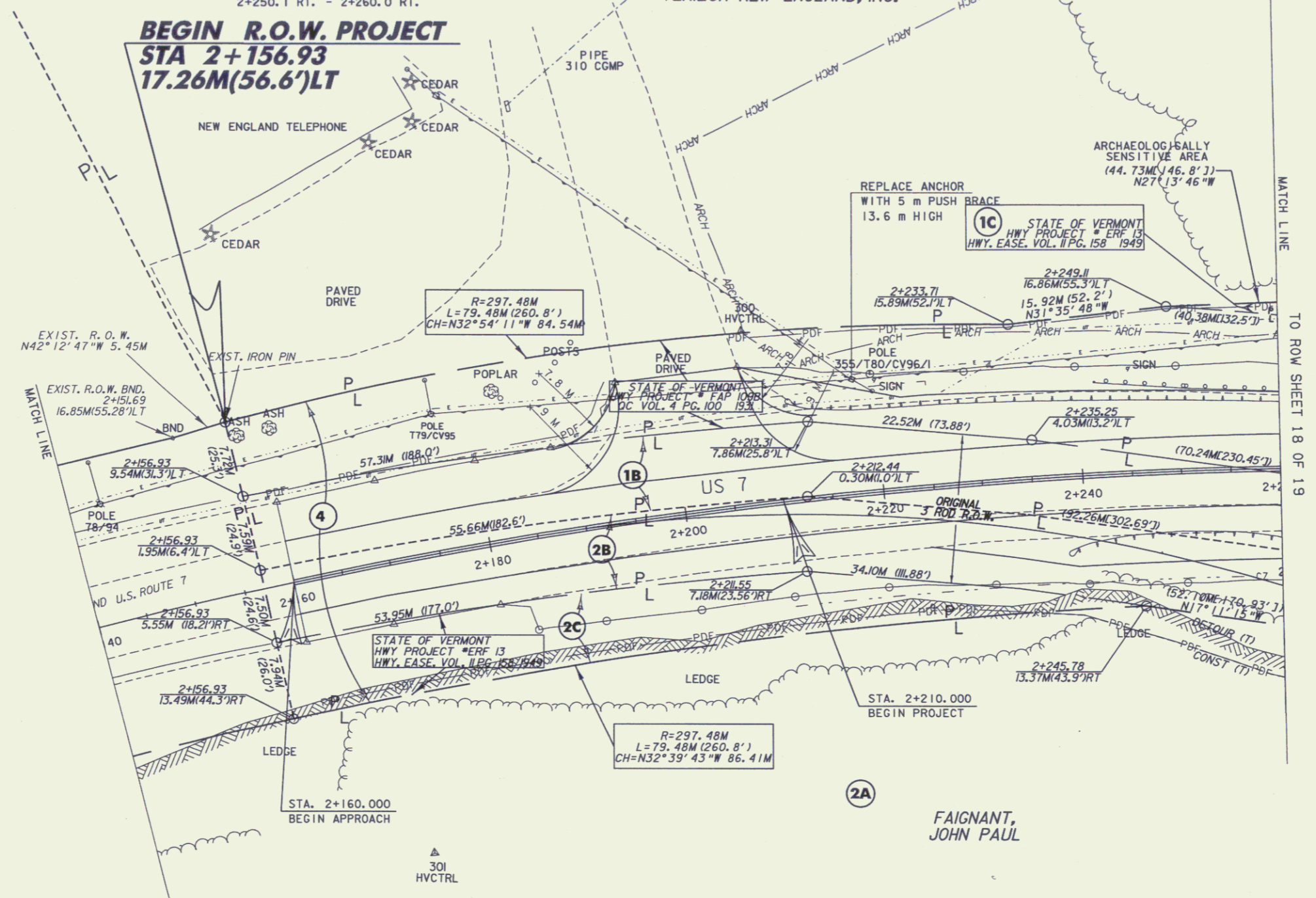

LINES SHOWN ON THIS PLAN AS EXISTING PROPERTY LINES P/L ARE BELIEVED TO BE ACCURATE BUT SHOULD NOT BE RELIED UPON FOR PURPOSES UNRELATED TO THE STATE OF VERMONT'S ACQUISITION OF LAND AND RIGHTS FOR THIS PROJECT.

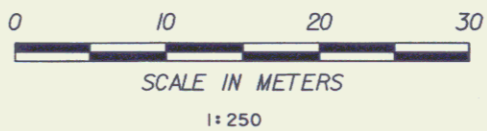

FOR R.O.W. USE ONLY

LAYOUT PLAN I

PROJECT NAME:	RUTLAND TOWN	FILE NAME:	sbi72ip1	LOT DATE:	31-JAN-2007
PROJECT NUMBER:	BRF 019-3(48)	PROJECT LEADER:	R.WHITCOMB	DRAWN BY:	T.LACKEY
		DESIGNED BY:	T.LACKEY	CHECKED BY:	
		ROW SHEET:	17 OF 19	SHEET:	12 OF 82

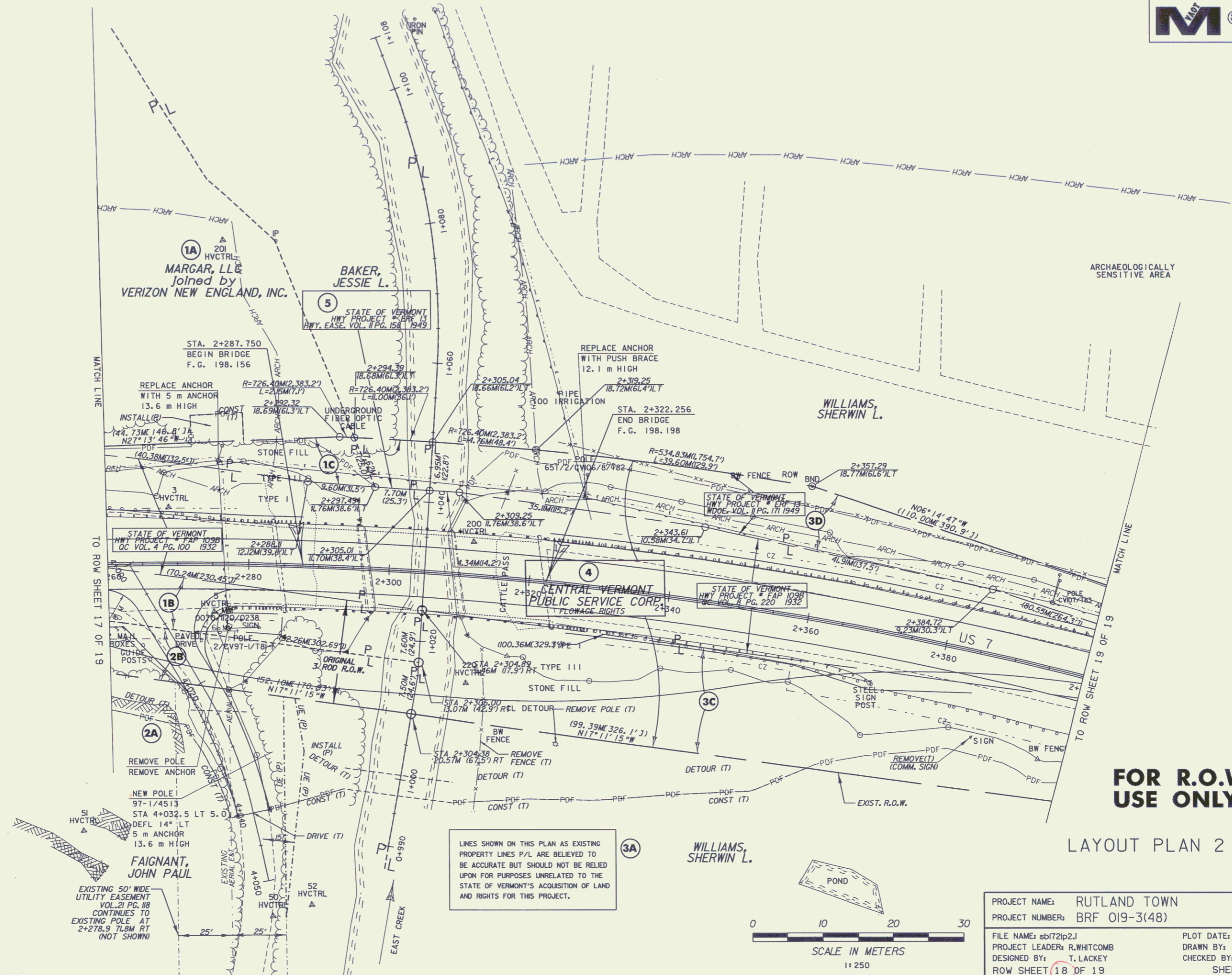

FOR R.O.W. USE ONLY

LAYOUT PLAN 2

PROJECT NAME:	RUTLAND TOWN	PLOT DATE:	31-JAN-2007
PROJECT NUMBER:	BRF 019-3(48)	DRAWN BY:	T. LACKEY
FILE NAME:	sb172ip2.1	CHECKED BY:	T. LACKEY
PROJECT LEADER:	R. WHITCOMB	SHEET	13 OF 82
DESIGNED BY:	T. LACKEY	ROW SHEET	18 OF 19

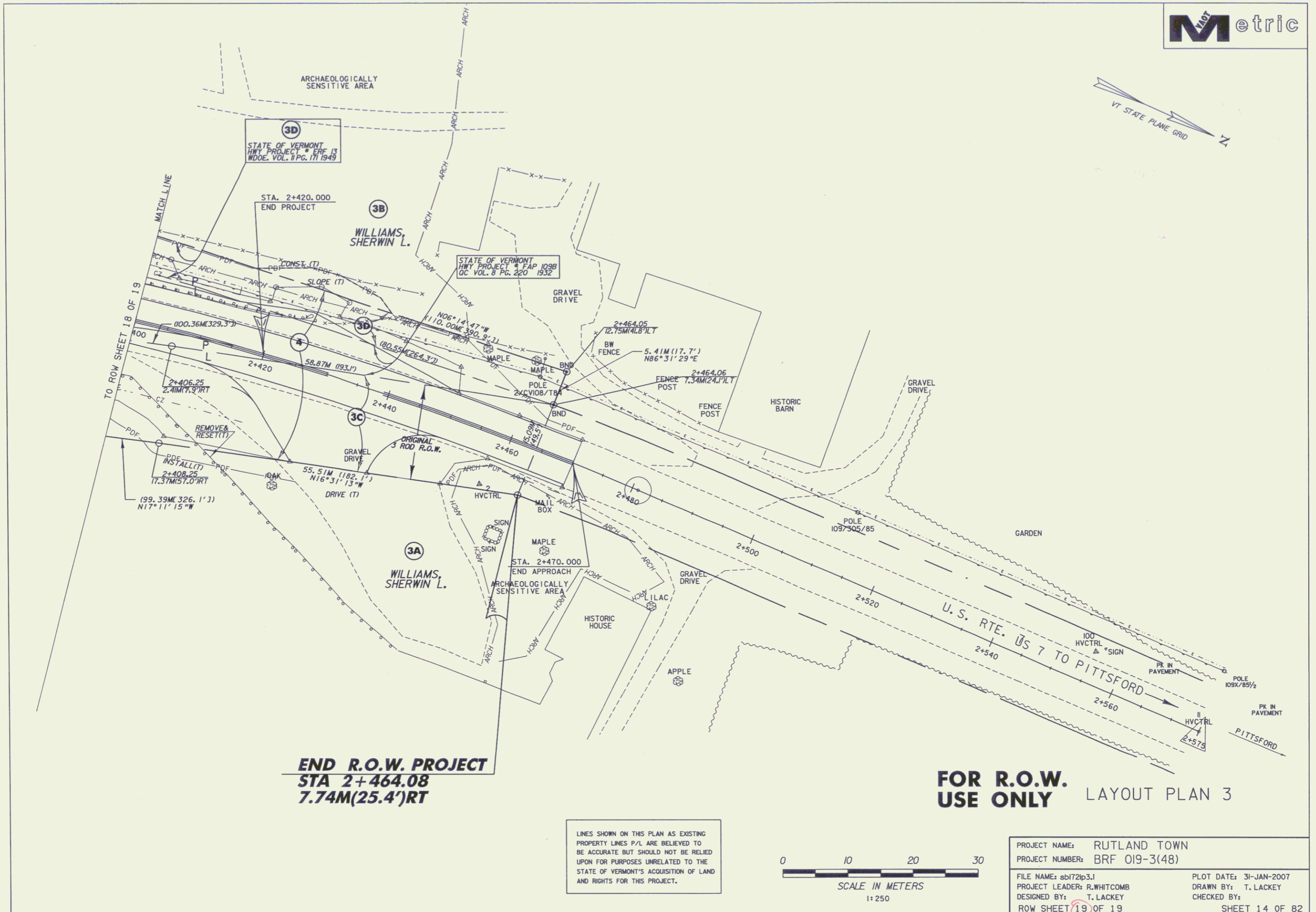
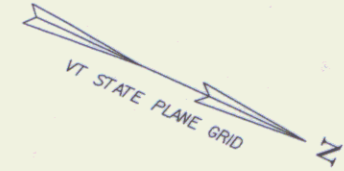

END R.O.W. PROJECT
STA 2+464.08
7.74M(25.4')RT

FOR R.O.W. USE ONLY LAYOUT PLAN 3

LINES SHOWN ON THIS PLAN AS EXISTING PROPERTY LINES P/L ARE BELIEVED TO BE ACCURATE BUT SHOULD NOT BE RELIED UPON FOR PURPOSES UNRELATED TO THE STATE OF VERMONT'S ACQUISITION OF LAND AND RIGHTS FOR THIS PROJECT.

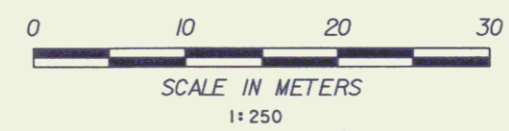

PROJECT NAME: RUTLAND TOWN	PLOT DATE: 31-JAN-2007
PROJECT NUMBER: BRF 019-3(48)	DRAWN BY: T. LACKEY
FILE NAME: rbt172ip3.1	CHECKED BY:
PROJECT LEADER: R. WHITCOMB	
DESIGNED BY: T. LACKEY	
ROW SHEET 19 OF 19	SHEET 14 OF 82