

THE FINAL CONFIGURATION OF THE ACCESS DRIVE SHALL BE LAID OUT IN THE FIELD AND SHALL GENERALLY FOLLOW THE EXISTING GROUND EXCEPT FILL SHALL BE ADDED TO PROVIDE A CONSTANT GRADE BETWEEN STATIONS 29+50 TO 31+50.

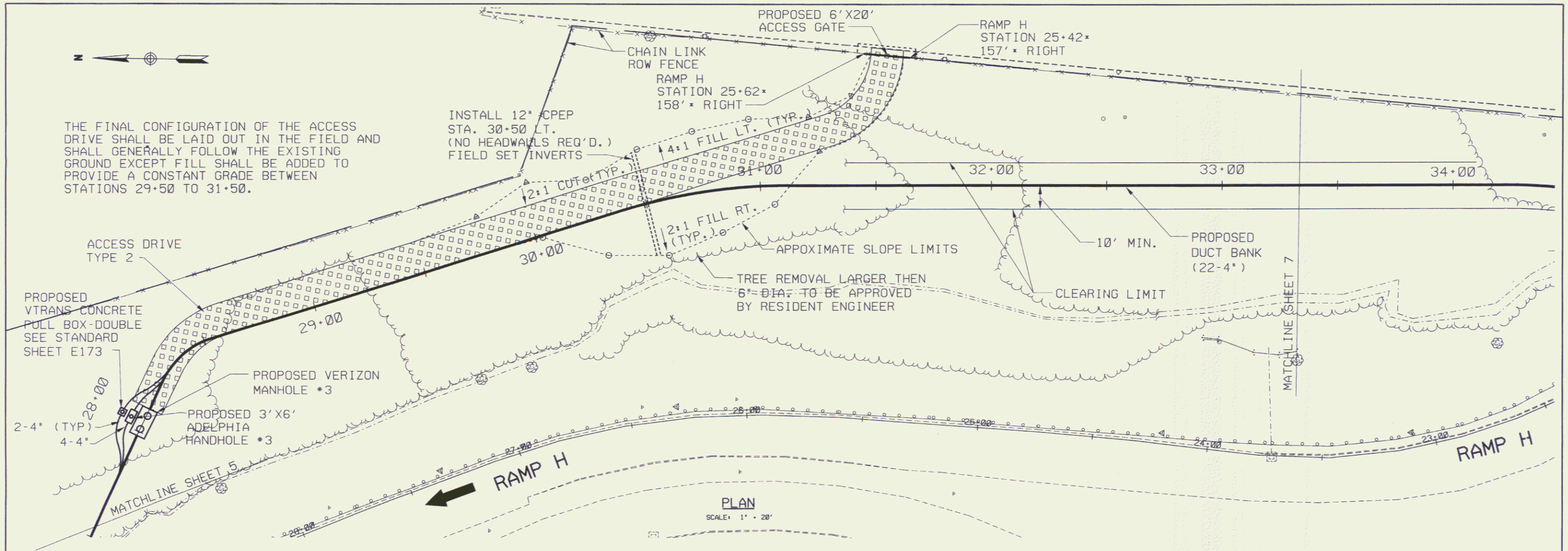

PLAN
SCALE: 1" = 20'

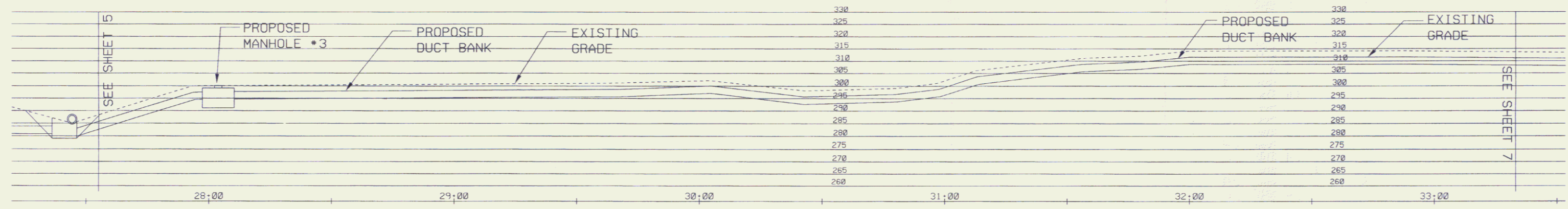

PROFILE
SCALE: 1" = 20'

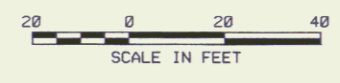

APR 15 2010

VANASSE HANGEN BRUSTLIN, INC.

STATE OF VERMONT AGENCY OF TRANSPORTATION	
Town Of	SOUTH BURLINGTON
Highway No.	U. S. 2
U. S. 2 OVER I-89	
TELECOMMUNICATIONS RELOCATION	
Designed By	M. HAYES
Checked By	Date
Drawn By	M. HAYES
Bridge Design Supervisor	
S. JOHNSON	
PROJECT	SOUTH BURLINGTON
PROJECT NO. IM DECK (36)	
I.G.C. Info.	VTRANS-GEN
Date 10/31/01	
R. O. W. SHEET 6 OF 6 SHEETS	

WB NO. 50929 plot date: 10/31/2001