

CLEARING AND GRUBBING, INCLUDING INDIVIDUAL TREES AND STUMPS
 RAMP 'B' 58+00.0 RT - 58+00.0 RT
 RAMP 'B' 58+35.5 LT (5' O.C.)
 RAMP 'B' 58+70.2 LT (5' ASH)
 VT RTE IS 16+25.4 LT (5' ASH)
 VT RTE IS 16+59.4 LT (5' ASH)

REMOVE EXISTING PAVEMENT (COMMON EXCAVATION)
 RAMP 'B' 58+00.0 - 58+70.2
 SLIP RAMP 'B' 60+00.0 - 60+77.2

REMOVE EXISTING CONCRETE PAVEMENT (COMMON EXCAVATION)
 VT RTE IS 16+85.0 - 16+76.7 RT (ISLAND)
 VT RTE IS 16+24.6 - 16+56.5 RT
 VT RTE IS 16+27.7 - 16+37.7 LT
 VT RTE IS 16+92.6 - 17+42.0 RT
 VT RTE IS 16+85.2 - 17+41.3 LT
 VT RTE IS 17+92.2 - 18+37.4 LT
 VT RTE IS 18+52.0 - 18+35.0 LT
 VT RTE IS 20+26.4 - 20+35.2 LT
 SLIP RAMP 'B' 10.7 RT - ROLAND CT. 29+5.0 LT
 ROLAND CT. 29+5.0 RT - VT RTE IS 19+25.5 RT

STONE FILL, TYPE 1
 RAMP 'B' 58+36 LT - 58+62 LT
 8' WIDE IN DITCH

REMOVAL OF EXISTING FENCE
 RAMP 'B' 59+52.7 LT
 19 LF - REMOVE TO CLEAR ZONE
 VT RTE IS 19+23.1 LT
 (IF - REMOVE TO BACK OF BASEMENT)

BEGIN R.O.W. PROJECT
VT ROUTE 15 STA. 16+26
55.00' LT.

VERTICAL GRANITE CURB
 RAMP 'B' 58+95.27 RT - RAMP 'B' 59+53.87 RT
 VT RTE IS 16+94.74 RT - VT RTE IS 16+94.30 RT
 VT RTE IS 16+99.30 RT - VT RTE IS 17+23.30 RT
 SLIP RAMP 'B' 58+03.35 LT - SLIP RAMP 'B' 58+55.27 LT
 VT RTE IS 16+38.8 RT - VT RTE IS 16+43.7 RT
 VT RTE IS 16+82.91 LT - VT RTE IS 16+93.39 LT
 VT RTE IS 16+92.42 LT - VT RTE IS 16+92.60 RT
 VT RTE IS 17+00.40 LT - VT RTE IS 17+00.60 RT
 VT RTE IS 20+29.63 LT - VT RTE IS 20+33.65 LT
 VT RTE IS 20+36.9 RT - VT RTE IS 20+39.38 LT
 VT RTE IS 19+95.5 RT - VT RTE IS 19+36.05 RT
 ROLAND CT. 29+48.36 LT - ROLAND CT. 29+22.73 LT
 ROLAND CT. 29+32.90 RT - VT RTE IS 19+25.48 RT

REMOVAL OF EXISTING CURB
 VT RTE IS 16+30.8 RT - RAMP 'B' 59+62.25 LT
 VT RTE IS 16+82.37 RT - VT RTE IS 17+60.1 RT
 SLIP RAMP 'B' 59.75 RT - SLIP RAMP 'B' 59+96.48 RT
 RAMP 'B' 59+13.8 RT - RAMP 'B' 59+57.69 RT
 VT RTE IS 16+20.78 RT - VT RTE IS 16+34.43 RT
 VT RTE IS 16+20.82 RT - VT RTE IS 16+34.58 RT
 VT RTE IS 16+92.37 LT - VT RTE IS 17+00.60 LT
 VT RTE IS 16+92.60 RT - VT RTE IS 17+00.60 RT
 VT RTE IS 16+83.00 LT - VT RTE IS 16+98.39 RT
 VT RTE IS 16+92.43 LT - VT RTE IS 20+23.8 RT (ENTIRE ISLAND, RESET IF NEEDED)
 VT RTE IS 20+29.63 LT - VT RTE IS 20+39.38 LT
 ROLAND CT. 29+32.5 RT - VT RTE IS 19+25.48 RT
 ROLAND CT. 29+32.90 LT - ROLAND CT. 29+22.61 LT

REMOVING AND RESETTING CURB (CONT'D)
 VT RTE IS 16+34.43 RT - VT RTE IS 16+34.43 RT - RESET NOSE TO
 VT RTE IS 16+20.78 RT - VT RTE IS 16+20.82 RT
 VT RTE IS 16+24.63 RT - VT RTE IS 16+38.8 RT
 VT RTE IS 16+87.46 LT - VT RTE IS 16+92.47 LT
 VT RTE IS 16+87.60 RT - VT RTE IS 16+92.60 RT
 VT RTE IS 17+00.40 LT - VT RTE IS 17+00.60 LT
 VT RTE IS 17+00.60 RT - VT RTE IS 17+00.60 RT
 VT RTE IS 16+98.39 RT - VT RTE IS 17+00.60 RT
 ROLAND CT. 29+22.61 LT - ROLAND CT. 29+35.00 LT
 ROLAND CT. 29+5.00 RT - ROLAND CT. 29+32.8 RT

CONCRETE SIDEWALK RAMPS W/ DETECTABLE WARNING SURFACE
 RAMP 'B' 59+57.8 LT (TYPE 0)
 RAMP 'B' 59+58.0 RT (TYPE 0)
 RAMP 'B' SLIP RAMP 'B' 59.1 LT (TYPE 0)
 RAMP 'B' SLIP RAMP 'B' 59.1 RT (TYPE 2)
 VT RTE IS 16+96.2 LT (MEDIAN ISLAND)
 VT RTE IS 16+96.8 RT (MEDIAN ISLAND)
 VT RTE IS 16+96.0 LT (TYPE 2)
 VT RTE IS 16+97.4 RT (TYPE 2)
 VT RTE IS 20+34.5 LT (TYPE 6)
 ROLAND CT. 29+53.0 LT (TYPE 2)
 ROLAND CT. 29+36.2 RT (TYPE 2)

COLD PLANING BITUMINOUS PAVEMENT
 VT RTE IS 16+85.0 - VT RTE IS 20+00.0
 ROLAND CT. 29+18.0 - ROLAND CT. 29+70.0

CHANGING ELEVATION OF SEWER MANHOLES
 VT RTE IS 16+02.8 LT
 VT RTE IS 18+29.5 RT
 VT RTE IS 20+16.5 LT
 VT RTE IS 20+57.1 LT

ADJUST ELEVATION OF VALVE BOX
 VT RTE IS 18+07.0 LT
 VT RTE IS 18+16.2 LT
 VT RTE IS 18+80.7 LT
 VT RTE IS 20+19.9 LT

ADJUST ELEVATION OF VALVE BOX (CONT'D)
 VT RTE IS 18+07.0 LT
 VT RTE IS 20+26.1 LT
 VT RTE IS 20+43.3 LT
 VT RTE IS 20+49.8 LT
 VT RTE IS 18+65.5 RT

PAINTED CURB
 VT RTE IS 15+93.0 - 16+23.0 RT (BOTH SIDES OF MEDIAN)
 VT RTE IS 16+77.1 - 17+07.1 LT & RT (BOTH SIDES OF MEDIAN)
 VT RTE IS 18+09.8 - 18+39.8 LT & RT (BOTH SIDES OF MEDIAN)
 VT RTE IS 18+91.1 - 19+35.1 RT (BOTH SIDES OF MEDIAN)

DELIMITER WITH STEEL POST
 RAMP 'B' 58+00 LT - 58+25 LT (3 EACH)
 RAMP 'B' 58+00 RT - SLIP RAMP 'B' 25 RT (3 EACH)
 REMOVE, STACK AND REINSTALL EACH

SPECIAL PROVISION (PORTLAND CEMENT CONCRETE ISLAND TREATMENT, 4 INCH)
 VT RTE IS 16+16 - 16+22 RT
 VT RTE IS 18+92 - 19+36 RT

SPECIAL PROVISION (PORTLAND CEMENT CONCRETE RUMBLE STRIP)
 VT ROUTE IS 19+34 RT - 20+36 LT (MEDIAN)

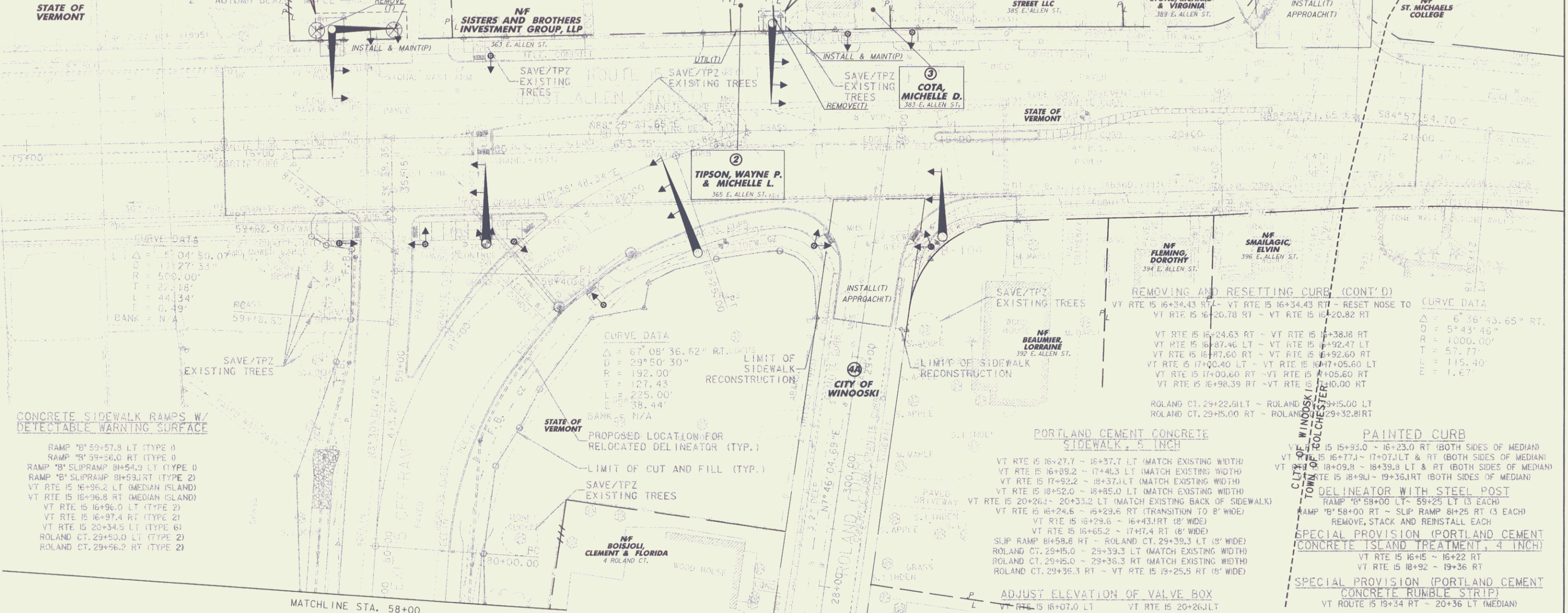

CONCRETE SIDEWALK RAMPS W/ DETECTABLE WARNING SURFACE
 RAMP 'B' 59+57.8 LT (TYPE 0)
 RAMP 'B' 59+58.0 RT (TYPE 0)
 RAMP 'B' SLIP RAMP 'B' 59.1 LT (TYPE 0)
 RAMP 'B' SLIP RAMP 'B' 59.1 RT (TYPE 2)
 VT RTE IS 16+96.2 LT (MEDIAN ISLAND)
 VT RTE IS 16+96.8 RT (MEDIAN ISLAND)
 VT RTE IS 16+96.0 LT (TYPE 2)
 VT RTE IS 16+97.4 RT (TYPE 2)
 VT RTE IS 20+34.5 LT (TYPE 6)
 ROLAND CT. 29+53.0 LT (TYPE 2)
 ROLAND CT. 29+36.2 RT (TYPE 2)

CURVE DATA
 $\Delta = 67^{\circ} 08' 36.62''$ RT. CURVE
 $D = 29^{\circ} 50' 30''$
 $R = 192.00'$
 $T = 127.43'$
 $L = 225.00'$
 $E = 38.44'$
 BANK = N/A

PROPOSED LOCATION FOR RELOCATED DELINEATOR (TYP.)

LIMIT OF CUT AND FILL (TYP.)

SAVE/TPZ EXISTING TREES

ADJUST ELEVATION OF VALVE BOX
 VT RTE IS 18+07.0 LT
 VT RTE IS 18+16.2 LT
 VT RTE IS 18+80.7 LT
 VT RTE IS 20+19.9 LT

ADJUST ELEVATION OF VALVE BOX (CONT'D)
 VT RTE IS 18+07.0 LT
 VT RTE IS 20+26.1 LT
 VT RTE IS 20+43.3 LT
 VT RTE IS 20+49.8 LT
 VT RTE IS 18+65.5 RT

PAINTED CURB
 VT RTE IS 15+93.0 - 16+23.0 RT (BOTH SIDES OF MEDIAN)
 VT RTE IS 16+77.1 - 17+07.1 LT & RT (BOTH SIDES OF MEDIAN)
 VT RTE IS 18+09.8 - 18+39.8 LT & RT (BOTH SIDES OF MEDIAN)
 VT RTE IS 18+91.1 - 19+35.1 RT (BOTH SIDES OF MEDIAN)

DELIMITER WITH STEEL POST
 RAMP 'B' 58+00 LT - 58+25 LT (3 EACH)
 RAMP 'B' 58+00 RT - SLIP RAMP 'B' 25 RT (3 EACH)
 REMOVE, STACK AND REINSTALL EACH

SPECIAL PROVISION (PORTLAND CEMENT CONCRETE ISLAND TREATMENT, 4 INCH)
 VT RTE IS 16+16 - 16+22 RT
 VT RTE IS 18+92 - 19+36 RT

SPECIAL PROVISION (PORTLAND CEMENT CONCRETE RUMBLE STRIP)
 VT ROUTE IS 19+34 RT - 20+36 LT (MEDIAN)

PROJECT NAME: WINOOSKI
PROJECT NUMBER: NH 089-3(65)
FILE NAME: r94a1982zzz.bdr
PROJECT LEADER: KEN UPMAL
DESIGNED BY: T. BIGELOW
ROW SHEET: 5 OF 5

PLOT DATE: 05-FEB-2010
DRAWN BY: T. BIGELOW
CHECKED BY: E. ATKINS
SHEET: 13 OF 66

FOR R.O.W. USE ONLY

0 20 40
 SCALE IN FEET