

STATE OF VERMONT
AGENCY OF TRANSPORTATION



PROPOSED IMPROVEMENT
TOWNS OF TROY AND NEWPORT
COUNTY OF ORLEANS
VT. RTE. 105, FAP, MINOR ARTERIAL

R.O.W. PLANS

GENERAL NOTES

TWO-WAY TRAFFIC SHALL BE MAINTAINED DURING CONSTRUCTION.

LOCATION: BEGINNING IN THE TOWN OF NEWPORT 250' WEST OF MILEMARKER 2.300 AND EXTENDING EASTERLY ALONG VT. RTE. 105 FOR 500' (0.095 MILES).

DESCRIPTION: WORK TO BE PERFORMED UNDER THIS PROJECT INCLUDES REPLACEMENT OF THE EXISTING 15' DIAMETER CULVERT LOCATED AT NEWPORT MM 2.300 WITH RELATED CHANNEL AND APPROACH WORK.

LENGTH OF R.O.W. PROJECT: 160.00 FEET = 0.030 MILES

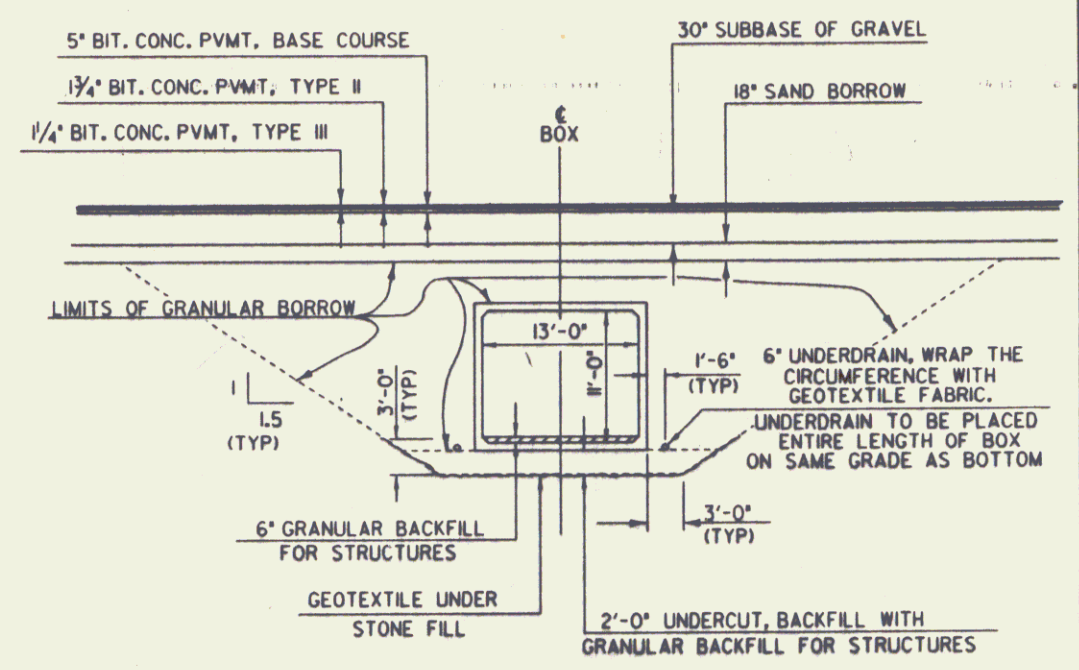
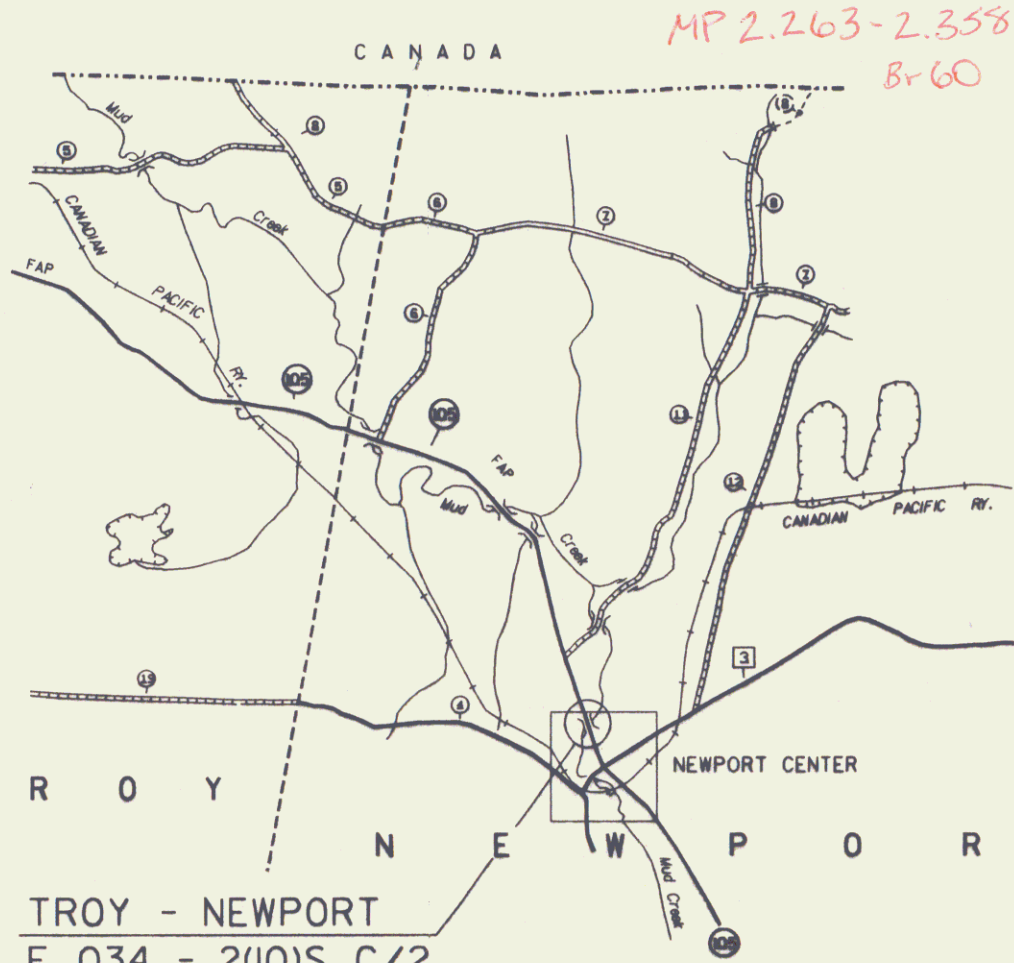
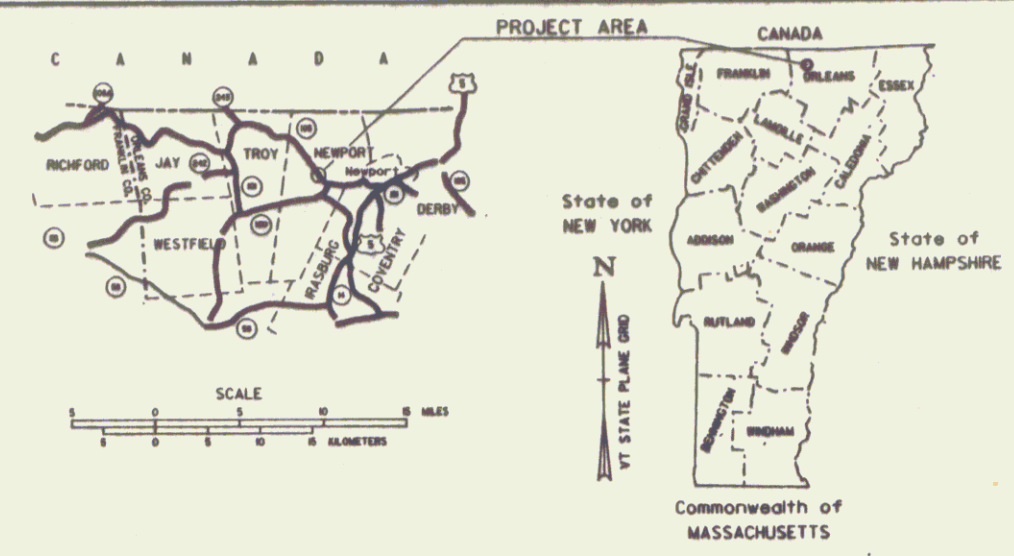

TYPICAL BOX SECTION
SCALE: 1/8" = 1'-0"

CONVENTIONAL SIGNS

COUNTY LINE	---
TOWN LINE	- - - -
LIMITS OF ACCESS	—○—
POINT OF ACCESS	—X—
FENCE LINE	—+—
STONE WALL	—o—o—o—
TRAVELED WAY	—+—+—+—
GUARD RAIL	—+—+—+—
RAILROAD	—+—+—+—
SURVEY LINE	—+—+—+—
CULVERT	—+—+—+—
POWER POLE	—+—+—+—
TELEPHONE POLE	—+—+—+—
TREES	—+—+—+—
CONTROL OF ACCESS	—+—+—+—
PROPERTY LINE	—+—+—+—
R.O.W. TAKING LINE	—+—+—+—
SLOPE RIGHTS	—+—+—+—
TOP OF CUT	—+—+—+—
TOE OF SLOPE	—+—+—+—

DATUM

VERTICAL	NGVD 1929
HORIZONTAL	N / A

TROY - NEWPORT
F 034 - 2(10)S C/2
VT 105, BR 60

RIGHT-OF-WAY DIVISION
TOWN FILE
PERPETUAL
Town of Newport
(To Be Returned To R.O.W. Division)

Pin # 928044
PROJECT PROCESSED UNDER
SECONDARY ROAD PLAN

THESE PLANS ARE SUBJECT TO SUCH ENGINEERING CHANGES AS MAY BE REQUIRED BY THE FEDERAL HIGHWAY ADMINISTRATION OR THE DIRECTOR OF MAINTENANCE AND CONSTRUCTION.
CONSTRUCTION IS TO BE CARRIED ON IN ACCORDANCE WITH THESE PLANS AND THE STANDARD SPECIFICATIONS FOR CONSTRUCTION DATED 1990, AS APPROVED BY THE FEDERAL HIGHWAY ADMINISTRATION ON MARCH 15, 1990 FOR USE ON THIS PROJECT, INCLUDING ALL SUBSEQUENT REVISIONS AND SUCH REVISED SPECIFICATIONS AND SPECIAL PROVISIONS AS ARE INCORPORATED IN THESE PLANS.

APPROVED	DATE
APPROVED	DATE
TROY - NEWPORT	
F 034-2(10)S C/2	
R.O.W. SHEET 1 OF 5 SHEETS	

NOV 21 1994

TYPICAL SECTION

1/4" BITUMINOUS CONCRETE PAVEMENT, TYPE III
 1/4" BITUMINOUS CONCRETE PAVEMENT, TYPE II
 5" BASE COURSE OF BITUMINOUS CONCRETE PAVEMENT, TYPE I
 30" SUBBASE OF GRAVEL
 18" SAND BORROW

SHOULDERS: 1/4" BITUMINOUS CONCRETE PAVEMENT, TYPE III
 1/4" BITUMINOUS CONCRETE PAVEMENT, TYPE II

MATERIAL ITEM	THICKNESS TOLERANCE
PAVEMENT	+/- 1/4" FOR THE TOTAL PAVEMENT THICKNESS
BASE COURSE	+/- 1/2"
SUBBASE	+/- 1"
SAND BORROW	+/- 1"

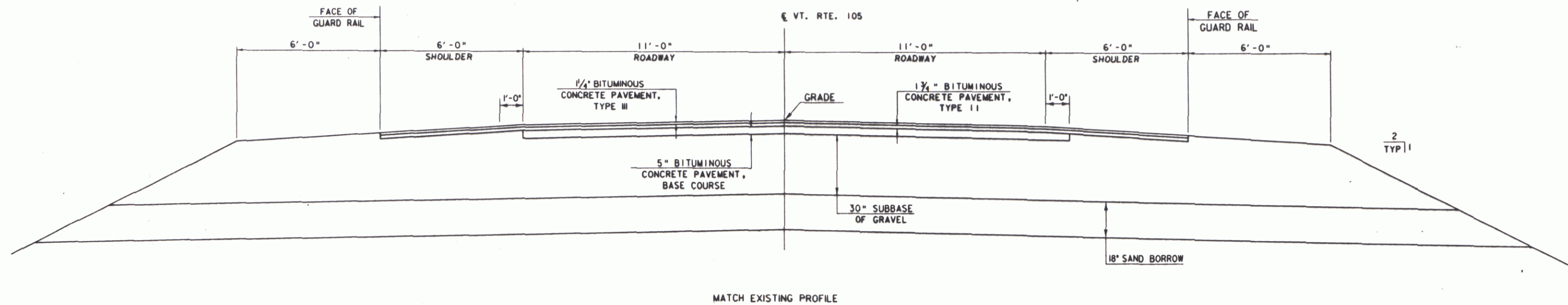

SEEDING FORMULA - RURAL AREA

X WT.	LBS./A.	NAME	PLR %	GERM %
37.5	22.5	CREeping RED FESCUE	98	85
37.5	22.5	TALL FESCUE	98	90
5.0	3.0	RED TOP	98	90
15.0	9.0	BIRDFOOT TREFOL	98	85
5.0	3.0	ANNUAL RYEGRASS	98	85
100.0	62.0			

SEEDING FORMULA - URBAN AREA

X WT.	LBS./A.	NAME	PLR %	GERM %
42.5	34.0	CREeping RED FESCUE	98	85
42.5	34.0	KENTUCKY BLUE GRASS	85	85
10.0	8.0	PERENIAL RYE GRASS	98	90
5.0	4.0	ANNUAL RYE GRASS	98	85
100.0	80.0			

THE SEED MIXTURE SHALL NOT HAVE A WEED CONTENT EXCEEDING 0.40% BY WEIGHT AND SHALL BE FREE OF ALL NOXIOUS WEED SEEDS.
 SEED- TO BE APPLIED PER SEEDING FORMULAS DIRECTED BY THE ENGINEER.
 FERTILIZER- FORMULA 19-19-19 TO BE USED WITH SEED, APPLIED AT THE RATE OF 500 LBS./ACRE.
 AGRICULTURAL LIMESTONE- TO BE APPLIED AT THE RATE OF 2 TONS/ACRE OR AS DIRECTED BY THE ENGINEER.
 MAY MATCH- TO BE PLACED ON EARTH SLOPES AT THE RATE OF 2 TONS/ACRE OR AS DIRECTED BY THE ENGINEER.
 TOPSOIL- TO BE USED WITH SEED AS INDICATED ON THE PLANS, OR AS DIRECTED BY THE ENGINEER.

STATE OF VERMONT AGENCY OF TRANSPORTATION

Town Of	NEWPORT	Bridge No.	80
Highway No.	VT. RTE. 105	Log Sta.	MM 2.300
		Surv. Sta.	122 + 00
VT. RTE. 105 OVER MUD CREEK			
ROADWAY TYPICALS			
Designed By	P. THURBER	Drawn By	M. CERITTI
Checked By	P. THURBER	Date	6/92
		Bridge Design Supervisor	D. E. LATHROP
		Date	6/92

TROY - NEWPORT
 F 034-2(10)S C/2
 R. O. W. SHEET 2 OF 5 SHEETS

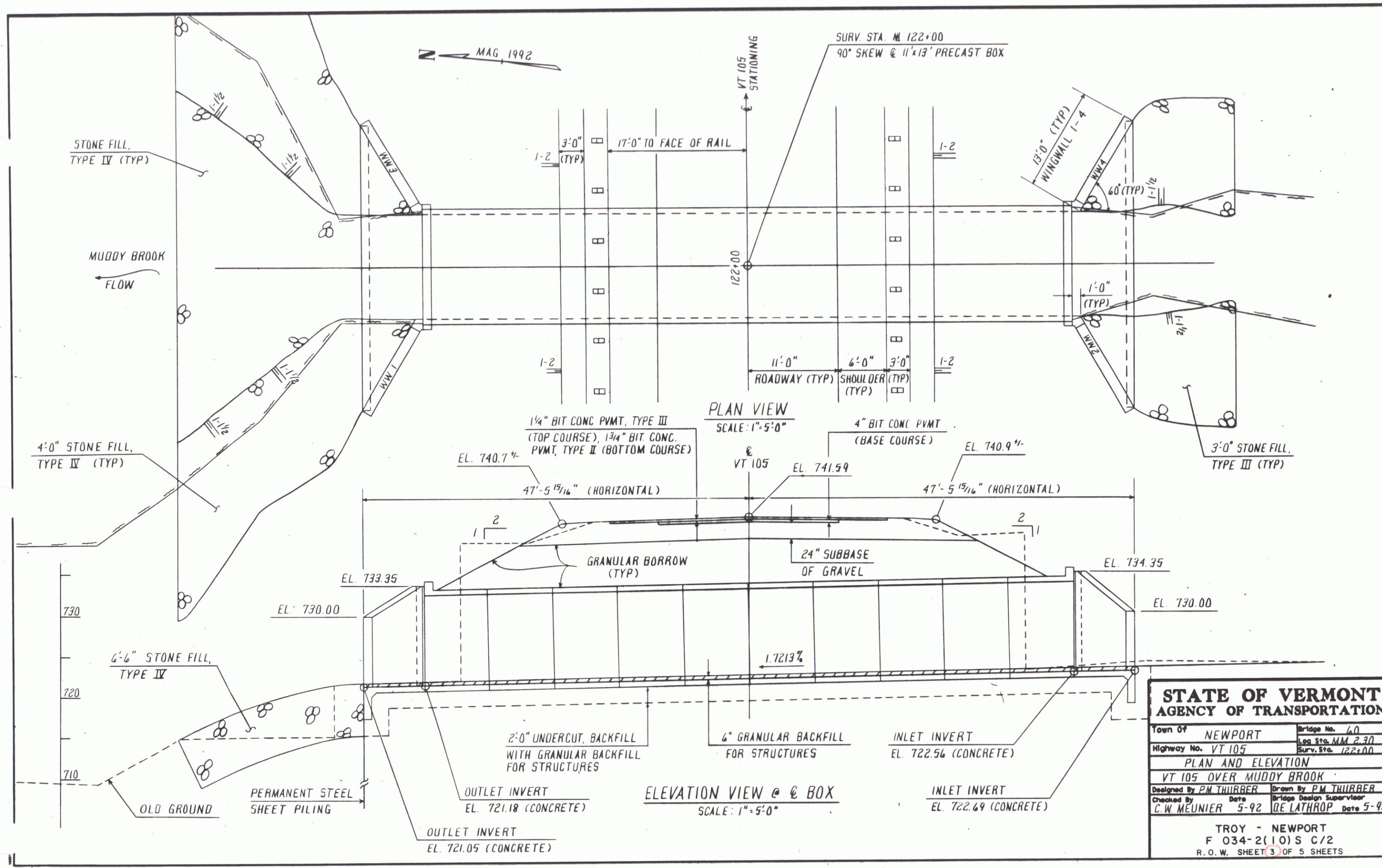

NOV 21 1994

3

TABLE OF PROJECT PROPERTY ACQUISITION

STATE OF VERMONT
AGENCY OF TRANSPORTATION
RIGHT OF WAY PLANS
DETAIL SHEET

PARCEL NO.	GRANTOR	SHEET NO.	BEGINNING STATION	ENDING STATION	TAKING	REM.	RIGHTS	TITLE TAKEN	DATE	TOWN OR CITY RECORDED	BK.	PG.	REMARKS	REVISION NO.	SHEET	DESCRIPTION OF REVISION	DATE	MADE BY	APPROVED BY
1	PATENAUDE, LEO M. & MERCEDES	5	121+21 LT. 123+42 LT. 122+25 LT.	122+81 LT. 122+55 LT.	0.07A±		CHANNEL (T) 0.01A±	MOE	10-18-93 Release 7-27-93	NEWPORT TOWN	180	150-160	3200 S.F.± 22' DRIVE MM 0233 620 S.F.±	1	4, 5	PARCEL NO. 1 PATENAUDE. ADD 22' DRIVE AT STA. 123+42 LT.; MM 0233. ADD CHANNEL (T) AT STA. 122+25 LT. ~ 122+55 LT.; 0.01A±. 620 S.F.±. THESE ADDITIONS WILL BE BY OPTION ONLY. PER C.O. 8370. MYLARS TO STRUCTURES 10-29-93	05-10-93	M. J. R.	L. W. B.
2	CITIZENS UTILITIES COMPANY												UTILITY						
3	NEW ENGLAND TELEPHONE COMPANY												UTILITY						

03-3474 1805 878209

ACCT: prop
/usr/z/fat/070070.dlr/92b044d.dgn
DATE PLOTTED 8-MAY-1993
92b044d.l

DR. (P)- DRAINAGE RIGHT
DIT. (P)- DITCHING RIGHT
CH. (P)- CHANNEL RT.
DRIVE (T)- DRIVE RIGHT
CUL. (P)- CULVERT RIGHT
[W]- WATER SOURCES

PRESENT R.O.W.
TAKING WITHOUT ACCESS
TAKING WITHOUT ACCESS ALONG PROPERTY LINE
TAKING WITH ACCESS
PERMANENT EASEMENT
TEMPORARY EASEMENT

LEGEND
--- CZ (P) --- CLEAR ZONE
--- CONST. (T) --- CONSTRUCTION EASEMENT
SR SR SLOPE RIGHTS
P PROPERTY LINE
L TOP OF CUT
△ △ △ TOE OF SLOPE

REVISED 05-10-93

R. O. W. PLANS

APPROVED: LAWRENCE W. BLISS DATE: 12-08-92
AGENT D. PLANS & TITLES

TROY - NEWPORT
F 034-2(10) S C/2
SHEET 4 OF 5

NOV 21 1994

4

BEGIN R. O. W. PROJECT

F 034-2(10)S C/2 STA. 121+21 60' LT.

END R. O. W. PROJECT

F 034-2(10)S C/2 STA. 122+81 60' LT.

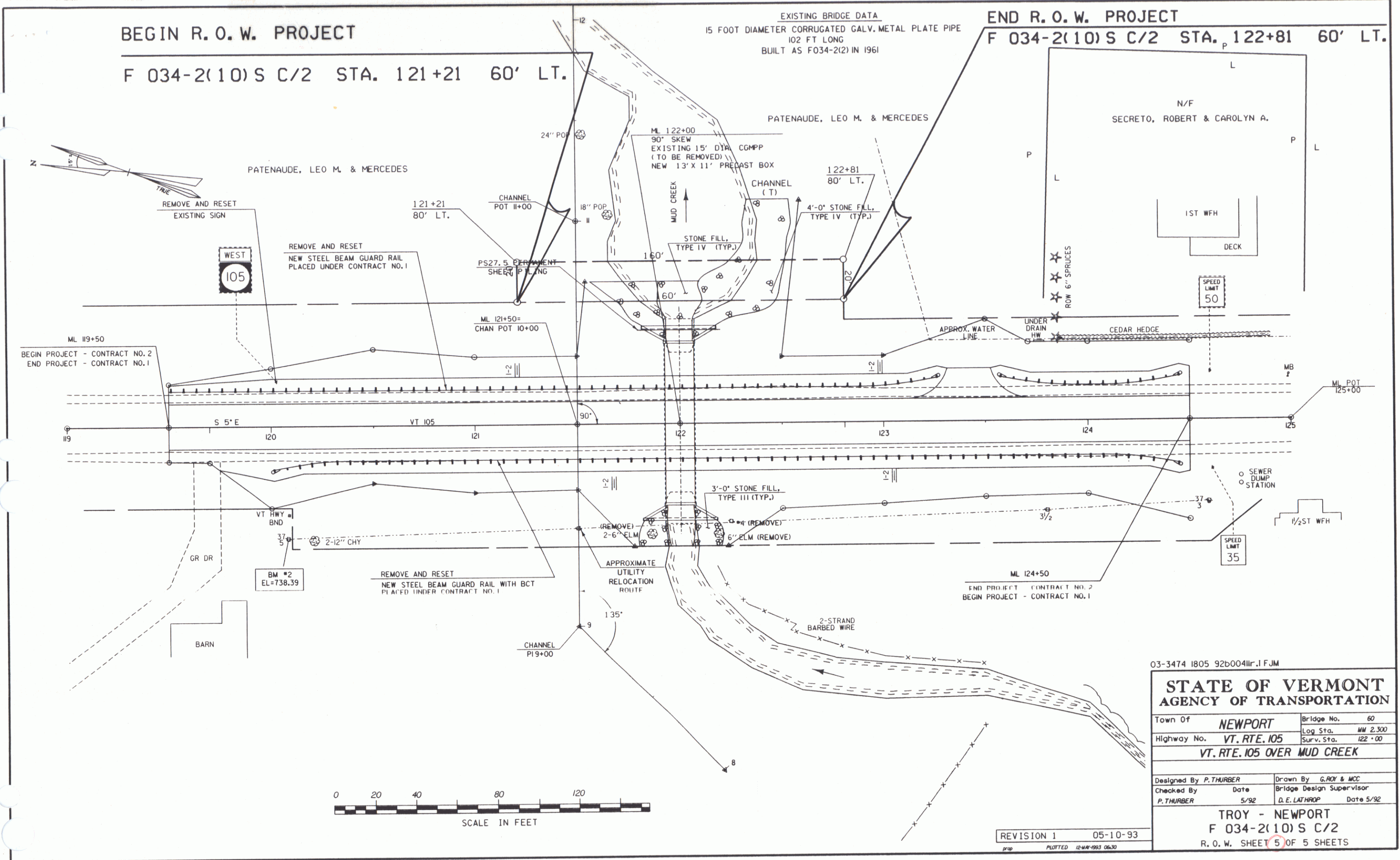

03-3474 1805 92b004lr.1.FJM

STATE OF VERMONT AGENCY OF TRANSPORTATION	
Town Of NEWPORT	Bridge No. 60
Highway No. VT. RTE. 105	Log Sta. MM 2.300
VT. RTE. 105 OVER MUD CREEK	
Designed By P. THURBER	Drawn By G. ROY & MCC.
Checked By P. THURBER	Date 5/92
	Bridge Design Supervisor D.E. LATHROP
	Date 5/92
TROY - NEWPORT	
F 034-2(10)S C/2	
R. O. W. SHEET 5 OF 5 SHEETS	

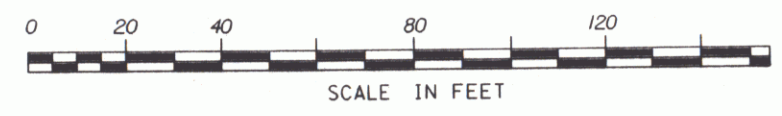

REVISION 1 05-10-93
PLOTTED 12-MAR-1993 06:30

NOV 21 1994 5