

BEGIN R. O. W. PROJECT

F 034-2(10)S C/2 STA. 121+21 60' LT.

END R. O. W. PROJECT

F 034-2(10)S C/2 STA. 122+81 60' LT.

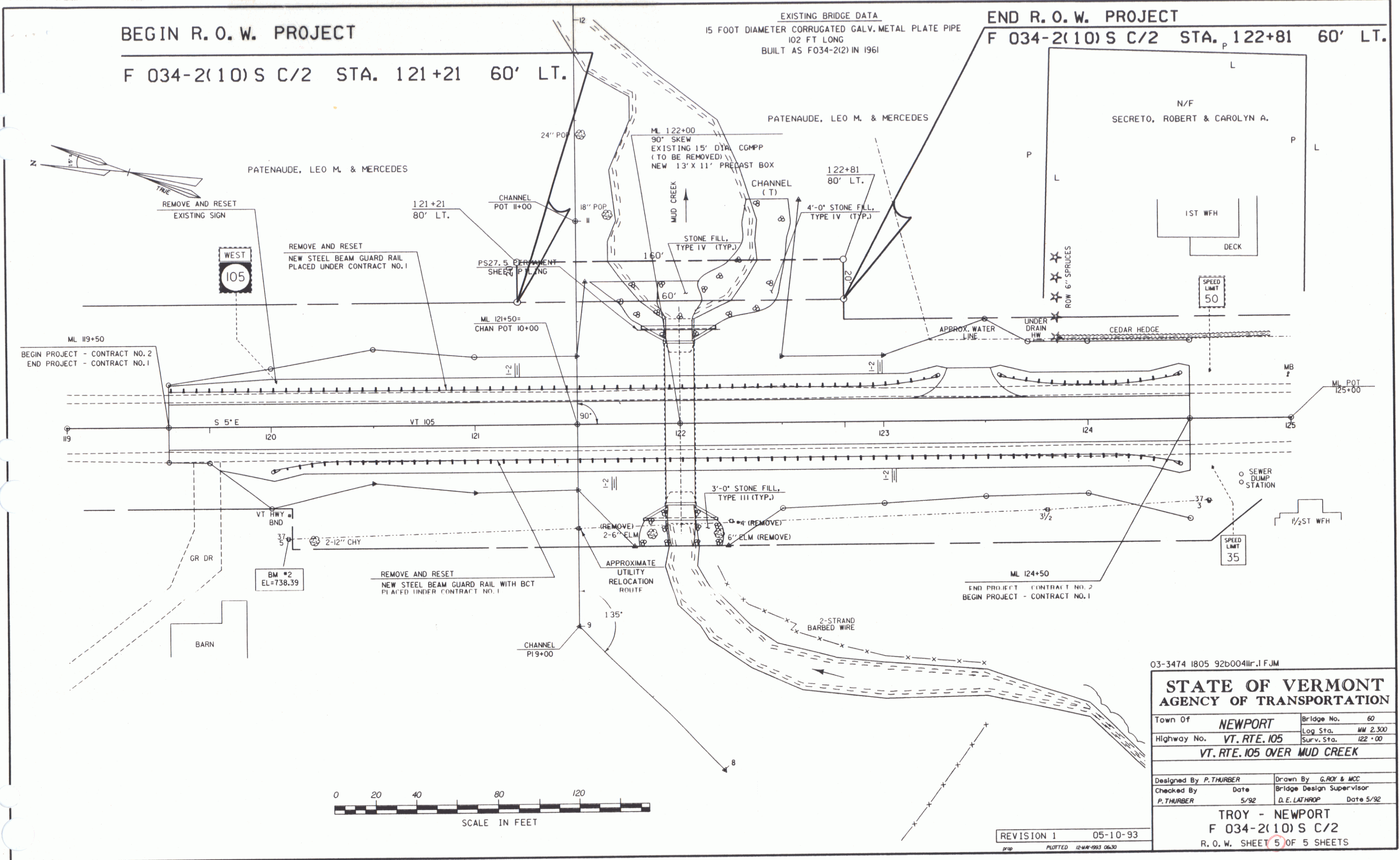

03-3474 1805 92b004lr.1.FJM

STATE OF VERMONT AGENCY OF TRANSPORTATION	
Town Of NEWPORT	Bridge No. 60
Highway No. VT. RTE. 105	Log Sta. MM 2.300
VT. RTE. 105 OVER MUD CREEK	
Designed By P. THURBER	Drawn By G. ROY & MCC.
Checked By P. THURBER	Date 5/92
	Bridge Design Supervisor D.E. LATHROP Date 5/92
TROY - NEWPORT	
F 034-2(10)S C/2	
R. O. W. SHEET 5 OF 5 SHEETS	

NOV 21 1994

5