

TIE DISTANCE TABLE

STATION	DESC.	TIE #	DISTANCE	DESCRIPTION	HEIGHT ABOVE GRND.	REMARKS
13+38.23	K	K1	57.35'	CORNER BUILDING TRIM	1'±	
13+31.89	K	K2	46.35'	CORNER BUILDING TRIM	1'±	
	K	K3	38.43'	CORNER CONCRETE RAMP WALL	1'±	
14+33.80	L	L1	82.33'	NAIL CTR. BOTTOM HORIZ. SIGN BOARD	2'±	ABOVE SIGN
	L	L2	83.45'	1/4" NAIL IN UTILITY POLE	2'±	IN PAVEMENT
	L	L3	47.15'	CONC. NAIL 1" IN FROM CORNER PARKING LOT		
14+87.65	M	M1	42.17'	CONC. NAIL 1" IN FROM CORNER PARKING LOT		SAME AS L3
	M	M2	46.88'	CONC. NAIL 1" IN EDGE OF PARKING LOT		IN LINE WITH SIGN
	M	M3	52.88'	NAIL IN TOP CTR. OF PLANTER TIMBER	2'	ROADSIDE END
16+32.10	N	N1	48.28'	OUT. CLOSE CORNER OF PORCH POST	3.7'±	ABOVE WALK
	N	N2	39.82'	CORNER BUILDING TRIM	3.7'±	ABOVE WALK
	N	N3	41.48'	NAIL TOP CORNER TIMBER RET. WALL	1'	TOP OF RET. WALL
19+05.54	O	O1	68.54'	CORNER CONCRETE FOUNDATION	1'	BELOW TRIM
	O	O2	8.89'	NAIL IN CORNER SIGN POST		ABOVE METAL
	O	O3	35.91'	NAIL IN 1" ST FENCE POST	1'	
20+70.47	P	P1	51.88'	CONC. NAIL END OF 6TH WHITE LINE		IN PAVEMENT
	P	P2	31.22'	CONC. NAIL END OF 1ST WHITE LINE		IN PAVEMENT
	P	P3	59.27'	NAIL IN SIGN POST	1'±	
22+72.72	Q	Q1	30.00'	NAIL IN 15" RED PINE	0.7'±	ABOVE WALK
	Q	Q2	80.05'	CORNER CONCRETE FOUNDATION WALL	0.3'±	
	Q	Q3	46.77'	NAIL IN 15" RED PINE	1.3'±	
23+28.47	R	R1	14.50'	NAIL IN 15" RED PINE	1.2'±	SAME AS Q3
	R	R2	13.85'	NAIL IN 15" RED PINE	1.2'±	
	R	R3	43.10'	NAIL IN GUY POLE	1.1'±	
23+35.32	S	S1	16.78'	NAIL IN 15" RED PINE	1.3'±	SAME AS Q2 R1
	S	S2	12.43'	NAIL IN 15" RED PINE	1.3'±	SAME AS R2
	S	S3	38.27'	NAIL IN GUY POLE	1.2'±	SAME AS R3
24+81.84	T	T1	40.00'	NAIL IN 18" RED PINE	0.6'	IN LASH
24+57.52	T	T2	12.74'	CONC. NAIL IN PATCH OF CONCRETE		OPPOSITE SIDE
	T	T3	25.43'	CONC. NAIL IN WHITE LINE		
25+84.04	U	U1	82.43'	CORNER BUILDING TRIM	2'	ABOVE STONE PATIO
	U	U2	21.88'	NAIL IN SIGN POST	2'±	
	U	U3	18.18'	NAIL IN SIGN POST	2'±	ROADSIDE

TANGENT LINE BEARINGS

STATION	TIE #	BEARING	DISTANCE
13+38.23 TO 14+33.80	K TO L	N 02°21'25" W	101.91'
14+33.80 TO 14+87.65	L TO M	N 02°21'25" W	53.85'
14+87.65 TO 16+32.10	M TO N	N 01°25'28" W	144.45'
16+32.10 TO 19+05.54	N TO O	N 03°04'17" W	273.44'
19+05.54 TO 20+70.47	O TO P	N 08°25'22" W	164.93'
20+70.47 TO 22+72.72	P TO Q	N 11°59'16" W	202.25'
22+72.72 TO 23+28.47	Q TO R	N 16°14'23" W	55.75'
23+28.47 TO 23+35.32	R TO S	N 14°08'49" W	8.85'
23+35.32 TO 24+81.84	S TO T	N 14°08'49" W	128.52'
24+81.84 TO 24+57.52	T TO U	N 40°03'28" W	128.52'

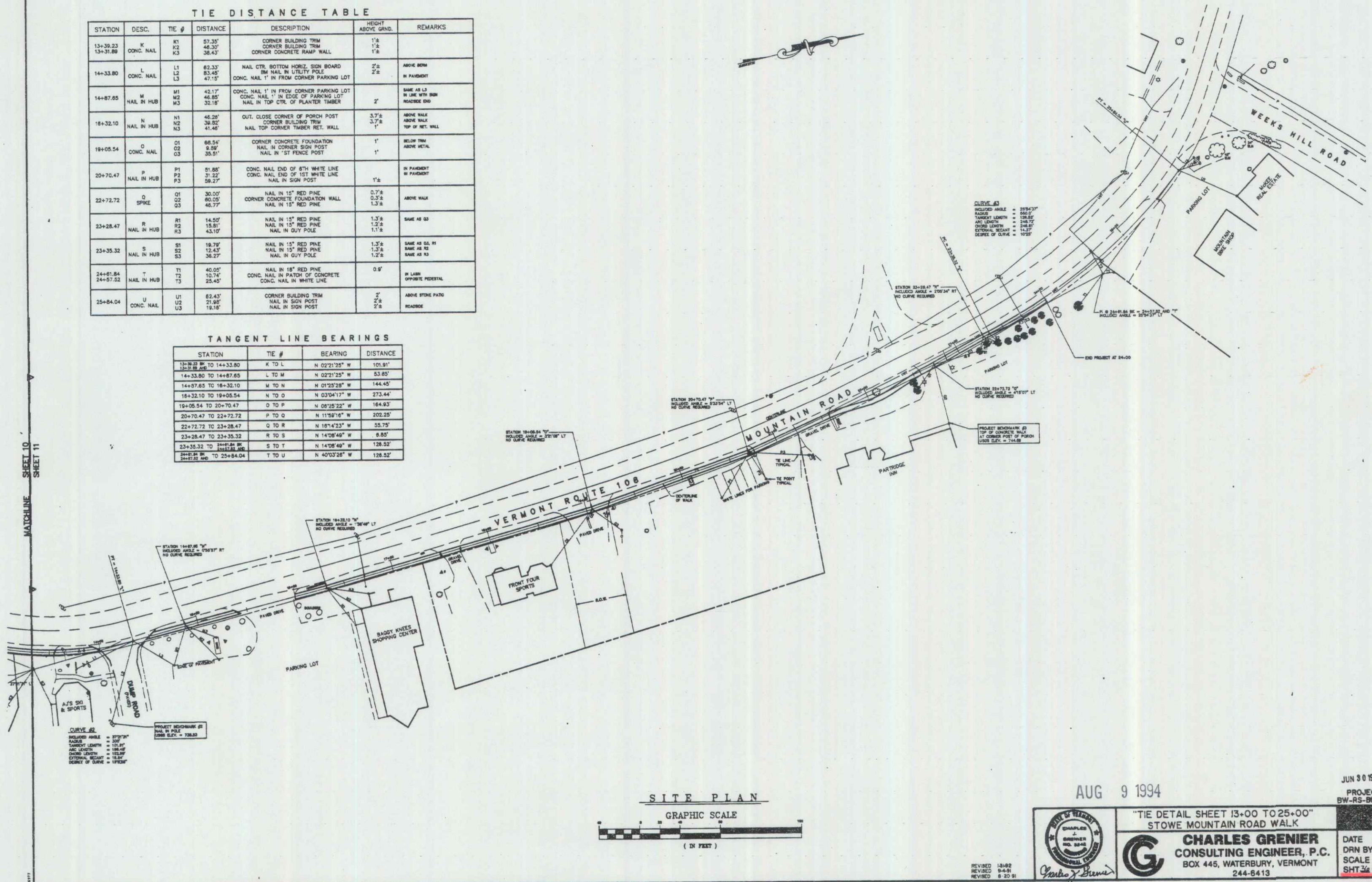

JUN 30 1992
PROJECT
BW-RS-BIKE (25)

AUG 9 1994

"TIE DETAIL SHEET 13+00 TO 25+00"
STOWE MOUNTAIN ROAD WALK

CHARLES GRENIER
CONSULTING ENGINEER, P.C.
BOX 445, WATERBURY, VERMONT
244-6413

DATE 8-14-91
DRN BY T.J.M.
SCALE 1"=40'
SHT 36 OF 39