

SUPERELEVATION TABLE		
STATION	LEFT LANE	RIGHT LANE
0+12	MATCH EXISTING GRADE	MATCH EXISTING GRADE
0+30	+0.02	-0.02
3+00	+0.02	-0.02
3+25	LEVEL	LEVEL
3+50	-0.02	+0.02
6+00	-0.02	+0.02
6+25	LEVEL	LEVEL
6+50	+0.02	-0.02
11+25	+0.02	-0.02
11+53	MATCH EXISTING GRADE	MATCH EXISTING GRADE

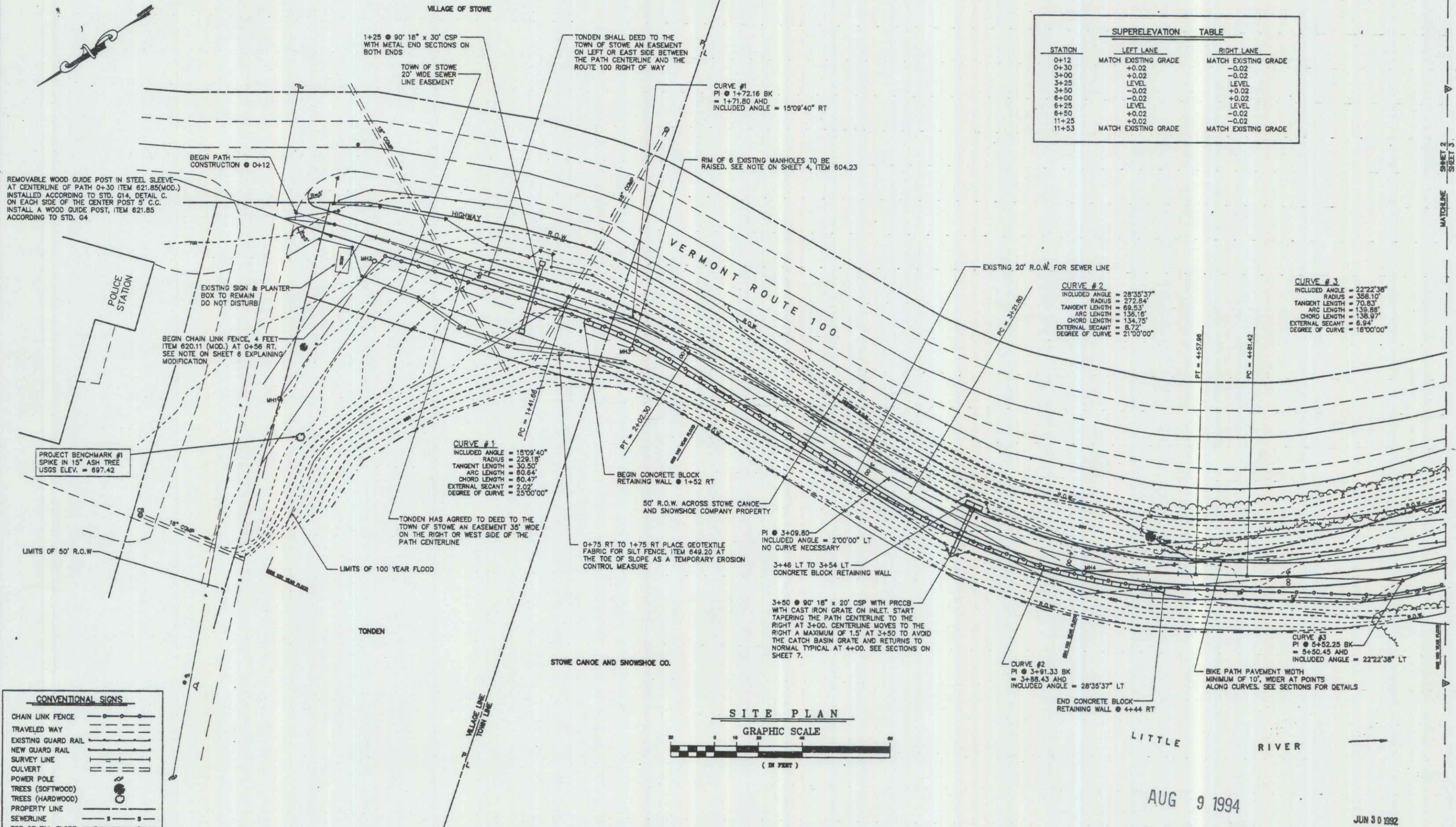

CONVENTIONAL SIGNS	
CHAIN LINK FENCE	— — — — —
TRAVELED WAY	— — — — —
EXISTING GUARD RAIL	— — — — —
NEW GUARD RAIL	— — — — —
SURVEY LINE	— — — — —
CULVERT	— — — — —
POWER POLE	— — — — —
TREES (SOFTWOOD)	— — — — —
TREES (HARDWOOD)	— — — — —
PROPERTY LINE	— — — — —
SEWERLINE	— — — — —
TOE OF FILL SLOPE	— — — — —
TOP OF CUT SLOPE	— — — — —
RIGHT OF WAY	— — — — —
SILT FENCE	— — — — —



AUG 9 1994

JUN 30 1992

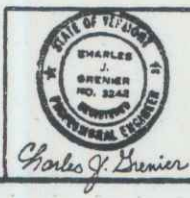

TOWN OF STOWE - RIVER WALK
"SITE PLAN 0+00 TO 5+80"
CHARLES GRENIER
CONSULTING ENGINEER, P.C.
BOX 445, WATERBURY, VERMONT
244-6413

BW-RS-BKE (29)
DATE 10-25-91
DRN BY T.J.M.
SCALE 1"=20'
SHT 3 OF 33

58-92 - REVISED STOWE CANOE R.O.W.