

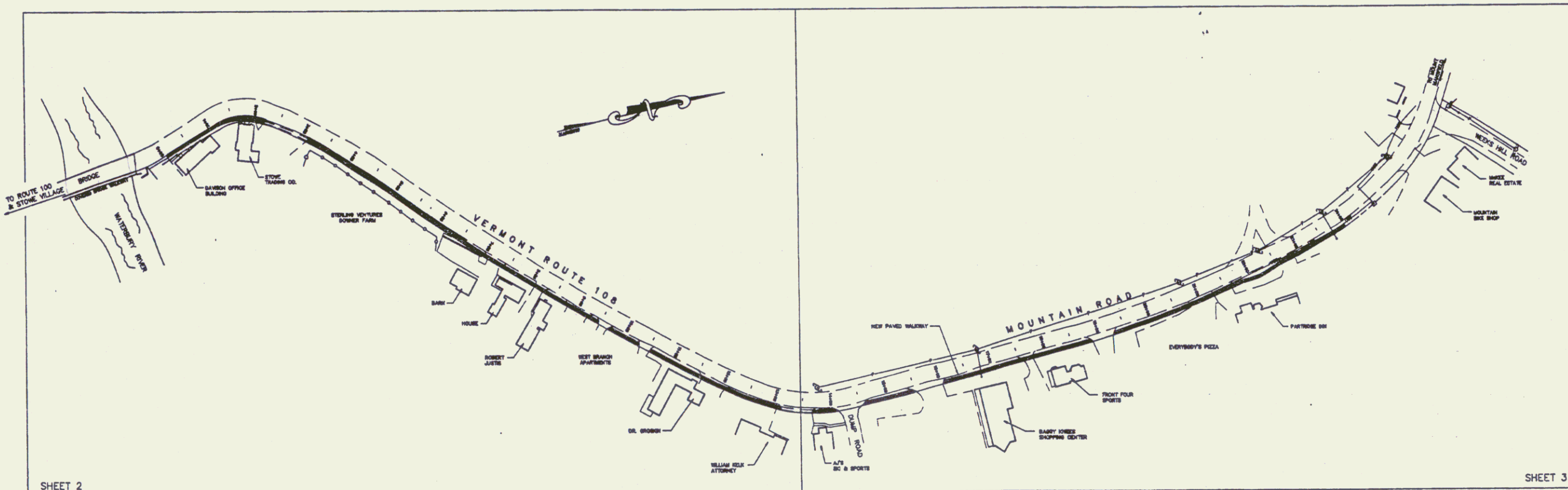

# VILLAGE OF STOWE

## MOUNTAIN ROAD WALK

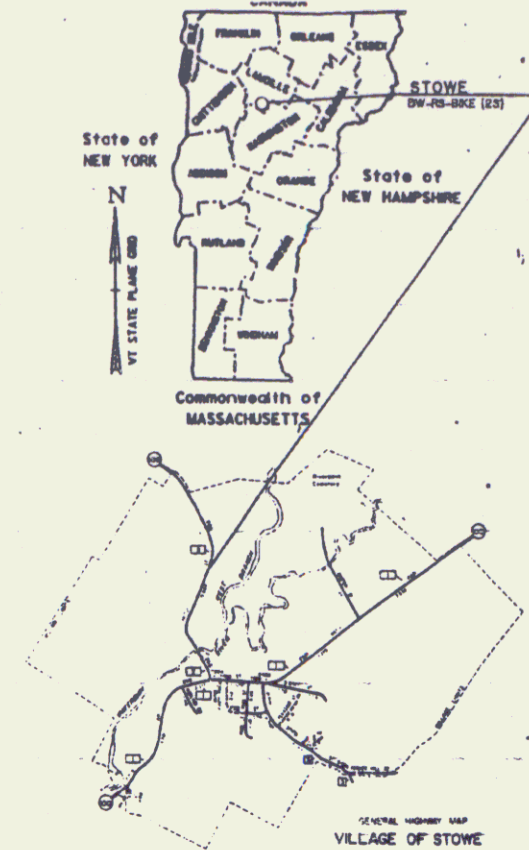

### INDEX OF SHEETS

NUMBER	TITLE
1	TITLE SHEET
2	SITE PLAN 0+00 TO 13+00
3	SITE PLAN 13+00 TO 25+50
4	CENTERLINE PROFILE
5	QUANTITY SUMMARY
6	EARTHWORK SUMMARY
7	SECTIONS 0+00 - 7+00
8	SECTIONS 7+15 - 15+00

APPLICABLE A.O.T. STANDARDS	
B-5	SLOPE GRADING, EMBANKMENT, MUD
C-1	CURBS, BITUMINOUS CONCRETE SIDEWALKS
C-3	SIDEWALK RAMPS
E-100	CONSTRUCTION APPROACH SIGNS
E-101	CONSTRUCTION SIGN DETAILS
E-102	CONSTRUCTION SIGN DETAILS
E-108	TRAFFIC CONTROL, MISCELLANEOUS DETAILS
E-107	DELIMITATION, BARRICADES AND DETOURS FOR CONSTRUCTION AREAS
E-107A	BREAKAWAY BARRICADE DETAILS

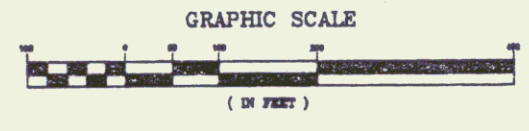

**PROJECT SCOPE:**  
 THIS PROJECT INVOLVES THE CONSTRUCTION OF A BITUMINOUS CONCRETE SIDEWALK ALONG THE EAST SIDE OF VERMONT ROUTE 108 WITHIN THE VILLAGE OF STOWE, STARTING AT THE COVERED BROOK WALKWAY OVER THE WATERBURY RIVER AND ENDING SOME 200' AWAY BEYOND THE PARADEGUE BAY. EXCAVATION AND PLACING A GRAVEL SUBBASE WILL BE REQUIRED.

AUG 9 1994

**SHEET 1A** JUN 30 1992 PROJECT  
 "TITLE SHEET" STOWE MOUNTAIN ROAD WALK **2** BW-RS-BIKI

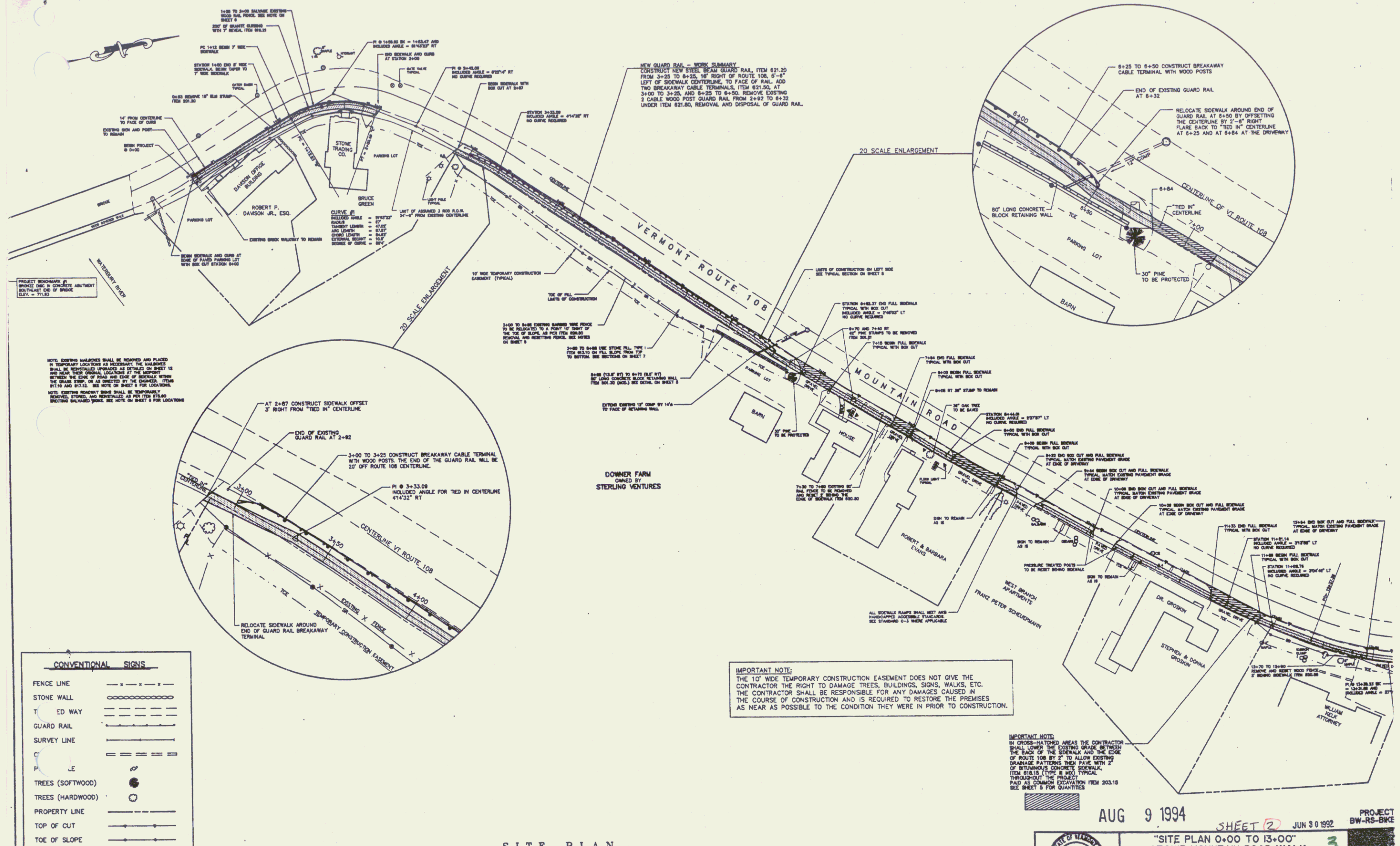

SITE PLAN

AUG 9 1994  
 SHEET 12  
 JUN 30 1992  
 PROJECT BW-RS-BIKE  
 "SITE PLAN 0+00 TO 13+00" STOWE MOUNTAIN ROAD WALK 3

CONVENTIONAL SIGNS

FENCE LINE	---
STONE WALL	○○○○○○○○○○
TED WAY	----
GUARD RAIL	----
SURVEY LINE	----
C	○
TREES (SOFTWOOD)	●
TREES (HARDWOOD)	○
PROPERTY LINE	----
TOP OF CUT	----
TOE OF SLOPE	----

IMPORTANT NOTE:  
 THE 10' WIDE TEMPORARY CONSTRUCTION EASEMENT DOES NOT GIVE THE CONTRACTOR THE RIGHT TO DAMAGE TREES, BUILDINGS, SIGNS, WALKS, ETC. THE CONTRACTOR SHALL BE RESPONSIBLE FOR ANY DAMAGES CAUSED IN THE COURSE OF CONSTRUCTION AND IS REQUIRED TO RESTORE THE PREMISES AS NEAR AS POSSIBLE TO THE CONDITION THEY WERE IN PRIOR TO CONSTRUCTION.

IMPORTANT NOTE:  
 IN CROSS-HATCHED AREAS THE CONTRACTOR SHALL LOWER THE EXISTING GRADE (BETWEEN THE BACK OF THE SIDEWALK AND THE TOE OF ROUTE 108 BY 3" TO ALLOW EXISTING GRANULAR PATTERNS TO REMAIN WITH 4" OF BITUMINOUS CONCRETE SURFACING. ITEM 818.15 (TYPE B) IS TYPICAL THROUGHOUT THE PROJECT. PROJECT SHALL PAID AS COMMON EXCAVATION ITEM 203.18 SEE SHEET 8 FOR QUANTITIES

MATCHLINE SHEET 2 SHEET 3

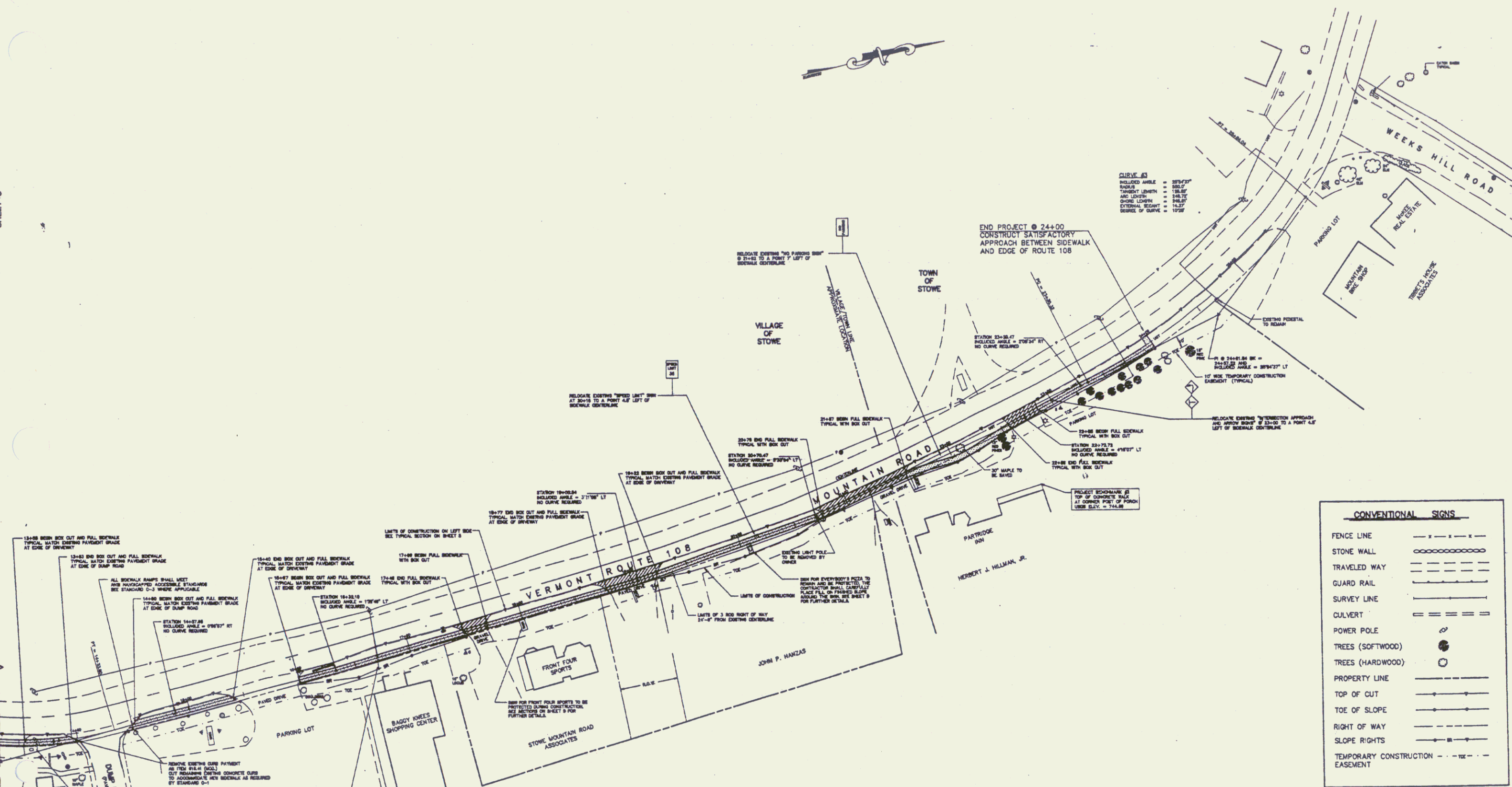

CURVE A3  
 ROLLOFF ANGLE = 25.47°  
 RADIUS = 100.0'  
 TANGENT LENGTH = 18.81'  
 CHORD LENGTH = 34.21'  
 EXTERNAL SECANT = 14.21'  
 BEARING OF CURVE = 192°

CONVENTIONAL SIGNS	
FENCE LINE	— — — — —
STONE WALL	— — — — —
TRAVELED WAY	— — — — —
GUARD RAIL	— — — — —
SURVEY LINE	— — — — —
CULVERT	— — — — —
POWER POLE	⊙
TREES (SOFTWOOD)	●
TREES (HARDWOOD)	⊙
PROPERTY LINE	— — — — —
TOP OF CUT	— — — — —
TOE OF SLOPE	— — — — —
RIGHT OF WAY	— — — — —
SLOPE RIGHTS	— — — — —
TEMPORARY CONSTRUCTION EASEMENT	— — — — —

**IMPORTANT NOTE:**  
 THE 10' WIDE TEMPORARY CONSTRUCTION EASEMENT DOES NOT GIVE THE CONTRACTOR THE RIGHT TO DAMAGE TREES, BUILDINGS, SIGNS, WALKS, ETC. THE CONTRACTOR SHALL BE RESPONSIBLE FOR ANY DAMAGES CAUSED IN THE COURSE OF CONSTRUCTION AND IS REQUIRED TO RESTORE THE PREMISES AS NEAR AS POSSIBLE TO THE CONDITION THEY WERE IN PRIOR TO CONSTRUCTION.

STATION 18+00.00  
 ROLLOFF ANGLE = 27.78° LT  
 NO CURVE REQUIRED

STATION 18+10.00  
 ROLLOFF ANGLE = 17.94° LT  
 NO CURVE REQUIRED

STATION 18+20.00  
 ROLLOFF ANGLE = 17.94° LT  
 NO CURVE REQUIRED

STATION 18+30.00  
 ROLLOFF ANGLE = 17.94° LT  
 NO CURVE REQUIRED

STATION 18+40.00  
 ROLLOFF ANGLE = 17.94° LT  
 NO CURVE REQUIRED

STATION 18+50.00  
 ROLLOFF ANGLE = 17.94° LT  
 NO CURVE REQUIRED

STATION 18+60.00  
 ROLLOFF ANGLE = 17.94° LT  
 NO CURVE REQUIRED

STATION 18+70.00  
 ROLLOFF ANGLE = 17.94° LT  
 NO CURVE REQUIRED

STATION 18+80.00  
 ROLLOFF ANGLE = 17.94° LT  
 NO CURVE REQUIRED

STATION 18+90.00  
 ROLLOFF ANGLE = 17.94° LT  
 NO CURVE REQUIRED

STATION 19+00.00  
 ROLLOFF ANGLE = 17.94° LT  
 NO CURVE REQUIRED

STATION 19+10.00  
 ROLLOFF ANGLE = 17.94° LT  
 NO CURVE REQUIRED

STATION 19+20.00  
 ROLLOFF ANGLE = 17.94° LT  
 NO CURVE REQUIRED

STATION 19+30.00  
 ROLLOFF ANGLE = 17.94° LT  
 NO CURVE REQUIRED

STATION 19+40.00  
 ROLLOFF ANGLE = 17.94° LT  
 NO CURVE REQUIRED

STATION 19+50.00  
 ROLLOFF ANGLE = 17.94° LT  
 NO CURVE REQUIRED

STATION 19+60.00  
 ROLLOFF ANGLE = 17.94° LT  
 NO CURVE REQUIRED

STATION 19+70.00  
 ROLLOFF ANGLE = 17.94° LT  
 NO CURVE REQUIRED

STATION 19+80.00  
 ROLLOFF ANGLE = 17.94° LT  
 NO CURVE REQUIRED

STATION 19+90.00  
 ROLLOFF ANGLE = 17.94° LT  
 NO CURVE REQUIRED

STATION 20+00.00  
 ROLLOFF ANGLE = 17.94° LT  
 NO CURVE REQUIRED

STATION 20+10.00  
 ROLLOFF ANGLE = 17.94° LT  
 NO CURVE REQUIRED

STATION 20+20.00  
 ROLLOFF ANGLE = 17.94° LT  
 NO CURVE REQUIRED

STATION 20+30.00  
 ROLLOFF ANGLE = 17.94° LT  
 NO CURVE REQUIRED

STATION 20+40.00  
 ROLLOFF ANGLE = 17.94° LT  
 NO CURVE REQUIRED

STATION 20+50.00  
 ROLLOFF ANGLE = 17.94° LT  
 NO CURVE REQUIRED

STATION 20+60.00  
 ROLLOFF ANGLE = 17.94° LT  
 NO CURVE REQUIRED

STATION 20+70.00  
 ROLLOFF ANGLE = 17.94° LT  
 NO CURVE REQUIRED

STATION 20+80.00  
 ROLLOFF ANGLE = 17.94° LT  
 NO CURVE REQUIRED

STATION 20+90.00  
 ROLLOFF ANGLE = 17.94° LT  
 NO CURVE REQUIRED

STATION 21+00.00  
 ROLLOFF ANGLE = 17.94° LT  
 NO CURVE REQUIRED

STATION 21+10.00  
 ROLLOFF ANGLE = 17.94° LT  
 NO CURVE REQUIRED

STATION 21+20.00  
 ROLLOFF ANGLE = 17.94° LT  
 NO CURVE REQUIRED

STATION 21+30.00  
 ROLLOFF ANGLE = 17.94° LT  
 NO CURVE REQUIRED

STATION 21+40.00  
 ROLLOFF ANGLE = 17.94° LT  
 NO CURVE REQUIRED

STATION 21+50.00  
 ROLLOFF ANGLE = 17.94° LT  
 NO CURVE REQUIRED

STATION 21+60.00  
 ROLLOFF ANGLE = 17.94° LT  
 NO CURVE REQUIRED

STATION 21+70.00  
 ROLLOFF ANGLE = 17.94° LT  
 NO CURVE REQUIRED

STATION 21+80.00  
 ROLLOFF ANGLE = 17.94° LT  
 NO CURVE REQUIRED

STATION 21+90.00  
 ROLLOFF ANGLE = 17.94° LT  
 NO CURVE REQUIRED

STATION 22+00.00  
 ROLLOFF ANGLE = 17.94° LT  
 NO CURVE REQUIRED

STATION 22+10.00  
 ROLLOFF ANGLE = 17.94° LT  
 NO CURVE REQUIRED

STATION 22+20.00  
 ROLLOFF ANGLE = 17.94° LT  
 NO CURVE REQUIRED

STATION 22+30.00  
 ROLLOFF ANGLE = 17.94° LT  
 NO CURVE REQUIRED

STATION 22+40.00  
 ROLLOFF ANGLE = 17.94° LT  
 NO CURVE REQUIRED

STATION 22+50.00  
 ROLLOFF ANGLE = 17.94° LT  
 NO CURVE REQUIRED

STATION 22+60.00  
 ROLLOFF ANGLE = 17.94° LT  
 NO CURVE REQUIRED

STATION 22+70.00  
 ROLLOFF ANGLE = 17.94° LT  
 NO CURVE REQUIRED

STATION 22+80.00  
 ROLLOFF ANGLE = 17.94° LT  
 NO CURVE REQUIRED

STATION 22+90.00  
 ROLLOFF ANGLE = 17.94° LT  
 NO CURVE REQUIRED

STATION 23+00.00  
 ROLLOFF ANGLE = 17.94° LT  
 NO CURVE REQUIRED

STATION 23+10.00  
 ROLLOFF ANGLE = 17.94° LT  
 NO CURVE REQUIRED

STATION 23+20.00  
 ROLLOFF ANGLE = 17.94° LT  
 NO CURVE REQUIRED

STATION 23+30.00  
 ROLLOFF ANGLE = 17.94° LT  
 NO CURVE REQUIRED

STATION 23+40.00  
 ROLLOFF ANGLE = 17.94° LT  
 NO CURVE REQUIRED

STATION 23+50.00  
 ROLLOFF ANGLE = 17.94° LT  
 NO CURVE REQUIRED

STATION 23+60.00  
 ROLLOFF ANGLE = 17.94° LT  
 NO CURVE REQUIRED

STATION 23+70.00  
 ROLLOFF ANGLE = 17.94° LT  
 NO CURVE REQUIRED

STATION 23+80.00  
 ROLLOFF ANGLE = 17.94° LT  
 NO CURVE REQUIRED

STATION 23+90.00  
 ROLLOFF ANGLE = 17.94° LT  
 NO CURVE REQUIRED

STATION 24+00.00  
 ROLLOFF ANGLE = 17.94° LT  
 NO CURVE REQUIRED

SITE PLAN

AUG 9 1994

JUN 30 19

PROJECT BW-RS-BKE

"SITE PLAN 13+00 TO 25+50"  
 STOWE MOUNTAIN ROAD WALK

SHEET 3

4

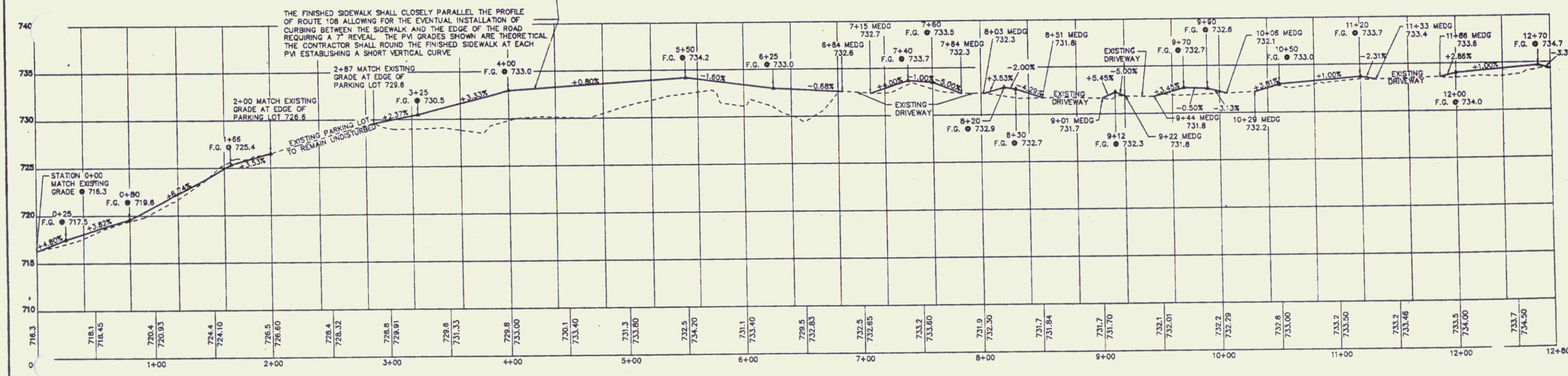
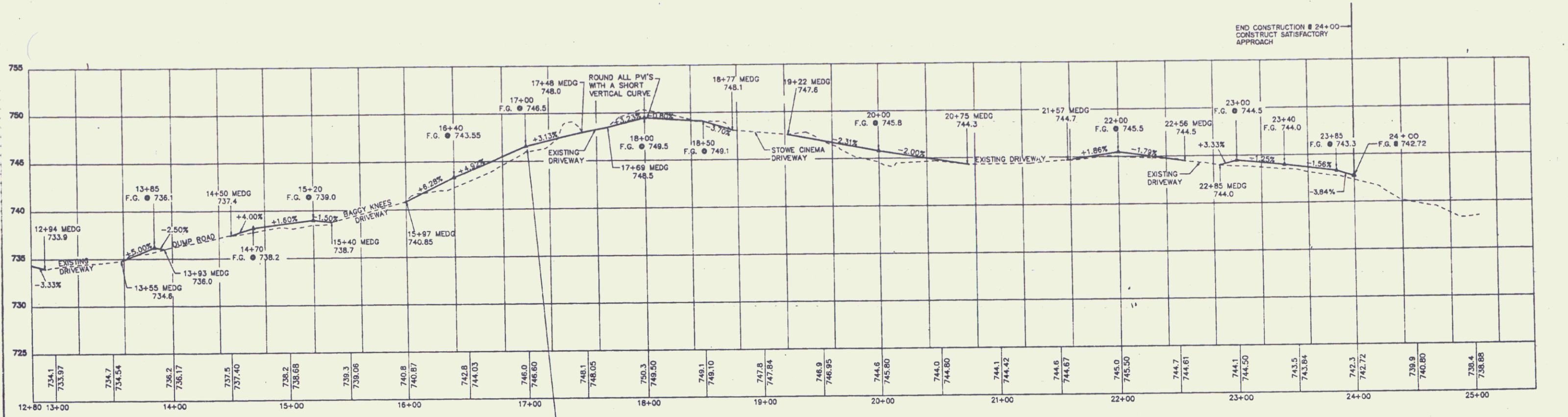

NOTE: MEDG = MATCH EXISTING DRIVEWAY GRADE

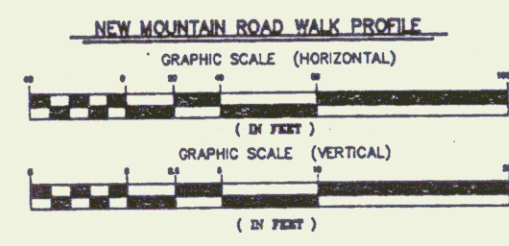

AUG 9 1994

SHEET 4

"CENTERLINE PROFILE"  
STOWE MOUNTAIN ROAD WALK

JUN 9 0 1994  
PROJECT  
BW-RS-BWCE

# QUANTITY SUMMARY

APPROXIMATE SUMMARY OF QUANTITIES				
GRAND TOTAL	UNIT	PAY ITEM	PAY ITEM NUMBER	RNDG
1	EACH	REMOVING SMALL STUMPS	201.20	-
2	EACH	REMOVING LARGE STUMPS	201.21	-
420	CY	COMMON EXCAVATION	203.15	11
180	CY	EARTH BORROW	203.30	15
590	CY	SUBBASE OF GRAVEL	301.15	13
39	CY	CONCRETE, CLASS C (MOD.)	501.30	-
14	LF	12" CSP (TH=0.064")	601.0005	-
210	CY	STONE FILL, TYPE I	613.10	7
200	LF	VERTICAL GRANITE CURB	616.21	-
34	LF	REMOVAL OF EXISTING CURB (MOD.)	616.41	-
4	EACH	RELOCATE MAILBOX, SINGLE SUPPORT	617.10	-
3	EACH	RELOCATE MAILBOX, MULTIPLE SUPPORT	617.12	-
170	TON	BITUMINOUS CONCRETE SIDEWALK	618.15	9
355	LF	REMOVAL AND RESETTING FENCE	620.50	-
75	LF	REMOVAL OF EXISTING FENCE	620.55	-
300	LF	STEEL BEAM GUARD RAIL	621.20	-
2	EACH	BREAKAWAY CABLE TERMINAL	621.50	-
340	LF	REMOVAL AND DISPOSAL OF GUARD RAIL	621.80	-
30	HOUR	UNIFORMED TRAFFIC OFFICERS	630.10	-
160	HOUR	FLAGGERS	630.45	-
0.50	LS	TESTING EQUIPMENT - CONCRETE	651.16	-
0.50	LS	TESTING EQUIPMENT - BITUMINOUS	651.17	-
0.55	LS	MOBILIZATION	655.10	-
55	SY	GEOTEXTILE FABRIC FOR FILTERS	649.10	-
40	LB	* SEED	651.15	-
250	LB	* FERTILIZER	651.18	-
1	TON	* AGRICULTURAL LIMESTONE	651.20	-
1	TON	* HAY MULCH	651.25	-
140	CY	* TOPSOIL	651.35	7
3	EACH	ERECTING SALVAGED SIGNS	675.60	-

\* CALCULATED 0.5 ACRES OF DISTURBED AREA

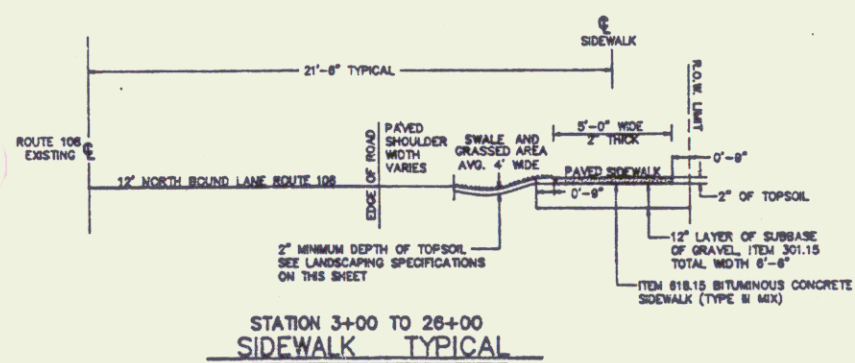
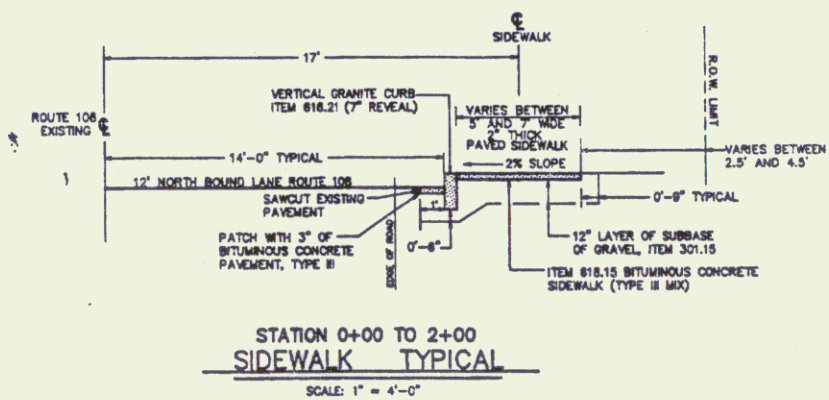

## GENERAL NOTES

- ITEM 501.30 CONCRETE, CLASS C SHALL BE MODIFIED AS FOLLOWS:  
THE CONCRETE BLOCK RETAINING WALL BETWEEN STATION 5+88 TO 6+70 SHALL BE CONSTRUCTED WITH LARGE CONCRETE BLOCKS WITH DIMENSIONS OF 2' x 4' x 4'. A 1" DIMENSION TOLERANCE IS ALLOWED. THESE BLOCKS ARE TO BE CONSTRUCTED OF WASTE CONCRETE FROM AREA SUPPLIERS. THE BLOCKS SHALL BE PLACED WITH THE SMOOTHEST FACE OUTWARD. EACH BLOCK SHALL HAVE LIFTING HOOKS WHICH SHALL BE REMOVED AFTER THE BLOCKS ARE IN PLACE. NO REINFORCING STEEL IS NECESSARY. THE TOP ROW OF BLOCKS SHALL BE OFFSET BY 3" FROM THE BOTTOM ROW. ALL COSTS ASSOCIATED WITH DELIVERING AND PLACING THE BLOCKS AT THE LOCATION AND GRADE SHOWN ON THE PLANS IS INCLUDED IN THE PER CUBIC YARD COST FOR THIS ITEM. THE MINOR AMOUNT OF EXCAVATION NECESSARY TO SET THE BOTTOM ROW OF BLOCKS SHALL ALSO BE INCLUDED IN THE COST OF THIS ITEM. THE COST OF BACKFILLING AGAINST THE BACK OF THE WALL HAS BEEN INCLUDED IN THE COST OF THE SUBBASE OF GRAVEL, ITEM 301.15.
- THIS PROJECT WILL INVOLVE THE REMOVAL OF LESS THAN 10 CUBIC YARDS OF PAVEMENT NORMALLY PAID AS ITEM 203.28 EXCAVATION OF SURFACES AND PAVEMENTS. BECAUSE OF THE SMALL VOLUME, THIS WORK HAS BEEN INCLUDED IN THE COMMON EXCAVATION QUANTITY. ALL PAVEMENT SHALL BE DISPOSED OF NEAR THE BOTTOM OF THE FILL BETWEEN STATION 3+50 AND 9+50.
- THE LARGE SIGN AT STATION 18+00 MARKED "FRONT FOUR SPORTS" AND THE SIGN NEAR STATION 20+10 MARKED "EVERYBODY'S PIZZA" SHALL BE PROTECTED BY THE CONTRACTOR AS DETAILED ON THE SITE PLAN AND SECTIONS.
- THE GUY POLE AND ANCHOR NEAR STATIONS 13+65 AND 16+71 SHALL BE RELOCATED BY THE VILLAGE OF STOWE WATER AND LIGHT DEPARTMENT AND IS NOT THE RESPONSIBILITY OF THE CONTRACTOR.
- THERE ARE THREE PRESSURE TREATED WOOD POSTS MARKING THE DRIVEWAYS BETWEEN STATION 9+00 AND 10+50. THESE POSTS SHALL BE RESET TO A LOCATION AT LEAST 2' BEHIND THE SIDEWALK. THE COST ASSOCIATED WITH REMOVING AND RESETTING THESE SMALL POSTS SHALL BE INCLUDED IN THE COST OF COMMON EXCAVATION ITEM 203.15.
- BECAUSE OF THE VERY CONGESTED AREA ALONG ROUTE 108 AND THE LACK OF AN OBVIOUS TOPSOIL STOCKPILE AREA, THE COMMON EXCAVATION WHICH INCLUDES THE TOPSOIL SHALL BE USED IN THE EMBANKMENT AREAS. NEW TOPSOIL SHALL BE TRUCKED ONTO THE SITE FOR USE IN THE FINISHED LANDSCAPING WITH PAYMENT UNDER ITEM 651.35.
- REMOVAL OF EXISTING CURB, ITEM 616.41 SHALL BE MODIFIED TO REQUIRE THE CUTTING OF THE REMAINING END OF THE EXISTING CURB ON A TAPER AS DETAILED ON STANDARD C1.
- THE COST OF TRAFFIC CONTROL IS SUBSIDIARY TO OTHER PAY ITEMS. SEE STANDARDS E100, E101, E106, E107, E107A, AND E110 FOR DETAILS.
- THE BITUMINOUS CONCRETE SIDEWALK SHALL BE PLACED IN ONE 2" THICK LIFT.

## LANDSCAPING SPECIFICATIONS

### SEEDING FORMULA, ITEM 651.15

% WT.	LBS./A.	NAME	PUR. %	GERM. %
31.25	25	CREeping RED FESCUE	85	85
31.25	25	KENTUCKY BLUE GRASS	85	75
31.25	25	PERENNIAL RYE GRASS	95	90
100.00	80			

THE SEED MIXTURE SHALL NOT HAVE A WEED CONTENT EXCEEDING 0.40% BY WEIGHT AND SHALL BE FREE OF ALL NOXIOUS WEED SEED.

SEED - TO BE APPLIED PER SEEDING FORMULAS DIRECTED BY THE ENGINEER.

FERTILIZER - FORMULA 10-20-10 TO BE USED WITH SEED, APPLIED AT A RATE OF 500 LBS./ACRE.

AGRICULTURAL LIMESTONE - TO BE APPLIED AT THE RATE OF 2 TONS/ACRE OR AS DIRECTED BY THE ENGINEER.

HAY MULCH - TO BE PLACED ON EARTH SLOPES AT THE RATE OF 2 TONS/ACRE OR AS DIRECTED BY THE ENGINEER.

SLOPE ROUNDING - ALL CUT SLOPES TO BE ROUNDED IN ACCORDANCE WITH STANDARD SHEET B-5.

## QUANTITIES

- ITEM 201.20 REMOVING SMALL STUMPS (TOTAL OF 1)  
0+93 15" ELM STUMP
- ITEM 201.21 REMOVING LARGE STUMPS (TOTAL OF 2)  
6+70± 42" STUMP  
7+40± 42" STUMP
- ITEM 501.30 (MOD.) CONCRETE, CLASS C  
THE CONCRETE BLOCK RETAINING WALL BETWEEN 5+88 AND 6+70 HAS A TOTAL OF 33 BLOCKS (2' x 4' x 4'), OR  
33 (2 x 4 x 4) + 27 = 39 CY
- ITEM 601.0005, 12" CSP (TH = 0.064")  
AT 6+32 AN EXISTING 12" METAL CULVERT SHALL BE EXTENDED BY 14' TO ALIGN WITH THE FACE OF NEW RETAINING WALL.
- ITEM 616.21 VERTICAL GRANITE CURB  
VERTICAL GRANITE CURB SHALL BE USED FROM 0+00 TO 2+00 TO SUPPORT THE EDGE OF THE SIDEWALK AND TO PROTECT PEDESTRIANS  
TOTAL = 200 LF
- ITEM 618.15 BITUMINOUS CONCRETE SIDEWALK QUANTITIES:  
1. STANDARD 5' SIDEWALK 2096' LONG = 10,450 SF  
2. 2' WIDER SIDEWALK 1+00 TO 2+00 = 200 SF  
3. AREAS BETWEEN SIDEWALK AND EDGE OF ROAD AT DRIVEWAYS:  
7+00± AREA 45' x 5' = 225  
8+00± AREA 25' x 5' = 125  
9+75± AREA 55' x 5' = 275  
11+50± AREA 60' x 5' = 300  
17+50± AREA 30' x 6' = 180  
19+00± AREA 55' x 6' = 330  
21+00± AREA 90' x 5' = 450  
22+75± AREA 35' x 5' = 175  
SUBTOTAL = 2060 SF
- 4. PATCHING IN FRONT OF GRANITE CURB (3" THICK)  
200' x 1' x 3' x 2" = 300 SF  
SUBTOTAL = 13,010 SF  
TOTAL TONNAGE = 13,010 x 2' x 2' / 128 = 161 TONS
- ITEM 621.20 STEEL BEAM GUARD RAIL  
3+25 TO 6+25, OR 300 LF
- ITEM 621.50 BREAKAWAY CABLE TERMINAL  
3+00 TO 3+25 AND 6+25 TO 6+50, OR A TOTAL OF 2
- ITEM 621.80 REMOVAL AND DISPOSAL OF GUARD RAIL  
2+82 TO 6+32, OR 340 LF
- ITEM 649.10 GEOTEXTILE FABRIC FOR FILTERS  
BEHIND RETAINING WALL 5+88 TO 6+70 ESTIMATED 6' x 82' - 9 = 55 SY

AUG 9 1994

JUN 8 0 1992

SHEET 4A

PROJECT  
BW-RS-BIKE 12



"QUANTITY SUMMARY"  
STOWE MOUNTAIN ROAD W&K

# EARTHWORK SUMMARY

STATION	FINISHED GRADE	DISTANCE	COMMON EXCAVATION		SUBBASE OF GRAVEL		EMBANKMENT	
			AREA	VOLUME	AREA	VOLUME	AREA	VOLUME
<b>BOX CUT</b>								
0+00	716.3		10.5		9		0	
0+22	717.4	22	8	8	10.5	8	1	1
0+44	718.2	22	8	7	10.5	9	1	1
0+50	718.5	6	8	2	10.5	2	1	0
0+80	719.6	30	7	8	10.5	12	2.5	2
1+00	720.9	20	7	5	10.5	8	0	1
1+50	724.1	50	18	21	11	20	0	0
1+66	725.4	16	15	9	11	7	0	0
2+00	726.6	34	14	18	11	14	0	0
<b>BOX CUT</b>								
2+87	729.6		7.5		6.5		0	
3+00	729.9	13	2	2	9.5	4	8	2
3+50	731.3	50	0	2	8.5	17	25	31
4+00	733.0	50	0	0	10	17	47	67
4+50	733.4	50	0	0	8.5	17	56	95
5+00	733.8	50	0	0	8	15	52	100
	734.2	50	2.5	2	8.5	15	44	89
	733.4	50	0	2	41	46	0	41
6+50	732.8	50	3	3	27.5	63	0	0
6+84	732.6	34	9	8	6.5	21	1	1
<b>BOX CUT</b>								
7+15	732.7		7.5		6.5		1.5	
7+50	733.6	35	6	9	6.5	8	2.5	3
7+84	732.3	34	7.5	9	6.5	8	0	2
<b>BOX CUT</b>								
8+03	732.3		7.5		6.5		0	
8+50	731.8	47	6	12	6.5	11	0	0
<b>BOX CUT</b>								
9+00	731.7		7		6.5		0	
9+22	731.8	22	7	6	6.5	5	0	0
<b>BOX CUT</b>								
9+44	731.8		7.5		6.5		0	
9+50	732.0	6	7.5	2	6.5	2	0	0
10+00	732.3	50	7.5	14	6.5	12	0	0
	732.1	6	7.5	2	6.5	2	0	0
<b>BOX CUT</b>								
10+29	732.2		7.5		6.5		1	
	733.0	21	7.5	6	6.5	5	1	1
	733.5	50	7.5	14	6.5	12	1	2
	733.4	33	7.5	9	6.5	8	1	1
11+33	733.4		7.5		6.5		0	
<b>COLUMN SUBTOTALS</b>			180 CY	368 CY	440 CY			

STATION	FINISHED GRADE	DISTANCE	COMMON EXCAVATION		SUBBASE OF GRAVEL		EMBANKMENT	
			AREA	VOLUME	AREA	VOLUME	AREA	VOLUME
<b>BOX CUT</b>								
11+86	733.6		7.5		6.5		0	
12+00	734.0	14	5	3	6.5	3	8	2
12+50	734.5	50	3	7	6.5	12	8	15
2+84	733.9	44	3	5	6.5	11	8	13
<b>BOX CUT</b>								
13+55	734.6		7		6.5		2	
13+75	735.8	20	7	5	6.5	5	2	2
13+93	736.0	18	7	5	6.5	4	6	3
<b>BOX CUT</b>								
14+50	737.4		9		6.5		0	
15+00	738.7	50	4.5	13	6.5	12	1.5	1
15+40	738.7	40	4.5	7	6.5	10	1.5	2
<b>BOX CUT</b>								
15+87	740.9		6.5		6.5		0	
16+50	744.0	53	2.5	9	6.5	13	11	11
17+00	748.6	50	4	8	6.5	12	3.5	13
17+48	748.0	48	4	23	6.5	12	0	3
<b>BOX CUT</b>								
17+69	748.5		12		6.5		1	
18+00	748.5	31	15	16	6.5	7	2	2
18+50	749.1	50	10	23	6.5	12	1	3
18+77	748.1	27	10	10	6.5	7	1	1
<b>BOX CUT</b>								
19+22	747.6		8		6.5		3	
19+50	747.0	28	8	8	6.5	7	3	3
20+00	745.6	50	3.5	11	6.5	12	18	19
20+50	744.6	50	5	8	6.5	12	6.5	23
20+75	744.3	25	5	5	6.5	6	6.5	6
<b>BOX CUT</b>								
21+57	744.7		4.5		6.5		2.5	
22+00	745.5	43	4.5	7	6.5	10	2.5	4
22+50	744.6	50	7.5	11	6.5	12	0	2
22+56	744.5	6	7.5	2	6.5	1	0	0
<b>BOX CUT</b>								
22+85	744.0		6		6.5		1.5	
23+00	744.5	15	6	3	6.5	4	1.5	1
23+50	743.8	50	6	11	6.5	12	1.5	3
24+00	742.7	50	6	13	6.5	13	1.5	2
<b>BOX CUT</b>								
<b>COLUMN #2 SUBTOTALS</b>			211 CY	209 CY	134 CY			
<b>COLUMN #1 SUBTOTALS</b>			180 CY	368 CY	440 CY			
<b>PROJECT TOTAL</b>			391 CY	577 CY	574 CY			

\* ADD 18 CY FOR DRIVEWAY WORK FOR A TOTAL OF 409 CY  
SEE CALCULATIONS ON THIS SHEET

### NOTES

1. THE EXISTING MAILBOXES SHALL BE RELOCATED NEAR THEIR ORIGINAL LOCATIONS NEAR THE MIDPOINT BETWEEN THE EDGE OF THE ROAD AND EDGE OF SIDEWALK WITHIN THE GRASS STRIP (5'± LEFT OF THE SIDEWALK CENTERLINE), OR AS DIRECTED BY THE ENGINEER. TEMPORARY RELOCATION MAYBE REQUIRED. PAYMENT AS PER ITEM 617.10 AND 617.12
- ITEM 617.10 RELOCATE MAILBOX, SINGLE SUPPORT (TOTAL OF 4)  
0+97  
7+75  
13+66  
19+38
- ITEM 617.12 RELOCATE MAILBOX, MULTIPLE SUPPORT (TOTAL OF 3)  
7+70  
10+85  
17+35
2. EXISTING ROADWAY SIGNS SHALL BE RELOCATED NEAR THEIR ORIGINAL LOCATION AS DIRECTED BY THE ENGINEER AS PER ITEM 675.60
- ITEM 675.60 ERECTING SALVAGED SIGNS (TOTAL OF 3)  
20+15  
21+92  
23+00
3. ITEM 620.50 REMOVAL AND RESETTING FENCE  
3+00 TO 5+85 (2 STRAND BARBED WIRE) = 285'  
7+30 TO 7+80 (WOOD RAIL) = 50'  
12+70 TO 12+90 (WOOD RAIL) = 20'  
TOTAL = 355'
4. ITEM 620.55 REMOVAL OF EXISTING FENCE (MOD.)  
A 75' WOOD RAIL FENCE (1+25 TO 2+00) SHALL BE REMOVED, SALVAGED, AND BECOME THE PROPERTY OF THE OWNER, THE STOWE TRADING COMPANY, IF THE OWNER DOES NOT WANT THE FENCE, THE CONTRACTOR SHALL ASSUME POSSESSION.

### STONE FILL, TYPE I

STATION	DISTANCE	AREA	VOLUME
BUTT		15	
3+50	50		35
4+00	50	23	
4+50	50	26	48
5+00	50	28	47
5+50	38	25	28
5+88		15 (EST.)	
BUTT			203 CY
<b>TOTAL</b>			

### EARTHWORK SUMMARY

TOTAL EMBANKMENT = 574 CY  
\*TOTAL AVAILABLE COMMON EXCAVATION = 409 CY  
EARTH BORROW REQUIRED = 165 CY

### COMMON EXCAVATION QUANTITIES

ITEM	DESCRIPTION	QUANTITY
203.15	ADDITIONAL COMMON EXCAVATION AT DRIVEWAYS:	
7+00±	40' x 10' x 2' ± (12 x 27)	= 2.5 CY
8+00±	25' x 11' x 2' ± (12 x 27)	= 1.5 CY
9+75±	55' x 10' x 2' ± (12 x 27)	= 3.5 CY
11+50±	55' x 12' x 2' ± (12 x 27)	= 4.0 CY
12+50±	25' x 12' x 2' ± (12 x 27)	= 2.0 CY
21+50±	40' x 10' x 2' ± (12 x 27)	= 2.5 CY
22+75±	35' x 10' x 2' ± (12 x 27)	= 2.0 CY
<b>TOTAL</b>		<b>= 18 CY</b>

AUG 9 1994

JUN 80



SHEET 5  
"EARTHWORK SUMMARY"  
STOWE MOUNTAIN ROAD WALK

PROJ  
EW-RS-BI

7



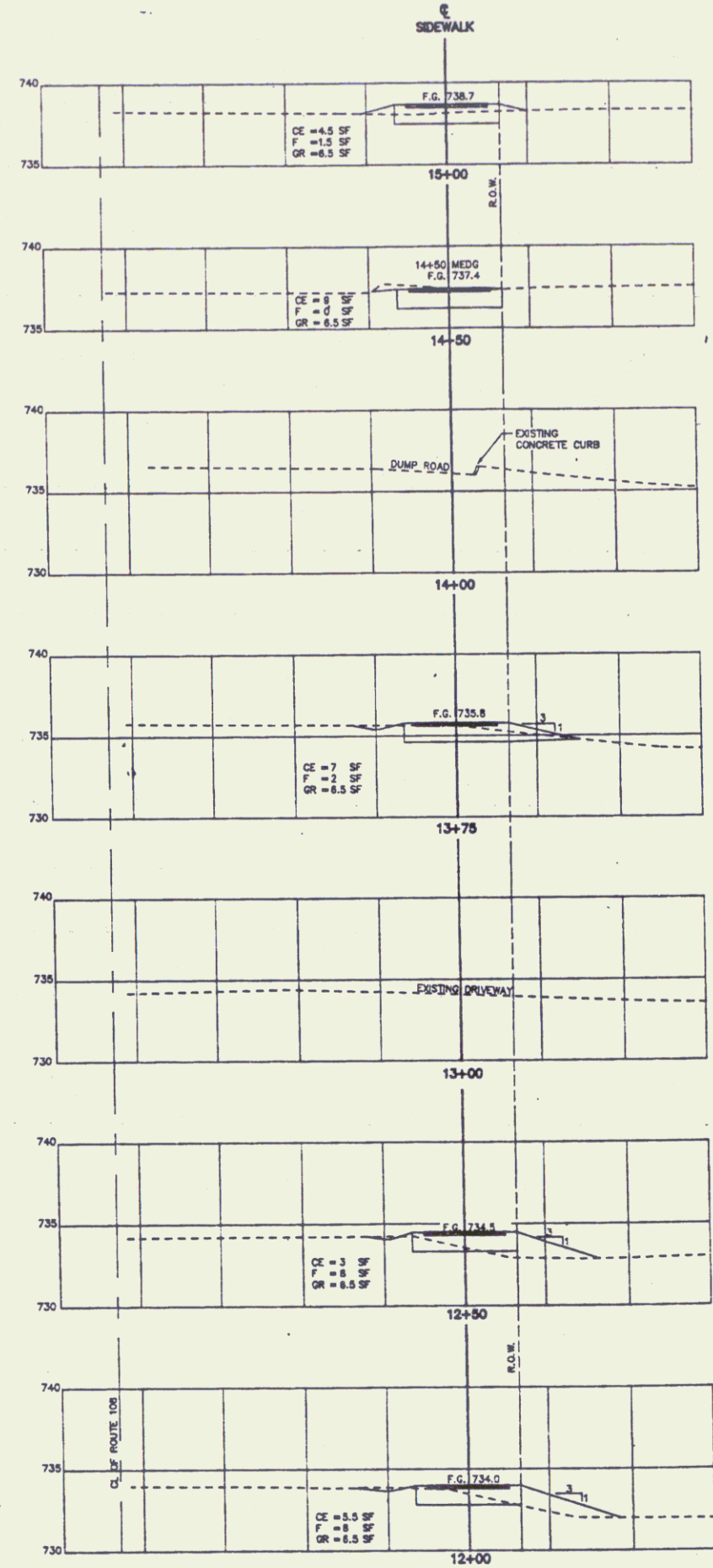
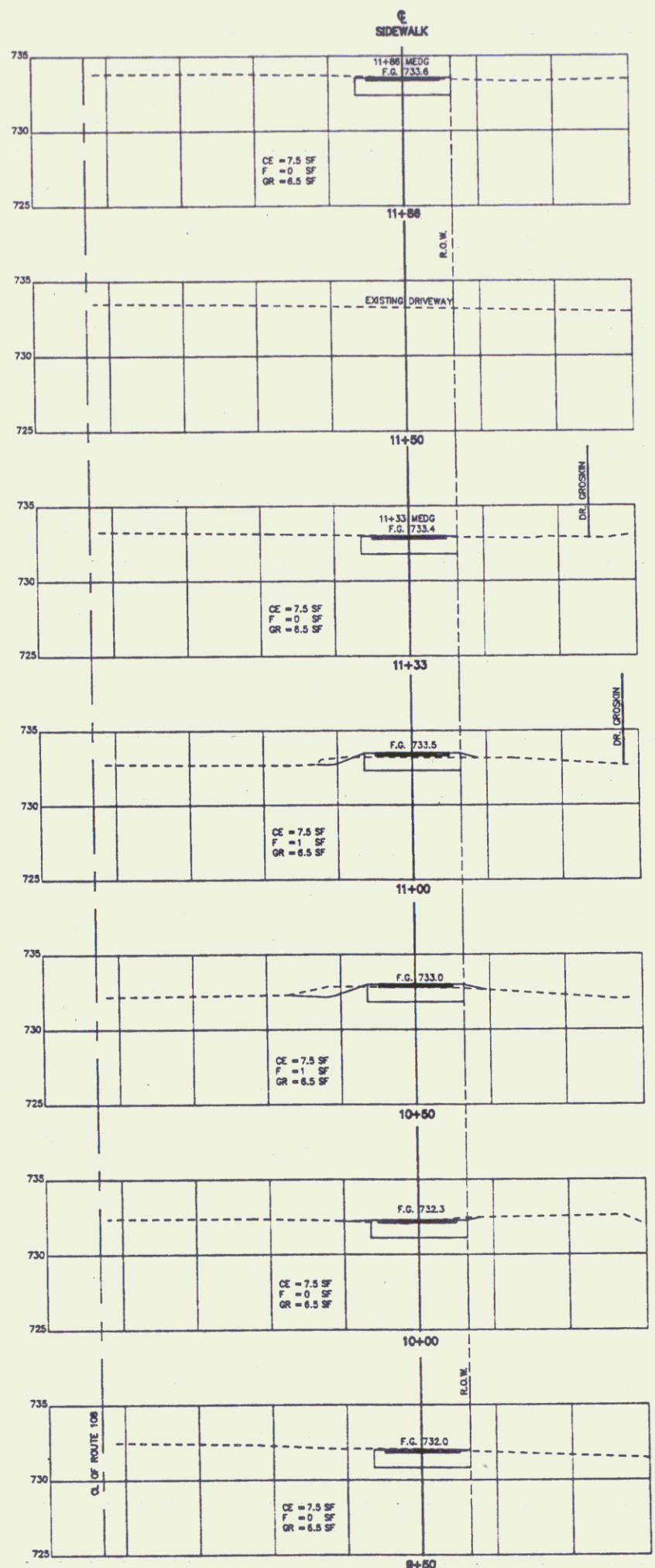
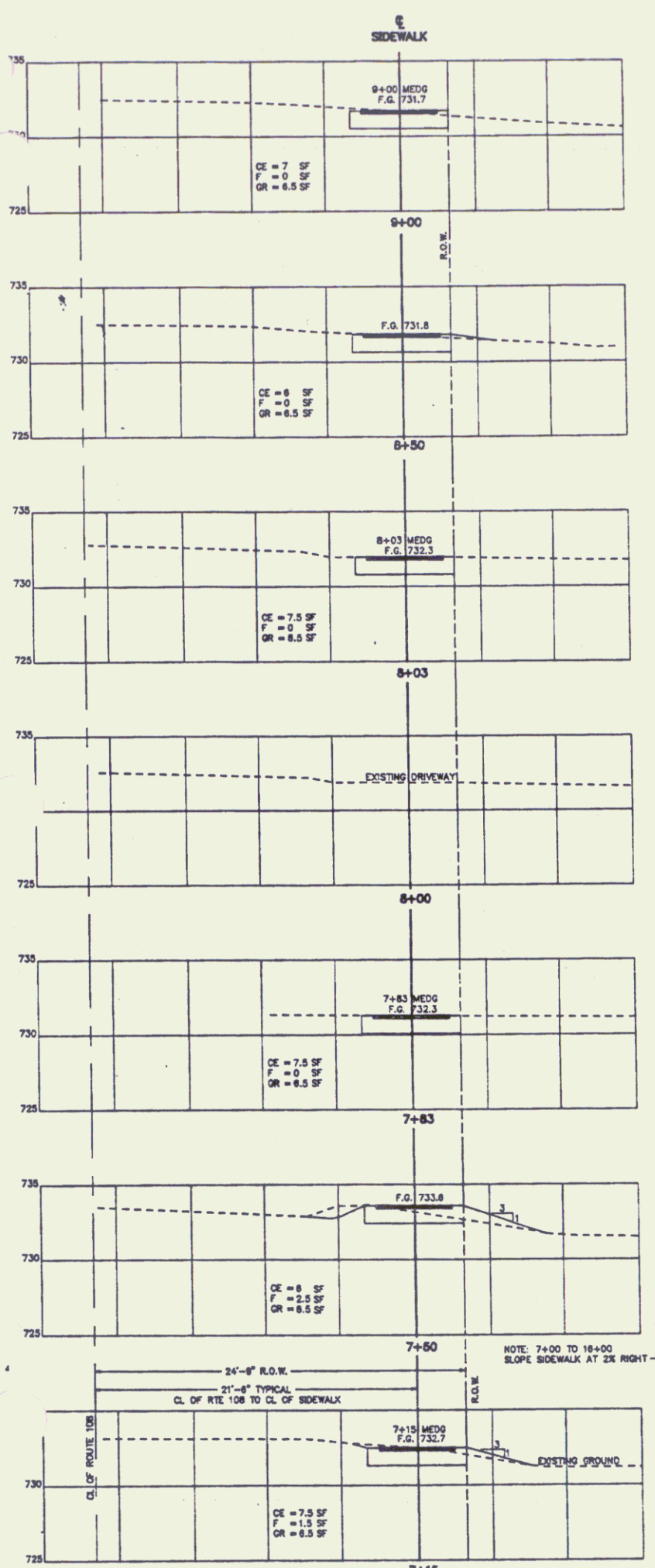

AUG 9 1994

SHEET 7

"SECTIONS 7+15 TO 15+00"  
STOW MOUNTAIN ROAD WALK

JUN 30 1995  
PRO.  
BW-RS-1

9

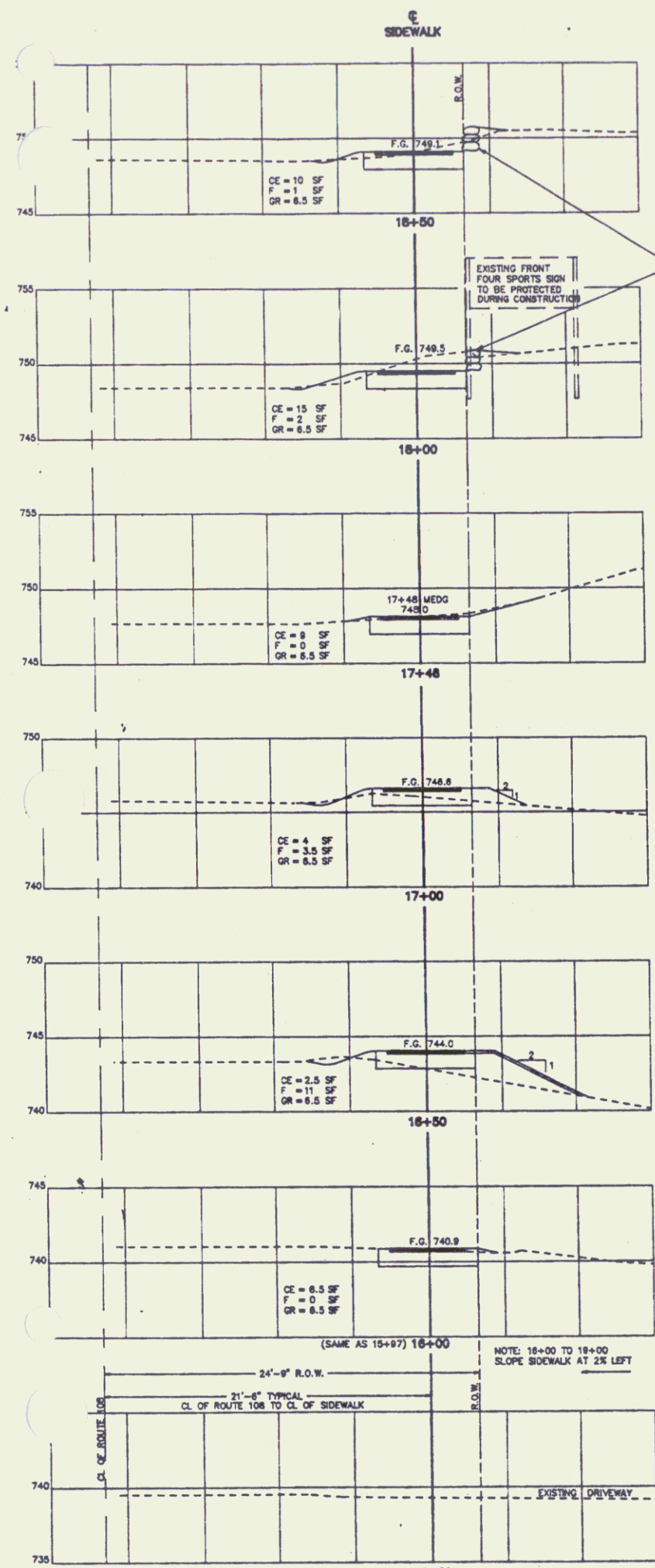

THE CONTRACTOR SHALL EXCAVATE A BENCH ALONG THE EDGE OF THE RIGHT OF WAY TO ALLOW OWNERS OF FRONT FOUR SPORTS TO CONSTRUCT A SMALL STONE RETAINING WALL. THE OWNERS AGREE TO COORDINATE CONSTRUCTION OF THE WALL WITH THE SIDEWALK CONSTRUCTION SCHEDULE. THE CONTRACTOR SHALL REED AND MOUND ALL DISTURBED GROUND AFTER THE WALL IS FINISHED.

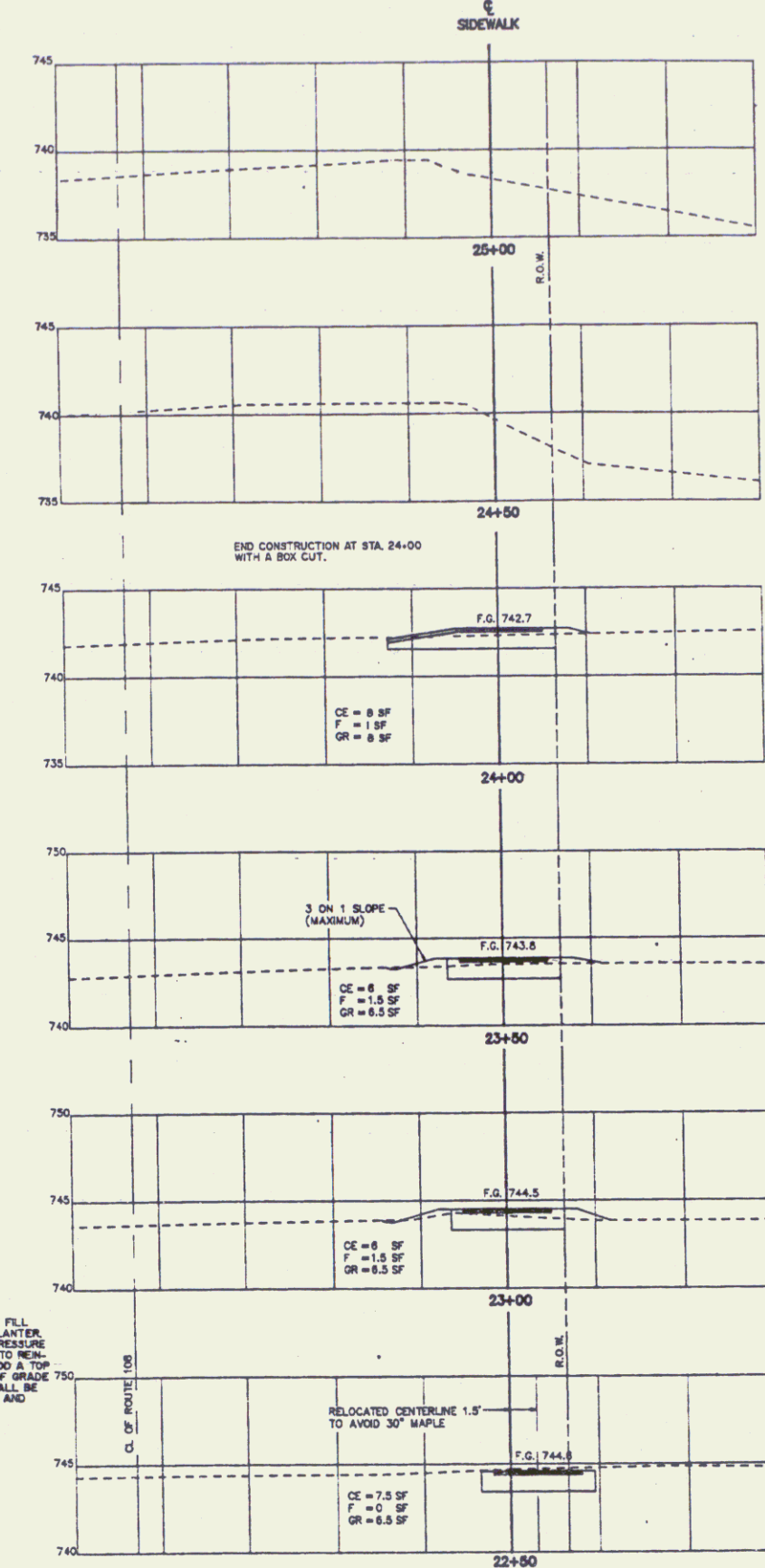
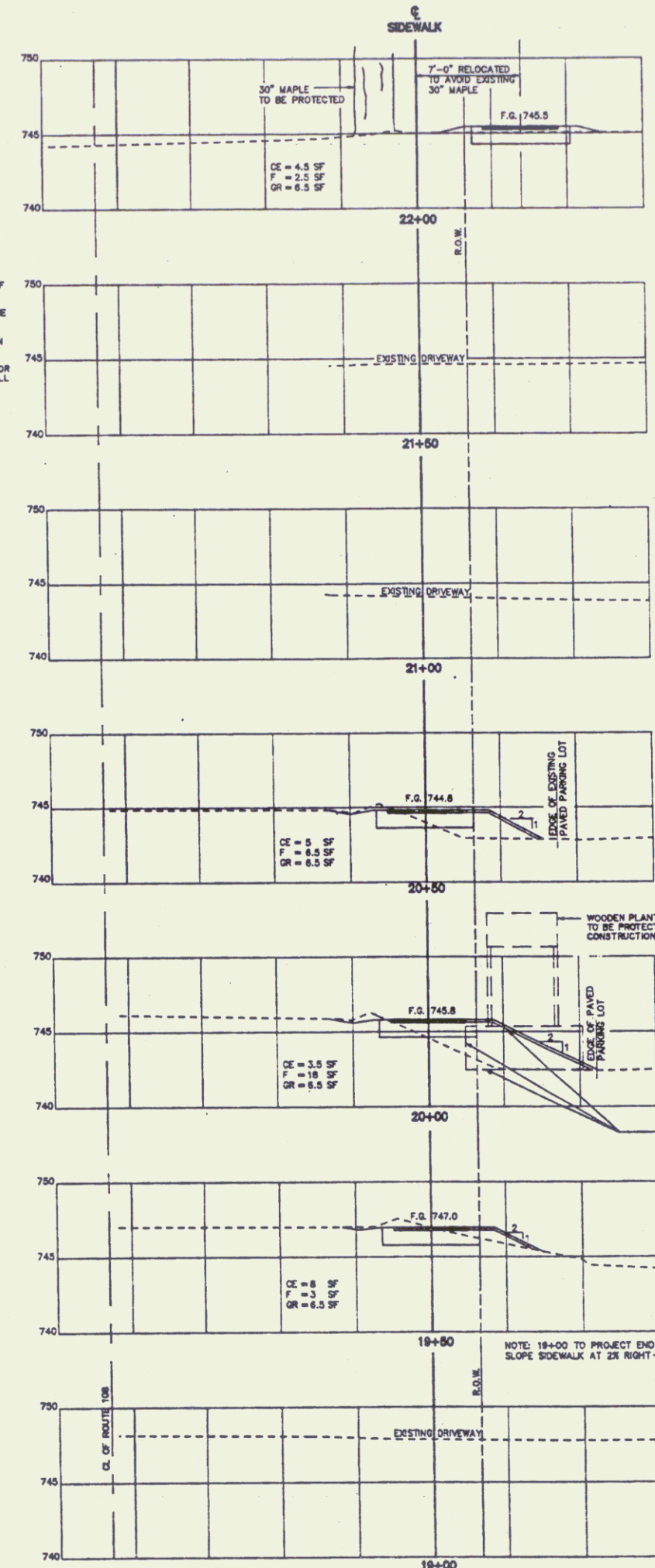

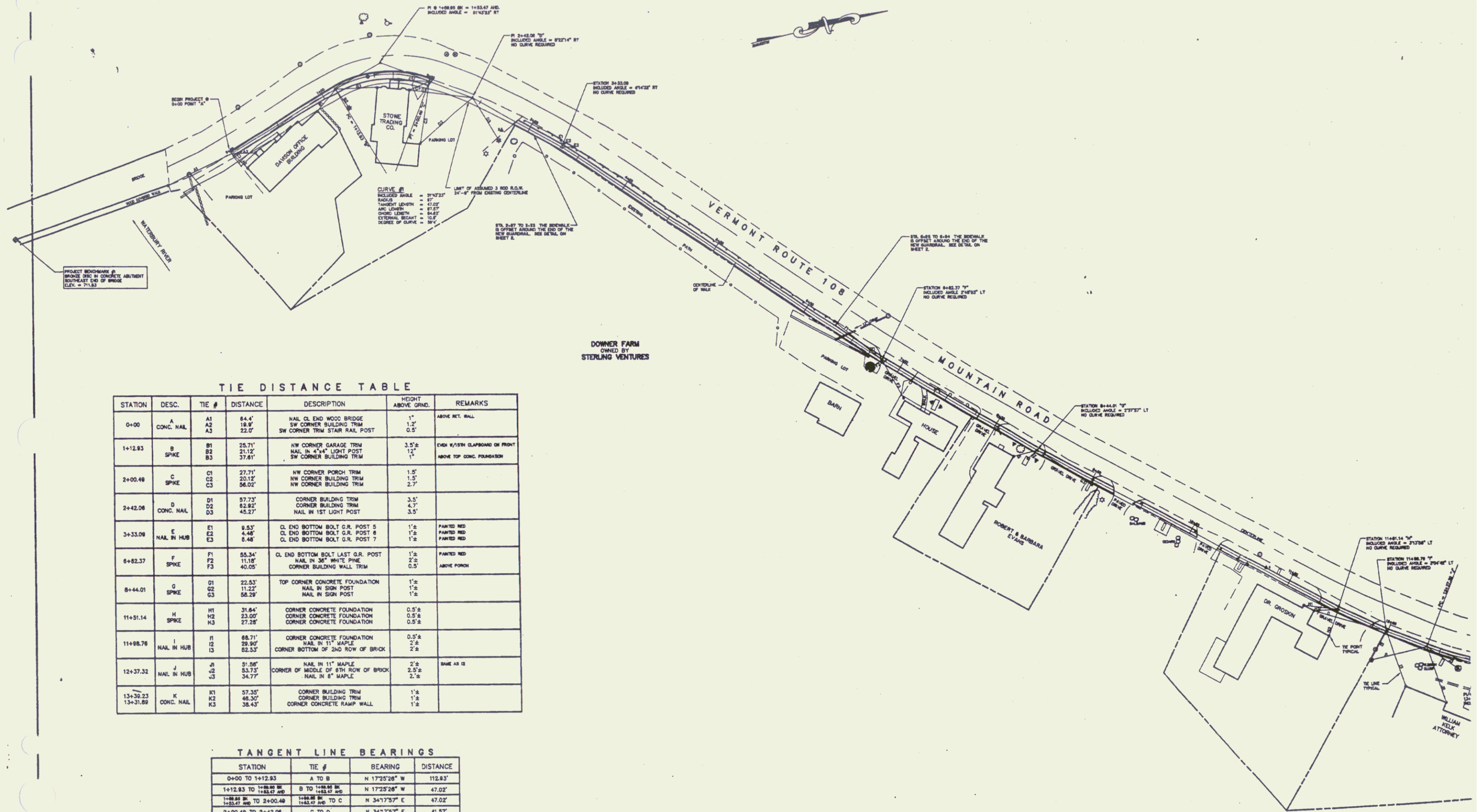

TIE DISTANCE TABLE

STATION	DESC.	TIE #	DISTANCE	DESCRIPTION	HEIGHT ABOVE GRND.	REMARKS
0+00	A CONC. NAIL	A1 A2 A3	84.4' 18.8' 22.0'	NAIL CL. END WOOD BRIDGE SW CORNER BUILDING TRIM SW CORNER TRIM STAIR RAIL POST	1' 1.2' 0.5'	ABOVE RET. WALL
1+12.83	B SPIKE	B1 B2 B3	25.71' 21.12' 37.81'	NW CORNER GARAGE TRIM NAIL IN 4"x4" LIGHT POST SW CORNER BUILDING TRIM	3.5' 1.3' 1'	EDGE W/ TRIM CLAPBOARD ON FRONT ABOVE TOP CONC. FOUNDATION
2+00.48	C SPIKE	C1 C2 C3	27.71' 22.12' 56.02'	NW CORNER PORCH TRIM NW CORNER BUILDING TRIM NW CORNER BUILDING TRIM	1.5' 1.5' 2.7'	
2+42.06	D CONC. NAIL	D1 D2 D3	57.73' 52.92' 45.27'	CORNER BUILDING TRIM CORNER BUILDING TRIM NAIL IN 1ST LIGHT POST	3.5' 4.7' 3.5'	
3+33.09	E NAIL IN HUB	E1 E2 E3	8.53' 4.46' 8.48'	CL. END BOTTOM BOLT G.R. POST 5 CL. END BOTTOM BOLT G.R. POST 6 CL. END BOTTOM BOLT G.R. POST 7	1.5' 1.5' 1.5'	PAINTED RED PAINTED RED PAINTED RED
6+82.37	F SPIKE	F1 F2 F3	55.34' 11.18' 40.05'	CL. END BOTTOM BOLT LAST G.R. POST NAIL IN 30" WHITE PINE CORNER BUILDING WALL TRIM	1.5' 2.2' 0.5'	PAINTED RED ABOVE PORCH
8+44.01	G SPIKE	G1 G2 G3	22.53' 11.22' 56.28'	TOP CORNER CONCRETE FOUNDATION NAIL IN SIGN POST NAIL IN SIGN POST	1.5' 1.5' 1.5'	
11+51.14	H SPIKE	H1 H2 H3	31.84' 23.00' 27.28'	CORNER CONCRETE FOUNDATION CORNER CONCRETE FOUNDATION CORNER CONCRETE FOUNDATION	0.5' 0.5' 0.5'	
11+88.78	I NAIL IN HUB	I1 I2 I3	88.71' 29.90' 52.53'	CORNER CONCRETE FOUNDATION NAIL IN 11" MAPLE CORNER BOTTOM OF 2ND ROW OF BRICK	0.5' 2.5' 2.5'	
12+37.32	J NAIL IN HUB	J1 J2 J3	51.56' 53.73' 34.77'	NAIL IN 11" MAPLE CORNER OF MIDDLE OF 8TH ROW OF BRICK NAIL IN 8" MAPLE	2.5' 2.5' 2.5'	BASE AS IS
13+32.23 13+31.89	K CONC. NAIL	K1 K2 K3	57.35' 48.30' 38.43'	CORNER BUILDING TRIM CORNER BUILDING TRIM CORNER CONCRETE RAMP WALL	1.5' 1.5' 1.5'	

TANGENT LINE BEARINGS

STATION	TIE #	BEARING	DISTANCE
0+00 TO 1+12.83	A TO B	N 17°25'28" W	112.83'
1+12.83 TO 1+88.89	B TO 1+88.89	N 17°25'28" W	47.02'
1+88.89 TO 2+00.48	1+88.89 TO C	N 34°17'57" E	47.02'
2+00.48 TO 2+42.06	C TO D	N 34°17'57" E	41.57'
2+42.06 TO 3+33.09	D TO E	N 42°40'11" E	91.03'
3+33.09 TO 6+82.37	E TO F	N 48°54'43" E	348.28'
6+82.37 TO 8+44.01	F TO G	N 44°08'40" E	181.84'
8+44.01 TO 11+51.14	G TO H	N 41°28'43" E	307.13'
11+51.14 TO 11+88.78	H TO I	N 38°14'48" E	47.82'
11+88.78 TO 12+37.32	I TO J	N 35°10'08" E	38.57'
12+37.32 TO 13+32.23	J TO K	N 35°10'08" E	100.81'

SITE PLAN

GRAPHIC SCALE



AUG 9 1994

SHEET 9



"TIE DETAIL SHEET 0+00 TO 13+00"  
STOWE MOUNTAIN ROAD WALK





- NOTES**
1. ONLY LIGHTWEIGHT MAILBOXES MADE OF LIGHT SHEET METAL OR PLASTIC SHALL BE USED. MAILBOXES SHALL MEET REQUIREMENTS AND APPROVAL OF THE U.S. POSTAL SERVICE.
  2. AN ALUMINUM MAILBOX SUPPORT STRUCTURE DESIGN AND CONSTRUCTION MAY BE USED AS LONG AS PROVEN CRASHWORTHY AND STRENGTH GUIDELINES AS SET OUT IN AASHTO'S "GUIDE FOR DESIGNING MAILBOXES ON HIGHWAYS". SUPPORT STRUCTURE SHALL ALSO MEET REQUIREMENTS OF THE U.S. POSTAL SERVICE.
  3. MAILBOX TURNOUT SHALL MEET B-17 STANDARD AS SET OUT IN "STATE OF VERMONT AGENCY OF TRANSPORTATION DESIGN STANDARDS FOR ROAD "EDGE CONSTRUCTION".
  4. IF ROAD TURNOUT OFFSET CANNOT BE ATTAINED DUE TO CONSTRAINTS OR OTHER REASONS THE TURNOUT SHALL BE AS DIRECTED BY THE ENGINEER.

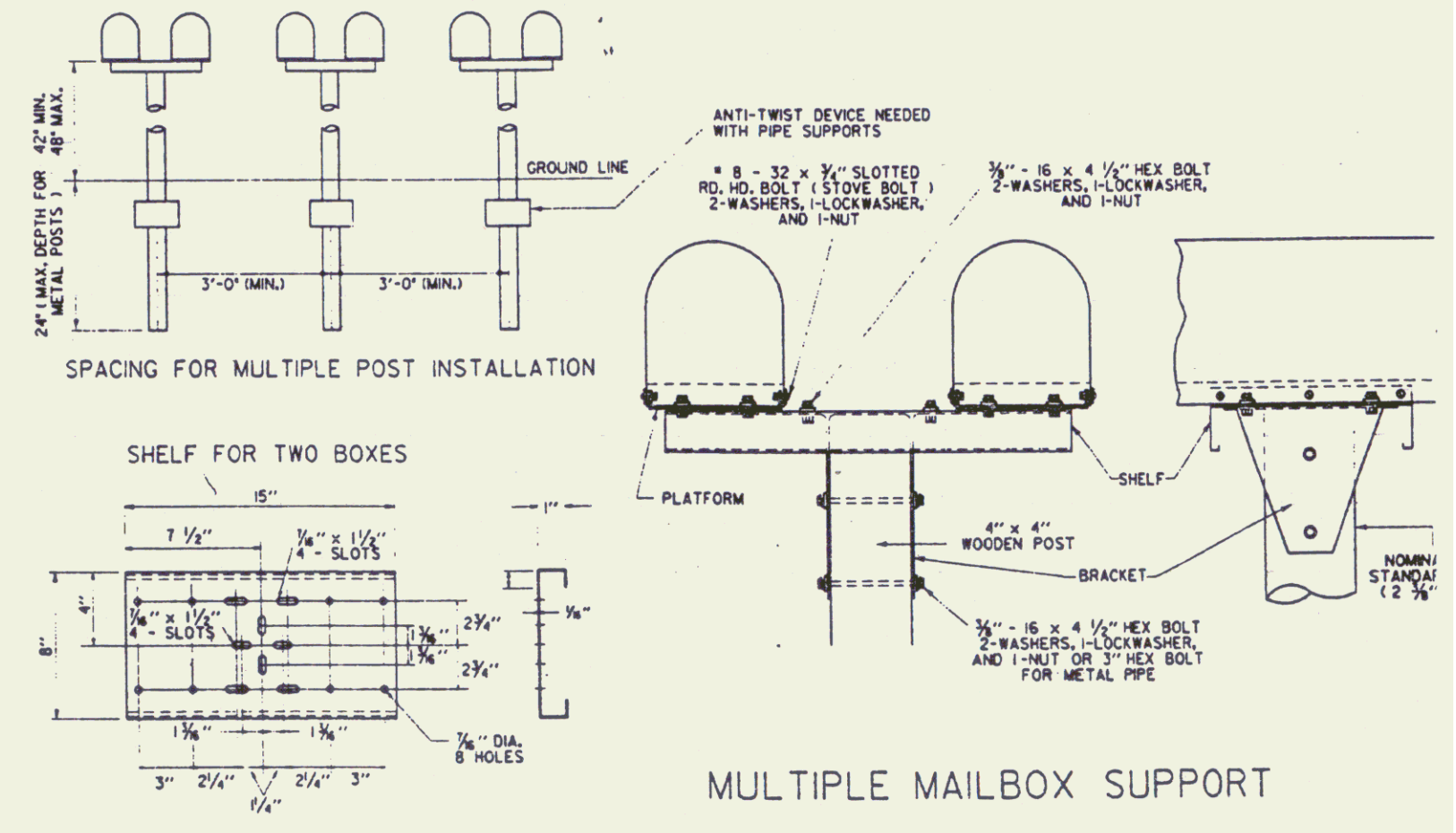
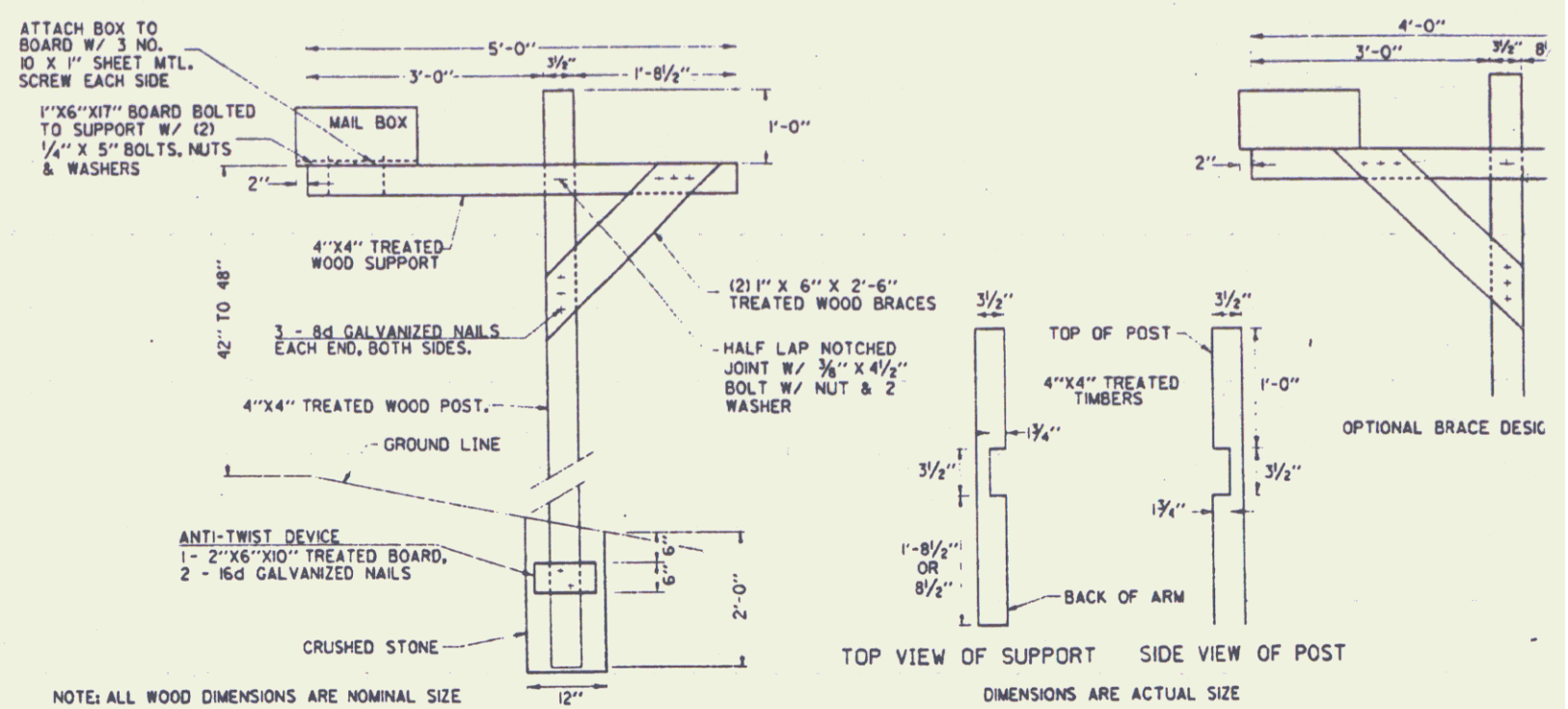
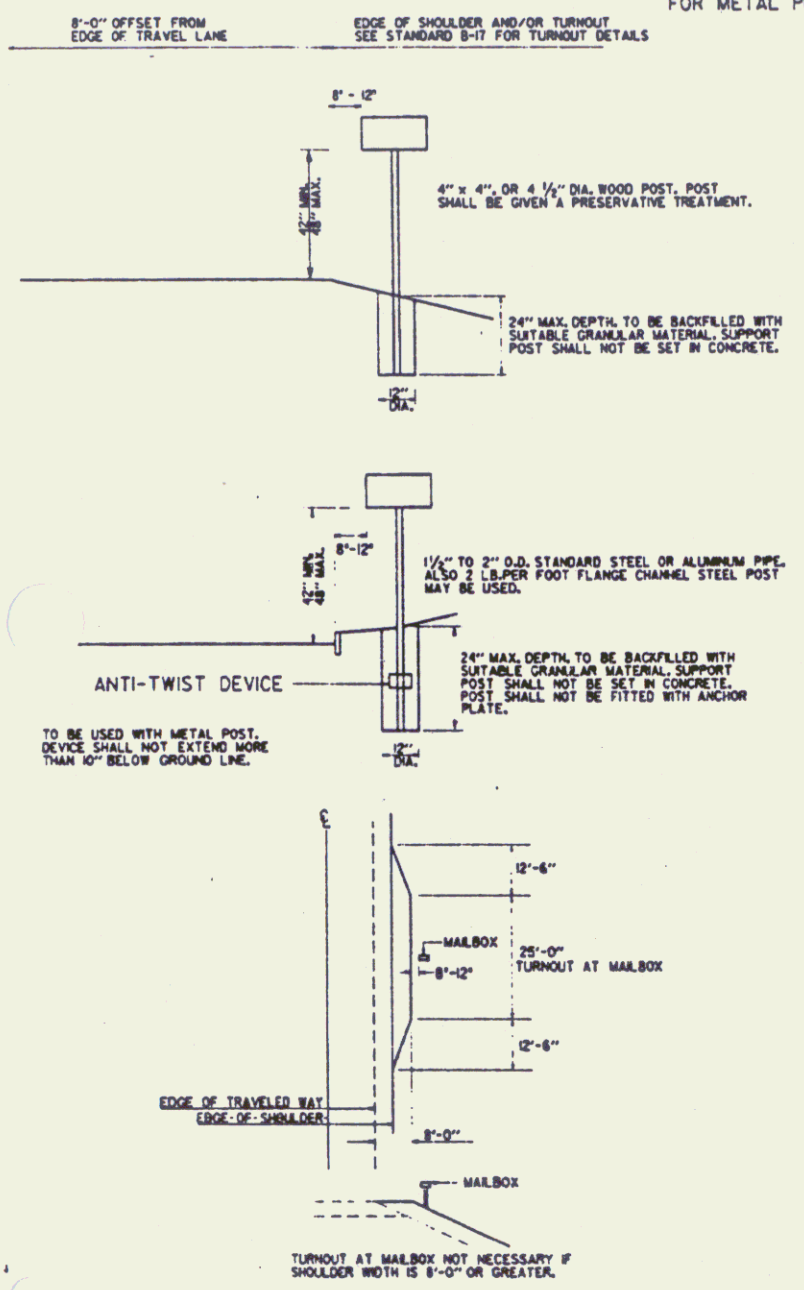
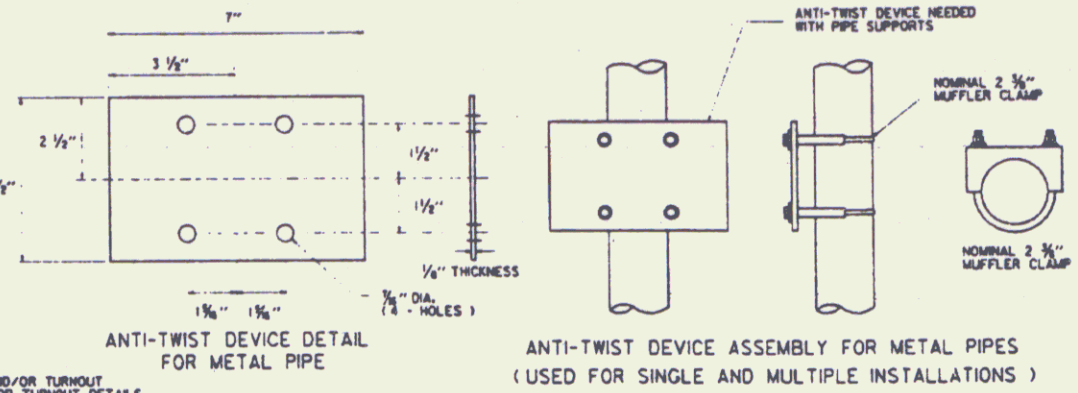

# MAILBOX SUPPORT HARDWARE

( SINGLE AND MULTIPLE SUPPORT )

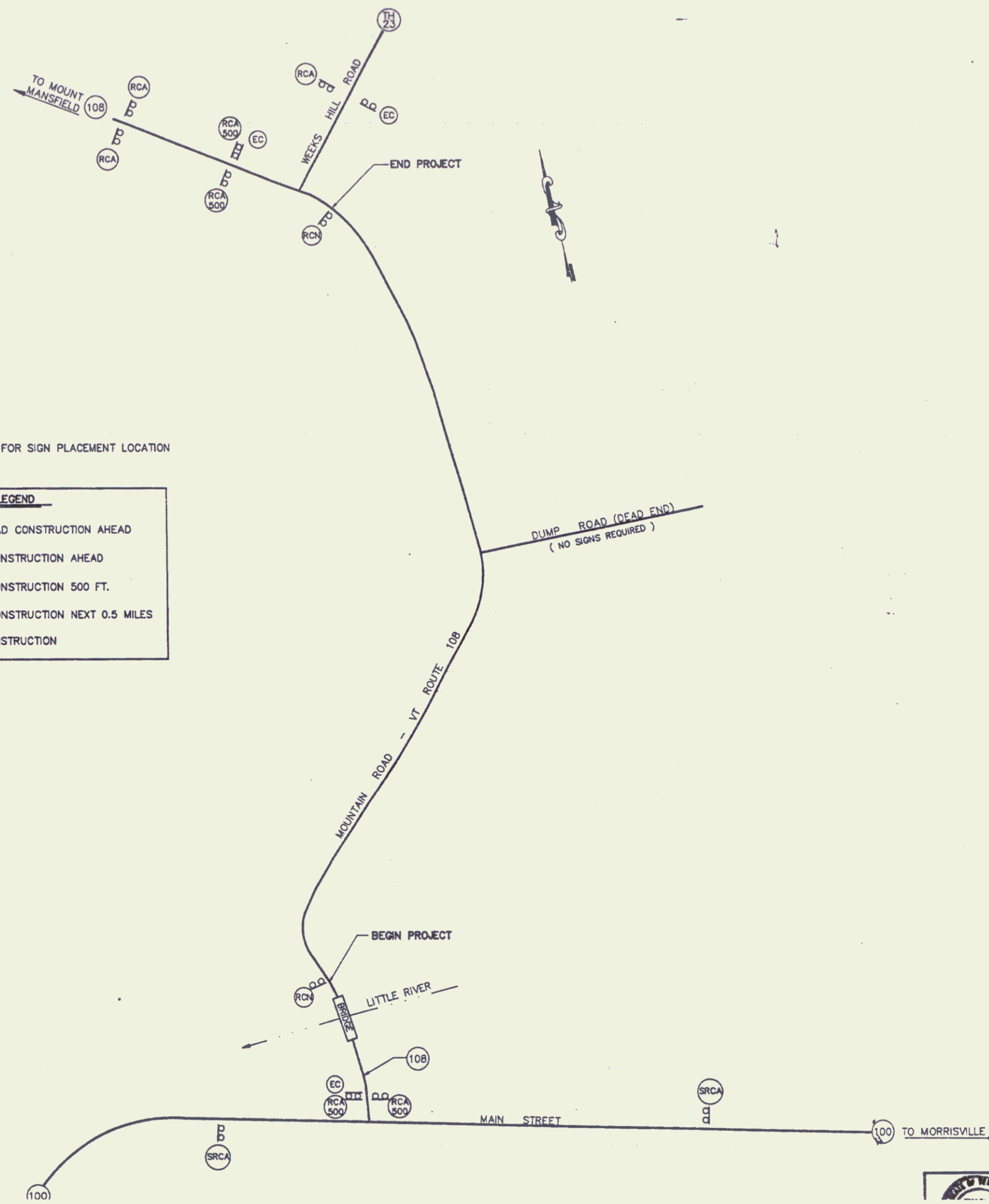

NOTE: SEE STD. E-100 FOR SIGN PLACEMENT LOCATION

LEGEND	
(SRCA)	= SIDE ROAD CONSTRUCTION AHEAD
(RCA)	= ROAD CONSTRUCTION AHEAD
(RCA 500)	= ROAD CONSTRUCTION 500 FT.
(RCA 0.5)	= ROAD CONSTRUCTION NEXT 0.5 MILES
(EC)	= END CONSTRUCTION

AUG 9 1994

SHEET 13

CONSTRUCTION APPROACH SIGNING  
STOWE MOUNTAIN ROAD WAI K 15

JUN 30 1992  
PROJECT  
BW-RS-BIKE