

MATCHLINE SHEET 2 SHEET 3

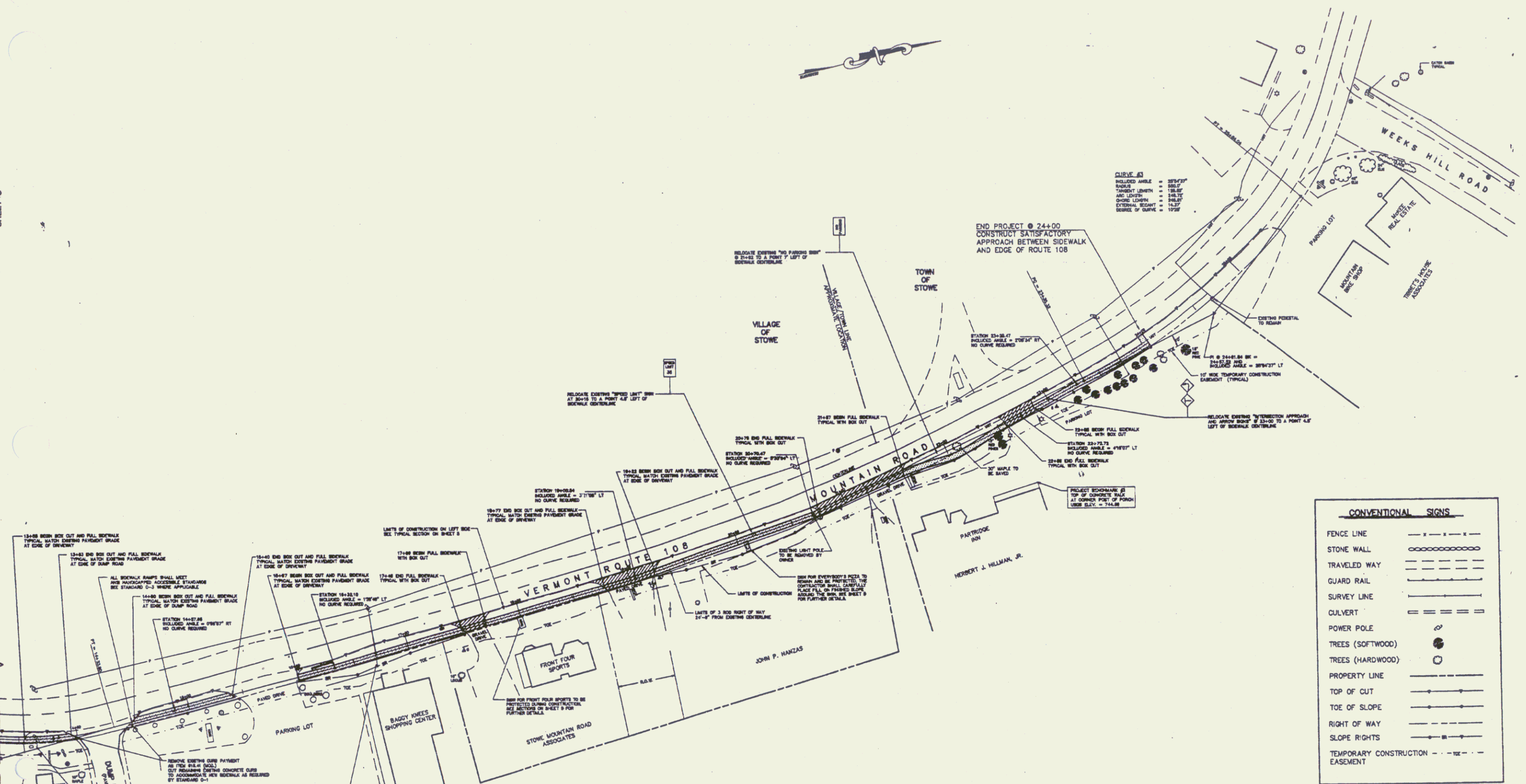

CURVE A3
 ROLLOVER ANGLE = 25.5/27°
 RADIUS = 100.0'
 TANGENT LENGTH = 18.85'
 CHORD LENGTH = 18.85'
 EXTERNAL ANGLE = 14.25°
 BEARING OF CURVE = 192°

CONVENTIONAL SIGNS	
FENCE LINE	— — — — —
STONE WALL	— — — — —
TRAVELED WAY	— — — — —
GUARD RAIL	— — — — —
SURVEY LINE	— — — — —
CULVERT	— — — — —
POWER POLE	— — — — —
TREES (SOFTWOOD)	●
TREES (HARDWOOD)	○
PROPERTY LINE	— — — — —
TOP OF CUT	— — — — —
TOE OF SLOPE	— — — — —
RIGHT OF WAY	— — — — —
SLOPE RIGHTS	— — — — —
TEMPORARY CONSTRUCTION EASEMENT	— — — — —

IMPORTANT NOTE:
 THE 10' WIDE TEMPORARY CONSTRUCTION EASEMENT DOES NOT GIVE THE CONTRACTOR THE RIGHT TO DAMAGE TREES, BUILDINGS, SIGNS, WALKS, ETC. THE CONTRACTOR SHALL BE RESPONSIBLE FOR ANY DAMAGES CAUSED IN THE COURSE OF CONSTRUCTION AND IS REQUIRED TO RESTORE THE PREMISES AS NEAR AS POSSIBLE TO THE CONDITION THEY WERE IN PRIOR TO CONSTRUCTION.

STATION 13+00.00
 ROLLOVER ANGLE = 27.75° LT
 RADIUS = 100.0'
 TANGENT LENGTH = 18.85'
 CHORD LENGTH = 18.85'
 EXTERNAL ANGLE = 14.25°
 BEARING OF CURVE = 192°

AUG 9 1994

JUN 30 1994

SITE PLAN



"SITE PLAN 13+00 TO 25+50"
 STOWE MOUNTAIN ROAD WALK

SHEET 3

PROJECT BW-RS-BKE

4