

SHEET 4 OF 6 SHEETS

MATCH LINE TO

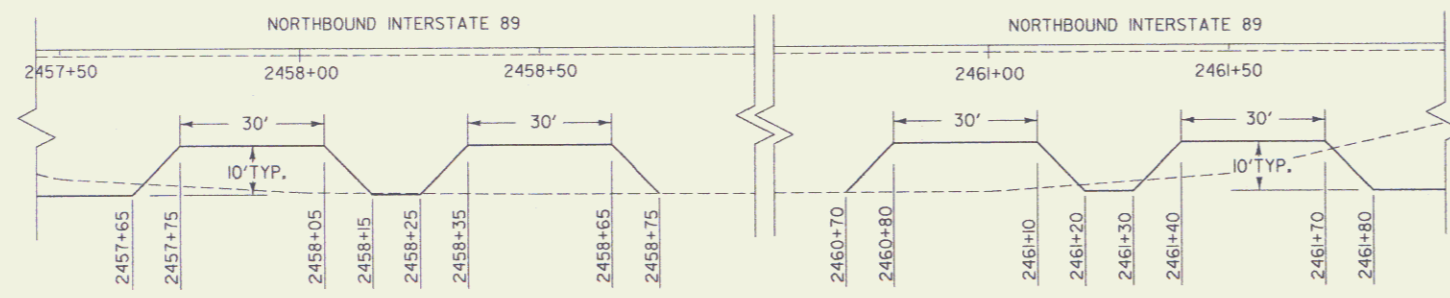

TRANSPLANTING TREES (APPLE)
 STA. 2457+26 RT. TO 2457+16 RT. (24.5' RT.)
 STA. 2457+73 RT. TO 2457+63 RT. (24.6' RT.)
 STA. 2458+11 RT. TO 2458+78 RT. (24.5' RT.)
 STA. 2458+87 RT. TO 2459+25 RT. (24.5' RT.)
 STA. 2459+27 RT. TO 2459+73 RT. (24.5' RT.)
 STA. 2460+40 RT. TO 2460+21 RT. (24.5' RT.)
 STA. 2460+90 RT. TO 2460+68 RT. (24.5' RT.)

EXCAVATION OF SURFACES AND PAVEMENTS
 STA. 2457+00 - 2463+00 RT.
 *NOTE: TO INCLUDE A PAVEMENT SAW CUT 2 FT OUTSIDE THE NEW GRANITE SLOPE EDGING / EXISTING SLOPE EDGING & 2 FT INSIDE THE OUTER EDGE OF PAVEMENT

REMOVING AND RESETTING CURB
 STA. 2457+00 - 2462+27
 *NOTE: ALL EXISTING GRANITE SLOPE EDGING IS TO BE REMOVED & RESET

GRANITE SLOPE EDGING
 STA. 2462+27 - 2463+00
 *NOTE: DONE IN CONJUNCTION WITH REMOVING AND RESETTING CURB
 STA. 2460+50 - 2462+00
 *NOTE: CENTRAL ISLAND CONSTRUCTION

HIGHBUSH CRANBERRY
 STA. 2457+00-2462+75 (12' RT. @ 5' o.c.)

STA. 2462+00 EXISTING 12" COMP. EXTEND WITH 18" 1.5" BT. CONC. STONE FILL TYPE 1 AT OUTLET

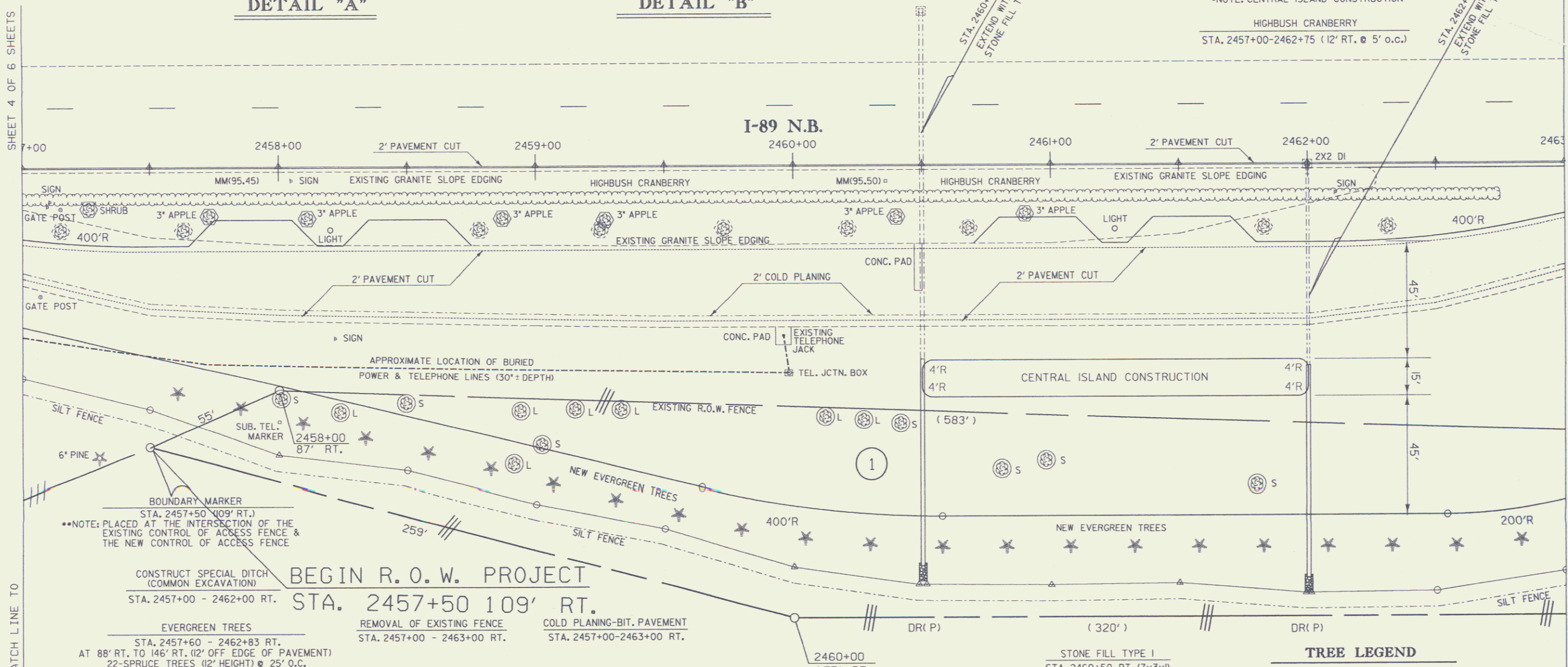

BEGIN R.O.W. PROJECT
 STA. 2457+00 109' RT.
 EVERGREEN TREES STA. 2457+60 - 2462+83 RT. AT 88' RT. TO 146' RT. (2' OFF EDGE OF PAVEMENT) 22-SPRUCE TREES (12' HEIGHT) @ 25' O.C.
 REMOVAL OF EXISTING FENCE STA. 2457+00 - 2463+00 RT.
 COLD PLANING-BIT. PAVEMENT STA. 2457+00-2463+00 RT.

STATION OFFSET DATA FOR ISLAND SEPARATING I-89 & WEIGH STATION

STATION	OFFSET	STATION	OFFSET
2457+00	1.50' / 27.50' RT.	2460+25	1.50' / 30.50' RT.
2457+25	1.50' / 29.84' RT.	2460+50	1.50' / 30.50' RT.
2457+50	1.50' / 30.50' RT.	2460+75	SEE DETAIL 'B'
2457+75	SEE DETAIL 'A'	2461+00	SEE DETAIL 'B'
2458+00	SEE DETAIL 'A'	2461+25	SEE DETAIL 'B'
2458+25	SEE DETAIL 'A'	2461+50	SEE DETAIL 'B'
2458+50	SEE DETAIL 'A'	2461+75	SEE DETAIL 'B'
2458+75	SEE DETAIL 'A'	2462+00	1.50' / 30.50' RT.
2459+00	1.50' / 30.50' RT.	2462+25	1.50' / 30.09' RT.
2459+25	1.50' / 30.50' RT.	2462+50	1.50' / 28.17' RT.
2459+50	1.50' / 30.50' RT.	2462+75	1.50' / 24.66' RT.
2459+75	1.50' / 30.50' RT.	2463+00	1.50' / 19.57' RT.
2460+00	1.50' / 30.50' RT.		

STATION OFFSET DATA FOR OUTSIDE EDGE OF PAVEMENT

STATION	OFFSET	STATION	OFFSET
2457+00	61.18' RT.	2460+25	134.18' RT.
2457+25	61.17' RT.	2460+50	135.43' RT.
2457+50	73.16' RT. (PT) 2460+57.52	2460+75	135.50' RT.
2457+75	79.14' RT.	2461+00	135.50' RT.
2458+00	85.13' RT.	2461+25	135.50' RT.
2458+25	91.12' RT.	2461+50	135.50' RT.
2458+50	97.11' RT.	2461+75	135.50' RT.
2458+75	103.10' RT.	2462+00	135.50' RT.
2459+00	109.09' RT.	2462+25	135.50' RT.
2459+25	115.07' RT.	2462+50	135.50' RT.
2459+50	121.06' RT.	2462+75	135.50' RT.
(PC) 2459+64.35	124.50' RT.	(PC) 2462+54.34	135.50' RT.
2459+75	126.90' RT.	2463+00	126.42' RT.
2460+00	131.34' RT.		

STONE FILL TYPE 1
 STA. 2460+50 RT. (7x3x1)
 STA. 2462+00 RT. (7x3x1)

GEOTEXTILE FABRIC FOR SILT FENCE
 STA. 2457+00 - 2463+00 RT.
 REMOVING TREES (LARGE & SMALL)
 STA. 2458+00 - 2461+80 (90' TO 125' RT.)
 7-LARGE TREES / 7-SMALL TREES
 *NOTE: APPROXIMATE LOCATIONS - TREES DEFINED ARE THOSE LOCATED OUTSIDE THE EXISTING R.O.W. FENCE NOT INCLUDED IN THE SURVEY

TREE LEGEND

- ⊙ S REMOVING SMALL TREES
- ⊙ L REMOVING LARGE TREES
- ✱ NEW EVERGREEN TREES
- ⊙ TRANSPLANTING TREES FROM
- ⊙ TRANSPLANTING TREES TO

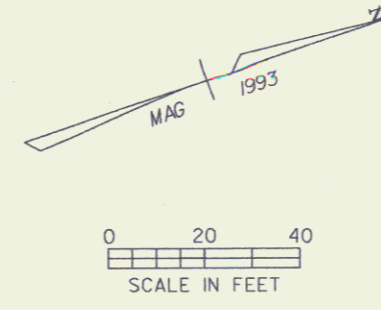

FEB 21 2001

THOMAS, ROBERT L & VERNA E.

SURVEYED BY R. MOREAU DATE 1/93
 DRAWN BY K. UPMAL DATE 1/94
 SQUAD LEADER S. MENARD
 DESIGN FILE NO. DGN&SPECIFICATION*****
 IPARM FILE /pr/09/0220/r-a2202r.PLOTTED *****
COLCHESTER
 IR 089-3(17)
 R. O. W. SHEET 4 OF 6 SHEETS

MATCH LINE TO

SHEET 6 OF 6 SHEETS

4