

STATE OF VERMONT
AGENCY OF TRANSPORTATION



PROPOSED IMPROVEMENT
TOWN OF COLCHESTER

COUNTY OF CHITTENDEN

INTERSTATE 89 (INTERSTATE PRINCIPAL ARTERIAL)

BEGINNING AT A POINT 4.49 MILES NORTH OF THE WINOOSKI/COLCHESTER TOWN LINE AND EXTENDING NORTHERLY FOR 0.229 MILES

LENGTH OF PROJECT = 1210.80 FEET = 0.229 MILE
LENGTH OF R.O.W. PROJECT = 710 FEET = 0.134 MILES
WORK TO BE DONE UNDER THIS PROJECT INCLUDES EXPANSION OF THE EXISTING NORTHBOUND WEIGH STATION REQUIRING ADDITIONAL SUBBASE, PAVEMENT, CURBING AND DRAINAGE IN ADDITION TO A NEW OVERLAY OF PAVEMENT ON THE EXISTING FACILITY INCLUDING CENTRALIZED CURBING, POWER, AND LIGHTING

Revised 11-15-01 AFA

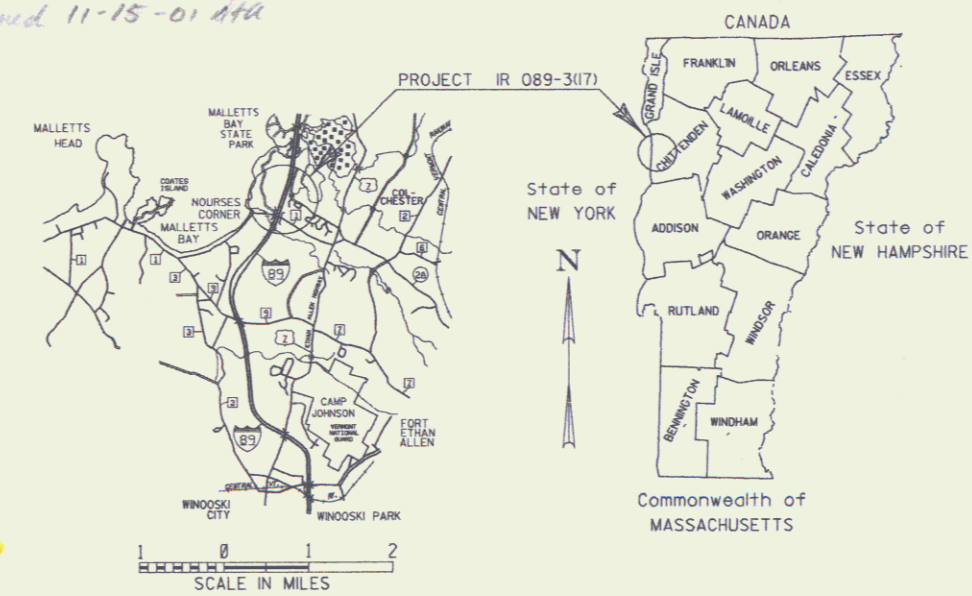

R.O.W. PLANS

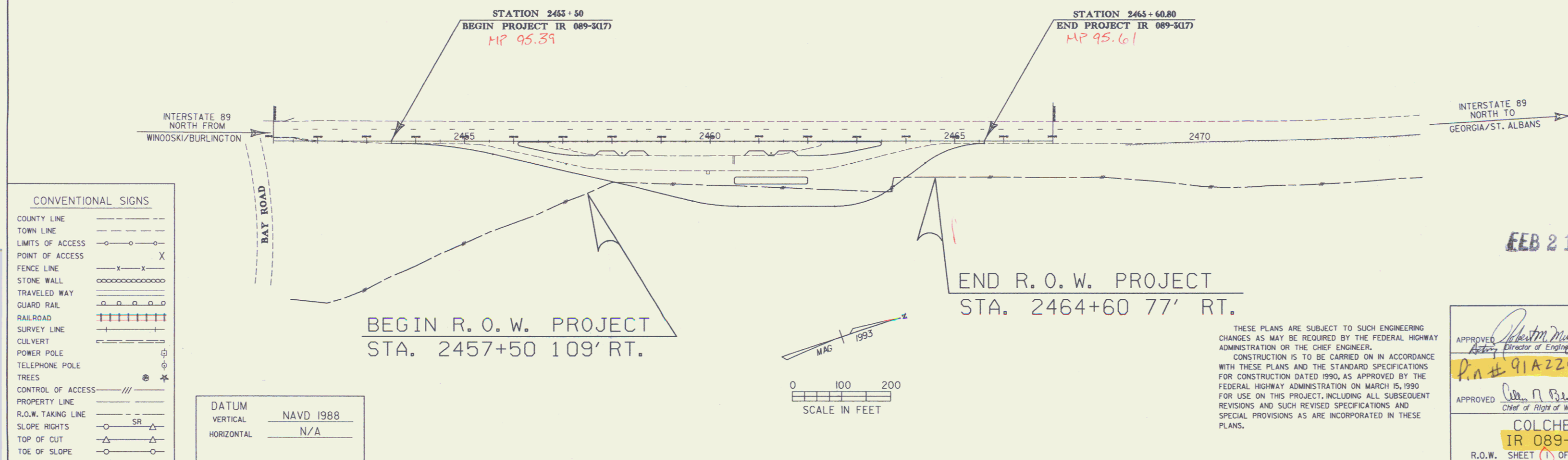

THESE PLANS ARE SUBJECT TO SUCH ENGINEERING CHANGES AS MAY BE REQUIRED BY THE FEDERAL HIGHWAY ADMINISTRATION OR THE CHIEF ENGINEER. CONSTRUCTION IS TO BE CARRIED ON IN ACCORDANCE WITH THESE PLANS AND THE STANDARD SPECIFICATIONS FOR CONSTRUCTION DATED 1990, AS APPROVED BY THE FEDERAL HIGHWAY ADMINISTRATION ON MARCH 15, 1990 FOR USE ON THIS PROJECT, INCLUDING ALL SUBSEQUENT REVISIONS AND SUCH REVISED SPECIFICATIONS AND SPECIAL PROVISIONS AS ARE INCORPORATED IN THESE PLANS.