

Original Drawing - Ink on polymer meeting the requirements of 27 V.S.A. § 1403

INDEX OF R.O.W. SHEETS

1	TITLE SHEET
2-3	TYPICAL SECTIONS
4-8	PROFILES
9-10	DRIVE TYPICALS/PROFILES
11	PLAN AND ELEVATION
12	BOX PLAN AND ELEVATION
13-14	TIE SHEETS
15-18	ALIGNMENT
19-20	R.O.W. DETAIL SHEETS
21-24	R.O.W. LAYOUT SHEETS

**R.O.W. PLANS**

STATE OF VERMONT  
AGENCY OF TRANSPORTATION



PROPOSED IMPROVEMENT  
BRIDGE PROJECT  
TOWN OF RICHMOND  
COUNTY OF CHITTENDEN  
US RTE. 2  
MAJOR COLLECTOR  
BRIDGE NO. 24

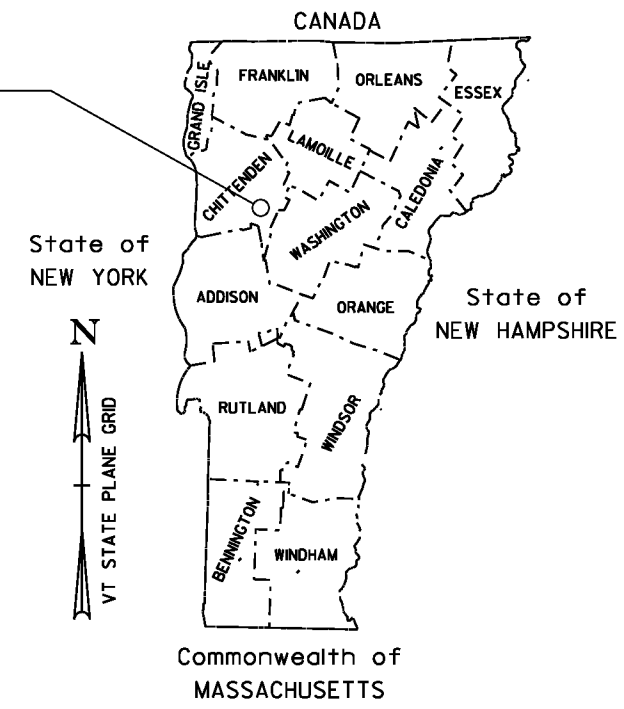
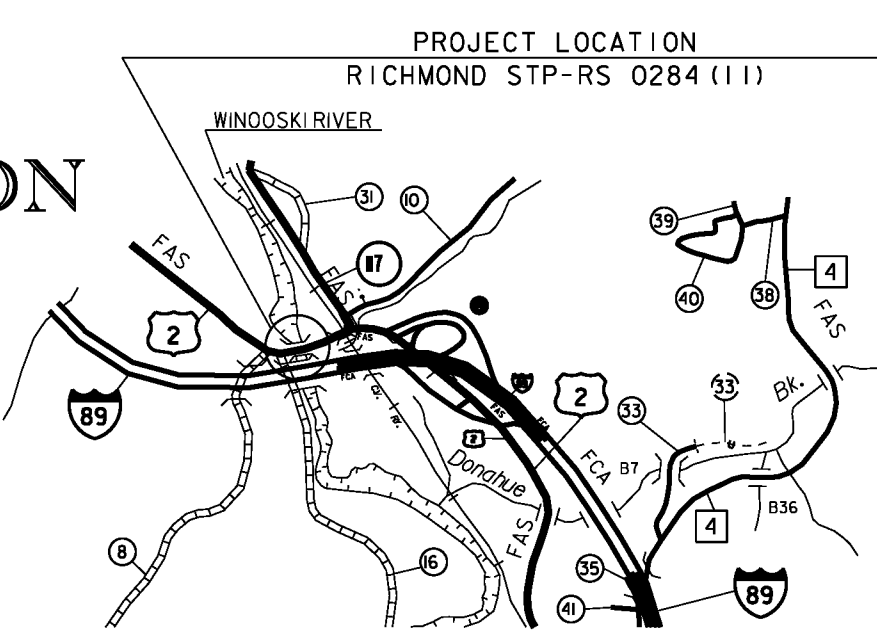

PROJECT LOCATION : BEGINNING ON US RTE. 2 APPROXIMATELY 0.568 MILES EASTERLY OF THE WILLISTON/RICHMOND TOWN LINE AND EXTENDING EASTERLY 0.246 MILES (1300 FT).

PROJECT DESCRIPTION : PROJECT CONSISTS OF REHABILITATING AND WIDENING EXISTING TRUSS BRIDGE #24 OVER THE WINDOOSKI RIVER, PLACEMENT OF A NEW PRECAST CONCRETE BOX WITH RELATED ROADWAY WORK.

LENGTH OF STRUCTURE : 356.00 FEET  
 LENGTH OF ROADWAY : 944.00 FEET  
 LENGTH OF PROJECT : 1300.00 FEET  
 LENGTH OF R.O.W. PROJECT : 1663 FEET

LINES SHOWN ON THIS PLAN AS EXISTING PROPERTY LINES P/L ARE BELIEVED TO BE ACCURATE BUT SHOULD NOT BE RELIED UPON FOR PURPOSES UNRELATED TO THE STATE OF VERMONT'S ACQUISITION OF LAND AND RIGHTS FOR THIS PROJECT.

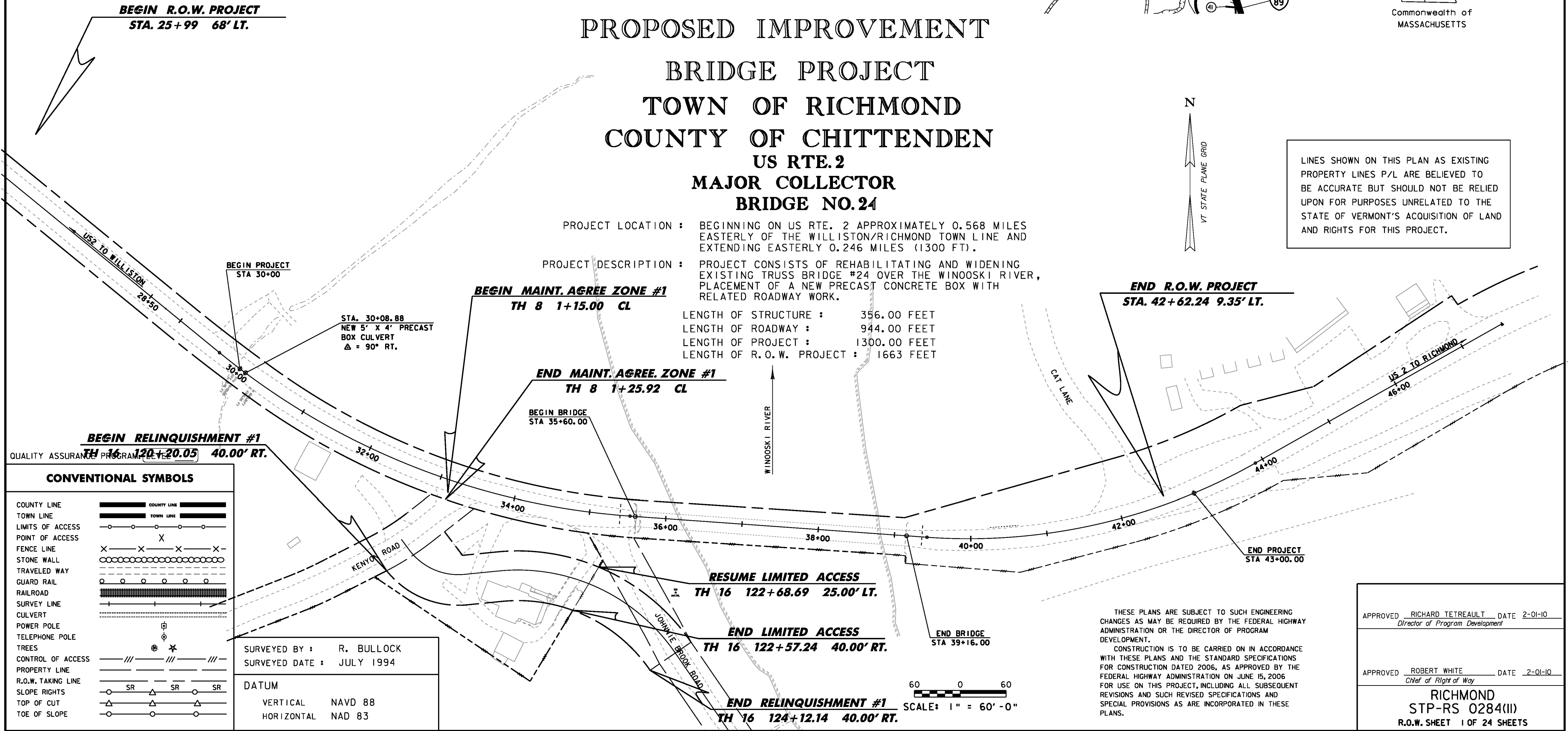

QUALITY ASSURANCE PROGRAM

**CONVENTIONAL SYMBOLS**

COUNTY LINE	
TOWN LINE	
LIMITS OF ACCESS	
POINT OF ACCESS	
FENCE LINE	
STONE WALL	
TRAVELED WAY	
GUARD RAIL	
RAILROAD	
SURVEY LINE	
CULVERT	
POWER POLE	
TELEPHONE POLE	
TREES	
CONTROL OF ACCESS	
PROPERTY LINE	
R.O.W. TAKING LINE	
SLOPE RIGHTS	
TOP OF CUT	
TOE OF SLOPE	

SURVEYED BY : R. BULLOCK  
 SURVEYED DATE : JULY 1994

DATUM  
 VERTICAL NAVD 88  
 HORIZONTAL NAD 83

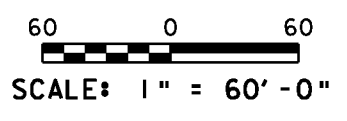

THESE PLANS ARE SUBJECT TO SUCH ENGINEERING CHANGES AS MAY BE REQUIRED BY THE FEDERAL HIGHWAY ADMINISTRATION OR THE DIRECTOR OF PROGRAM DEVELOPMENT.

CONSTRUCTION IS TO BE CARRIED ON IN ACCORDANCE WITH THESE PLANS AND THE STANDARD SPECIFICATIONS FOR CONSTRUCTION DATED 2006, AS APPROVED BY THE FEDERAL HIGHWAY ADMINISTRATION ON JUNE 15, 2006 FOR USE ON THIS PROJECT, INCLUDING ALL SUBSEQUENT REVISIONS AND SUCH REVISED SPECIFICATIONS AND SPECIAL PROVISIONS AS ARE INCORPORATED IN THESE PLANS.

APPROVED RICHARD TETREAU DATE 2-01-10  
*Director of Program Development*

APPROVED ROBERT WHITE DATE 2-01-10  
*Chief of Right of Way*

**RICHMOND**  
**STP-RS 0284(II)**  
 R.O.W. SHEET 1 OF 24 SHEETS