

Research Drawer Set

STATE OF VERMONT
AGENCY OF TRANSPORTATION



PROPOSED IMPROVEMENT
TOWN OF WORCESTER
COUNTY OF WASHINGTON
VT. ROUTE 12 (FAS MAJOR COLLECTOR)

R.O.W. PLANS

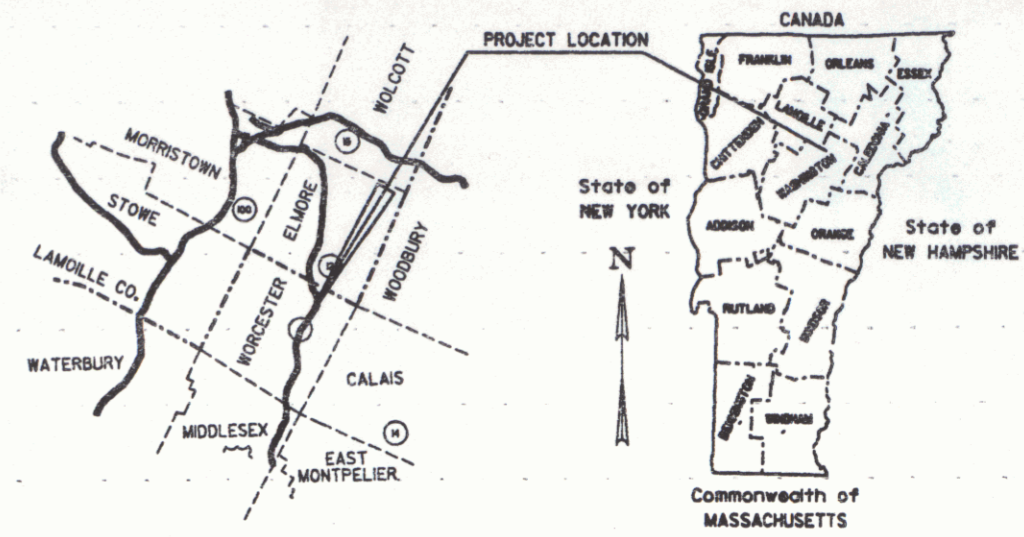

BEGINNING AT A POINT 3.489 MILES NORTH OF THE MIDDLESEX-WORCESTER TOWN LINE AND EXTENDING NORTHERLY 0.038 MILES TO MILEMARKER 3.527
WORK UNDER THIS PROJECT INCLUDES THE REPLACEMENT OF BRIDGE NO. 83 OVER THE HANCOCK BROOK AND NECESSARY APPROACH WORK GENERALLY ALONG EXISTING ALIGNMENT

LENGTH OF ROADWAY = 169 FEET = 0.032 MILES
LENGTH OF BRIDGE = 31 FEET = 0.006 MILES
LENGTH OF PROJECT = 200 FEET = 0.038 MILES
LENGTH OF R. O. W. PROJECT = 411 FEET = 0.080 MILES

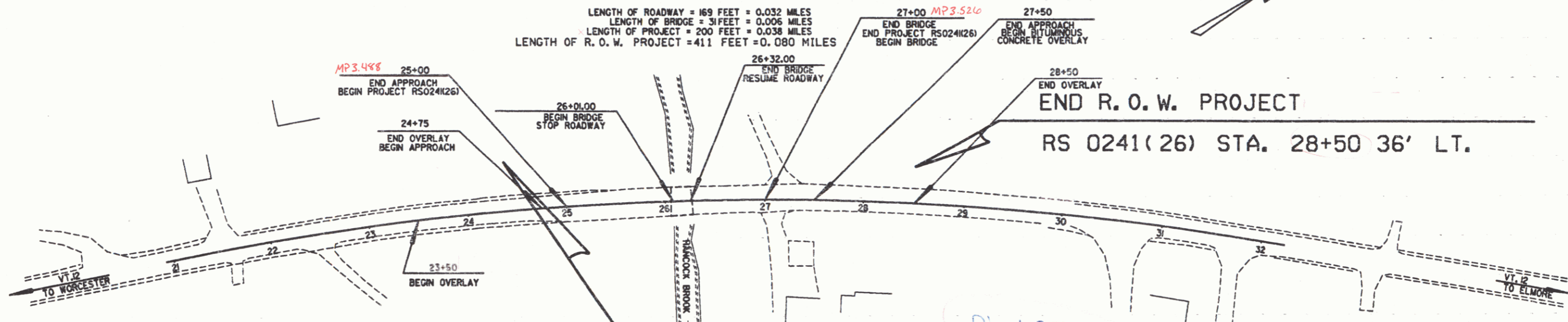

BEGIN R. O. W. PROJECT
RS 0241(26) STA. 24+39 49' LT.

END R. O. W. PROJECT
RS 0241(26) STA. 28+50 36' LT.

CONVENTIONAL SIGNS

COUNTY LINE	---
TOWN LINE	- - - -
LMITS OF ACCESS	— X —
POINT OF ACCESS	X
FENCE LINE	— X —
STONE WALL	— X —
TRAVELED WAY	— X —
GUARD RAIL	— X —
RAILROAD	— X —
SURVEY LINE	— X —
CULVERT	— X —
POWER POLE	— X —
TELEPHONE POLE	— X —
TREES	— X —
CONTROL OF ACCESS	— X —
PROPERTY LINE	— X —
R.O.W. TAKING LINE	— X —
SLOPE RIGHTS	— X —
TOP OF CUT	— X —
TOE OF SLOPE	— X —

DATUM

VERTICAL	1929
HORIZONTAL	N/A

RIGHT-OF-WAY DIVISION
TOWN FILE
PERPETUAL
Town of WORCESTER Vt. Rte #12
(To Be Returned To R.O.W. Division)

ALL DRIVES AS INDICATED ON PLANS ARE SUBJECT TO PERMITS PURSUANT TO TITLE 19 SECTION 88, V.S.A.



MAY 02 1994

APPROVED GORDON MCARTHUR DATE 1-23-92
Director of Engineering

APPROVED ALLEN BLAKE DATE 1-23-92
Chief of Right of Way

WORCESTER
RS 0241(26)
R.O.W. SHEET 1 OF 7 SHEETS